

# POINT WEST CORPORATE CENTER

1610 ARDEN WAY, SACRAMENTO, CA



GREAT CENTRAL LOCATION  
WITH BEST-IN-CLASS AMENITIES  
PROMINENT BUILDING SIGNAGE AVAILABLE

**NEWMARK**

  
**BASIN STREET  
PROPERTIES**

[pointwestportfolio.com](http://pointwestportfolio.com)

Exclusively Marketed By:

**Jack Blackmon**  
916.494.2349  
jack.blackmon@nmrk.com  
CA RE License #01999561

**Jodie Robinson**  
916.569.2318  
jodie.robinson@nmrk.com  
CA RE License #022143577

**Chris Lemmon**  
916.367.6349  
chris.lemmon@nmrk.com  
CA RE License #01506816

# POINT WEST CORPORATE CENTER

1610 ARDEN WAY  
SACRAMENTO, CA

## PROPERTY HIGHLIGHTS



Classic brick architecture with expansive windowline and courtyard views



Professional Property Management and facilities engineer



Onsite fitness center with showers



Beautiful courtyard with shaded outdoor seating and outdoor water feature



Located within minutes of Sacramento's CBD



Onsite Cafe. Restaurants and retail services immediately adjacent to the property & short walk to Arden mall



Immediate freeway access to Business Hwy 80



Onsite security patrol



Onsite training & conference room



Basin Street Properties is proud to announce our newest tenant amenity – Concierge Services. Tenants have access to family entertainment, travel arrangements, and a host of other business services.



### Personal Services

- Housekeeping / sitting
- Pet sitting / grooming
- Auto detailing / maintenance
- Dry cleaning / laundry
- Fitness trainer / massage services
- Customized personal shopping



### Entertainment Services

- Tickets for concerts, theater and sporting events
- Restaurant reservations
- Visiting client and guest arrangements



### Event and Meeting Services

- Site selection
- Catering, food and beverage arrangements
- Multi-media / A.V. arrangements



# POINT WEST CORPORATE CENTER

1610 ARDEN WAY  
SACRAMENTO, CA



## SITE PLAN

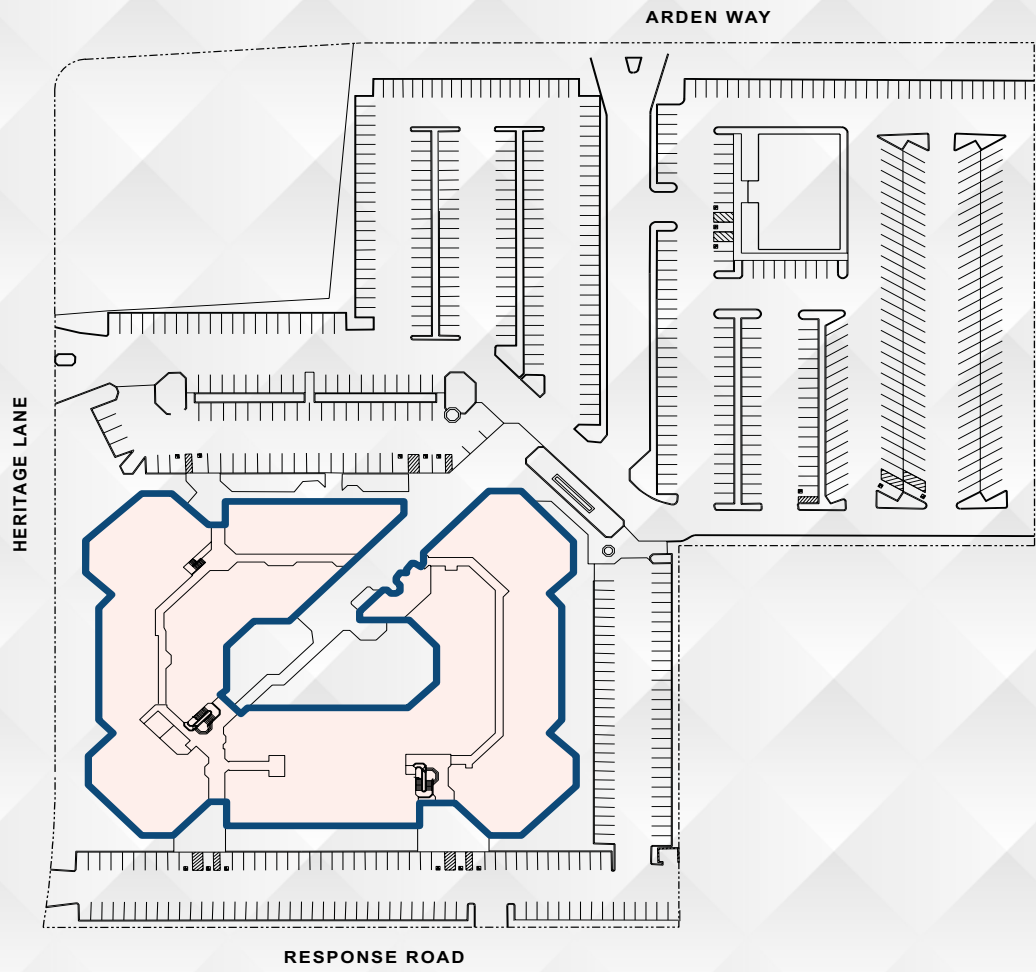

# POINT WEST CORPORATE CENTER

1610 ARDEN WAY  
SACRAMENTO, CA

## AMENITIES MAP



# POINT WEST CORPORATE CENTER

1610 ARDEN WAY  
SACRAMENTO, CA

## FLOOR PLANS

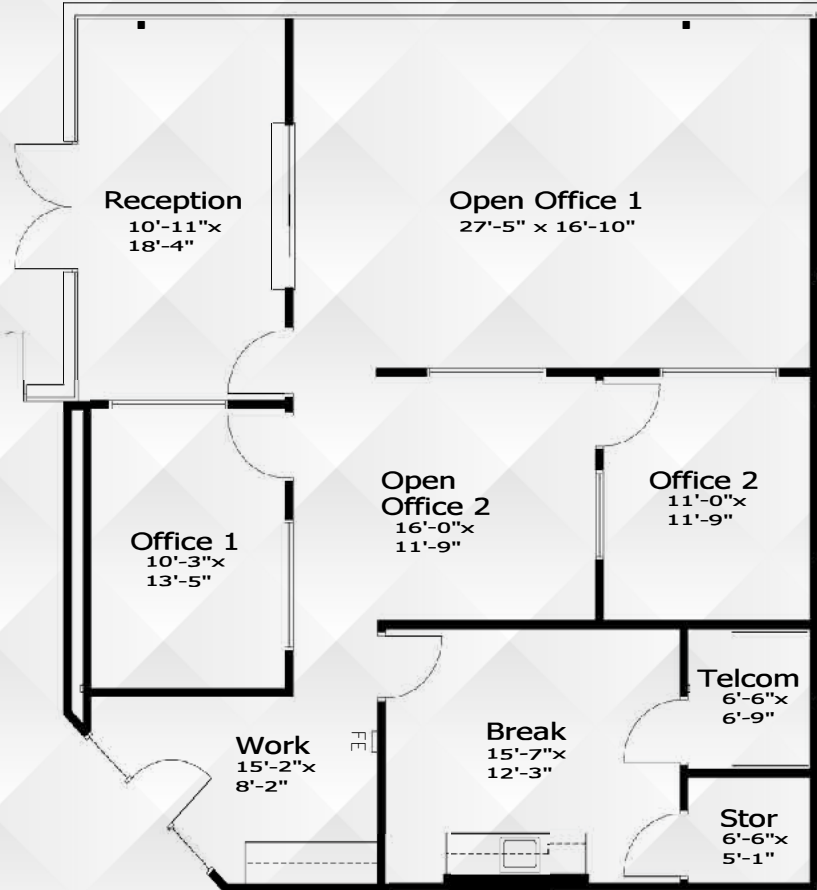
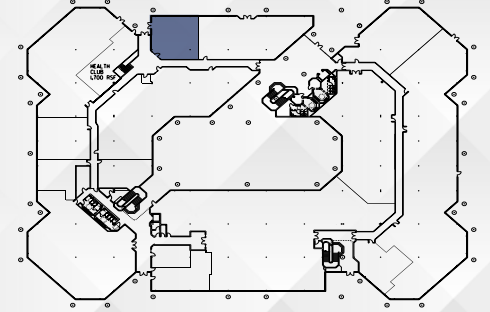

**FIRST FLOOR | 1,836 RSF | SUITE 119**

# POINT WEST CORPORATE CENTER

1610 ARDEN WAY  
SACRAMENTO, CA

## FLOOR PLANS

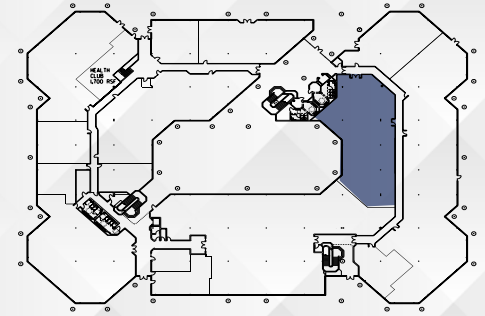
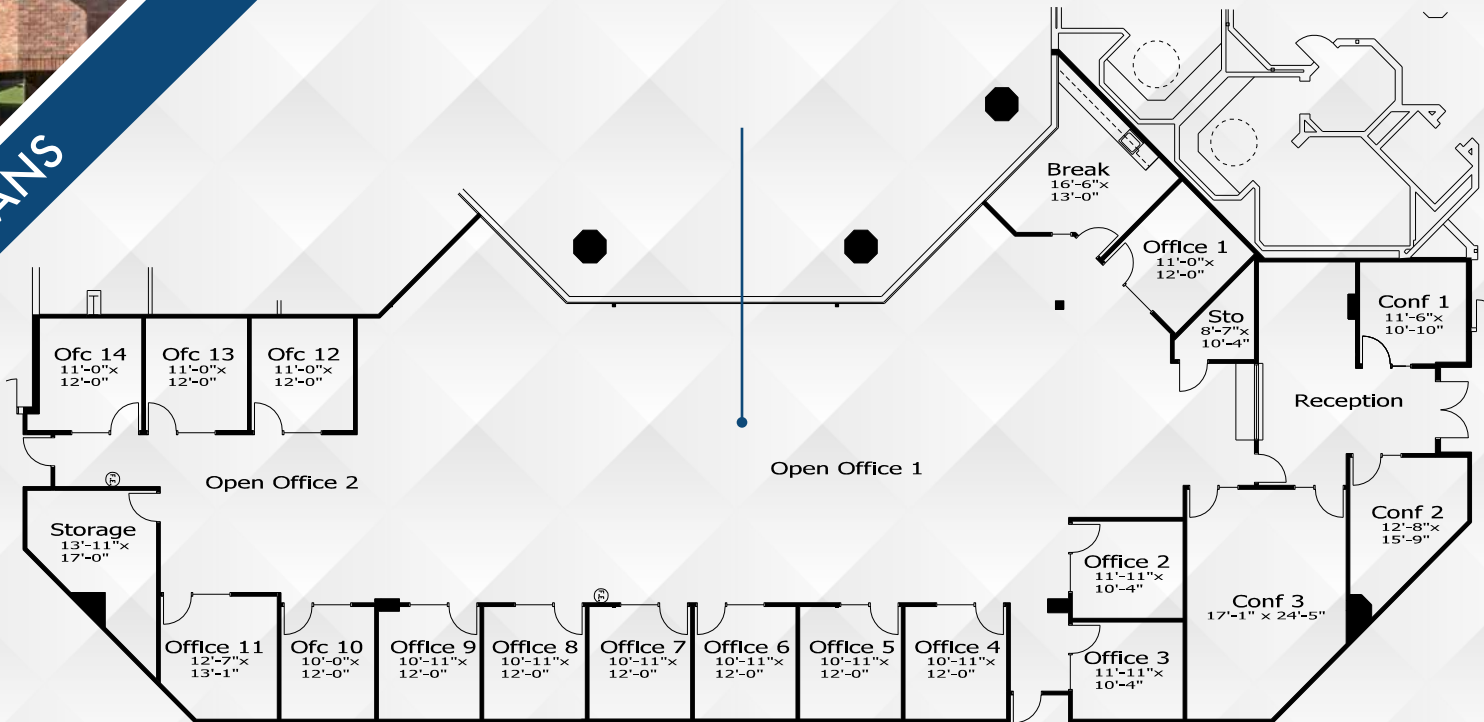

**FIRST FLOOR | 8,116 RSF | SUITE 190**

# POINT WEST CORPORATE CENTER

1610 ARDEN WAY  
SACRAMENTO, CA

## FLOOR PLANS

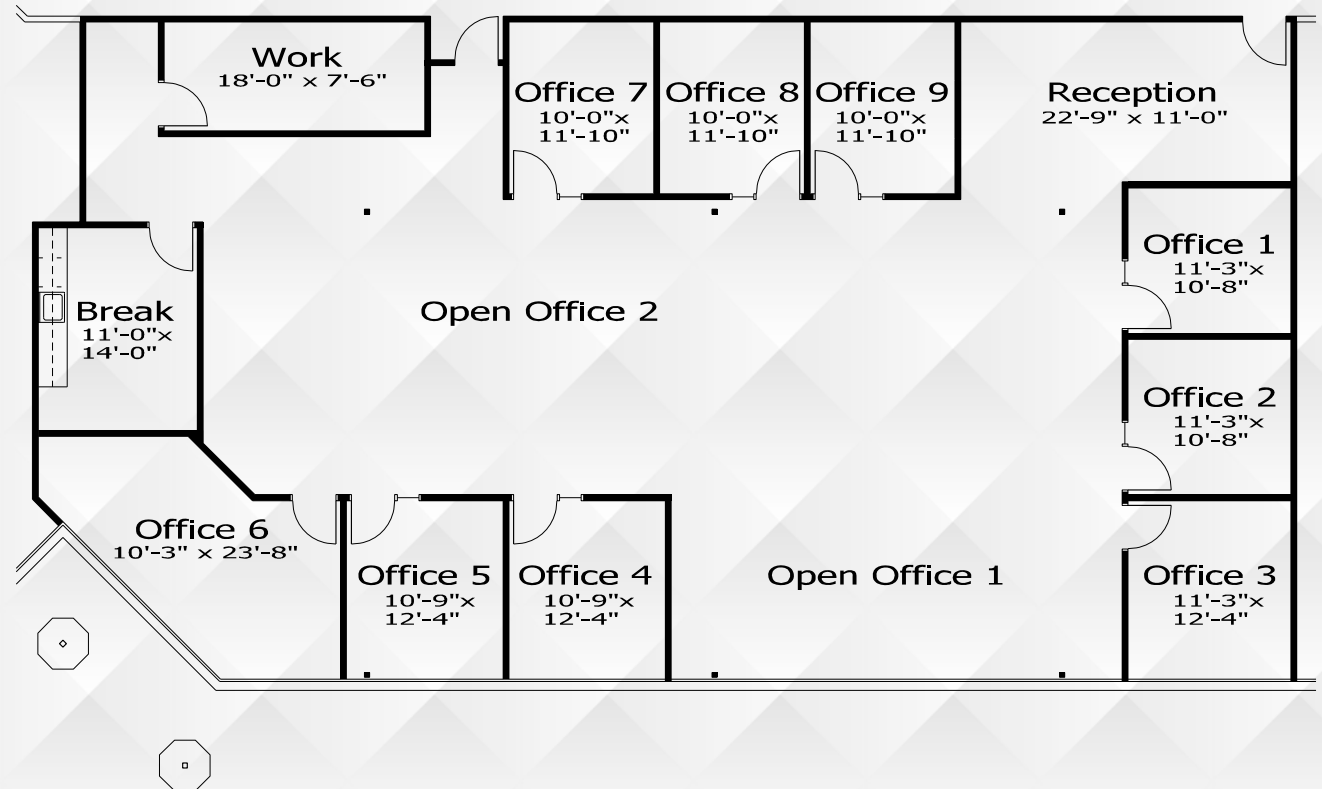
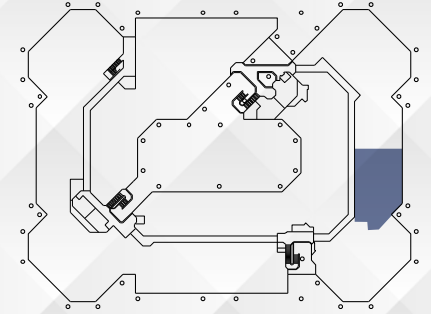

**SECOND FLOOR | 4,369 RSF | SUITE 277**

# POINT WEST CORPORATE CENTER

1610 ARDEN WAY  
SACRAMENTO, CA

## FLOOR PLANS

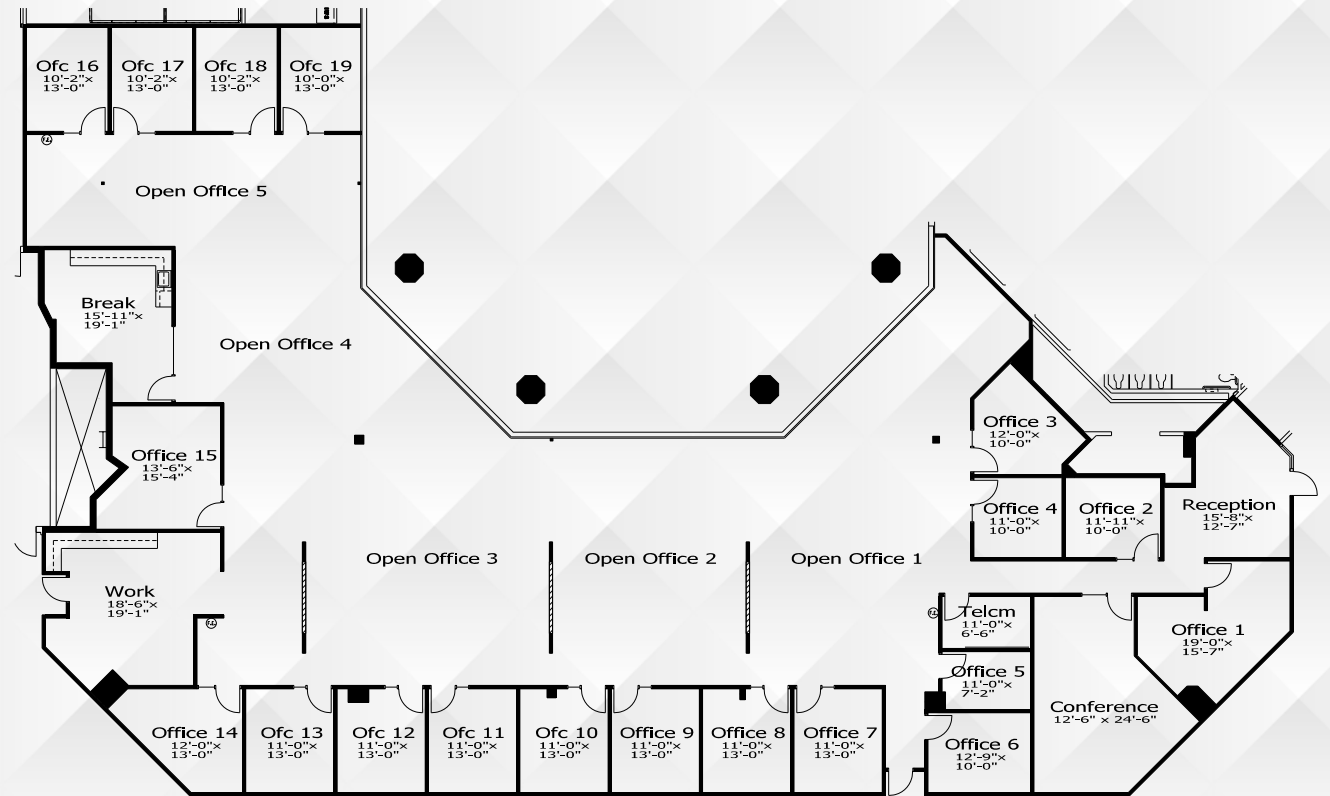
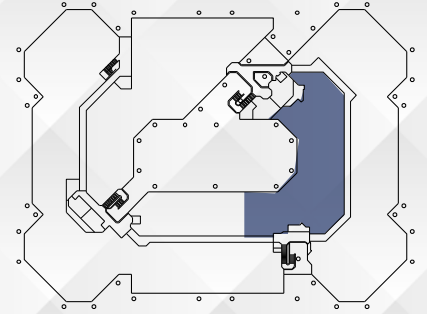

**SECOND FLOOR | 10,258 RSF | SUITE 280**

**POINT WEST  
CORPORATE CENTER**

1610 ARDEN WAY  
SACRAMENTO, CA

**FLOOR PLANS**

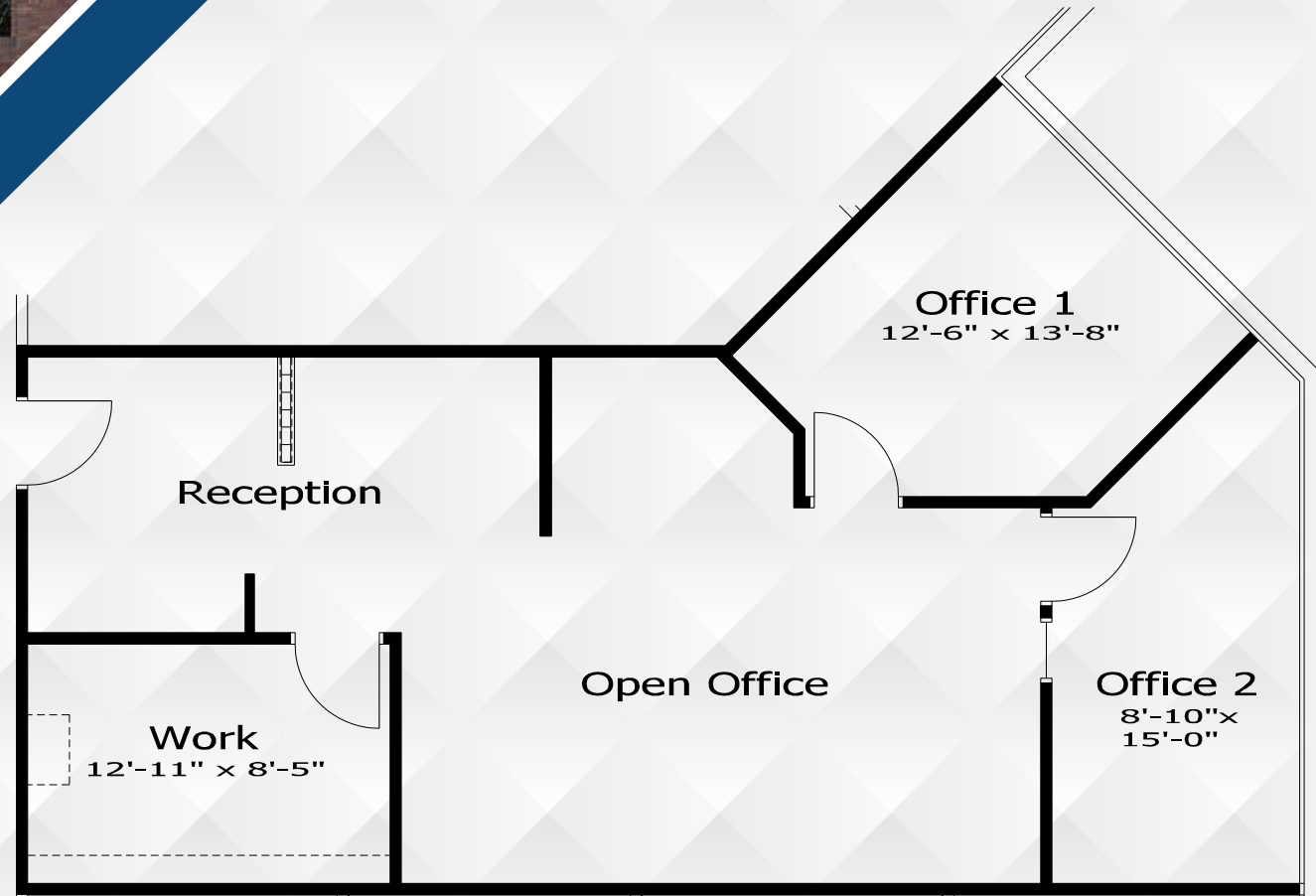
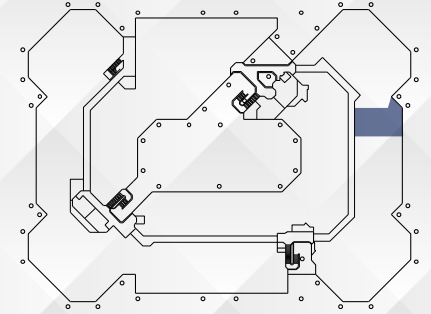

**SECOND FLOOR | 1,105 RSF | SUITE 287**

# POINT WEST CORPORATE CENTER

1610 ARDEN WAY  
SACRAMENTO, CA

## FLOOR PLANS

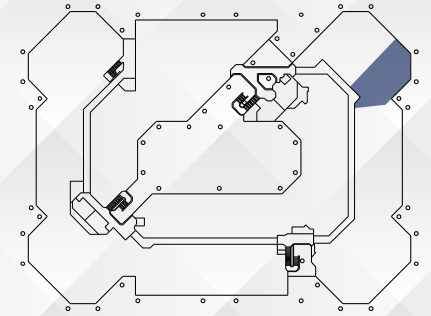

**SECOND FLOOR | 3,492 RSF | SUITE 295**

# POINT WEST CORPORATE CENTER

1610 ARDEN WAY  
SACRAMENTO, CA

## FLOOR PLANS

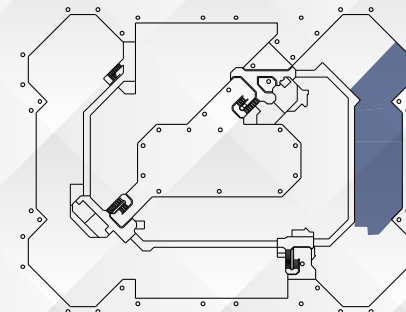

**SECOND FLOOR | 8,966 RSF | SUITE 277 | SUITE 287 | SUITE 295**

# POINT WEST CORPORATE CENTER

1610 ARDEN WAY, SACRAMENTO, CA

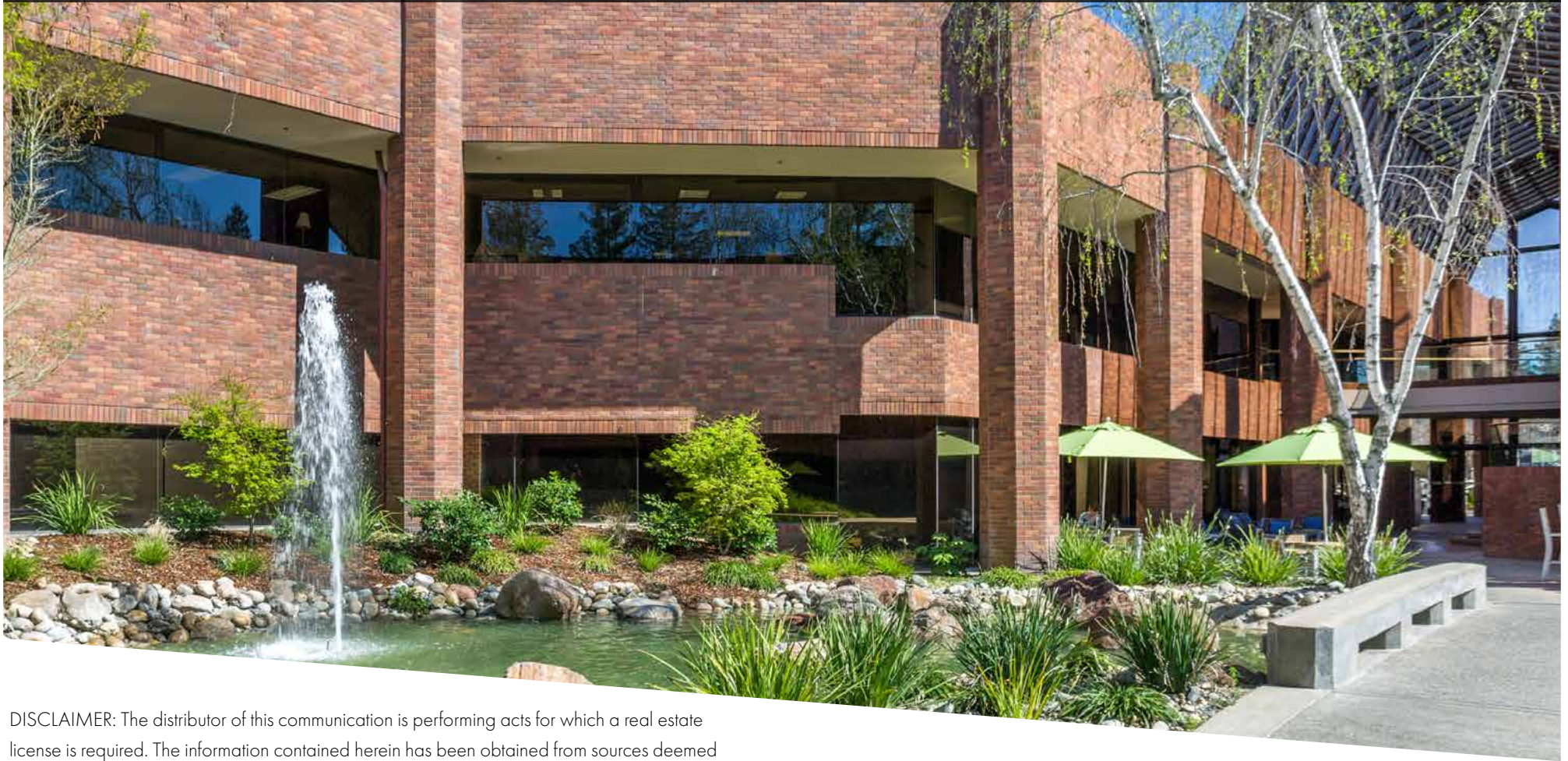

DISCLAIMER: The distributor of this communication is performing acts for which a real estate license is required. The information contained herein has been obtained from sources deemed reliable but has not been verified and no guarantee, warranty or representation, either express or implied, is made with respect to such information. Terms of sale or lease and availability are subject to change or withdrawal without notice.

**NEWMARK**

  
**BASIN STREET**  
PROPERTIES

[pointwestportfolio.com](http://pointwestportfolio.com)

Exclusively Marketed By:

**Jack Blackmon**

916.494.2349

[jack.blackmon@nmrk.com](mailto:jack.blackmon@nmrk.com)

CA RE License #01999561

**Jodie Robinson**

916.569.2318

[jodie.robinson@nmrk.com](mailto:jodie.robinson@nmrk.com)

CA RE License #022143577

**Chris Lemmon**

916.367.6349

[chris.lemmon@nmrk.com](mailto:chris.lemmon@nmrk.com)

CA RE License #01506816