

# Colonial Village

Shopping Center & Office Park

1-11 Lincoln Highway/Route 27 · Edison, NJ

*Built Medical and Professional Space Available*



## THE PROPERTY

Weiss Realty is pleased to present Colonial Village Shopping Center & Office Park, a six-acre landscaped property in North Edison near the Metuchen border and Metropark Train Station, minutes from the Garden State Parkway, New Jersey Turnpike, I-287, Routes 1 and 9, across from JFK Hospital and close to Menlo Park Mall.

### AVAILABLE SPACE

1 LINCOLN HIGHWAY 2ND FLOOR	950 SF
3 LINCOLN HIGHWAY GROUND FLOOR	300 SF
5 LINCOLN HIGHWAY 2ND FLOOR	1,400 SF - 2,000 SF
7 LINCOLN HIGHWAY 2ND FLOOR	500 SF

## Medical & Professional Space



## PROPERTY HIGHLIGHTS

- Retail, Medical & Office Suites Available from 300 SF to over 2,000 SF
- A seven-day, 24 hour working environment with on-site property management
- Parking for 400 cars
- Convenient access via Metropark train station and all major highways



## Site Plan

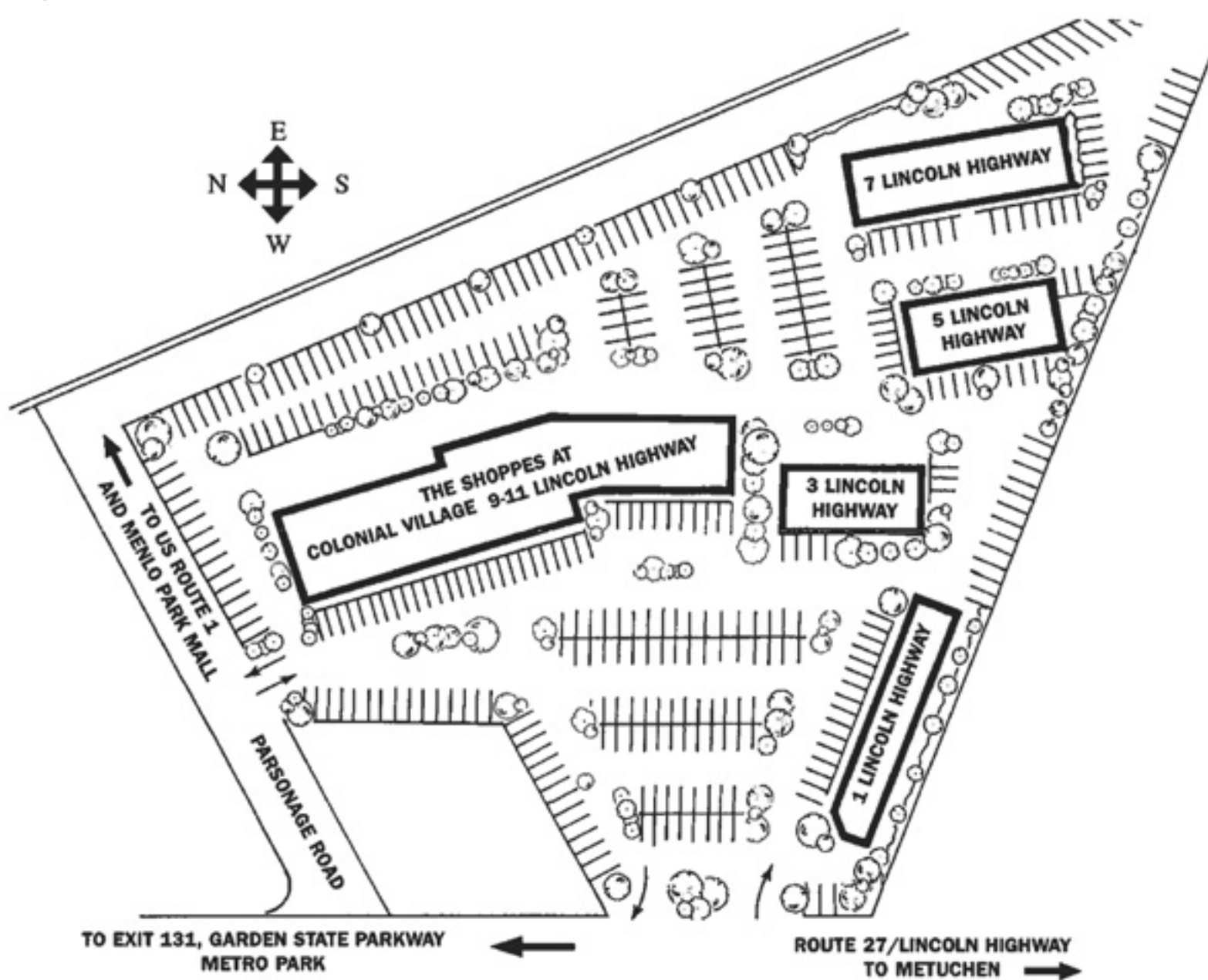

**Weiss**  
**REALTY**

jweissrealty.com

Matthew B. Weiss  
(201) 814-1841 o  
(917) 309-7861 c  
mweiss@jweissrealty.com

Jaime M. Weiss  
(201) 814-1840 o  
(201) 615-0474 c  
jweiss@jweissrealty.com

### Broker Cooperation Invited

A commission computed in accordance with the rates and conditions of our agency agreement with our principal, when received from our principal will be paid to the cooperating broker who consummates a sale which is unconditionally executed and delivered by and between buyer and seller. (A copy of the rates and additional conditions are available upon request) No warranty or representation, expressed or implied, is made as to the accuracy of the information contained herein, and same is submitted subject to errors, omissions, change of price, rental or other conditions, withdrawal without notice and to any specific listing conditions imposed by our principals.