



Bldg 2

For Lease

High Visibility Office Space

Mike Cobb

Managing Director
+1 207 712 9318
m.cobb@colliers.com

Abby Woodman

Associate
+1 207 272 6393
abby.woodman@colliers.com



217 Commercial Street, Suite 201
Portland, ME 04101
+1 207 560 8000
colliers.com/maine

235 Portland Road Gray, ME

Property Highlights

- Highly visible office space available for lease with pylon signage and plenty of on-site parking
- 2,500± to 10,000± SF of shell condition office/commercial space that can be designed to suit your needs
- Competitive tenant improvement allowances and flexible layouts
- Great exposure with 580' of frontage on Route 100/Portland Road
- Less than 3 miles to Exit 63 off I-95 and about 5 minutes to the center of town, offering many amenities including banks, grocery stores, USPS, restaurants, gas stations, Dollar Tree, and more

Information herein has been obtained from sources deemed reliable, however its accuracy cannot be guaranteed by Colliers International | New Hampshire & Maine. The user is required to conduct their own due diligence and verification. Colliers International | New Hampshire & Maine is independently owned and operated.

For Lease

Specifications

Address:	235 Portland Road, Building 2
Location:	Gray, ME 04039
Owner(s):	235 PR, LLC
Map/Lot:	36/002
Book & Page:	35257 & 252
Building Type:	Office/mixed-use
Year Built:	1990
Total Building SF:	10,000±
Available SF:	2,500± to 10,000±
Utilities:	Municipal water & septic Mini splits (to be installed)
Zoning:	Commercial
Parking:	Ample
Lease Rate:	\$16.00 modified gross



Aerial

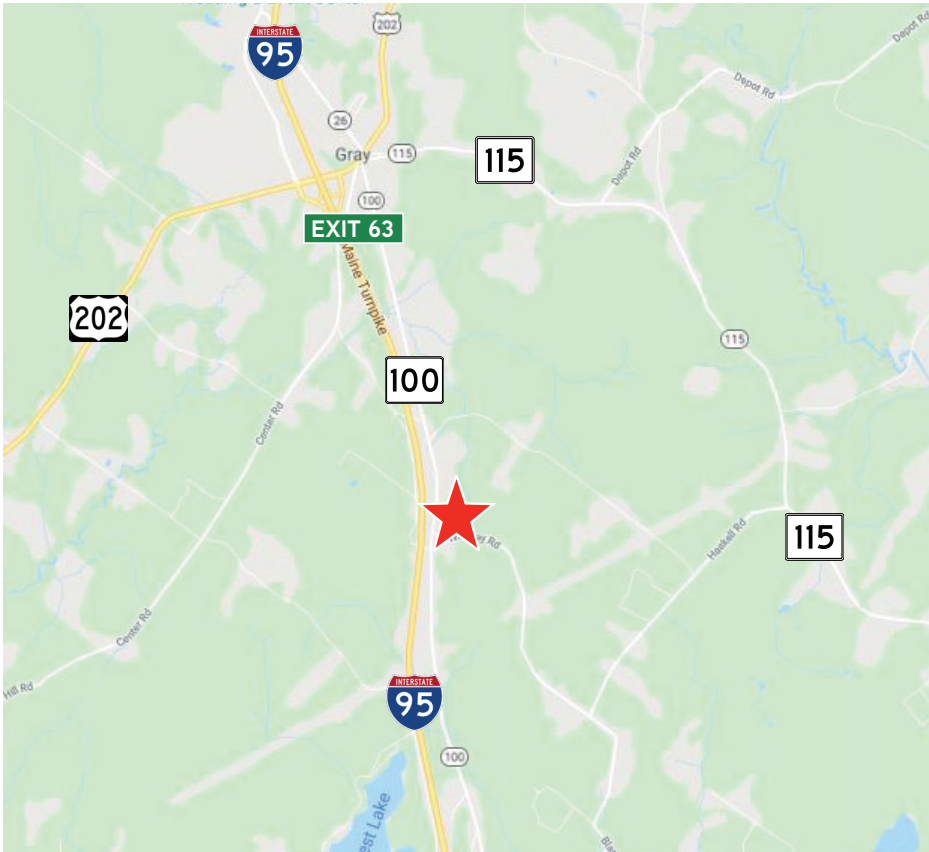

Contact us:

Mike Cobb

Managing Director
+1 207 712 9318
m.cobb@colliers.com

Abby Woodman

Associate
+1 207 272 6393
abby.woodman@colliers.com



217 Commercial Street, Suite 201
Portland, ME 04101
+1 207 560 8000
colliers.com/maine

Building 2 Sample Layout

First Floor

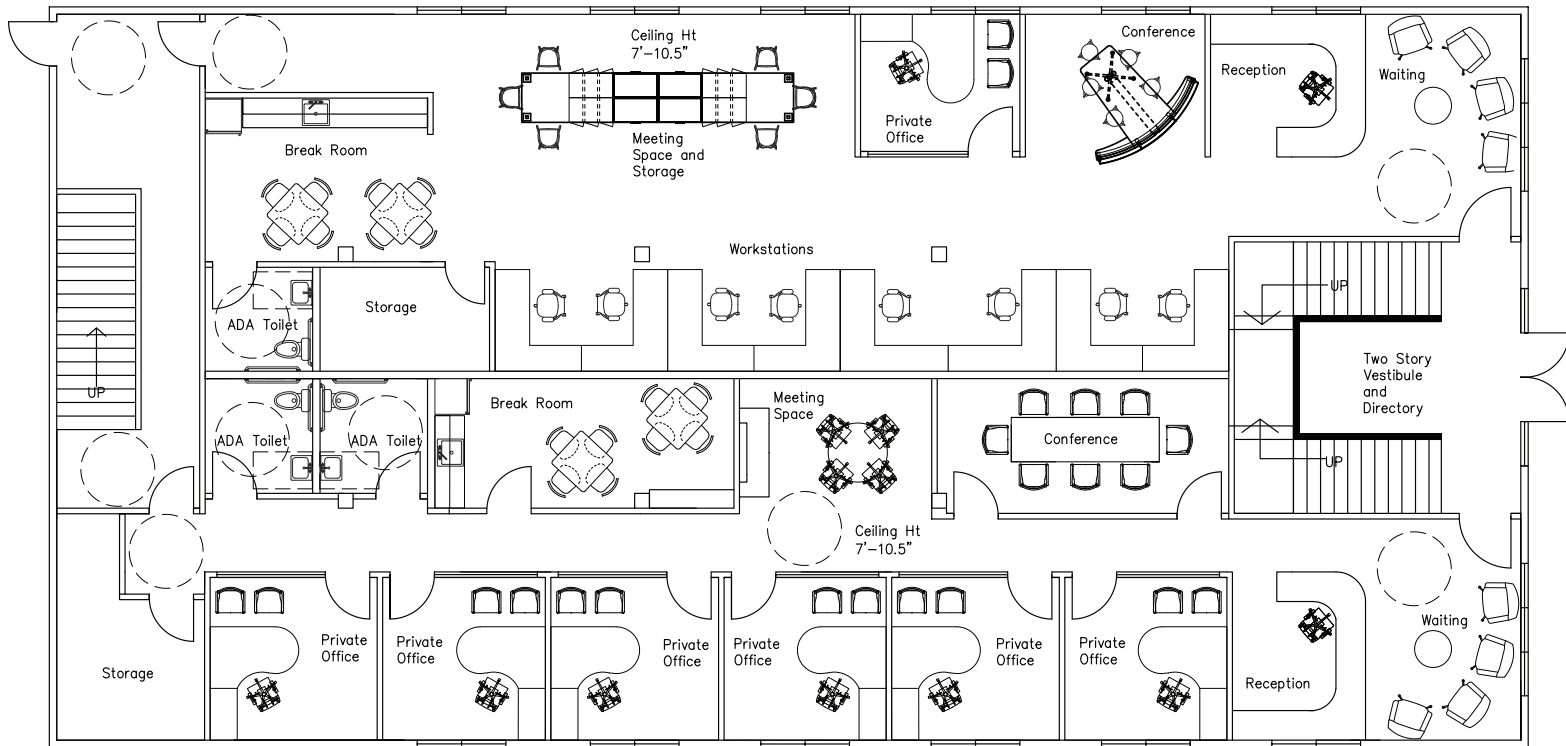

Second Floor

