

FOR LEASE



29751 EAST ENID ROAD - UNIT A & B - EUGENE, OR

FOR LEASE: INDUSTRIAL SPACE

- 4,350 SQUARE FEET
- 4 GRADE LEVEL ROLL-UP DOORS
- 3-PHASE POWER (480V 400 AMPS)

Lease Rate: \$0.75/SF, NNN



www.campbellre.com

For more information contact:

TIM CAMPBELL

timc@campbellre.com | (541) 484-2214

Licensed in the State of Oregon

BILL NEWLAND

bill@campbellre.com | (541) 484-2214

Licensed in the State of Oregon

SPACE FLOOR PLAN

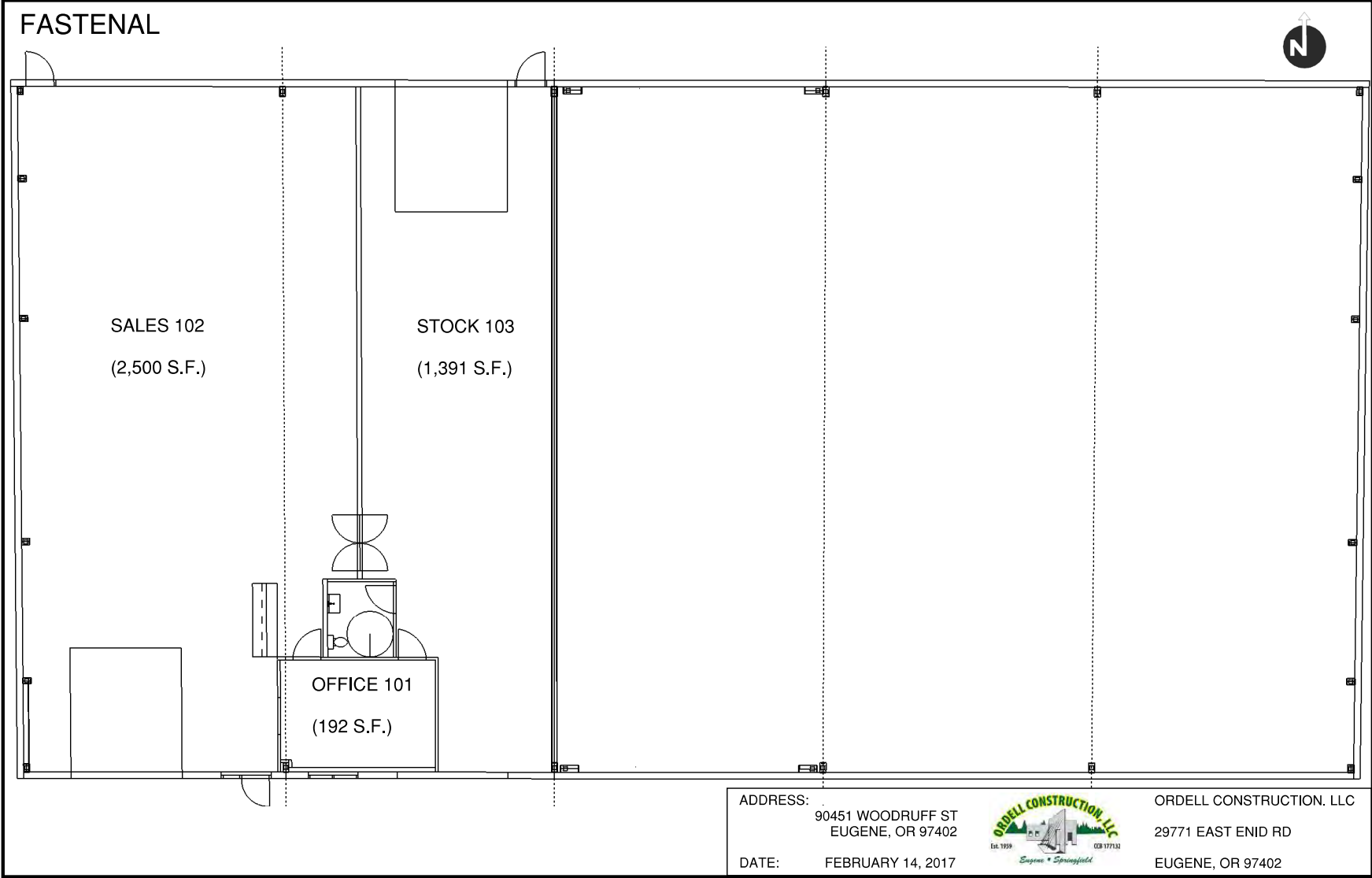

The information in this package was obtained from sources deemed reliable, and is not guaranteed by agent. Package is subject to change, error or omission, prior sale or lease, correction or withdrawal. Any party contemplating purchase is urged to conduct their own independent study and inspection.



29751 EAST ENID ROAD



The information in this package was obtained from sources deemed reliable, and is not guaranteed by agent. Package is subject to change, error or omission, prior sale or lease, correction or withdrawal. Any party contemplating purchase is urged to conduct their own independent study and inspection.



PROPERTY LOCATION MAP

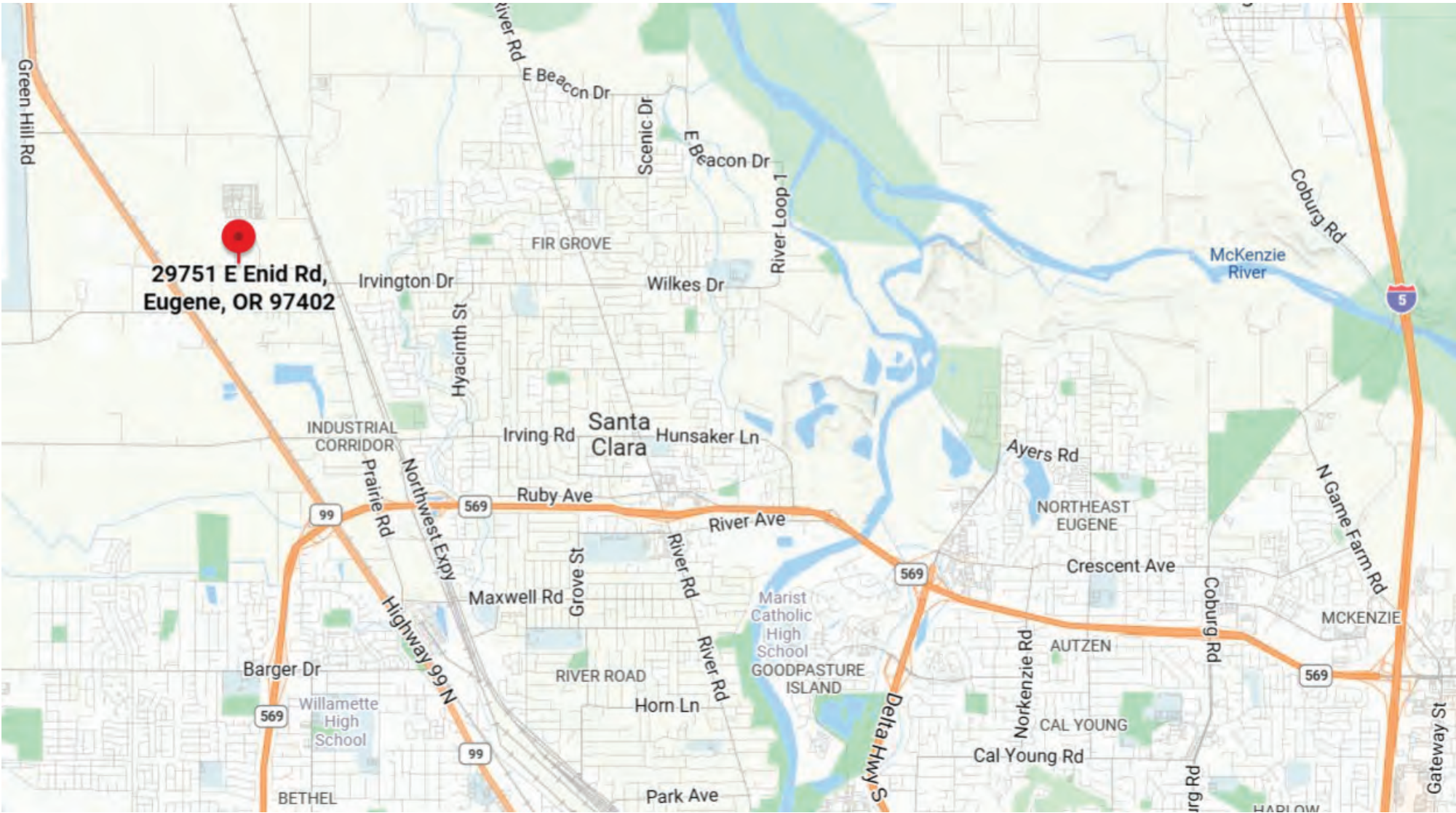

29751 E Enid Rd,
Eugene, OR 97402

The information in this package was obtained from sources deemed reliable, and is not guaranteed by agent. Package is subject to change, error or omission, prior sale or lease, correction or withdrawal. Any party contemplating purchase is urged to conduct their own independent study and inspection.

