



INDUSTRIAL SPACES FOR LEASE



**1000 BUSINESS PARK DRIVE STE A&F
DIXON, CA 95620**

**7,550 & 10,000 SQ. FT. AVAILABLE
INCLUDING 2,235 SQ. FT. OFFICE**

ASKING RATES

Suite A - \$0.50/NNN

Suite F - \$0.80/NNN

PROPERTY HIGHLIGHTS

- **Suite F 10,000 Sq. Ft.:** Available February 1, 2026
 - 1 Grade Level and 2 Dock High Loading Doors
 - Power: 200 Amps 277/480 V
- **Suite A 7,550 Sq. Ft.:** Available January 1, 2026
 - 1 Grade Level Loading Door
 - Dead Storage
- ESFR Fire Sprinkler System
- 28' - 32' Clear Height
- One Mile South of I-80

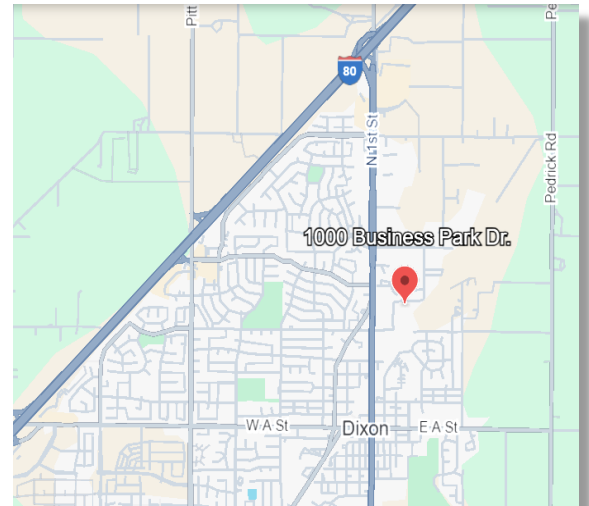

BILL MACLAUGHLIN

BILLYMAC3@MACCO.ORG

916-374-4231

LIC # 01175040

BROLIN COOK

BCOOK@MACCO.ORG

916-374-4227

LIC # 02198393

1401 Shore Street, West Sacramento, CA 95691

www.macco.org

The information contained herein has been carefully checked and to the best of our knowledge is correct but we assume no liability for representations as to values or for errors or omissions in this statement. Client should carefully verify the above items of income and expenses and all other information contained herein.

1000 BUSINESS PARK DRIVE STE A — Dead Storage

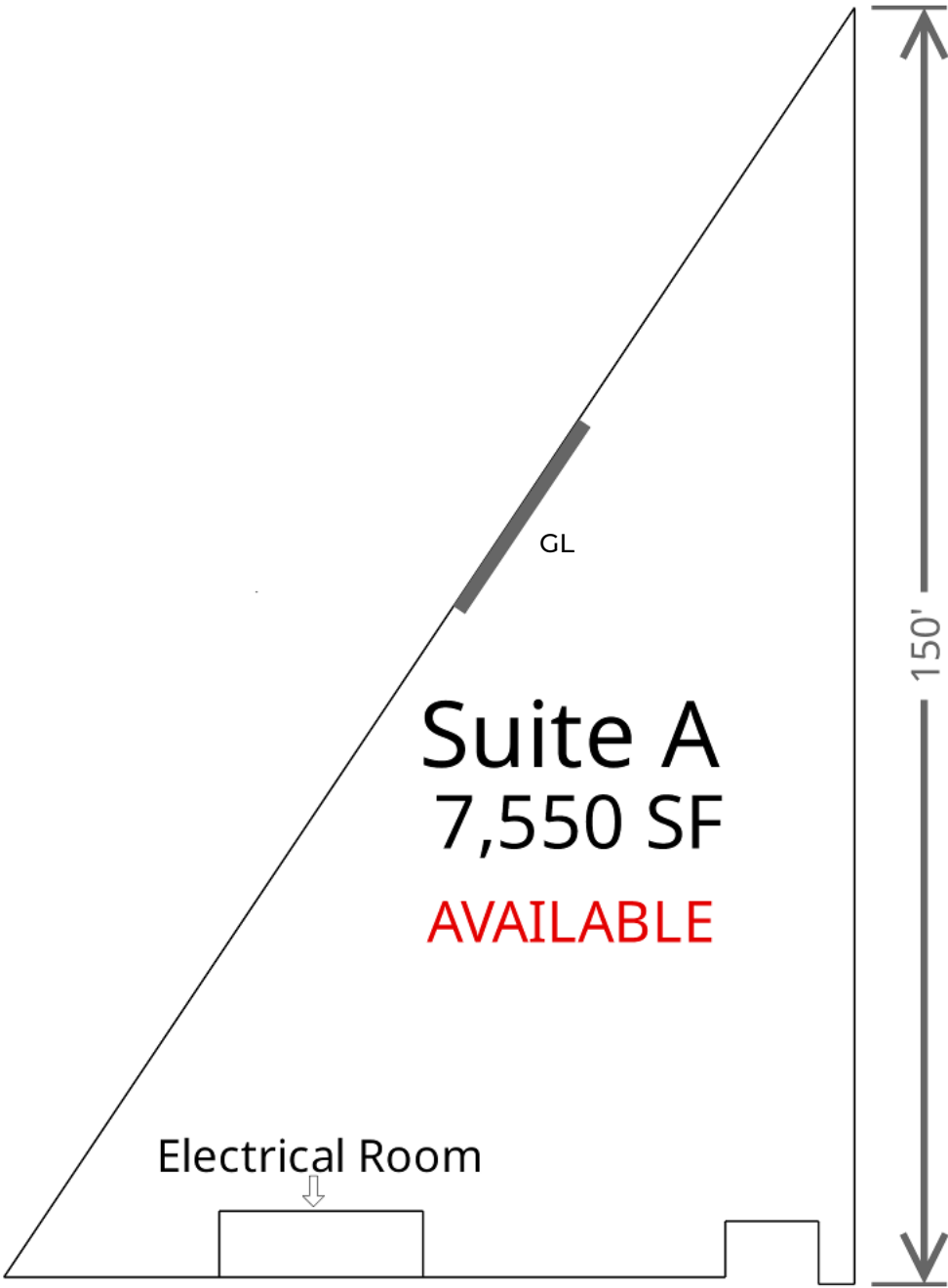

1000 BUSINESS PARK DRIVE STE F

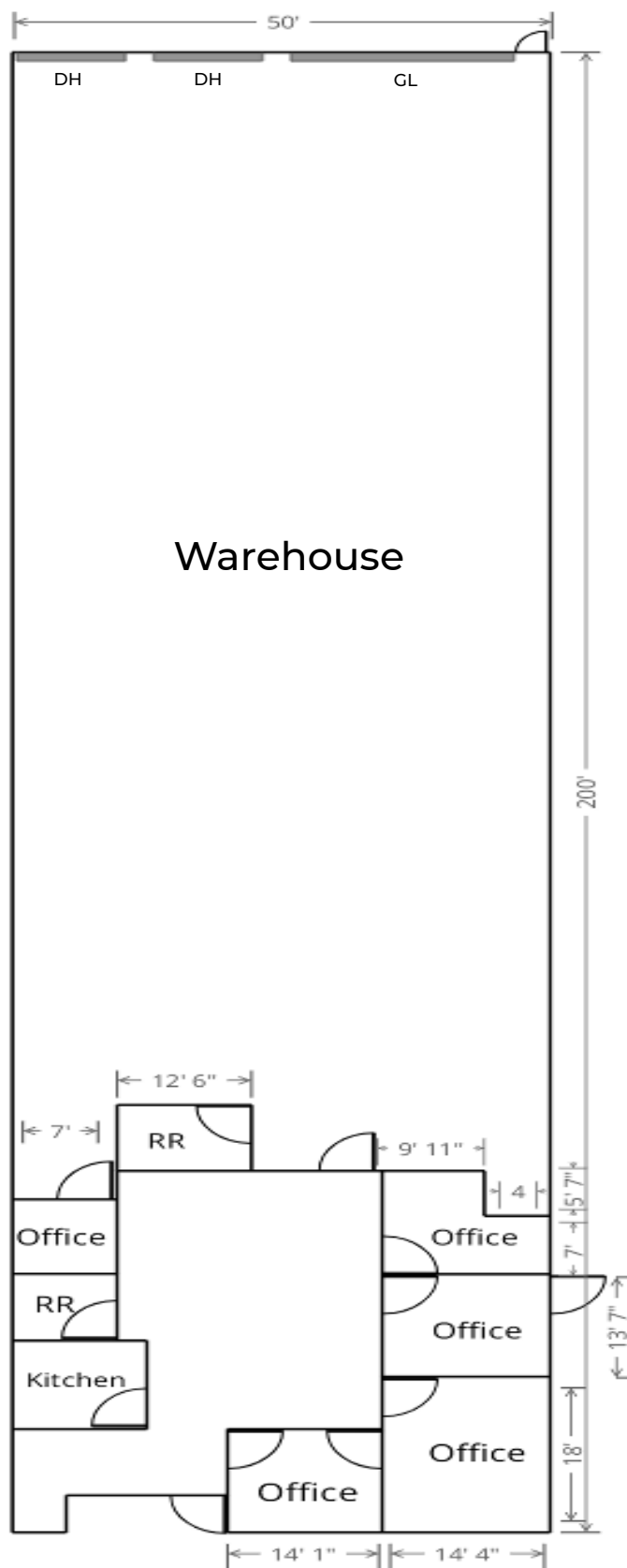

1000 BUSINESS PARK DRIVE STE F

