



GOVERNORS DRIVE  
& 14TH STREET  
HUNTSVILLE, AL  
35805

RETAIL SPACE  
**FOR LEASE**



## ABOUT THE PROPERTY

*The Foundry* is a mixed-use development that is adjacent to ~50,000 SF of office space, and includes ~40,000 SF of retail/restaurant space, 328 multifamily units, and 14 rentable townhomes.

CONVENIENT COMMUTE

LUXURIOUS AMENITIES

VIBRANT COMMUNITY

PROMINENT SIGNAGE

NEW DEVELOPMENTS

VISIBILITY & ACCESS

PARKING



**CRUNKLETON**  
COMMERCIAL REAL ESTATE GROUP

**ANUSHA ALAPATI DAVIS**

Vice President of Retail

256-384-7608

[anusha@crunkletonassociates.com](mailto:anusha@crunkletonassociates.com)

**WESLEY CRUNKLETON**

Principal

256-536-8809

[wesley@crunkletonassociates.com](mailto:wesley@crunkletonassociates.com)



# PROPERTY HIGHLIGHTS



## ADDRESS

Governors Drive & 14th Street, Huntsville, AL 35801



## PROPERTY NAME

The Foundry



## SALE/LEASE

For Lease



## TYPE OF PROPERTY

Retail



## SF AVAILABLE

Building B: 1,419 SF

Building I: 2,176 SF



## PRICE

Call For Pricing

## PROPERTY HIGHLIGHTS:

- Along major thoroughfare with high traffic counts.
- Four multi-family projects totaling over 700 units within one mile of site.
- High-visibility signage on Governors Drive.
- Plenty of parking.
- Outdoor patio seating opportunities.
- At a signalized intersection.
- Property is adjacent to high-profile Stovehouse development that encompasses ~80,000 SF of office and ~30,000 SF of retail, plus abundant event space.
- Inside entertainment district.
- Walkable community via 10 ft. wide illuminated sidewalk along Governors Drive.



**CRUNKLETON**  
COMMERCIAL REAL ESTATE GROUP

**ANUSHA ALAPATI DAVIS**

Vice President of Retail

256-384-7608

anusha@crunkletonassociates.com

**WESLEY CRUNKLETON**

Principal

256-536-8809

wesley@crunkletonassociates.com

# BUILDING B FLOORPLAN

**SUITE 104**  
1,419 SFAA AVAILABLE

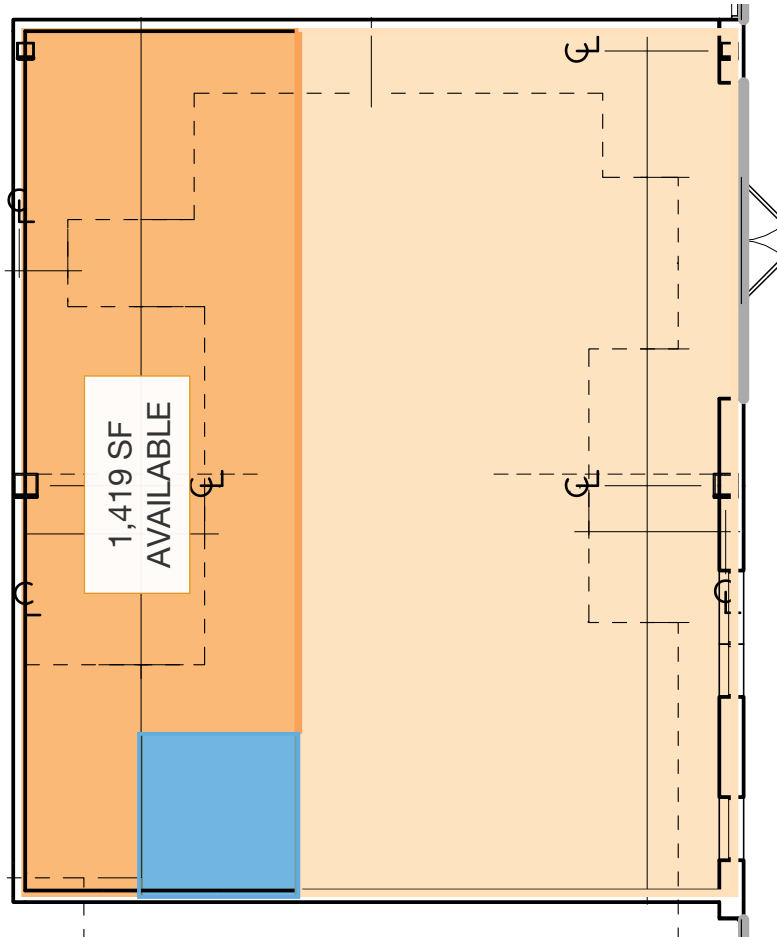

**ANUSHA ALAPATI DAVIS**  
Vice President of Retail  
256-384-7608  
[anusha@crunkletonassociates.com](mailto:anusha@crunkletonassociates.com)

**WESLEY CRUNKLETON**  
Principal  
256-536-8809  
[wesley@crunkletonassociates.com](mailto:wesley@crunkletonassociates.com)



# BUILDING I FLOORPLAN

2,176 SF AVAILABLE

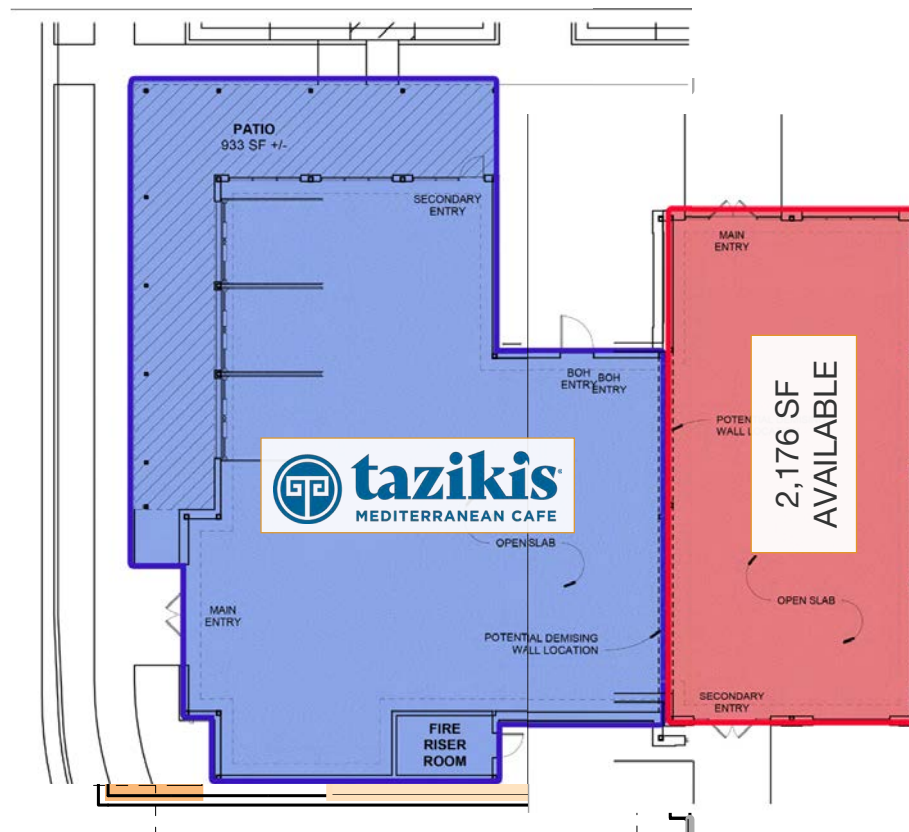



# AERIAL



**CRUNKLETON**  
COMMERCIAL REAL ESTATE GROUP

**ANUSHA ALAPATI DAVIS**  
Vice President of Retail  
256-384-7608  
anusha@crunkletonassociates.com

**WESLEY CRUNKLETON**  
Principal  
256-536-8809  
wesley@crunkletonassociates.com



# SITE PLAN & THE FOUNDRY



**CRUNKLETON**  
 COMMERCIAL REAL ESTATE GROUP

**ANUSHA ALAPATI DAVIS**  
 Vice President of Retail  
 256-384-7608  
 anusha@crunkletonassociates.com

**WESLEY CRUNKLETON**  
 Principal  
 256-536-8809  
 wesley@crunkletonassociates.com



# AREA MAP



**CRUNKLETON**  
COMMERCIAL REAL ESTATE GROUP

**ANUSHA ALAPATI DAVIS**

Vice President of Retail

256-384-7608

anusha@crunkletonassociates.com

**WESLEY CRUNKLETON**

Principal

256-536-8809

wesley@crunkletonassociates.com



# THE *Foundry*

3810 GOVERNORS DR. SW  
HUNTSVILLE, AL 35805



**CRUNKLETON**  
COMMERCIAL REAL ESTATE GROUP

300 Pratt Ave NE Huntsville AL 35801  
256-536-8809  
[crunkletonassociates.com](http://crunkletonassociates.com)

**ANUSHA ALAPATI DAVIS**  
Vice President of Retail  
256-384-7608  
[anusha@crunkletonassociates.com](mailto:anusha@crunkletonassociates.com)

**WESLEY CRUNKLETON**  
Principal  
256-536-8809  
[wesley@crunkletonassociates.com](mailto:wesley@crunkletonassociates.com)