

LINCOLN PARK OFFICE SPACE

20,228 SF AVAILABLE FOR LEASE



PRIME LINCOLN PARK LOCATION
2059 N Clark Street | Chicago, IL 60614

The Opportunity

Goldstreet Partners presents a rare leasing opportunity in Lincoln Park. This 20,000 SF office space, located directly across from the Lincoln Park Zoo, offers easy access to Lake Shore Drive. The main entrance on Clark Street leads to a dedicated lobby, which will be completely rebranded for a new tenant. The second floor features 19,531 SF of office space, including a 697 SF lobby on the ground floor with access from Clark Street. Facing the Lincoln Park Zoo and near the Green City Farmer's Market, this space is ideal for various uses, complementing our existing retail tenants: Starbucks, RJ Grunts, and PNC Bank.

Highlights

- Prime location in Lincoln Park, directly across from the Lincoln Park Zoo
- Convenient access to Lake Shore Drive and public transportation
- Spacious 19,531 SF second-floor office area with dedicated 697 SF ground-floor lobby
- Potential for custom branding and reconfiguration to suit tenant needs
- Proximity to popular attractions like Green City Farmer's Market and vibrant retail tenants
- Last Remaining Space. Join Starbucks, RJ Grunts, PNC Bank, and a new Preschool

Key Facts

Address:	2059 N Clark Street, Chicago, IL 60614
Neighborhood:	Lincoln Park
Premises:	697 SF (ground floor) + 19,531 SF (2nd floor)
Parking:	Area garages nearby
Zoning:	B1-3
Alderman:	Timmy Knudsen (43rd Ward)

20,228 SF Available For Lease | 2059 N Clark Street, Chicago, IL 60614 | info@goldstreetre.com

SECOND FLOOR PLAN

PROGRAM SUMMARY:

RECEPTION	1
CONFERENCE ROOM	4
PRIVATE OFFICE	7
WORKSTATIONS	33
Huddle Room	7
STORAGE	1
COLLAB/PANTRY	2
COPY/PRINT AREA	1
PHONE ROOM	6

WALL LEGEND

- EXISTING PARTITION, TO REMAIN
- NEW PARTITION

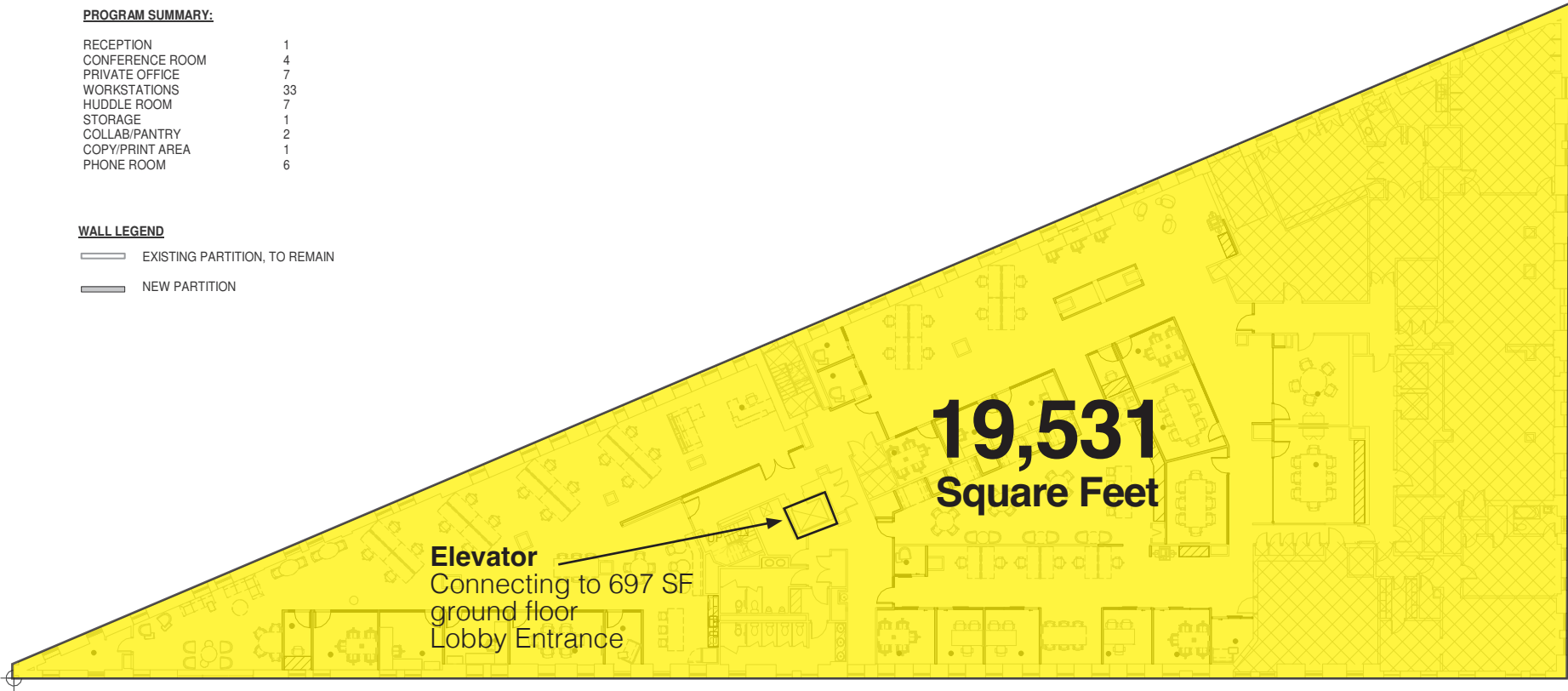

WELCOME TO LINCOLN PARK

Located just two miles North of the Magnificent Mile and downtown's many hotels and attractions, Lincoln Park, Chicago is home to a variety of unmatched destinations. Whether you want to immerse yourself in arts and culture, dine at award-winning restaurants or enjoy first-class shopping, Lincoln Park offers an inspired experience.

Home to DePaul University, museums, theaters, and historic homes, Lincoln Park welcomes students, young professionals, families and even celebrities to its bustling, tree-lined streets. It's a friendly (and family-friendly) urban environment with convenient public transportation, skyline views and ample open space coming together to create an experience you won't find anywhere else.



DEMOGRAPHICS

LINCOLN PARK NEIGHBORHOOD



141

Wealth Index
against
National
Average



72,350

Total
Population



\$190,528

Average
Household
Income



32.6

Median Age
for Lincoln Park



\$645,519

Median
Home Value



91%

Education of
Bachelors Degree
or Higher

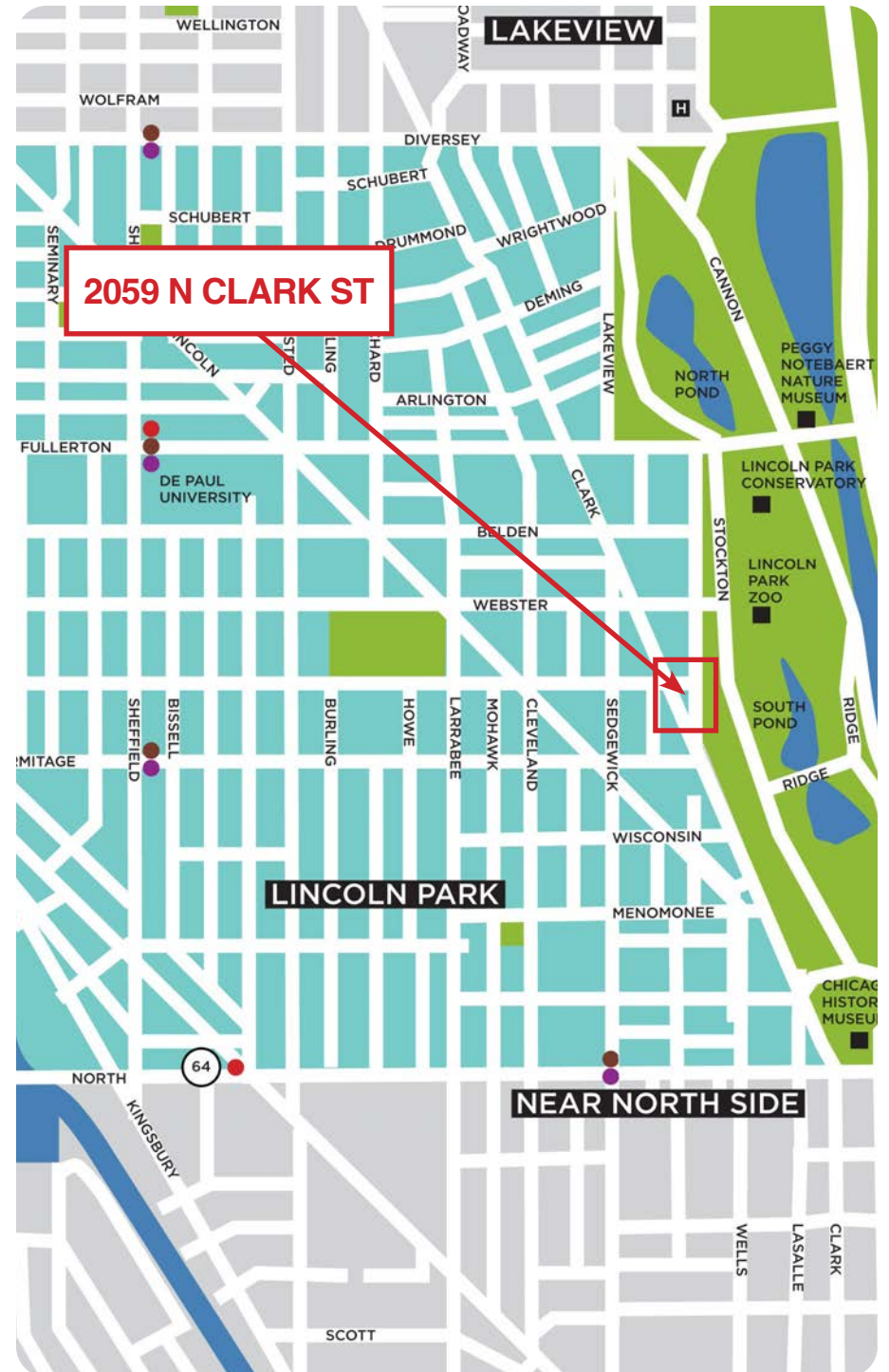



GOLDSTREET

PARTNERS

FOR ADDITIONAL INFORMATION:

David Goldberg
david@goldstreetre.com
(847) 274-8504

Allan Perales
allan@goldstreetre.com
(312) 852-5526

20,228 SF Available For Lease | 2059 N Clark Street, Chicago, IL 60614 | info@goldstreetre.com