



# FOR LEASE

- ✓ ± 9,457 Total SF on ± 3.54 Acres
- ✓ Zoned West Haven City Mixed Use
- ✓ Large Showroom w/ Storefront Windows
- ✓ Warehouse w/ Multiple Overhead Doors
- ✓ Extra Warehouse w/ Carport & OHDs
- ✓ Large Secure Fenced Storage Yard
- ✓ High Visibility Freeway Frontage
- ✓ Direct Access to Freeway & Roads
- ✓ MLS #2157549



**\$14,950.00/NNN**

**1750 S 1350 W  
West Haven, UT 84401**

**CREST**  
REALTY

# Floor Plan

## South Warehouse

Warehouse = 6,615 Sq Ft  
 Office = 585 Sq Ft  
 Mezzanine = 657 Sq Ft  
 Total = 7,857 Sq Ft

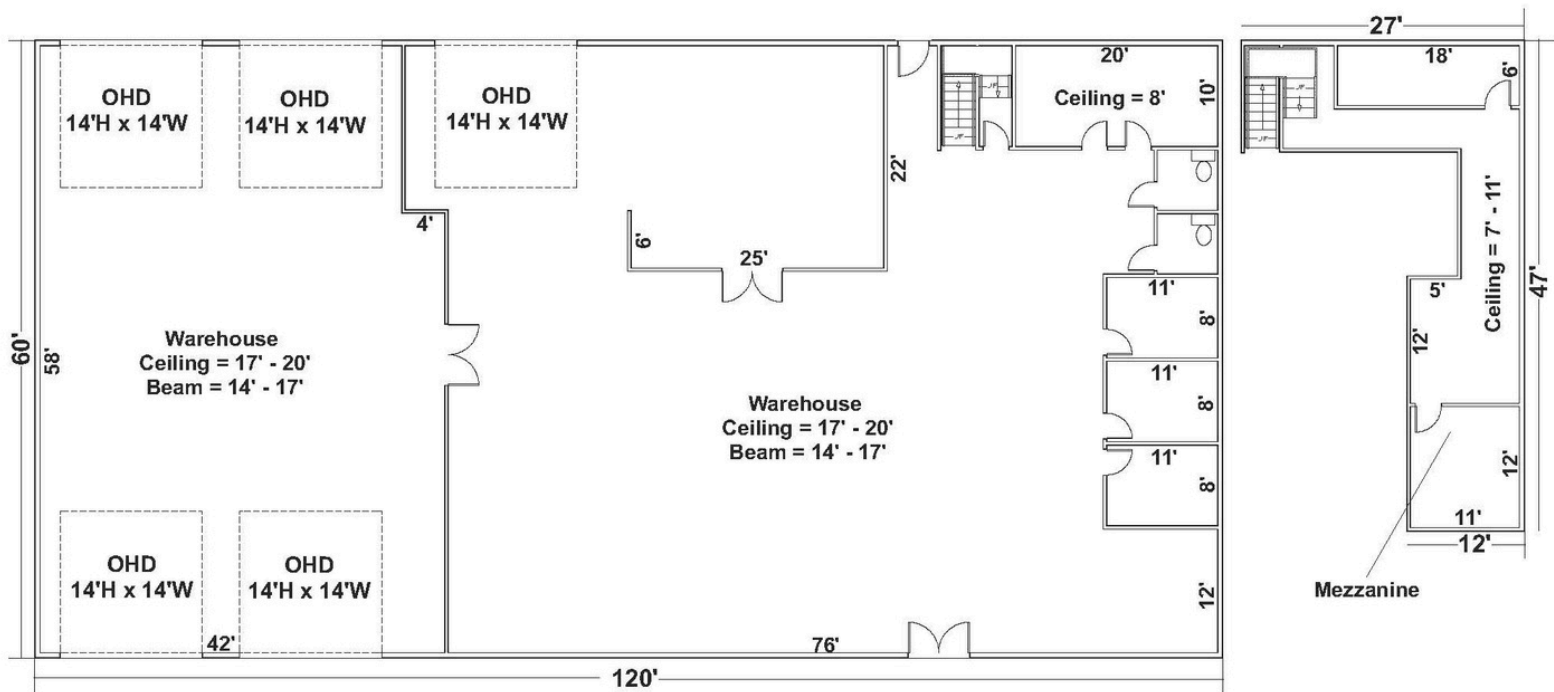

# Floor Plan

North Warehouse

Building Total = 1,600 Sq Ft

Carport = 600 Sq Ft

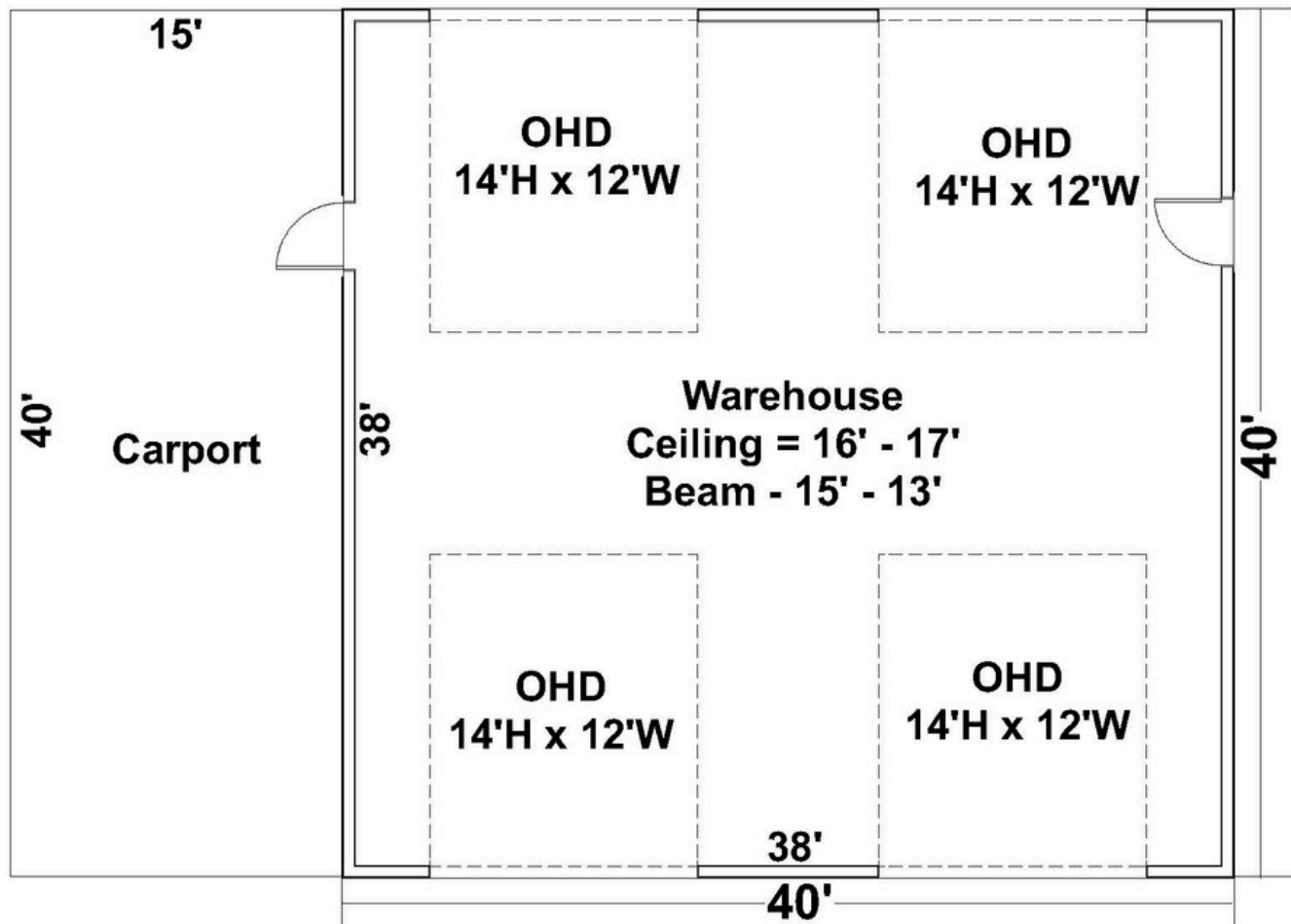

## West Haven City Zoning

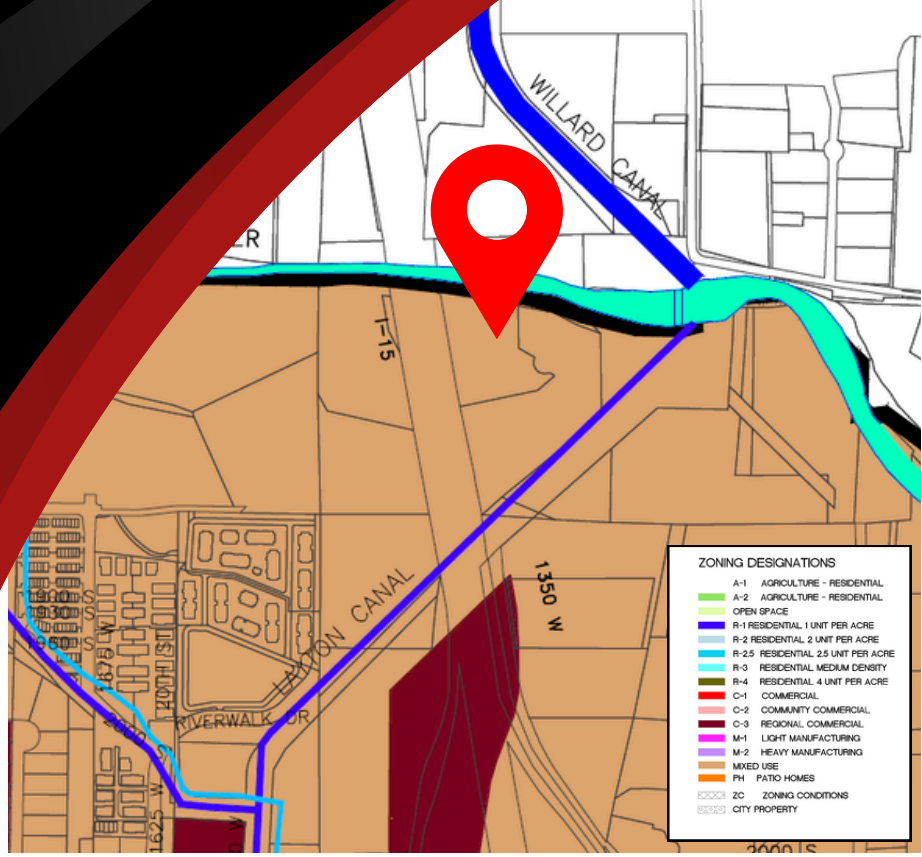

1750 S 1350 W  
WEST HAVEN, UT 84401

Ogden Nature Center



**Garrett Pierson**  
801-644-1361  
g@crestutah.com



**Aaron McCrady**  
801-953-7012  
aaroncrest@gmail.com





# Contact Us



**Garrett Pierson**

801-644-1361

g@crestutah.com



**Aaron McCrady**

801-953-7012

aaroncrest@gmail.com



[www.crestutah.com](http://www.crestutah.com)

968 Chambers St #2,

South Ogden UT 84403

801-476-9500

