

CHURCH OF JESUS CHRIST
LATTER DAY SAINTS
749/0003

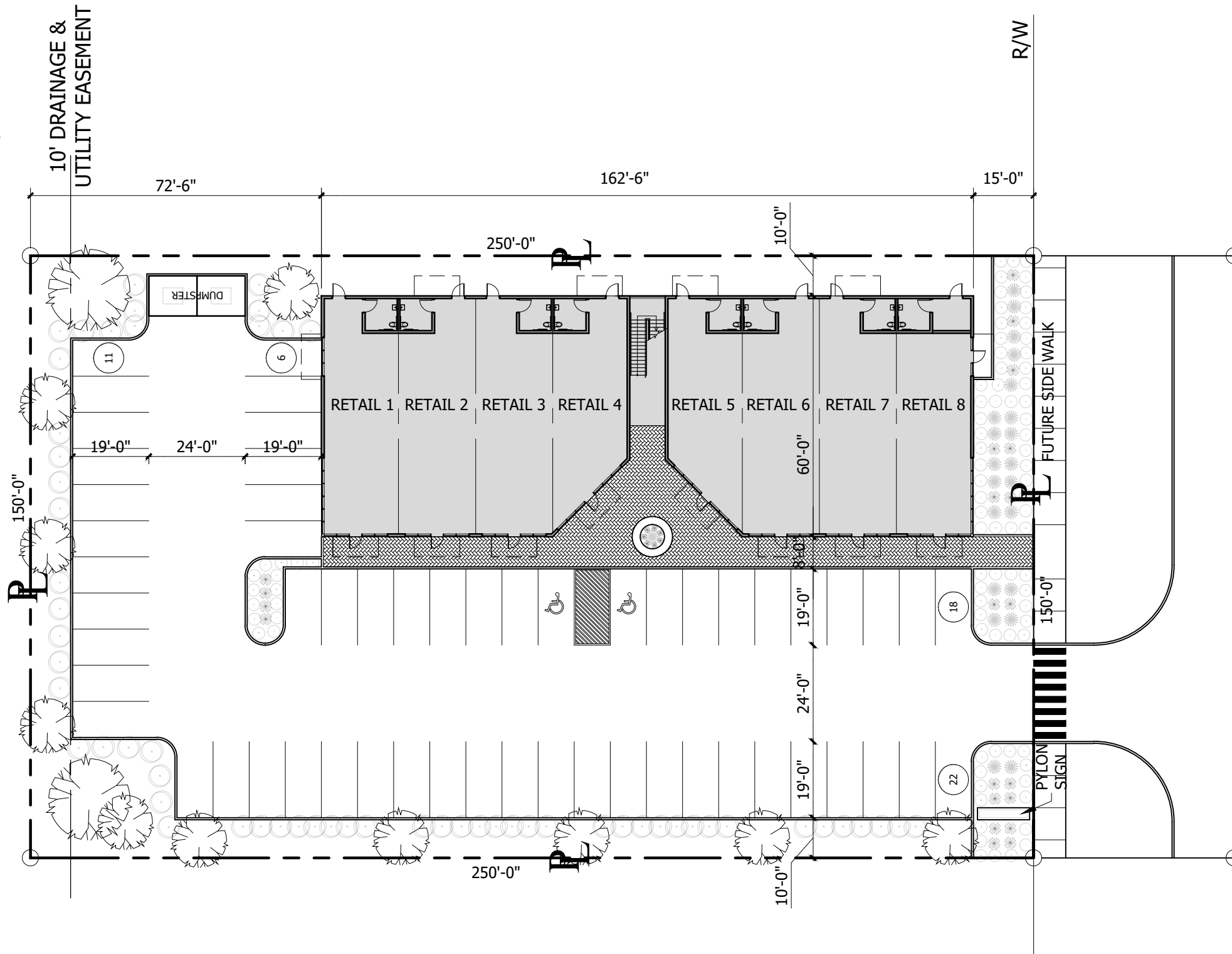

SITE DATA		
AREA	1.0 ACRE	PARKING
RETAIL AREA	9,075 SF	31
APARTMENT AREA	19,320 SF	-
(8).2 BEDS	-	12
(8).1 BEDS	-	12
BUILDING AREA	28,395 SF	-
PARKING REQUIRED	-	55
PARKING PROVIDED	-	57

US HWY 21 (CHARLOTTE HWY)
98' PUBLIC R/W

1 CONCEPTUAL SITE PLAN
1" = 30'-0"

MOORESVILLE,
NC 28117



This is conceptual site plan only. Do not purchase site until reviewed by local planner & civil engineer. Your civil engineer must verify the zoning, setbacks, utility location and sizes, green space requirements parking requirements, landscape requirements and grading for ADA accessibility with the city/county/state prior to getting started with engineering.