

CORONA | CA

9153 STELLAR COURT

TWO INDUSTRIAL BUILDING CAMPUS
±38,816 SF ON A ±1.86 ACRE LOT
MAIN BUILDING ±26,500 SF | ±12,316 SF BACK BUILDING

EXCLUSIVE LISTING AGENTS:

KEVIN FREJLACH
P: 909.912.0005
KFREJLACH@DAUMCRE.COM
CADRE #01210292

NICK CANTU
M: 714.787.9454
NCANTU@DAUMCRE.COM
CADRE #02016719

D/AQ Corp. #01129558. Maps Courtesy ©Google & ©Microsoft. Although all information is furnished regarding for sale, rental or financing is from sources deemed reliable, such information has not been verified and no express representation is made nor is any to be implied as to the accuracy thereof, and it is submitted subject to errors, omissions, changes of price, rental or other conditions, prior sale, lease or financing, or withdrawal without notice.

DAUM
COMMERCIAL REAL ESTATE SERVICES

PROPERTY HIGHLIGHTS

TWO INDUSTRIAL BUILDING CAMPUS ±38,816 SF ON ±1.86 ACRES



±38,816 SF
Space Available: ±26,600
Main Building & ±12,316
Back Building



±15,860 SF
Office / R&D
Space



28'
Warehouse
Clearance



2 DBL WIDE GL
Loading Doors with 3
Knockout Panels for
Additional Doors



1000 Amps
at 277/400 Volts
(Verify)



2 Cranes
Front Bldg Crane: 5 Tons
Back Bldg Crane: 20 Tons



Fully Fenced
Secured Concrete
Yard



Sprinklers



Wildrose
in Wildrose
Business Park

9153 STELLAR COURT
CORONA | CA

EXCLUSIVE LISTING AGENTS:

KEVIN FREJLACH
P: 909.912.0005
KFREJLACH@DAUMCRE.COM
CADRE #01210292

NICK CANTU
M: 714.787.9454
NCANTU@DAUMCRE.COM
CADRE #02016719

FLOOR PLAN

9153
STELLAR
COURT

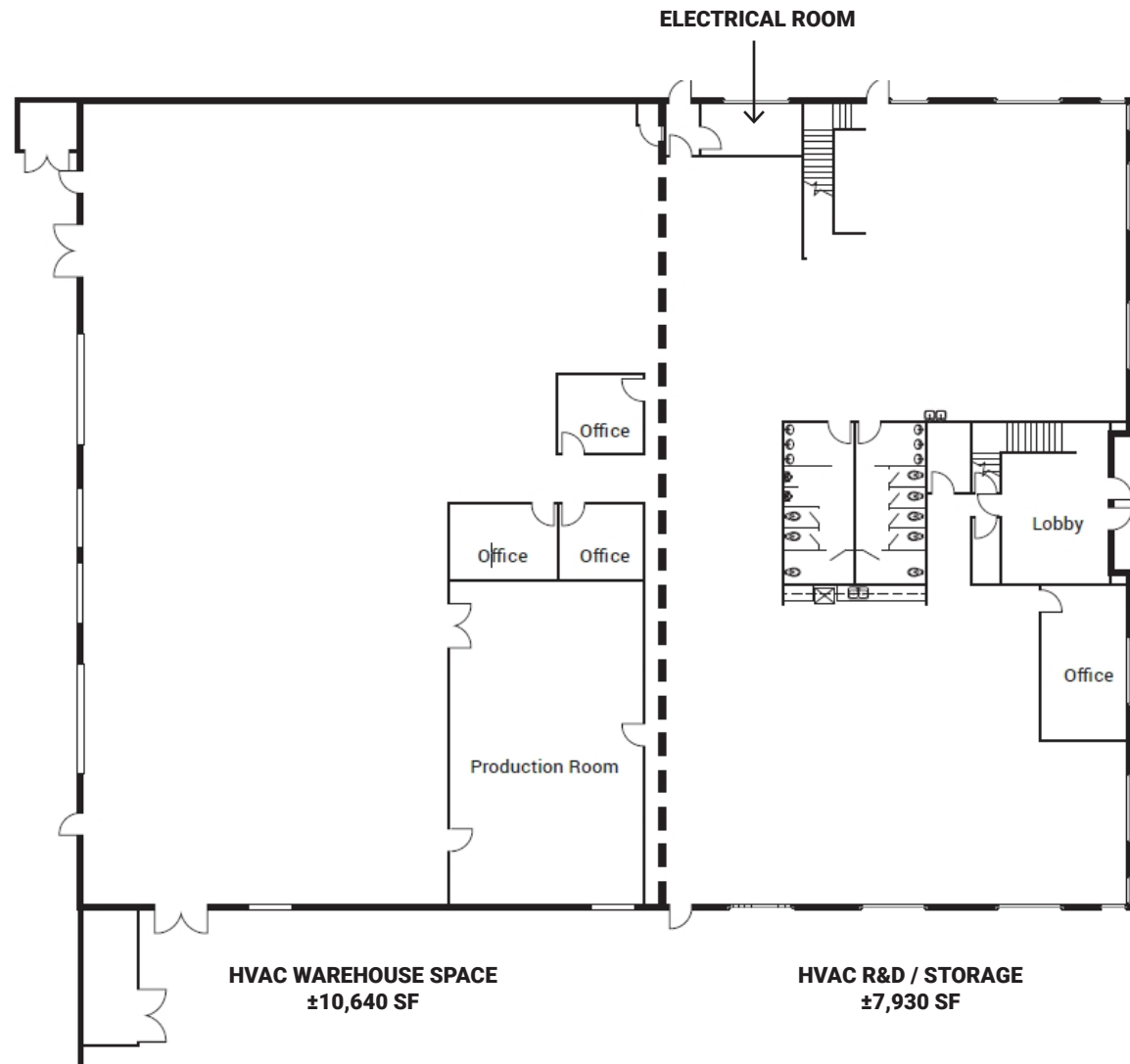

***NOT TO SCALE**

SITE PLAN

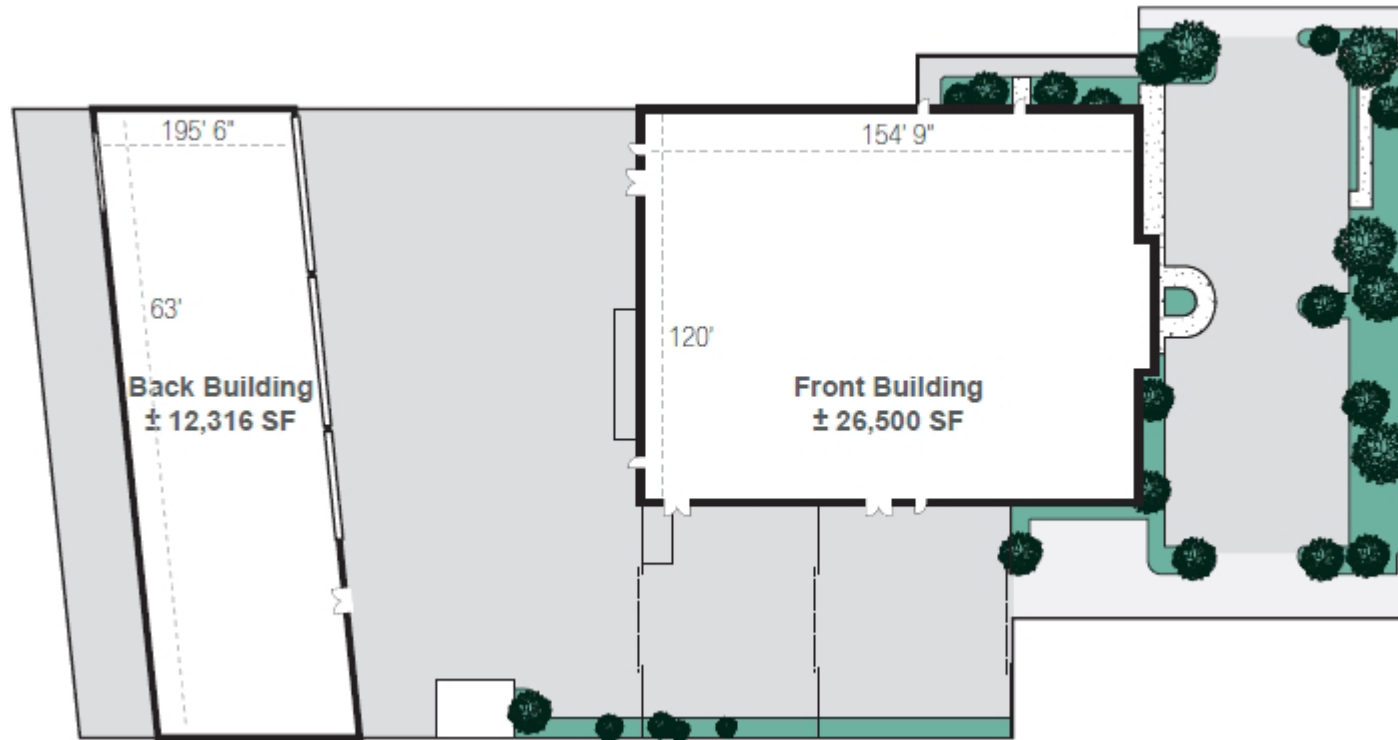

*NOT TO SCALE

9153 STELLAR COURT

CORONA | CA

EXCLUSIVE LISTING AGENTS:

KEVIN FREJLACH
P: 909.912.0005
KFREJLACH@DAUMCRE.COM
CADRE #01210292

NICK CANTU
M: 714.787.9454
NCANTU@DAUMCRE.COM
CADRE #02016719

AERIAL

9153
STELLAR
COURT

±12,316 SF
BACK BUILDING

±26,600 SF
MAIN BUILDING

STELLAR CT.

TEMESCAL CANYON RD



TWO INDUSTRIAL BUILDING CAMPUS
±38,816 SF ON ±1.86 ACRES

Google

CORONA | CA

D/AQ Corp. #01129558. Maps Courtesy ©Google & ©Microsoft. Although all information is furnished regarding for sale, rental or financing is from sources deemed reliable, such information has not been verified and no express representation is made nor is any to be implied as to the accuracy thereof, and it is submitted subject to errors, omissions, changes of price, rental or other conditions, prior sale, lease or financing, or withdrawal without notice.

DAUM
COMMERCIAL REAL ESTATE SERVICES

GALLERY



9153 STELLAR COURT

CORONA | CA

EXCLUSIVE LISTING AGENTS:

KEVIN FREJLACH
P: 909.912.0005
KFREJLACH@DAUMCRE.COM
CADRE #01210292

NICK CANTU
M: 714.787.9454
NCANTU@DAUMCRE.COM
CADRE #02016719

D/AQ Corp. #01129558. Maps Courtesy ©Google & ©Microsoft. Although all information is furnished regarding for sale, rental or financing is from sources deemed reliable, such information has not been verified and no express representation is made nor is any to be implied as to the accuracy thereof, and it is submitted subject to errors, omissions, changes of price, rental or other conditions, prior sale, lease or financing, or withdrawal without notice.

DAUM
COMMERCIAL REAL ESTATE SERVICES

AERIALS



LOCAL AMENITIES



9153 STELLAR COURT
CORONA | CA

EXCLUSIVE LISTING AGENTS:

KEVIN FREJLACH
P: 909.912.0005
KFREJLACH@DAUMCRE.COM
CADRE #01210292

NICK CANTU
M: 714.787.9454
NCANTU@DAUMCRE.COM
CADRE #02016719

D/AQ Corp. #01129558. Maps Courtesy ©Google & ©Microsoft. Although all information is furnished regarding for sale, rental or financing is from sources deemed reliable, such information has not been verified and no express representation is made nor is any to be implied as to the accuracy thereof, and it is submitted subject to errors, omissions, changes of price, rental or other conditions, prior sale, lease or financing, or withdrawal without notice.

DAUM
COMMERCIAL REAL ESTATE SERVICES

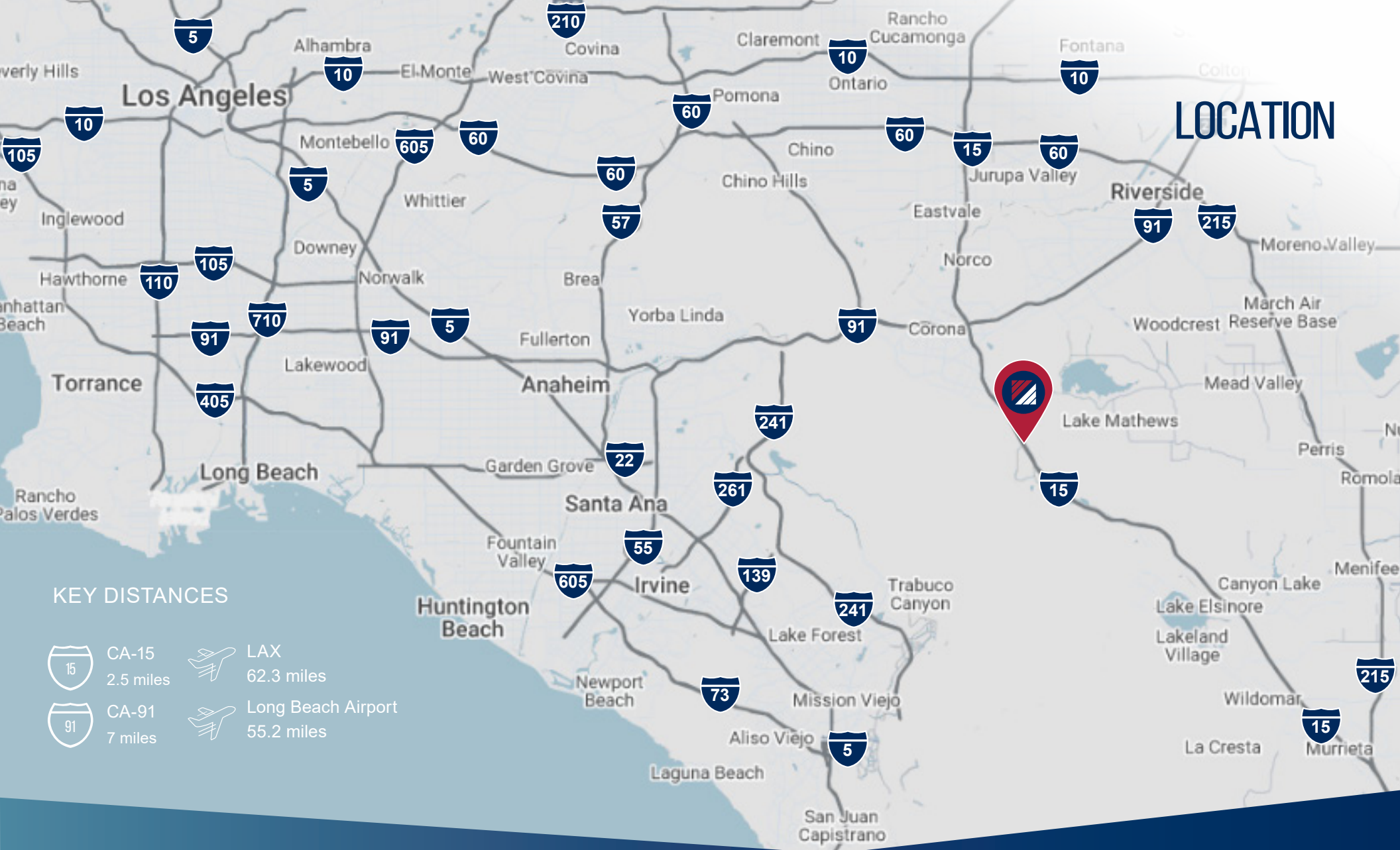

LOCATION

KEY DISTANCES



CA-15
2.5 miles



LAX
62.3 miles



CA-91
7 miles



Long Beach Airport
55.2 miles

9153 STELLAR COURT

CORONA | CA

EXCLUSIVE LISTING AGENTS:

KEVIN FREJLACH
P: 909.912.0005
KFREJLACH@DAUMCRE.COM
CADRE #01210292

NICK CANTU
M: 714.787.9454
NCANTU@DAUMCRE.COM
CADRE #02016719