

HAVANA 37

3700 HAVANA STREET



150,532 SF
INFILL DENVER
BUSINESS
PARK

NEWMARK



Mike Viehmann, SIOR
303-260-4340
mike.viehmann@nmrk.com

Michael Wafer Jr, SIOR
303-260-4407
mike.waferjr@nmrk.com

Mike Wafer, SIOR
303-260-4242
mike.wafer@nmrk.com

HAVANA 37

3700 HAVANA STREET

**ASK ABOUT BROKER
INCENTIVES!**

Centrally located business park just blocks off I-70. Fully renovated spaces include professional office and warehouse space with multiple loading options.

PROPERTY HIGHLIGHTS

| | |
|--------------|----------------------|
| Available SF | 9,615 SF & 14,336 SF |
|--------------|----------------------|

| | |
|------------|------------|
| Total Size | 150,532 SF |
|------------|------------|

| | |
|---------------------|---|
| Number of Buildings | 3 |
|---------------------|---|

| | |
|-------------|-----------------|
| City/County | Denver / Denver |
|-------------|-----------------|

| | |
|------------|------|
| Year Built | 1974 |
|------------|------|

| | |
|--------|-----|
| Zoning | I-2 |
|--------|-----|

| | |
|---------|----------------------|
| Loading | Dock High & Drive-In |
|---------|----------------------|

| | |
|------------|--------------|
| Sprinklers | General Duty |
|------------|--------------|

| | |
|---------|------------|
| Parking | 2:1,000 SF |
|---------|------------|



HAVANA 37

3700 HAVANA STREET

Available Space

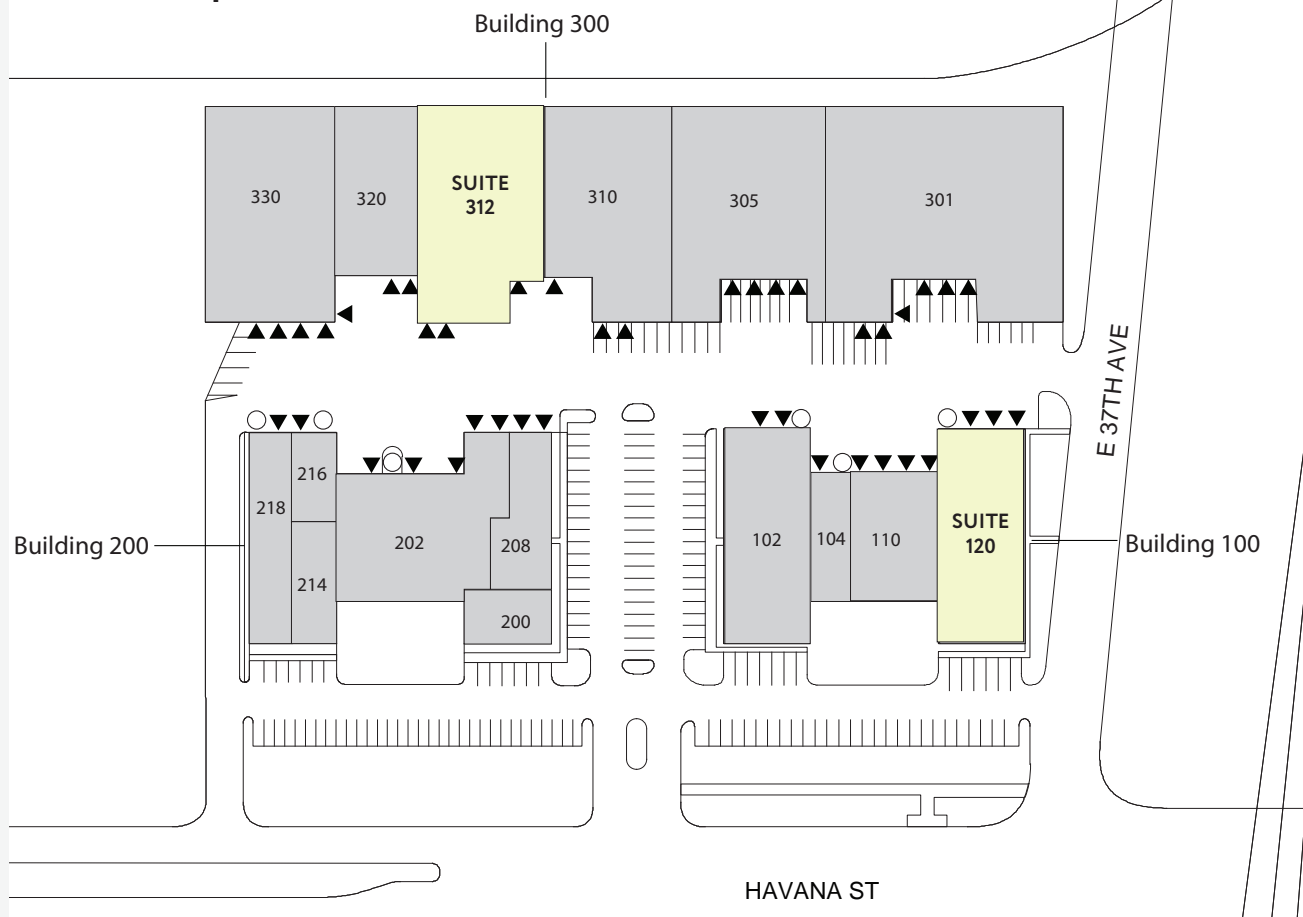

| Suite | Total SF | Office SF | Clear Height | Loading | Available | Lease Rate | Op/Ex |
|-------|-----------|-----------|--------------|---------------|-------------|------------|-----------|
| 120 | 9,615 SF | 1,305 SF | 14' | 3 Docks, 1 DI | Immediately | \$9.25/SF | \$4.93/SF |
| 312 | 14,336 SF | 1,026 SF | 18' | 4 Docks | Immediately | \$8.25/SF | \$4.93/SF |

Power: 200 Amps 480 Volts, 3 Phase

** Additional parking available for Suite 120

Power: 200 Amps 208 Volts, 3 Phase



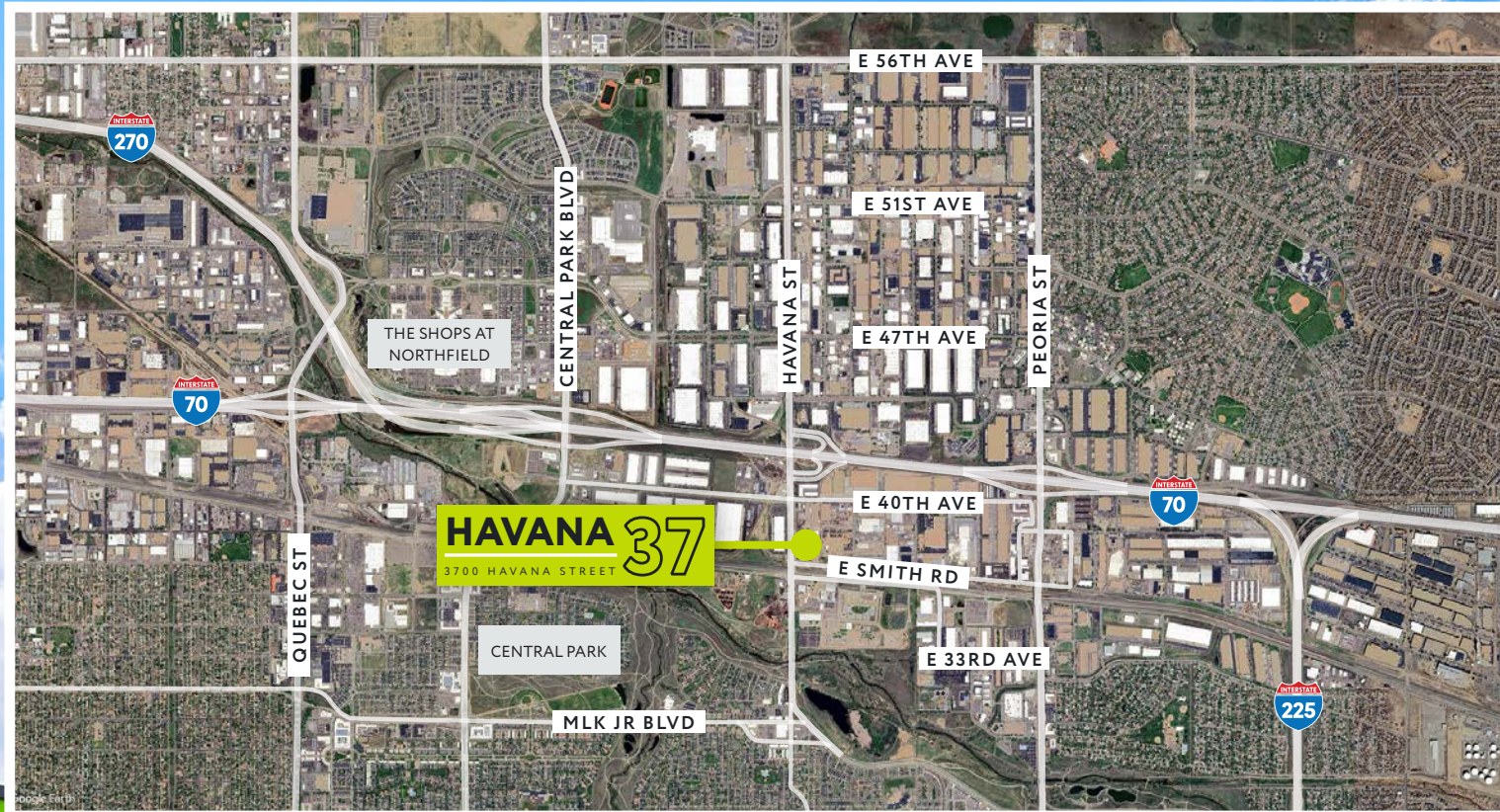

Mike Viehmann, SIOR
303-260-4340
mike.viehmann@nmrk.com

Michael Wafer Jr, SIOR
303-260-4407
mike.waferjr@nmrk.com

Mike Wafer, SIOR
303-260-4242
mike.wafer@nmrk.com

NEWMARK



The information contained herein has been obtained from sources deemed reliable but has not been verified and no guarantee, warranty or representation, either express or implied, is made with respect to such information. Terms of sale or lease and availability are subject to change or withdrawal without notice.

HAVANA 37

3700 HAVANA STREET

150,532 SF INFILL DENVER
BUSINESS PARK

| | |
|-----------------|----------|
| Building | 100 |
| Suite | 120 |
| Total Available | 9,615 SF |
| Office Size | 1,305 |
| Clear Height | 14' |
| Dock Doors | 3 |
| Drive-In Doors | 1 |

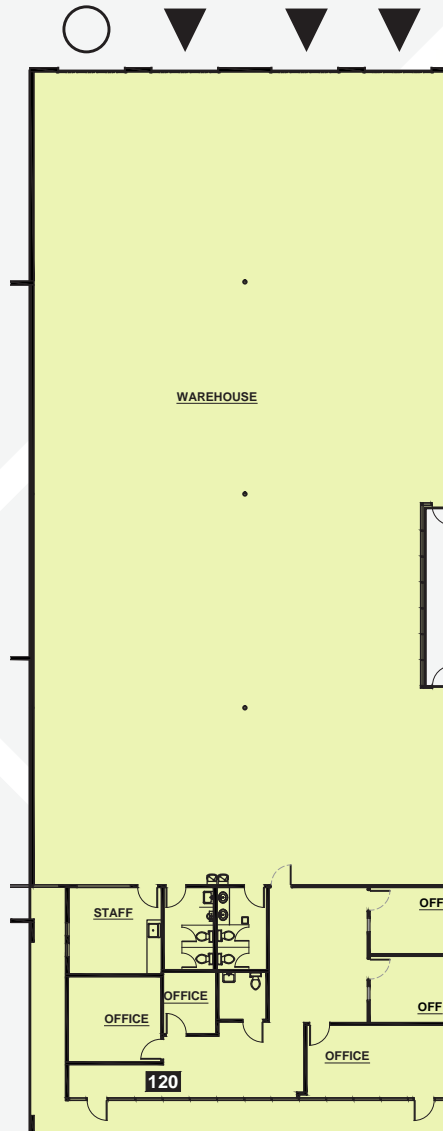

NEWMARK



Mike Viehmann, SIOR
303-260-4340
mike.viehmann@nmrk.com

Michael Wafer Jr, SIOR
303-260-4407
mike.waferjr@nmrk.com

Mike Wafer, SIOR
303-260-4242
mike.wafer@nmrk.com

The information contained herein has been obtained from sources deemed reliable but has not been verified and no guarantee, warranty or representation, either express or implied, is made with respect to such information. Terms of sale or lease and availability are subject to change or withdrawal without notice.

HAVANA 37

3700 HAVANA STREET

150,532 SF INFILL DENVER
BUSINESS PARK

| | |
|-----------------|-----------|
| Building | 300 |
| Suite | 312 |
| Total Available | 14,336 SF |
| Office Size | 1,026 SF |
| Clear Height | 18' - 20' |
| Dock Doors | 4 |
| Rail Doors | 2 |

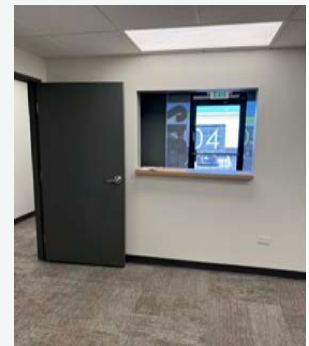
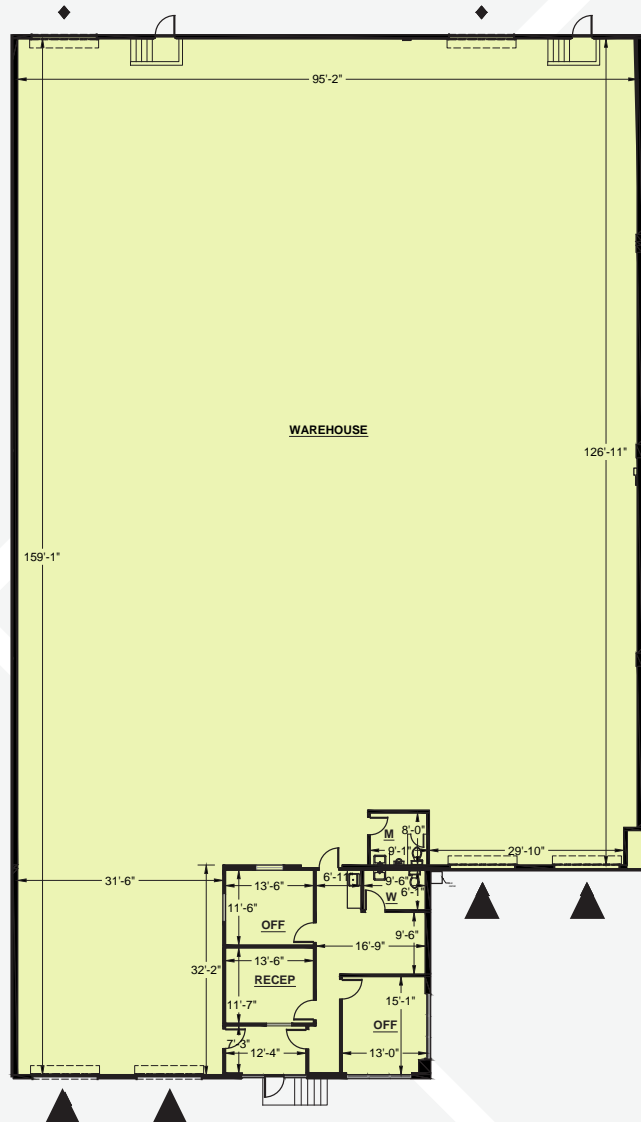

NEWMARK



Mike Viehmann, SIOR
303-260-4340
mike.viehmann@nrmk.com

Michael Wafer Jr, SIOR
303-260-4407
mike.waferjr@nrmk.com

Mike Wafer, SIOR
303-260-4242
mike.wafer@nrmk.com

The information contained herein has been obtained from sources deemed reliable but has not been verified and no guarantee, warranty or representation, either express or implied, is made with respect to such information. Terms of sale or lease and availability are subject to change or withdrawal without notice.