



## East Tampa Warehouse Available May 2026

- 156,311 sf available
- 9,109 sf office
- Cross dock
- 34 dock high doors
- 2 ramps with 12' x 16' doors
- 19 trailer parking spaces
- Monument signage
- Ideal location in Madison Industrial Park

### Get more information

**Clay Witherspoon**

Managing Director | Principal

+1 813 444 0626

[clay.witherspoon@avisonyoung.com](mailto:clay.witherspoon@avisonyoung.com)**Laurie Hynes**

Sr. Client Services Coordinator

+1 813 444 0621

[laurie.hynes@avisonyoung.com](mailto:laurie.hynes@avisonyoung.com)[avisonyoung.com](http://avisonyoung.com)

# Plan and Specifications

**For Lease**  
Tampa Distribution Center | Madison  
4406 Madison Industrial Lane, Tampa, FL 33619

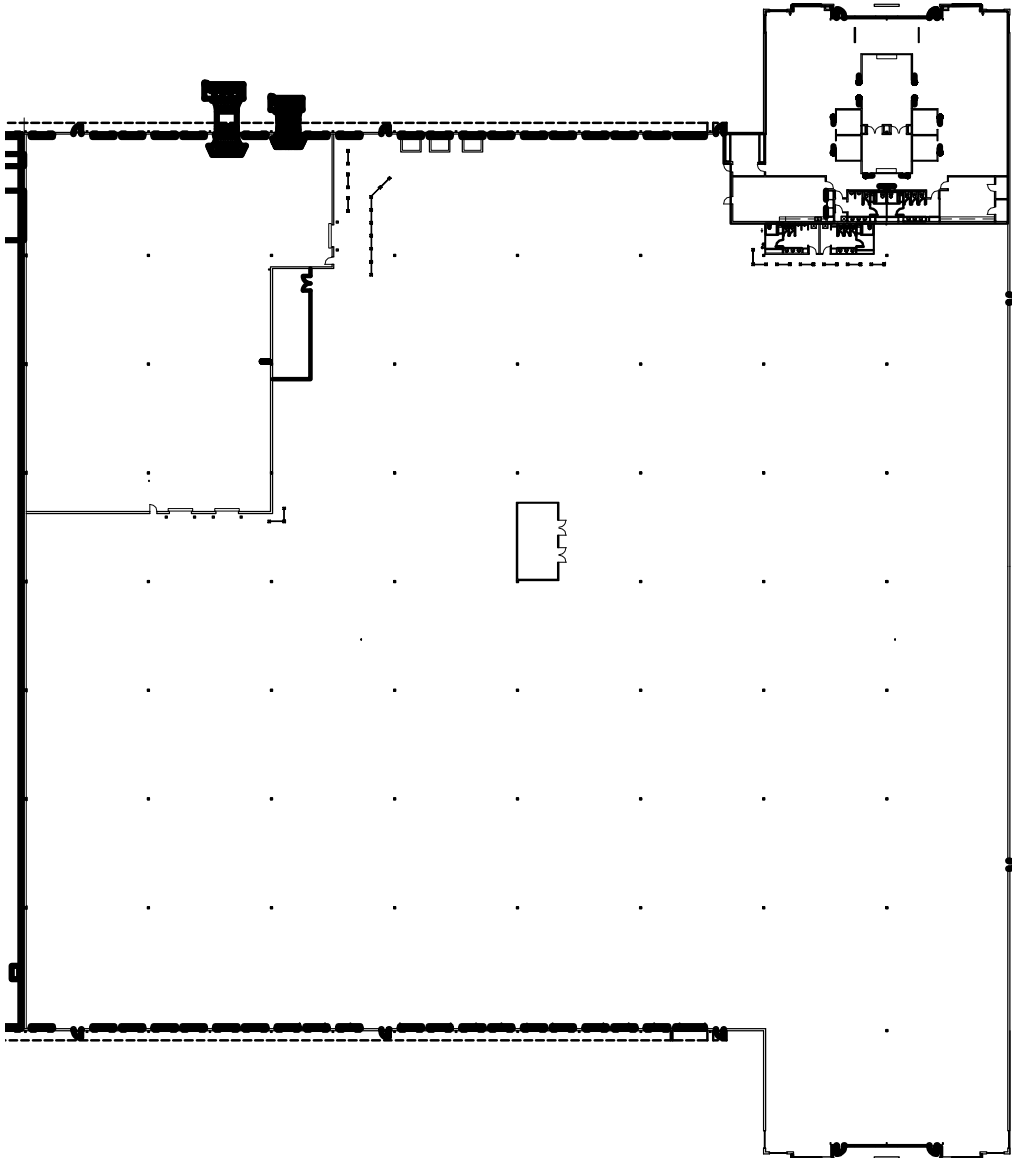

Space depth	365'
Clear height	30'
Column spacing	50' x 44' 2"
Loading	Cross Dock
Truck Court	138'
Trailer Parking	19 spaces
Doors	34 dock high 2 ramps
Fire Sprinkler	ESFR

**Get more  
information**

**Clay Witherspoon**  
Managing Director | Principal  
+1 813 444 0626

**Laurie Hynes**  
Sr. Client Services Coordinator  
+1 813 444 0621





## Location

## For Lease

Tampa Distribution Center | Madison  
4406 Madison Industrial Lane, Tampa, FL 33619



## Get more information

**Clay Witherspoon**  
Managing Director | Principal  
+1 813 444 0626

**Laurie Hynes**  
Sr. Client Services Coordinator  
+1 813 444 0621

**AVISON  
YOUNG**