

# 46,204 SF

Industrial Space For Lease



## Prologis Schiller Park



4136 United Parkway, Suite A  
Schiller Park, IL 60176 USA



### LOCATION

- Close proximity to O'Hare International Airport and the City of Chicago
- Excellent access to I-294, I-290 and I-90
- 19 miles to downtown Chicago

### FACILITY

- 101,707 SF building
- 46,204 SF available (expandable to 101,707 SF)
- 3,800 SF office
- 22' clear height
- 6 interior docks
- 2 drive in doors
- 33' x 36'4" column spacing
- 1200 amps at 277/480 volts
- 100 car parking stalls (entire building)

### ADVANTAGES AND AMENITIES

- Approved 6B tax status in place
- Institutionally owned and managed
- Easily accessible to strong labor pool and public transportation

**Prologis Essentials: your single-source service for efficient move-in and operations at [prologisessentials.com](https://www.prologisessentials.com)**

# 46,204 SF

Industrial Space For Lease



## Prologis Schiller Park

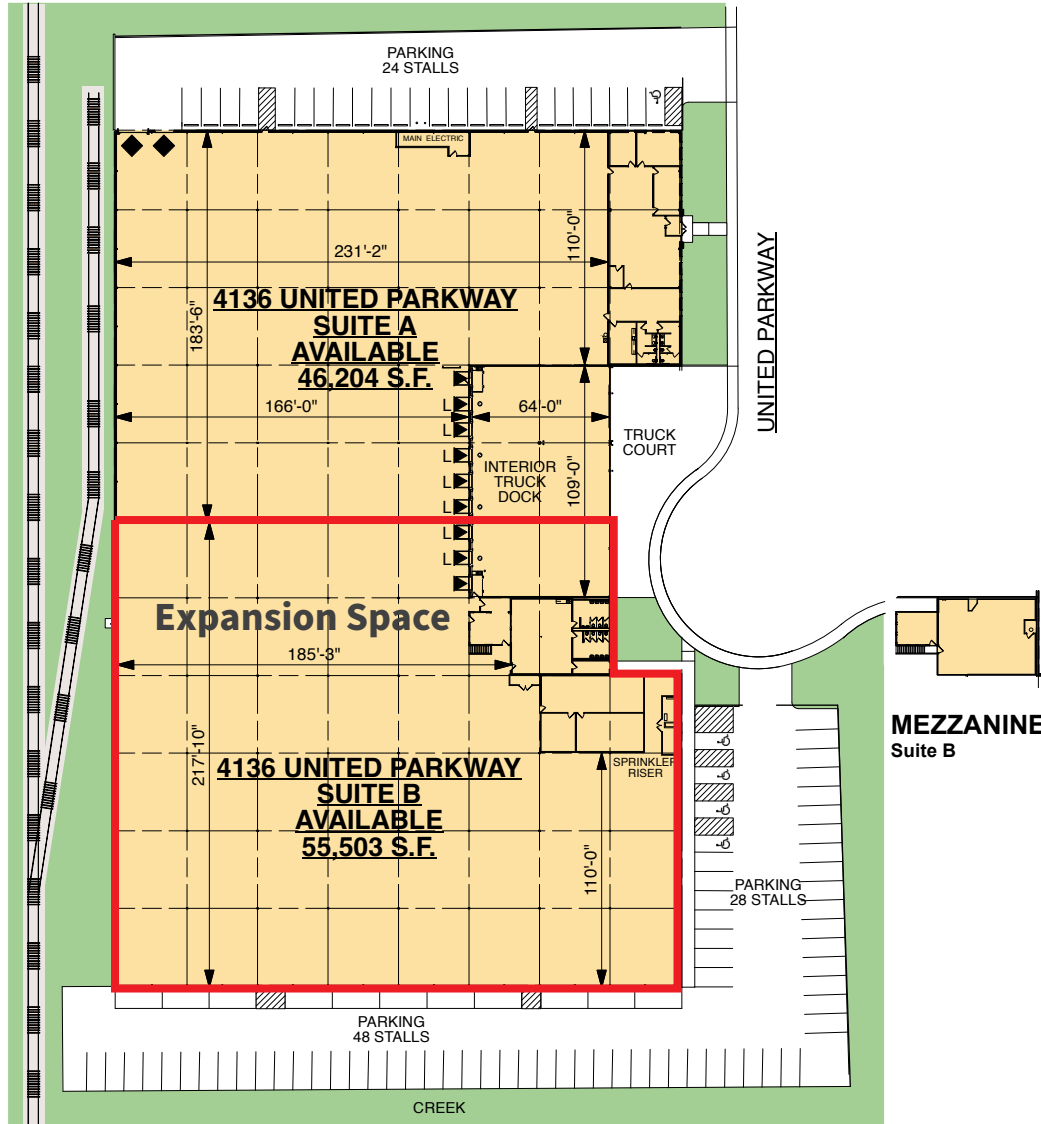

**CBRE**  
Matt Cowie  
matt.cowie@cbre.com  
ph +1 312 334 7203  
cell +1 312 735 6510  
321 N Clark Street  
Suite 3400  
Chicago, IL 60654 USA

**CBRE**  
Larry Goldwasser, SIOR  
larry.goldwasser@cbre.com  
ph +1 312 334 7201  
cell +1 312 953 5744  
321 N Clark Street  
Suite 3400  
Chicago, IL 60654 USA

**CBRE**  
John Marks  
john.marks@cbre.com  
ph +1 312 334 7204  
cell +1 773 814 0802  
321 N Clark Street  
Suite 3400  
Chicago, IL 60654 USA

**Prologis**  
Maggie Tullier  
mtullier@prologis.com  
ph +1 847 292 3943  
cell +1 847 420 4145  
6250 N River Road  
Suite 1100  
Rosemont, IL 60018 USA

**Prologis Essentials: your single-source service for efficient move-in and operations at [prologisessentials.com](http://prologisessentials.com)**

No warranty or representation, expressed or implied, is made as to the accuracy of the information contained herein, and same is submitted subject to error and omissions.

# 46,204 SF

Industrial Space For Lease



## Prologis Schiller Park

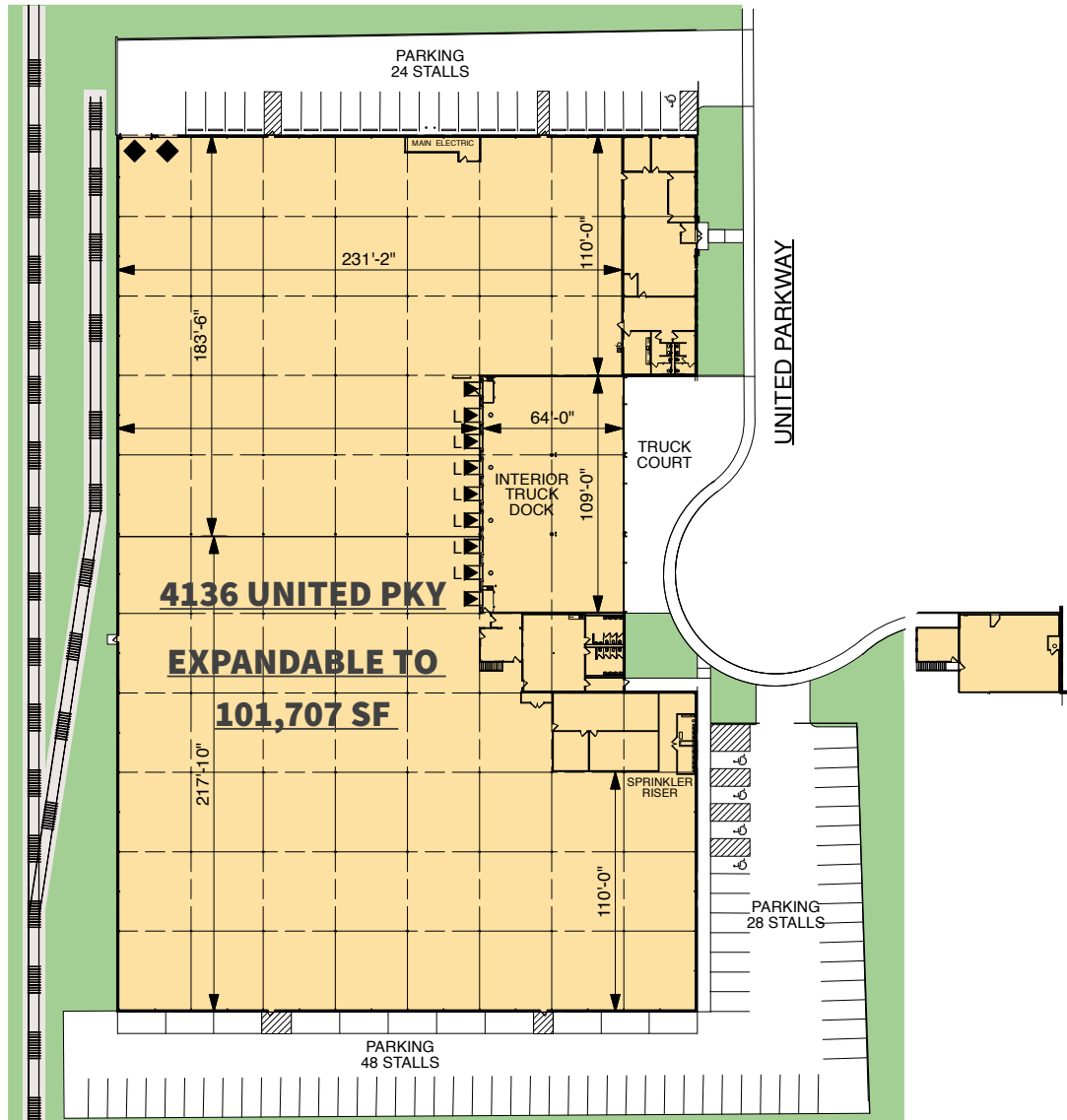

## CBRE

**CBRE**  
Matt Cowie  
matt.cowie@cbre.com  
ph +1 312 334 7203  
cell +1 312 735 6510  
321 N Clark Street  
Suite 3400  
Chicago, IL 60654 USA

**CBRE**  
Larry Goldwasser, SIOR  
larry.goldwasser@cbre.com  
ph +1 312 334 7201  
cell +1 312 953 5744  
321 N Clark Street  
Suite 3400  
Chicago, IL 60654 USA

**CBRE**  
John Marks  
john.marks@cbre.com  
ph +1 312 334 7204  
cell +1 773 814 0802  
321 N Clark Street  
Suite 3400  
Chicago, IL 60654 USA

**Prologis**  
Maggie Tullier  
mtullier@prologis.com  
ph +1 847 292 3943  
cell +1 847 420 4145  
6250 N River Road  
Suite 1100  
Rosemont, IL 60018 USA

**Prologis Essentials: your single-source service for efficient move-in and operations at [prologisessentials.com](http://prologisessentials.com)**

No warranty or representation, expressed or implied, is made as to the accuracy of the information contained herein, and same is submitted subject to error and omissions.