



Proposed Uses

- 1 - 1.82 ac - 180 Seat Restaurant
- 2 - 2.05 ac - 3-Story 60 Room Hotel
- 3 - .80 ac - 80 Seat Restaurant/Retail
- 4 - SOLD
- 5 - SOLD

Commercial Lot (Lot 2)

10300 Blackwell Rd SE

For Sale | Belville, NC

Overview

Status:	For Sale
Property Type:	Land
Size:	2.05 Acres
Zoning:	CBD
County:	Brunswick
Asking Price:	\$1,025,000

Great site suitable for retail and hospitality.

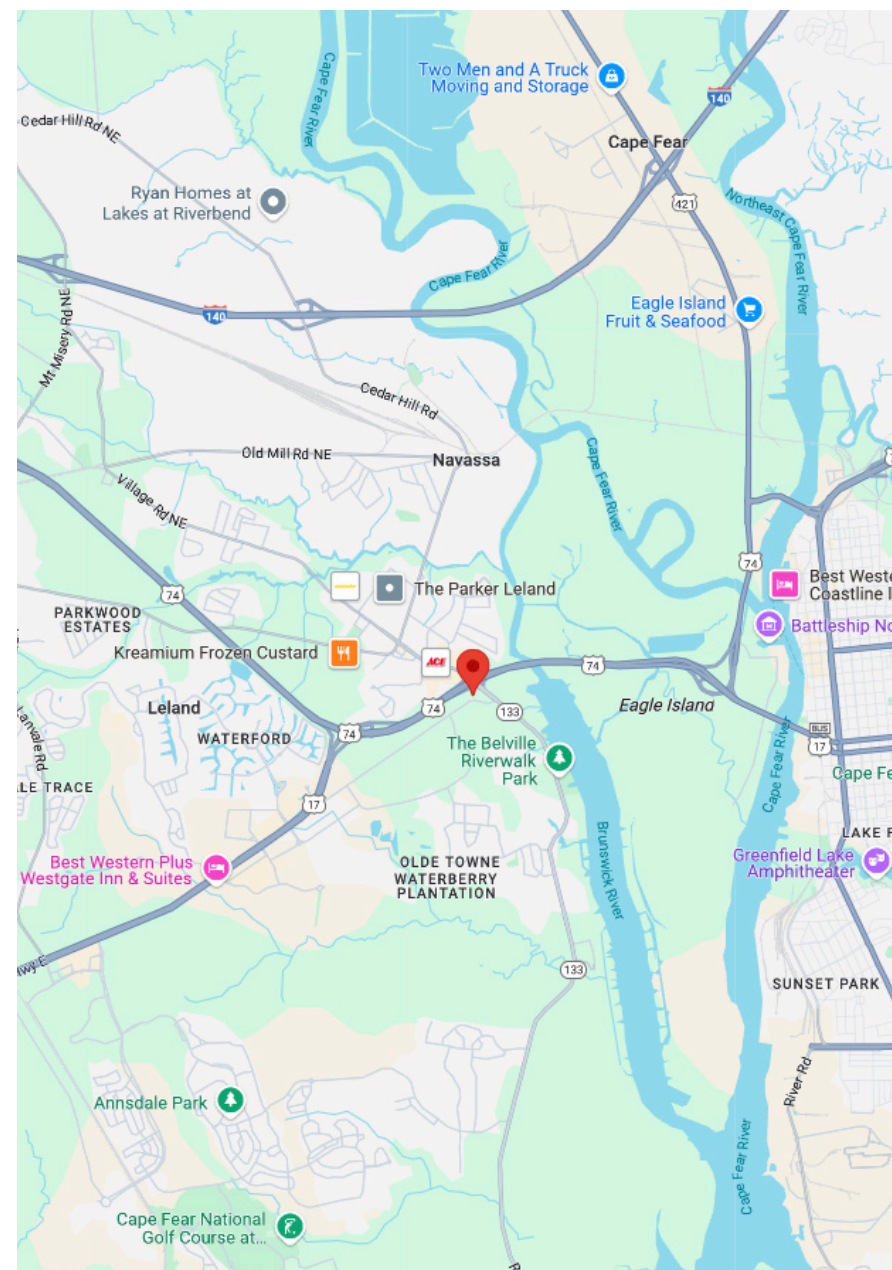

Property Information



Asking Price: \$1,025,000
List Price/Acre: \$500,000
Total Space: 2.05 Acres
Listing ID: 28006452
Status: For Sale
Property Type: Land
Investment: No

Available: Now
Water & Sewer: Yes
Zoning: CBD
County: Brunswick
Parcels: 038GA005
Nearest MSA: Myrtle Beach-Conway
Occupancy Type: Single Tenant

Demographics

	POPULATION	HOUSEHOLDS	AVG. HH INCOME	EMPLOLYMENT
1 MILE	2,117	5,368	\$70K	990
3 MILES	14,593	13,860	\$60K	6,687
5 MILES	46,781	29,342	\$46K	20,716

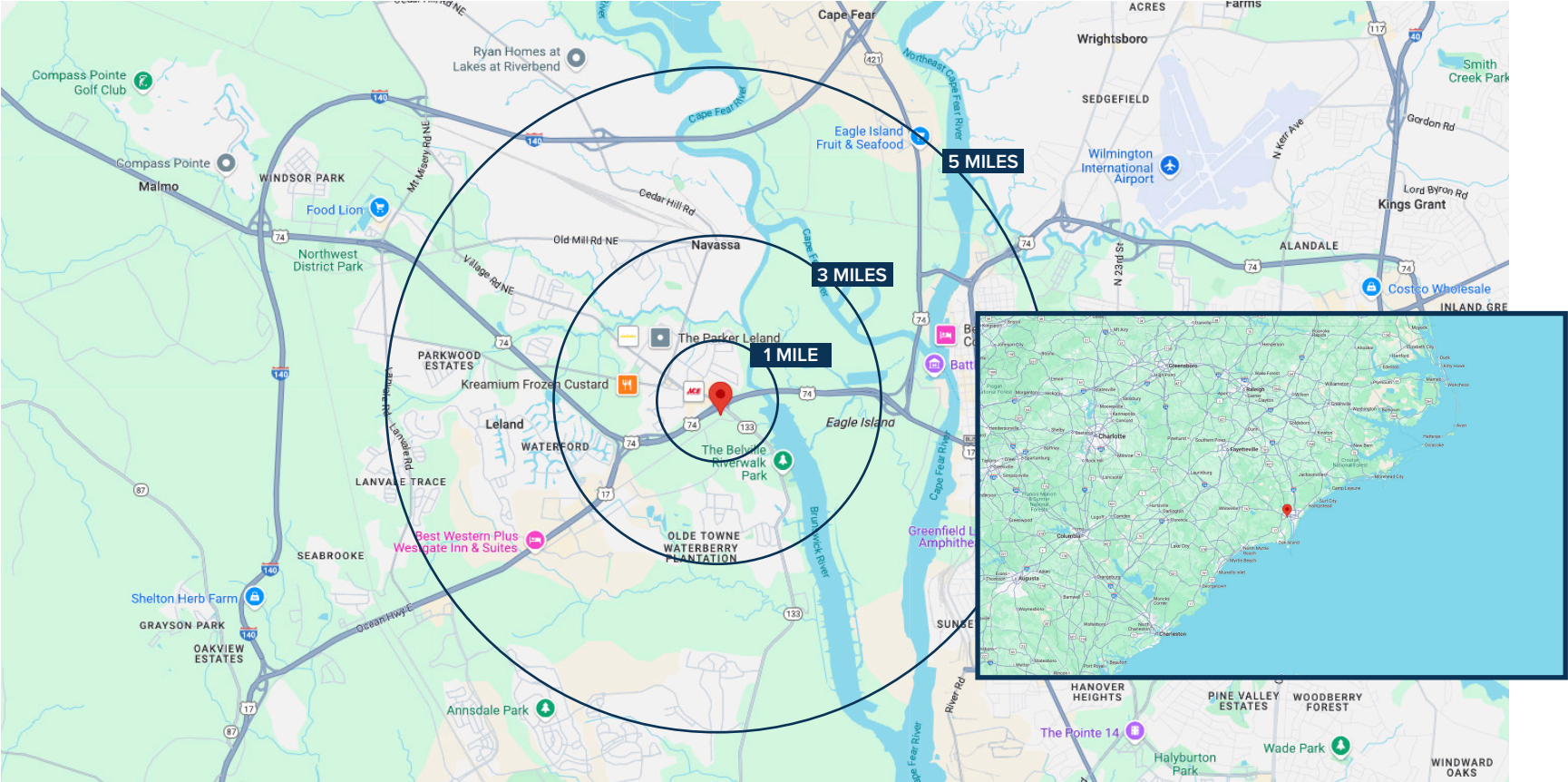

Submarket Overview





Aerial



Aerial



Site Plans

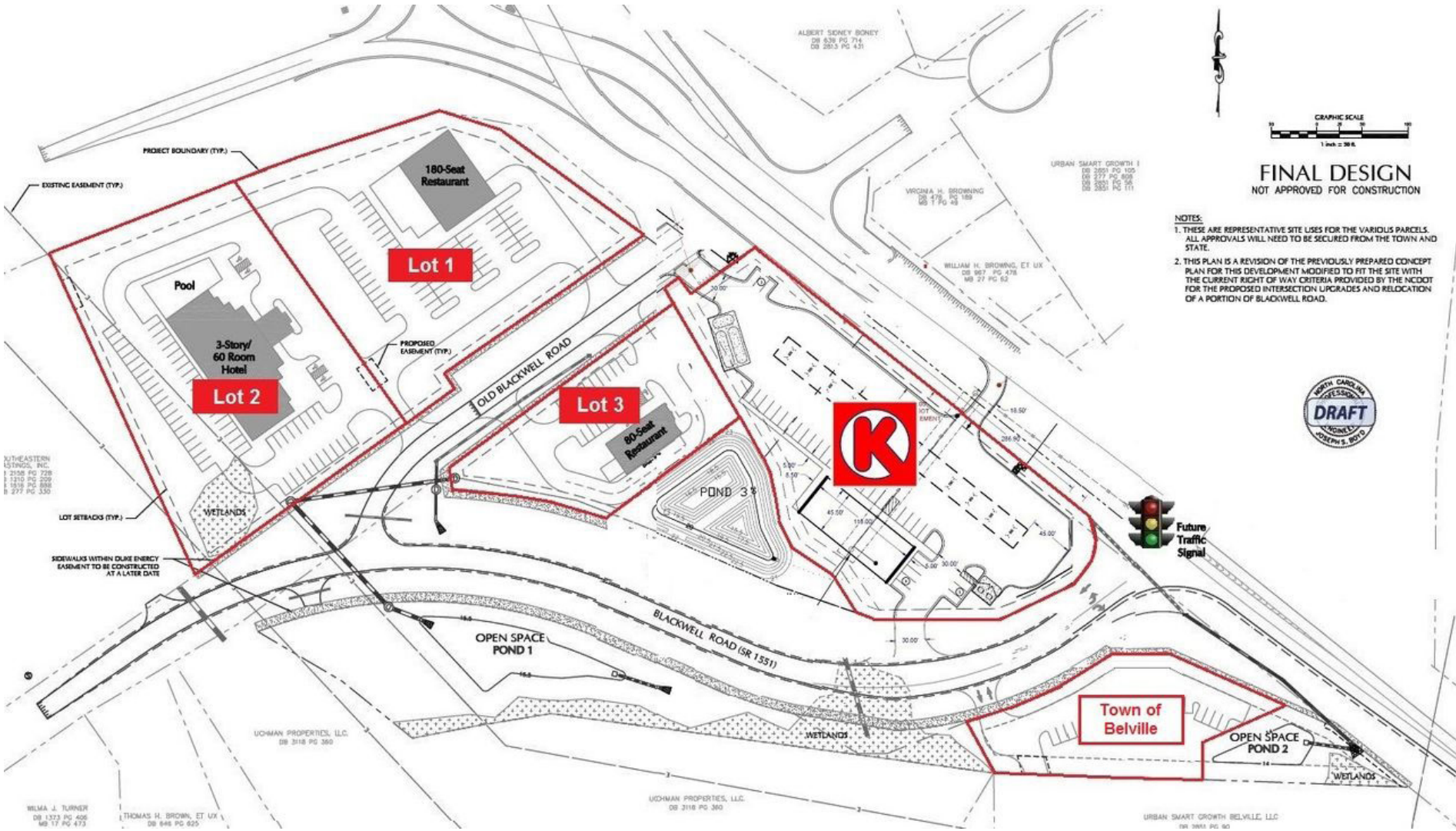



Local Information



Belville, NC

Belville, North Carolina, is a small but steadily growing town in Brunswick County, located just minutes from downtown Wilmington and neighboring Leland. Positioned along the Brunswick River, Belville offers a peaceful, scenic setting with convenient access to urban amenities and coastal attractions. One of the town's highlights is the Belville Riverwalk Park, which features a scenic boardwalk, fishing areas, picnic spots, and walking trails that connect visitors to the natural beauty of the riverfront.

Though quieter than nearby towns, Belville is part of a rapidly developing area and benefits from its close proximity to major shopping centers, restaurants, and highways. It's an appealing option for those who want to enjoy a slower pace while staying close to everything southeastern North Carolina has to offer. The combination of natural surroundings, community-focused development, and easy access to Wilmington makes Belville a unique and appealing place to call home.

Contact Info

Office

2524 Independence Blvd.
Wilmington NC 28412

910-791-0400

www.mwmrealestate.com

Listing Agent

Jack Kilbourne

910-262-4407

jack@mwmrealestate.com



All information furnished is from sources deemed reliable, but no warranty or representation is made as to the accuracy thereof and same is submitted subject to errors omissions, change of price, rental or other conditions, without notice. No liability of any kind is to imposed on the broker herein.