

For Lease | ±5,868 SF Industrial Building

# 520 Harbor Boulevard Belmont, California



## Contact Us

### Sequoia Realty Services

**Ryan Pegnim**  
Principal  
+1 650 346 9820  
rqp@seq-rs.com  
Lic. 01478696

**Anthony Kamm**  
Principal  
+1 650 888 3858  
ak@seq-rs.com  
Lic. 01783456

### CBRE

**Michael Domanico**  
Senior Vice President  
+1 650 577 2942  
michael.domanico@cbre.com  
Lic. 01944774

**Gio Haughton**  
Senior Associate  
+1 650 387 1197  
gio.haughton@cbre.com  
Lic. 02107010



**CBRE**

520 Harbor Boulevard  
Belmont, California 94002

For Lease

# Property Highlights

- 1 Roll-up Door
- Heavy Power, 3 phase, 1200 Amps
- Parking
- High Ceiling, Clear Span Warehouse
- Small Yard
- 0.5 Mile from CalTrain
- Easy Access to Highway 101 & El Camino Real
- Asking Rate: \$2.50 NNN



520 Harbor Boulevard  
Belmont, California 94002

For Lease

# Floor Plan

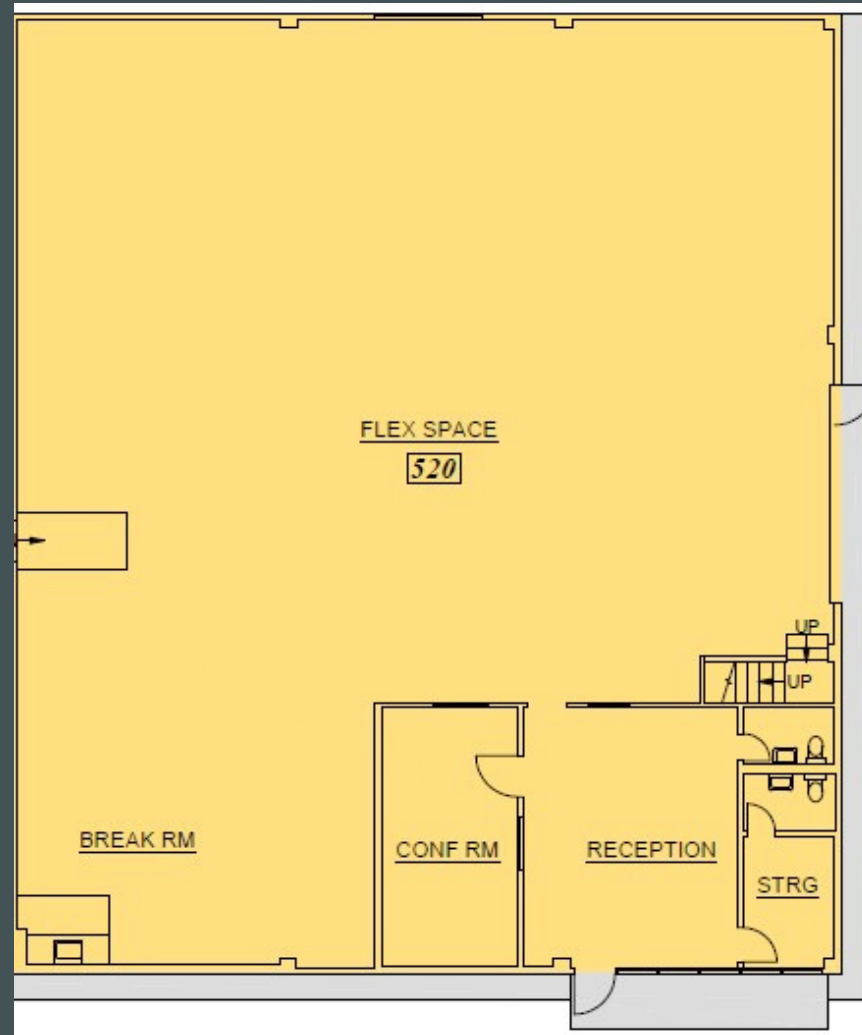

© 2024 CBRE, Inc. All rights reserved. This information has been obtained from sources believed reliable but has not been verified for accuracy or completeness. CBRE, Inc. makes no guarantee, representation or warranty and accepts no responsibility or liability as to the accuracy, completeness, or reliability of the information contained herein. You should conduct a careful, independent investigation of the property and verify all information. Any reliance on this information is solely at your own risk. CBRE and the CBRE logo are service marks of CBRE, Inc. All other marks displayed on this document are the property of their respective owners, and the use of such marks does not imply any affiliation with or endorsement of CBRE. Photos herein are the property of their respective owners. Use of these images without the express written consent of the owner is prohibited.

# Location Map

520 Harbor Boulevard  
Belmont, California 94002

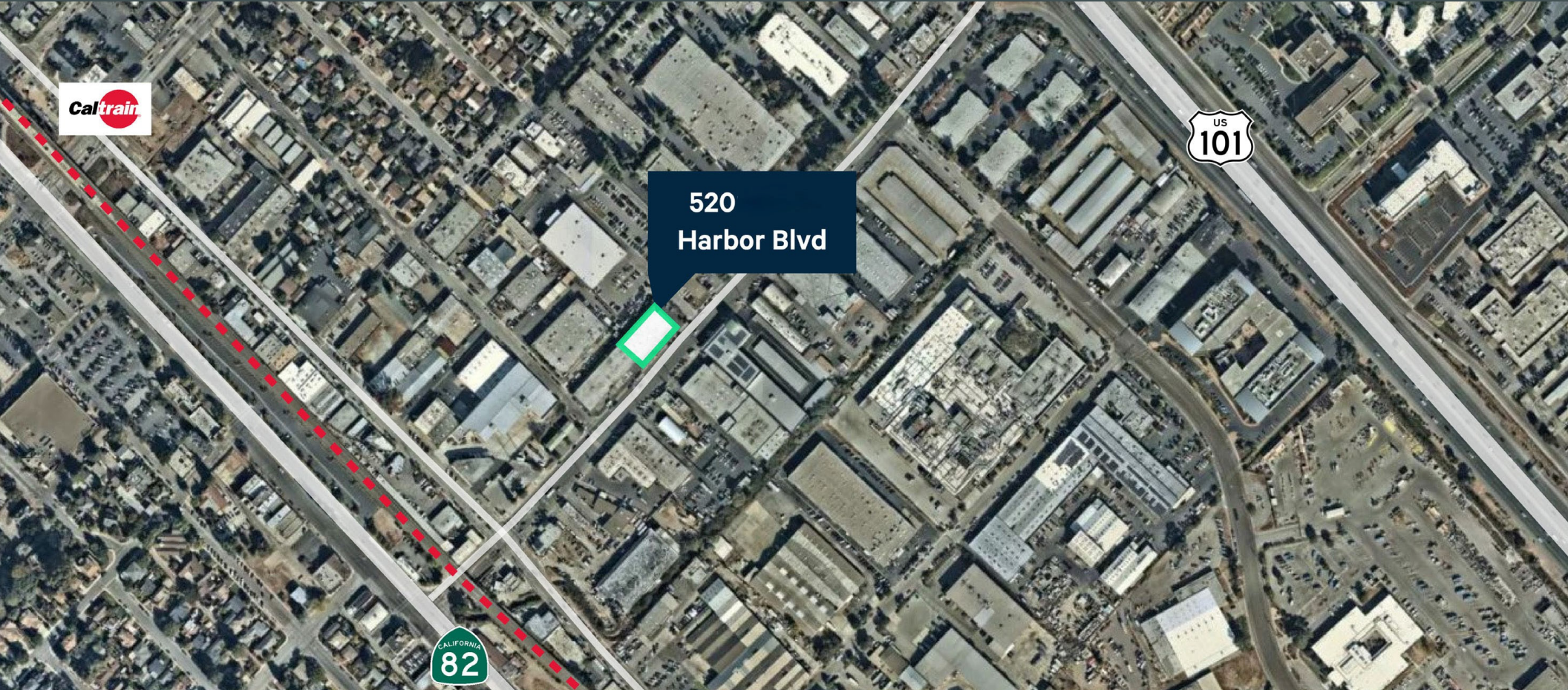

## Contact Us

### Sequoia Realty Services

**Ryan Pegnim**  
Principal  
+1 650 346 9820  
rcp@seq-rs.com  
Lic. 01478696

**Anthony Kamm**  
Principal  
+1 650 888 3858  
ak@seq-rs.com  
Lic. 01783456

### CBRE

**Michael Domanico**  
Senior Vice President  
+1 650 577 2942  
michael.domanico@cbre.com  
Lic. 01944774

**Gio Haughton**  
Senior Associate  
+1 650 387 1197  
gio.haughton@cbre.com  
Lic. 02107010



**CBRE**