



**370 GREAT
SOUTHWEST
PARKWAY, SUITE G**
ATLANTA, GA 30336

For Lease
5,054 +/- SF
Office / Warehouse Space

WILSON COVINGTON, SIOR
Senior Vice President
404.942.2073
wcovington@kingindustrial.com

King *Industrial
Realty, Inc.*

Industrial • Commercial • Investment
404.942.2000 | kingindustrial.com

FOR LEASE
5,054+/- SF
OFFICE / WAREHOUSE
SPACE

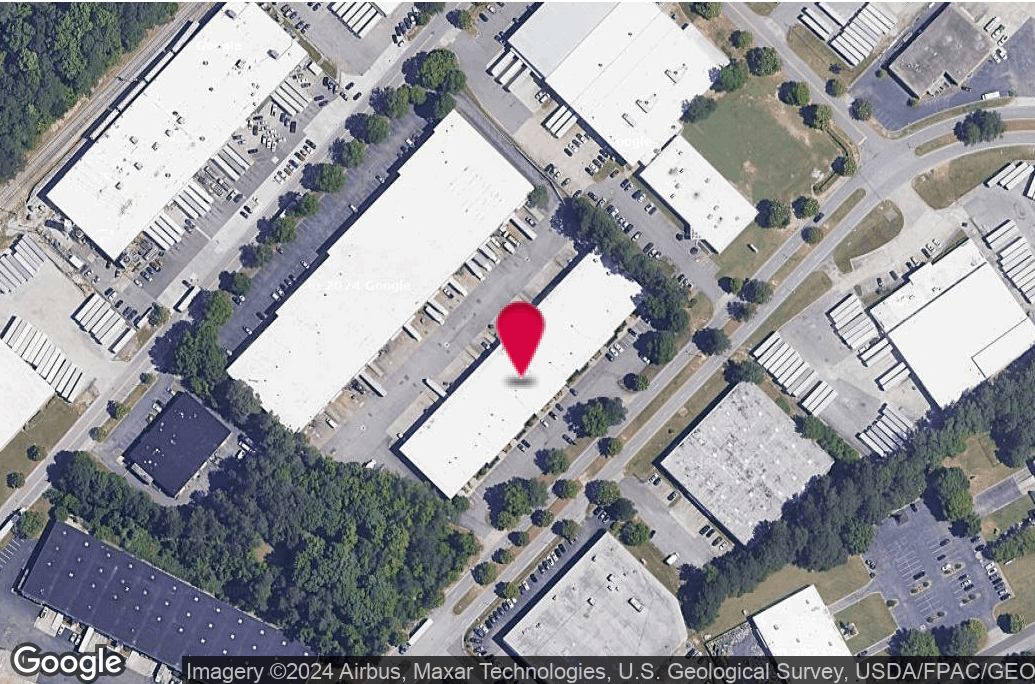

PROPERTY HIGHLIGHTS

- 900 +/- SF Office
- 2 Dock Doors
- 20' Clear Height
- Rear Load Trucking
- LED Warehouse Lights
- Ample Car Parking

OFFERING SUMMARY

Available SF:	5,054 SF
Lot Size:	4.03 Acres
Building Size:	55,303 SF
Zoning:	M1A

FLOOR PLAN

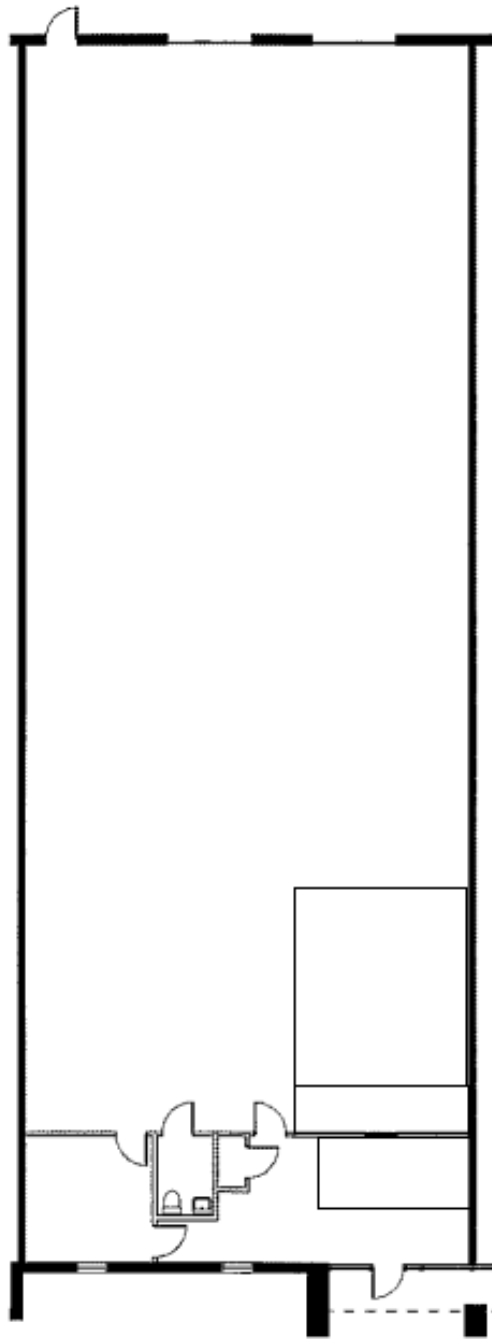

LOCATION MAP

278 Dallas

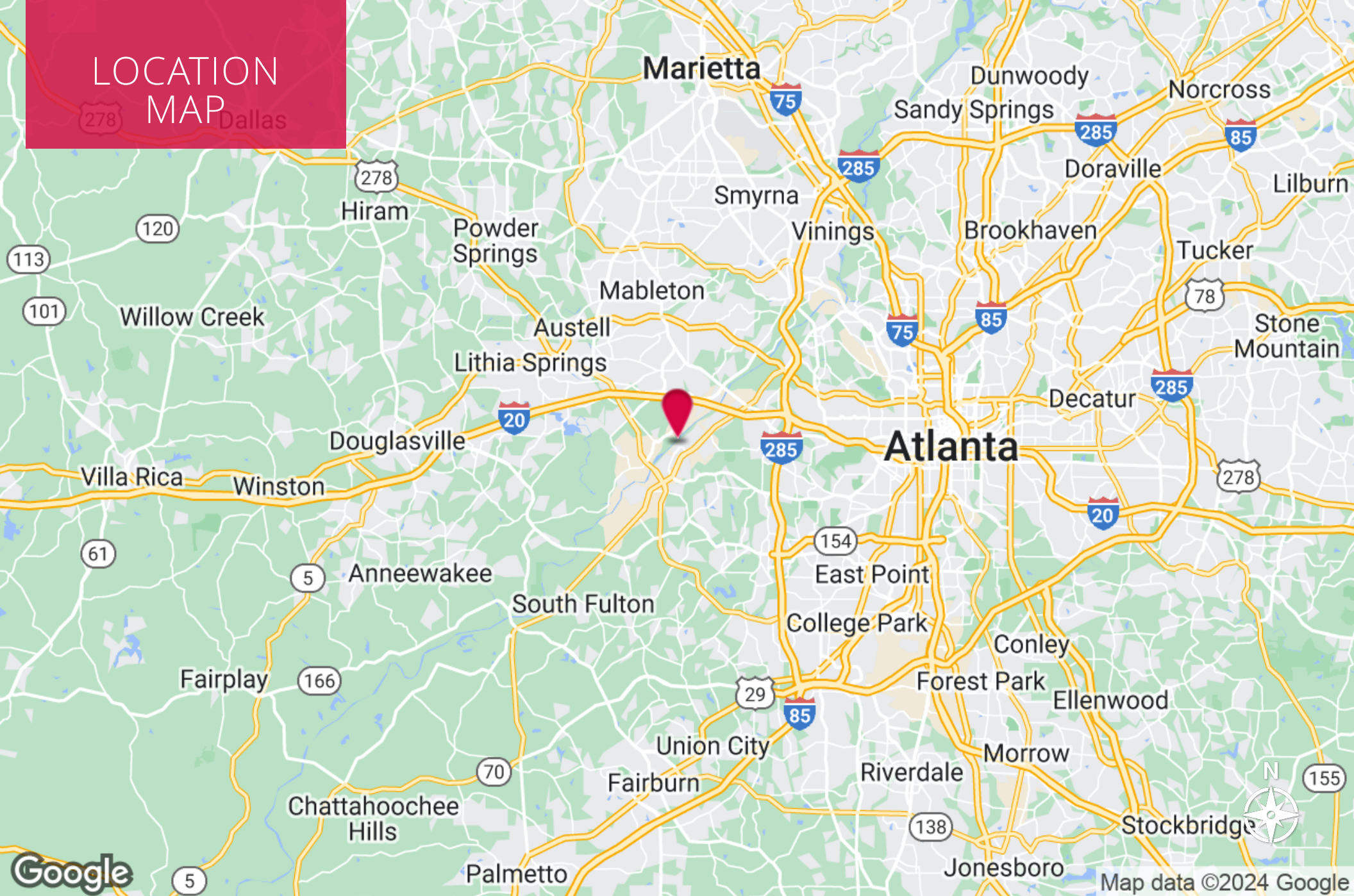

WILSON COVINGTON, SIOR

Senior Vice President

404.942.2073

wcovington@kingindustrial.com

Every effort has been made to provide accurate information, but no liability is assumed for errors or omissions.

Owned & Managed By:



king Industrial Realty, Inc.

CORFAC INTERNATIONAL

Industrial • Commercial • Investment

404.942.2000 | kingindustrial.com

EXCLUSIVELY LISTED BY:

WILSON COVINGTON, SIOR

Senior Vice President

wcovington@kingindustrial.com

404.942.2073

King Industrial
Realty, Inc.

Industrial • Commercial • Investment
404.942.2000 | kingindustrial.com