

8310-8358 Tyler Boulevard - Tyler Center Plaza

# Professional and Retail Suites For Lease

Mentor, Ohio 44060 (Lake County)



**New  
Ownership**

## Building and Location Features:

- Outstanding Location
- 2 ADA Elevators
- Handicapped Accessible and Common Area ADA Restrooms in Hall
- Below Market Lease Rates
- Will "Build to Suit" Interior
- Ample Parking in Front and Rear of Building
- Present Tenants:
  - Tommy Boys, Asian Nails, Imperial Dragon, Subway and Several Office Tenants
- Traffic Signal on Tyler Blvd
- Across from The Giant Eagle Plaza with Taco Bell, Wendy's, Starbuck's, Raising Canes Chicken and Future Development
- Great Visibility on SR 2 Between SR 306 and SR 615

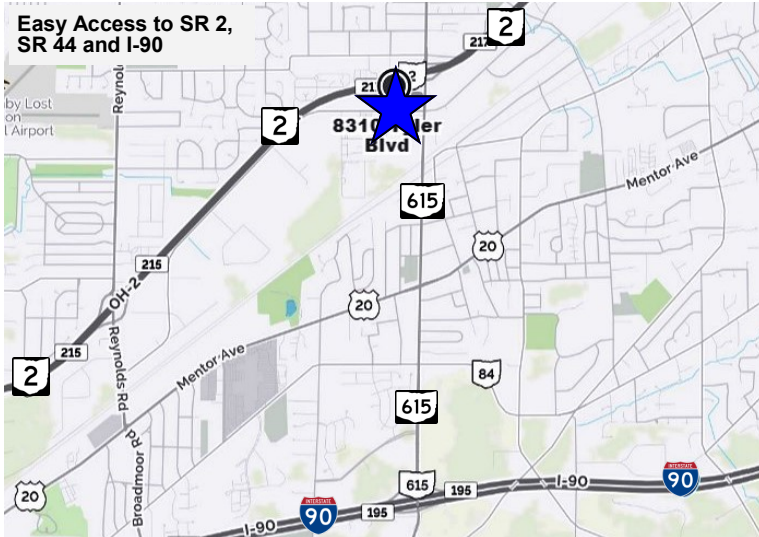

Contact:

**Neil Sawicki, SIOR, Broker**

440-255-5552 x13 Office

440-339-8585 Cell

Neil@GlobalCommercialRE.com



# GLOBAL

**Real Estate Advisors Inc.**  
Broker

www.GlobalCommercialRE.com

440-255-5552

This information has been secured from sources we believe are reliable, but we make no representations or warranties, expressed or implied, as to the accuracy of the information. References to condition, square footage or age are approximate. Buyer or Tenant acknowledges that they are relying on their own investigations and are not relying on Broker provided information. Procuring broker shall only be entitled to a commission, calculated in accordance with the rates approved by our principal only if such procuring broker executes a brokerage agreement acceptable to us and our principal and the conditions as set forth in the brokerage agreement are fully and unconditionally satisfied. Although all information furnished regarding property for sale, rental, or financing is from sources deemed reliable, such information has not been verified and no express representation is made nor is any to be implied as to the accuracy thereof and it is submitted subject to errors, omissions, change of price, rental or other conditions, prior sale, lease or financing, or withdrawal without notice and to any special conditions imposed by our principal.

8310-8358 Tyler Boulevard - Tyler Center Plaza

# Professional and Retail Suites For Lease

Mentor, Ohio 44060 (Lake County)

## Available Suites - Office

- **8338 Tyler Blvd - \$600.00 Monthly + Utilities**  
200± SF Second Floor Suite  
Two (2) Offices within Unit  
Plenty of Window Space
- **8340 Tyler Blvd - \$1,200.00 Monthly + Utilities**  
975± SF Second Floor Suite  
Three (3) Offices within Unit  
Large 19'x12' Conference Room with Windows  
Space may be Combined with 8342 Tyler Blvd
- **8342 Tyler Blvd - \$1,200.00 Monthly + Utilities**  
926± SF Second Floor Suite  
Large 22' x 15' Unit  
Will Build to Suite  
Allowance for Build-Out to Qualified Tenant  
Plenty of Window Space  
Space may be Combined with 8340 Tyler Blvd
- **8344 Tyler Blvd - \$1,200.00 Monthly + Utilities**  
913± SF Second Floor Suite  
2 Large Rooms  
Window Space  
Space can be Combined with Suites 8342 Tyler Blvd



*New Ownership!*



Contact:  
**Neil Sawicki, SIOR, Broker**

440-255-5552 x13 Office

440-339-8585 Cell

Neil@GlobalCommercialRE.com



# GLOBAL

**Real Estate Advisors Inc.**  
Broker  
[www.GlobalCommercialRE.com](http://www.GlobalCommercialRE.com)

**440-255-5552**

This information has been secured from sources we believe are reliable, but we make no representations or warranties, expressed or implied, as to the accuracy of the information. References to condition, square footage or age are approximate. Buyer or Tenant acknowledges that they are relying on their own investigations and are not relying on Broker provided information. Procuring broker shall only be entitled to a commission, calculated in accordance with the rates approved by our principal only if such procuring broker executes a brokerage agreement acceptable to us and our principal and the conditions as set forth in the brokerage agreement are fully and unconditionally satisfied. Although all information furnished regarding property for sale, rental, or financing is from sources deemed reliable, such information has not been verified and no express representation is made nor is any to be implied as to the accuracy thereof and it is submitted subject to errors, omissions, change of price, rental or other conditions, prior sale, lease or financing, or withdrawal without notice and to any special conditions imposed by our principal.

8310-8358 Tyler Boulevard - *Tyler Center Plaza*

# Professional and Retail Suites For Lease

Mentor, Ohio 44060 (Lake County)

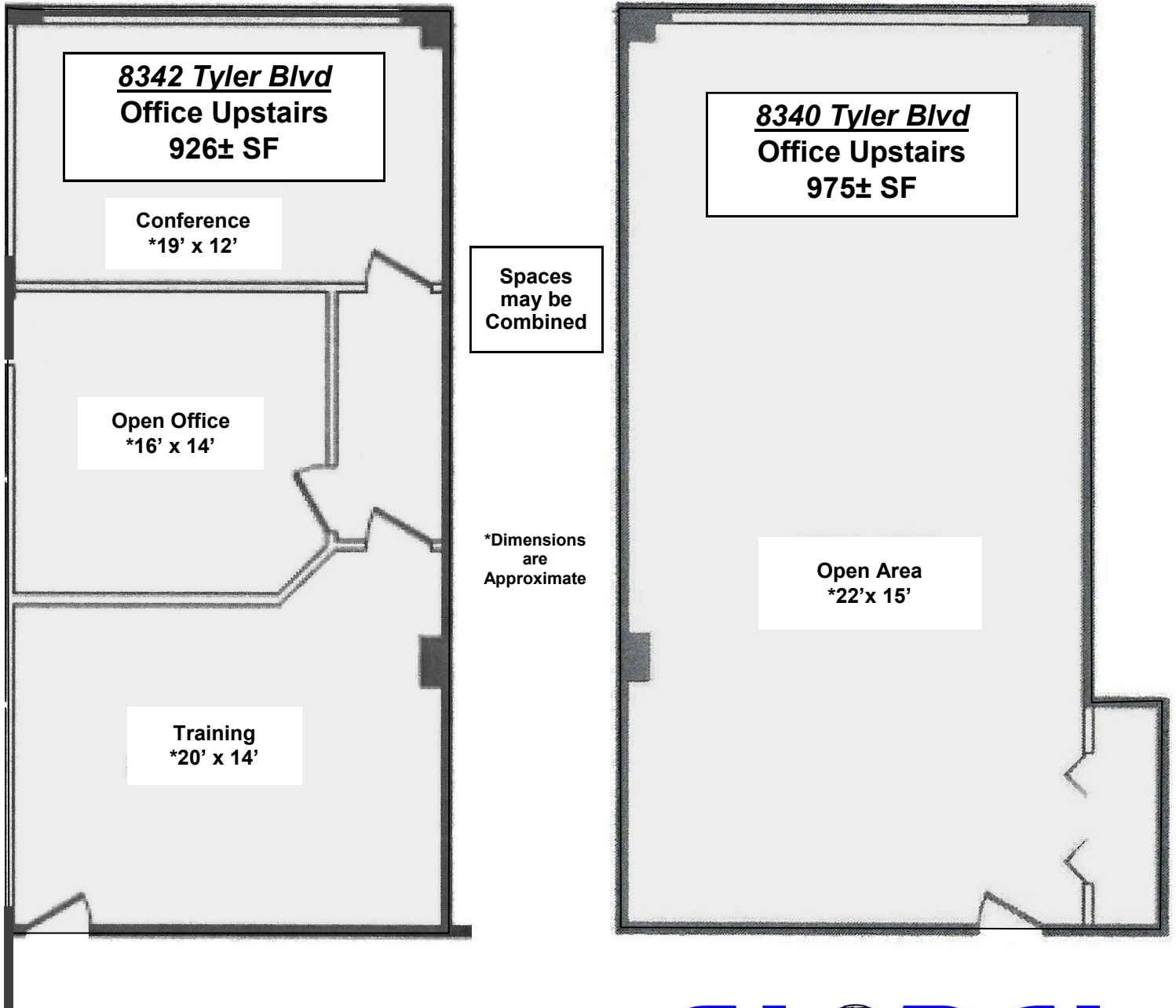

Contact:

**Neil Sawicki, SIOR, Broker**

440-255-5552 x13 Office

440-339-8585 Cell

Neil@GlobalCommercialRE.com



# GLOBAL

**Real Estate Advisors Inc.**  
Broker

[www.GlobalCommercialRE.com](http://www.GlobalCommercialRE.com)

440-255-5552

This information has been secured from sources we believe are reliable, but we make no representations or warranties, expressed or implied, as to the accuracy of the information. References to condition, square footage or age are approximate. Buyer or Tenant acknowledges that they are relying on their own investigations and are not relying on Broker provided information. Procuring broker shall only be entitled to a commission, calculated in accordance with the rates approved by our principal only if such procuring broker executes a brokerage agreement acceptable to us and our principal and the conditions as set forth in the brokerage agreement are fully and unconditionally satisfied. Although all information furnished regarding property for sale, rental, or financing is from sources deemed reliable, such information has not been verified and no express representation is made nor is any to be implied as to the accuracy thereof and it is submitted subject to errors, omissions, change of price, rental or other conditions, prior sale, lease or financing, or withdrawal without notice and to any special conditions imposed by our principal.

8310-8358 Tyler Boulevard - Tyler Center Plaza

# Professional and Retail Suites For Lease

Mentor, Ohio 44060 (Lake County)

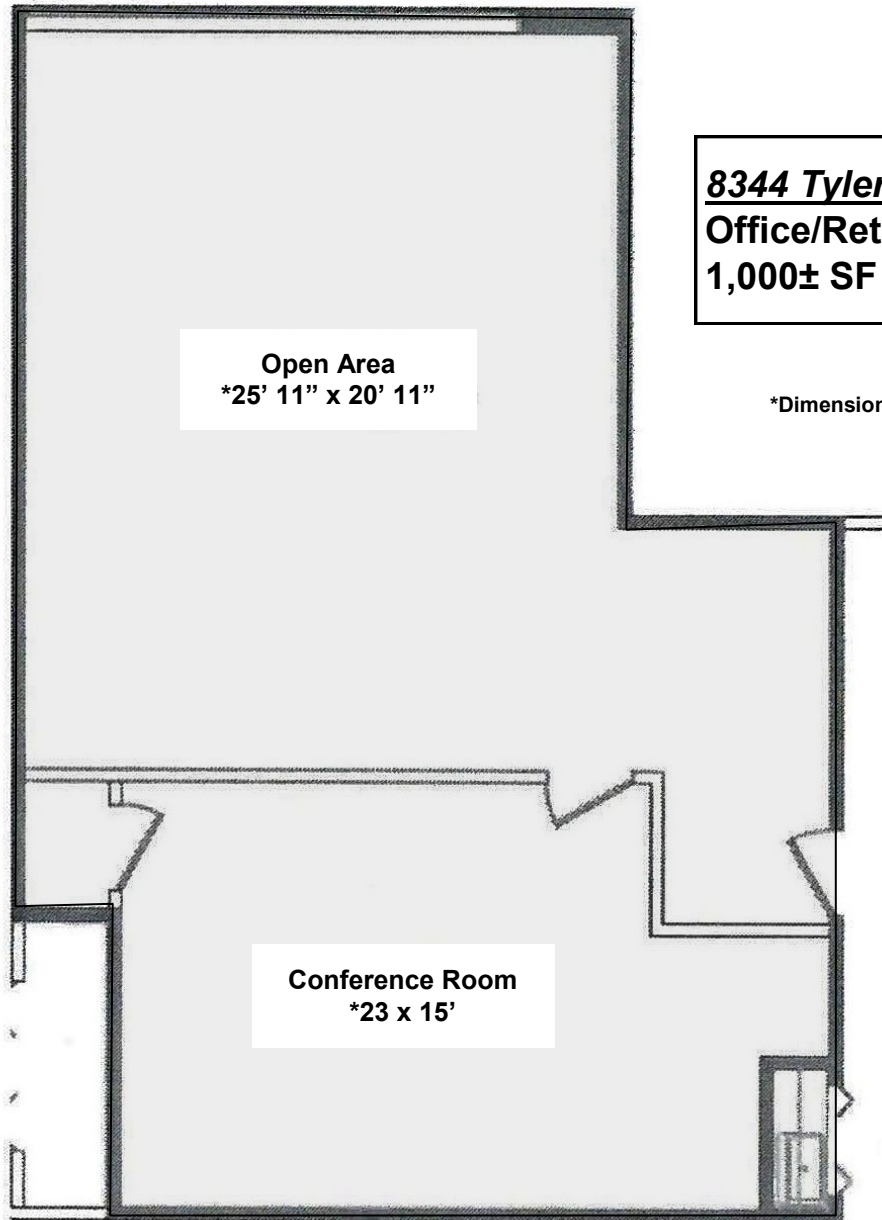

**8344 Tyler Blvd**  
**Office/Retail - Street Level**  
**1,000± SF**

\*Dimensions are Approximate

**Contact:**  
**Neil Sawicki, SIOR, Broker**  
440-255-5552 x13 Office  
440-339-8585 Cell  
Neil@GlobalCommercialRE.com



# GLOBAL

**Real Estate Advisors Inc.**  
Broker  
[www.GlobalCommercialRE.com](http://www.GlobalCommercialRE.com)

**440-255-5552**

This information has been secured from sources we believe are reliable, but we make no representations or warranties, expressed or implied, as to the accuracy of the information. References to condition, square footage or age are approximate. Buyer or Tenant acknowledges that they are relying on their own investigations and are not relying on Broker provided information. Procuring broker shall only be entitled to a commission, calculated in accordance with the rates approved by our principal only if such procuring broker executes a brokerage agreement acceptable to us and our principal and the conditions as set forth in the brokerage agreement are fully and unconditionally satisfied. Although all information furnished regarding property for sale, rental, or financing is from sources deemed reliable, such information has not been verified and no express representation is made nor is any to be implied as to the accuracy thereof and it is submitted subject to errors, omissions, change of price, rental or other conditions, prior sale, lease or financing, or withdrawal without notice and to any special conditions imposed by our principal.

# 8310-8358 Tyler Boulevard - Tyler Center Plaza

## Professional and Retail Suites For Lease

Mentor, Ohio 44060 (Lake County)



**Contact:**  
**Neil Sawicki, SIOR, Broker**  
 440-255-5552 x13 Office  
 440-339-8585 Cell  
 Neil@GlobalCommercialRE.com



# GLOBAL

**Real Estate Advisors Inc.**  
 Broker  
 www.GlobalCommercialRE.com  
 440-255-5552

This information has been secured from sources we believe are reliable, but we make no representations or warranties, expressed or implied, as to the accuracy of the information. References to condition, square footage or age are approximate. Buyer or Tenant acknowledges that they are relying on their own investigations and are not relying on Broker provided information. Procuring broker shall only be entitled to a commission, calculated in accordance with the rates approved by our principal only if such procuring broker executes a brokerage agreement acceptable to us and our principal and the conditions as set forth in the brokerage agreement are fully and unconditionally satisfied. Although all information furnished regarding property for sale, rental, or financing is from sources deemed reliable, such information has not been verified and no express representation is made nor is any to be implied as to the accuracy thereof and it is submitted subject to errors, omissions, change of price, rental or other conditions, prior sale, lease or financing, or withdrawal without notice and to any special conditions imposed by our principal.

8310-8358 Tyler Boulevard - Tyler Center Plaza

# Professional and Retail Suites For Lease

Mentor, Ohio 44060 (Lake County)

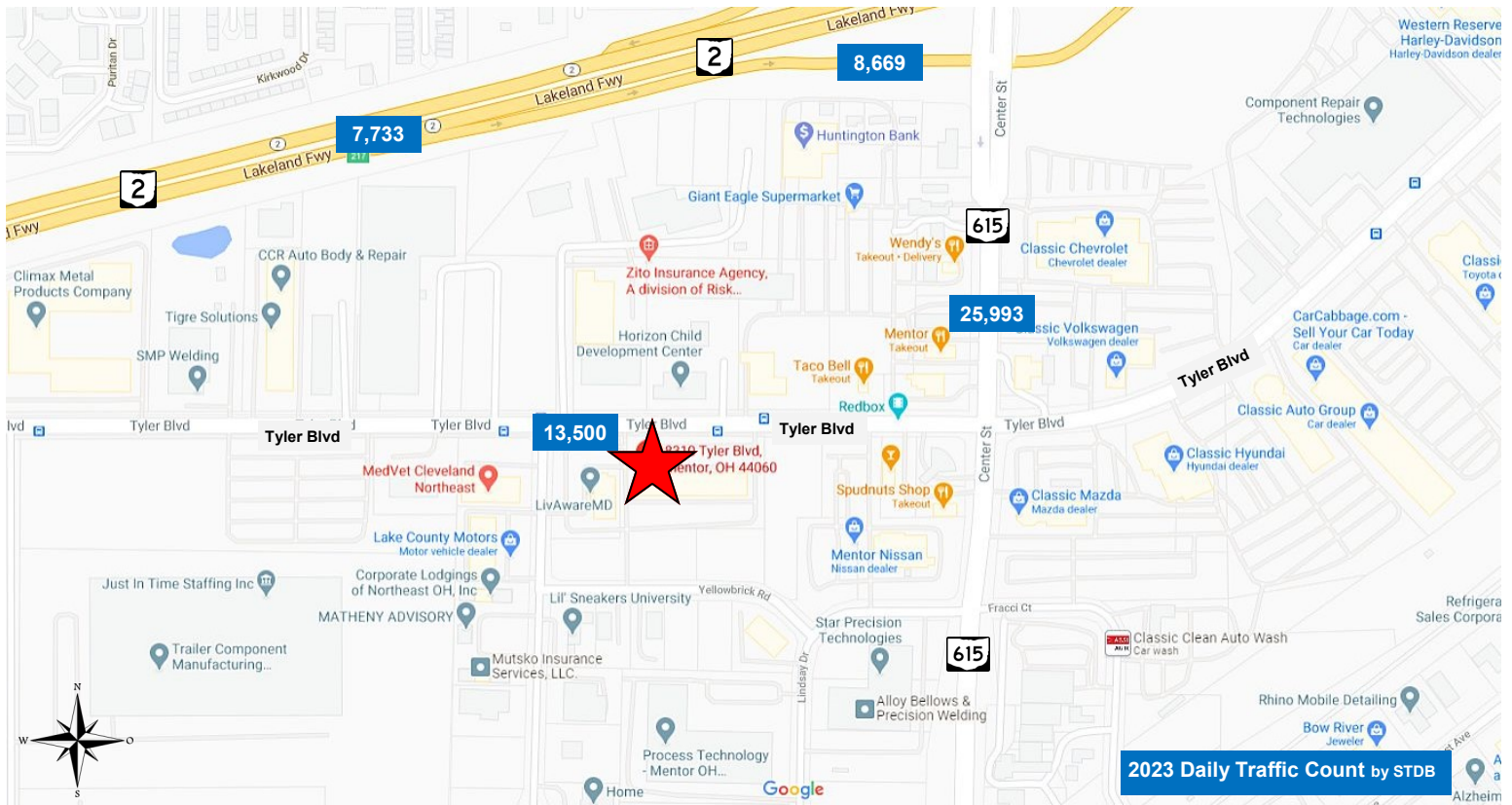

2025 Projected Demographics by STDB	1 Mile	3 Mile	5 Mile
Population	6,104	54,755	105,297
Total Households	2,600	23,241	44,122
Average Household Income	\$95,589	\$99,003	\$99,184
Total Housing Units	2,746	24,794	47,273

**Contact:**  
**Neil Sawicki, SIOR, Broker**  
 440-255-5552 x13 Office  
 440-339-8585 Cell  
 Neil@GlobalCommercialRE.com



**Real Estate Advisors Inc.**  
 Broker  
 www.GlobalCommercialRE.com  
 440-255-5552

This information has been secured from sources we believe are reliable, but we make no representations or warranties, expressed or implied, as to the accuracy of the information. References to condition, square footage or age are approximate. Buyer or Tenant acknowledges that they are relying on their own investigations and are not relying on Broker provided information. Procuring broker shall only be entitled to a commission, calculated in accordance with the rates approved by our principal only if such procuring broker executes a brokerage agreement acceptable to us and our principal and the conditions as set forth in the brokerage agreement are fully and unconditionally satisfied. Although all information furnished regarding property for sale, rental, or financing is from sources deemed reliable, such information has not been verified and no express representation is made nor is any to be implied as to the accuracy thereof and it is submitted subject to errors, omissions, change of price, rental or other conditions, prior sale, lease or financing, or withdrawal without notice and to any special conditions imposed by our principal.