

8221-23 Santa Fe Springs Rd

Number		PERMIT FEES	
1	Gas System, 1st 4 Outlets	\$2.00	2 00
	Each Outlet Additional	.50	
	Water Heaters or Vents	\$2.00	
	Water Piping	\$2.00	
	Water Treating Equipment or Softeners	\$2.00	
	Sink, Kitchen-Slop	\$2.00	
	Garbage Disp.	\$2.00	
	Bath Tub	\$2.00	
	Lavatories	\$2.00	
	Shower Pans	\$2.00	
	Water Closets	\$2.00	
	Laundry Trays	\$2.00	
	Wash. Mach. Stand Pipes	\$2.00	
	Dishwasher	\$2.00	
	Sink, Floor, Bar	\$2.00	
	Urinals	\$2.00	
	Drink Fountains	\$2.00	
	Floor Drains	\$2.00	
	Traps, Sand, Grease	\$2.00	
	Plumbing Piping Without Fixtures	Each \$2.00	
	Lawn Sprinklers	\$2.00	
	Back Flow Devices	\$2.00	
	Sewer(s)	Each \$5.00	
	Septic Tank & Cesspool	\$10.00	
	Swim Pool Plumbing	\$6.00	
<b>FILING FEE</b>		<b>\$3 00</b>	
<b>TOTAL FEES</b>		<b>5 00</b>	

8170-031-025

Street Address of Job **8221 & 8223 Santa Fe Sprgs. Rd.**

**PLUMBING**

**DEPT. OF BLDG. WHITTIER, CALIFORNIA**

Plumbing Contractor **Garcia Plbg.**

Contractor's Address **4841 Durfee Rd. Pico Rivera**

Contractor's Phone **692-0462**

Property Owner's Name **A. J. Pyka**

Contractor's State Lic. No. <b>265413</b>	Contractor's City Lic. No. <b>9020</b>
-------------------------------------------	----------------------------------------

New Bldg.  Old Bldg.

**FLOORS TO BE LEFT OPEN UNTIL PIPING IS INSTALLED AND INSPECTED**

**SEWER CHARGE -**

REMARKS

BELOW FOR OFFICE USE ONLY

Groundwork	Rough
Gas	Final <i>1-27-78 Jones</i>
Sewer	
Utility Clearance	<i>1-27-78 done Thelma</i>

I hereby acknowledge that I have read this application and state that the above is correct and agree to comply with all ordinances and State Laws regulating plumbing.

I hereby certify that I am properly registered and/or licensed as required by the City of Whittier and State of California or that I am the legal owner of the above described property, and I certify that in the performance of the work for which this permit is issued, I shall not employ any person in violation of the workmen's compensation laws of California.

Signature of Permittee *Garcia Plumbing*

Permit Fee **5.00**

No. *By A.J. Pyka*  
**90769**

822148223  
 SANTA FE SPRINGS  
 8170-031-025

PERMIT FEES	No.	Each	Fee
Residence 750 sq. ft. max.			\$13.00
Residence 1000 sq. ft. max.			\$17.50
Residence 1400 sq. ft. max.			\$24.50
Residence 1700 sq. ft. max.			\$30.00
Residence 2000 sq. ft. max.			\$35.00
Residence 2500 sq. ft. max.			\$44.00
Residence 3000 sq. ft. max.			\$52.50
Residence over 3000 sq. ft.			\$61.00
RANGE or OVEN (ea.)			\$ 2.00
CLOTHES DRYER			\$ 2.00
SPACE/WATER HTR. (ea.)			\$ 2.00
TIME CLOCK			\$ 2.00
FIXTURES	10	\$ .25	250
OUTLETS	66	\$ .25	1650
TEMPORARY POLE			\$ 6.00
SERVICE (200 AMP. MAX.)	1	\$ 6.00	6.00
(OVER 200 AMP.)	1	\$12.00	12.00
SIGN (INC. TIME CLOCK)			\$ 8.00
TEMP. LIGHTING			\$ 6.00
<b>MOTORS:</b>			
1 H.P. MAX.			\$ 2.00
10 H.P. MAX.			\$ 5.00
50 H.P. MAX.			\$ 8.00
100 H.P. MAX.			\$15.00
500 H.P. MAX.			\$22.50
OVER 500 H.P.			\$30.00
FILING FEE -----			\$5.00
PLAN CHECK FEE (OVER 1200 A.) -----			
<b>TOTAL FEES</b>			42.00 36.00

STREET ADDRESS OF JOB

**ELECTRIC**

DEPT. OF BLDG. WHITTIER, CALIF.

ELECTRICAL CONTRACTOR *HOLMES EDDINGS ELECT*

CONTRACTOR'S ADDRESS *METRO CENTER TRAIL 904 SO ALTA VISTA*

CONTRACTOR'S PHONE *213 359 8277*

CITY REG. NO. *13506* STATE LICENSE NO. *32603740*

PROPERTY OWNER *A PIKA*

PURPOSE OF BLDG. *COMMERCIAL*

NEW BLDG.  EXISTING BLDG.  NO. OF METERS *1*

REMARKS:

ROUGH *11-22-77* FINAL *1-24-78*

LIGHTS CLEARED TO UTILITY CO. *1-25-78*

POWER CLEARED TO UTILITY CO. *1-25-78*

I hereby acknowledge that I have read this application and state that the above is correct and agree to comply with all ordinances and State laws regulating electrical wiring.

I hereby certify that I am properly registered and/or licensed as required by the City of Whittier and/or State of California or that I am the legal owner of the above described property and I certify that in the performance of the work for which this permit is issued I shall not employ any person in violation of the workmen's compensation laws of California.

Signature *[Signature]*  
 of Permittee

42.00 PERMIT NO. **89942**

WHEN VALIDATED THIS IS YOUR PERMIT 89942 11/15/77 8 36.00

PERMIT FEES	No.	Each	Fee
Residence 750 sq. ft. max.			\$13.00
Residence 1000 sq. ft. max.			\$17.50
Residence 1400 sq. ft. max.			\$24.50
Residence 1700 sq. ft. max.			\$30.00
Residence 2000 sq. ft. max.			\$35.00
Residence 2500 sq. ft. max.			\$44.00
Residence 3000 sq. ft. max.			\$52.50
Residence over 3000 sq. ft.			\$61.00
RANGE or OVEN (ea.)		\$ 2.00	
CLOTHES DRYER		\$ 2.00	
SPACE/WATER HTR. (ea.)		\$ 2.00	
TIME CLOCK		\$ 2.00	
FIXTURES	10	\$ .25	4.50
OUTLETS	30	\$ .25	7.50
TEMPORARY POLE		\$ 6.00	
SERVICE (200 AMP. MAX.)		\$ 6.00	
(OVER 200 AMP.)		\$12.00	
SIGN (INC. TIME CLOCK)		\$ 8.00	
TEMP. LIGHTING		\$ 6.00	
<b>MOTORS:</b>			
1 H.P. MAX.	10	\$ 2.00	20.00
10 H.P. MAX.	1	\$ 5.00	5.00
50 H.P. MAX.		\$ 8.00	
100 H.P. MAX.		\$15.00	
500 H.P. MAX.		\$22.50	
OVER 500 H.P.		\$30.00	

FILING FEE	-----	\$5.00
PLAN CHECK FEE (OVER 1200 A.)	-----	
<b>TOTAL FEES</b>		<b>42.00</b>

I hereby acknowledge that I have read this application and state the above is correct and agree to comply with all ordinances and State Laws. I hereby certify that I am properly registered and/or licensed as required by the City of Whittier and/or State of California, or that I am the legal owner of the above described property, and I certify that in the performance of the work for which this permit is issued I shall not employ any person, and that I shall purchase workers' compensation insurance before I employ any person on work for which this permit is issued.

Signature of Permittee *Roy Miller*

8221 SALT SPRINGS RD  
 Santa Springs Rd  
**ELECTRIC 8170-031-025**

DEPT. OF BLDG. WHITTIER, CALIF.

ELECTRICAL CONTRACTOR *HOLMES ENDINGS*

CONTRACTOR'S ADDRESS *ALTA VISTA 404 50 MONROVIA 9106*

CONTRACTOR'S PHONE *213 359 8277*

CITY REG. NO. *13506* STATE LICENSE NO. *326037C10*

PROPERTY OWNER *F CENICEROS*

PURPOSE OF BLDG. *COMMERCIAL*

NEW BLDG.  EXISTING BLDG.  NO. OF METERS

REMARKS:

ROUGH *11-22-77 dm* FINAL *1-24-78 dm*

LIGHTS CLEARED TO UTILITY CO.

POWER CLEARED TO UTILITY CO.

PERMIT NO.  
**90437**

FEE  
**42.00**

90437 12/23/77 42.00 EP

**FOR APPLICANT TO FILL IN**

BUILDING ADDRESS 8223 Sante Fe Springs Rd  
 LOCALITY Whittier Calif  
 NEAREST CROSS ST. Persing  
 OWNER Fred R Rizzo  
 MAIL ADDRESS 8223 Sante Fe Springs  
 CITY Whittier TEL. NO.  
 ARCHITECT OR ENGINEER Self TEL. NO. 445161  
 ADDRESS Above  
 CONTRACTOR " TEL. NO.  
 ADDRESS

LEGAL DESCRIPTION LOT NO. 35 BLOCK  
 TRACT 6956  
 SIZE OF LOT 50X115 NO. OF BLDGS. NOW ON LOT 1  
 USE OF EXISTING BLDG. Home. NO. OF FAMILIES NO. OF ROOMS 5

**DESCRIPTION OF WORK**

NEW  ALTERATION  ADDITION   
 REPAIR  MOVING  DEMOLISH   
 SQ. FT. SIZE 1008 NO. OF ROOMS 1 STORIES 1  
 WALL COVERING Stucco ROOF COVERING Campo Sh.  
 USE OF NEW BUILDING tool & Die Shop

I HEREBY ACKNOWLEDGE THAT I HAVE READ THIS APPLICATION AND STATE THAT THE ABOVE IS CORRECT AND AGREE TO COMPLY WITH ALL COUNTY ORDINANCES AND STATE LAWS REGULATING BUILDING CONSTRUCTION.

SIGNATURE OF PERMITTEE Fred R Rizzo  
 AUTHORIZED AGT.

76A638A 9-4B  
 DBS-3 50M SETS \$ 3250<sup>00</sup>  
 VALUATION

P. C. \$  
 FEE 5<sup>00</sup>  
 \$  
 FEE 12<sup>90</sup>

**FOR OFFICE USE ONLY**

DISTRICT NO. 11 PLAN CK. NO. 11251 PERMIT NO. 1542  
 RECEIVED BY Idaly DATE OF APPL. 9-7-49 DATE ISSUED 12-9-49  
 BUILDING ADDRESS 8223 St. Fe. Spgs. Rd.  
 LOCALITY Whittier  
 NEAREST CROSS ST. Persing  
 FIRE ZONE NO. OF PLANS TYPE V GROUP E  
 BLDG. SETBACK LINE F.P.L. ORD. NO.  
 APPROVED BY [Signature] DATE 1/20/50  
 USE ZONE M3 APPROVED BY [Signature] DATE 1/20/50

3620 CORRECTIONS

ORIGINAL

**APPROVALS.**

FOUNDATION: LOCATION FORMS, MATERIALS INSPECTOR [Signature] DATE 1/20/50  
 FRAME: FIRE STOPS, BRACING, BOLTS [Signature] 4/14/50  
 LATH, INT. [Signature] 5/26/50  
 LATH, EXT. [Signature] 4/14/50  
 PLASTER, INT.  
 PLASTER, EXT.  
 FINAL [Signature] 10/15/50

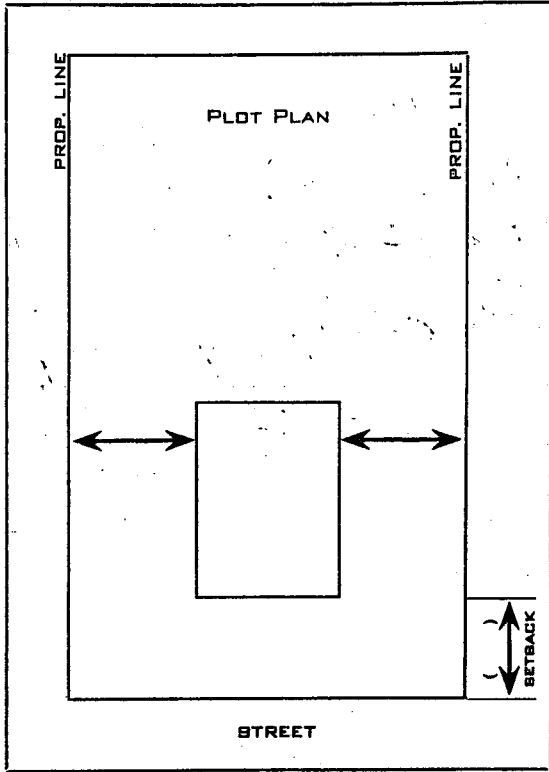

Map Number.....

No. Assigned by.....

Field Check by.....

Date.....

DEPARTMENT OF BUILDING AND SAFETY

COUNTY OF LOS ANGELES

WM. J. FOX, CHIEF ENGINEER

8170-031-025

# PLUMBING

NATURE OF INSTALLATION				DISTRICT NO.	GROUP	ZONE	PERMIT NO.
ROUGH	FIXTURES	COMPLETE		6W	I	MB	A-25391
HEATER	CESSPOOL	<input checked="" type="checkbox"/> SEPTIC TANK		RECEIVED BY	READY FOR FIRST INSPECTION		DATE ISSUED
GAS	MISCELLANEOUS			MW	now		6-19-41

**APPLICANT FILL IN HEAVILY OUTLINED PORTION ONLY**

PLUMBER	NAME	Meyer Cesspool Service	JOB ADDRESS	1319 Santa Fe Springs Rd.
	ADDRESS	1205 B. Painter	LOCALITY	South Whittier
	CITY	Whittier	NEAREST CROSS ST.	Persena Drive
	COUNTY CERT. No.	EXPIRES		

**LOCATION OF SEPTIC TANK, OR CESSPOOL**

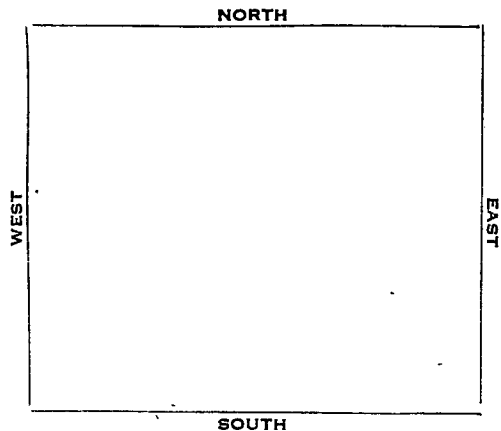

OWNER	NAME	C. H. Dore
	MAIL ADDRESS	219 S. Pickering
	CITY	

I AM THE LEGAL POSSESSOR OF THE ABOVE LOS ANGELES COUNTY CERTIFICATE OF QUALIFICATION.

G. W. Meyer  
PLUMBER

I AM THE LEGAL OWNER OF THE PROPERTY DESCRIBED ABOVE.

OWNER

**CORRECTIONS**

ORIGINAL

**DESCRIPTION OF WORK**

<input type="checkbox"/> BATH TUB	<input type="checkbox"/> FURNACE
<input type="checkbox"/> SHOWER	<input type="checkbox"/> DISHWASHER
<input type="checkbox"/> LAVATORY	<input type="checkbox"/> REFRIGERATOR
<input type="checkbox"/> KITCHEN SINK	<input type="checkbox"/> WATER SOFTENER
<input type="checkbox"/> FLOOR SINK	<input type="checkbox"/> SAND TRAP
<input type="checkbox"/> SLOP SINK	<input type="checkbox"/> FLOOR DRAIN
<input type="checkbox"/> WASH TRAY	<input type="checkbox"/> URINAL
<input type="checkbox"/> WATER CLOSET	<input type="checkbox"/> DRINKING FOUNTAIN
<input type="checkbox"/> WATER HEATER	<input type="checkbox"/> DENTAL LAVATORY
<input type="checkbox"/> METER <input type="checkbox"/> GAS OUTL	<input type="checkbox"/> SODA FOUNTAIN

**APPROVALS**

	DATE	INSPECTOR'S NAME
ROUGH PLUMBING		
GAS PIPING		
GAS VENT		
CESSPOOL		
SEPTIC TANK		
SEWER		
UTILITY CO. NOTIFIED		
FINAL	6-19-41	<u>W. J. Fox</u>

TOTAL NUMBER OF FIXTURES	
CESSPOOL	1 00
SEPTIC TANK	1 00
TOTAL FEE	\$ 2 00

**DEPARTMENT OF BUILDING AND SAFETY  
COUNTY OF LOS ANGELES**

WM. J. FOX, CHIEF ENGINEER

APPLICATION FOR PERMIT

**ELECTRIC**

8170-031-025

ELECTRICIAN	NAME					DISTRICT NO.	GROUP	ZONE	PERMIT NO.
	<i>[Signature]</i>					600	J	M-3	30890
						RECEIVED BY		READY FOR FIRST INSPECTION	
	ADDRESS					<i>[Signature]</i>	W-C		2-10-48
	CITY								
COUNTY CERT. NO.									
TEL. NO.									
EXPIRES									
APPLICANT FILL IN HEAVILY OUTLINED PORTION ONLY.									
DESCRIPTION OF WORK					JOB ADDRESS				
NUMBER OF OUTLETS ON CIRCUITS LOCATION BY ROOMS					1319 Santa Fe Avenue Rd.				
					LOCALITY				
CIRCUIT					NEAREST CROSS ST.				
					OWNER				
LIGHT OUTLETS					NAME				
					MAIL ADDRESS				
SW.					CITY				
					TEL. NO.				
PLUGS					I AM THE LEGAL POSSESSOR OF THE ABOVE LOS ANGELES COUNTY CERTIFICATE OF QUALIFICATION.				
					ELECTRICIAN.				
FIXT					I AM THE LEGAL OWNER OF THE PROPERTY DESCRIBED ABOVE				
					OWNER.				
CORRECTIONS									
ORIGINAL									
TOTAL									
NO. OF OUTLETS					APPROVALS				
NO. OF FIXTURES					DATE				
NO. OF MOTORS 2 H.P. $\frac{1}{2}/34$					INSPECTOR'S NAME				
NO. OF SIGNS TRANS.					CONDUIT				
NO. OF RANGES OR HEATERS					WIRING				
MISCELLANEOUS					FIXTURES				
PERMIT FEE					POWER				
TOTAL FEE					UTILITY CO. NOTIFIED				
					FINAL				



DEPARTMENT OF BUILDING AND SAFETY  
 COUNTY OF LOS ANGELES  
 WM. J. FOX, CHIEF ENGINEER

APPLICATION FOR PERMIT

ELECTRIC

8170-031-025

ELECTRICIAN	NAME	DISTRICT NO.		GROUP	ZONE	PERMIT NO.
	ADDRESS	6W	J	M-3	28794	
	CITY	TEL. NO.	RECEIVED BY	READY FOR FIRST INSPECTION	DATE ISSUED	
	COUNTY CERT. NO.	EXPIRES	Harry	Call	1-30-48	

APPLICANT FILL IN HEAVILY OUTLINED PORTION ONLY

DESCRIPTION OF WORK										JOB ADDRESS	
										1319 Santa Fe Springs Rd.	
NUMBER OF OUTLETS ON CIRCUITS LOCATION BY ROOMS										LOCALITY	
										Whittier	
CIRCUIT										NEAREST CROSS ST.	
										Kensington Drive	
LIGHT OUTLETS					SW.	PLUGS			FIXT	OWNER	NAME
A	B	C	D	E		F	G	H	MAIL ADDRESS		3114 R. Fisher
											CITY
											Whittier
											TEL. NO.
											445 1/2
										I AM THE LEGAL POSSESSOR OF THE ABOVE LOS ANGELES COUNTY CERTIFICATE OF QUALIFICATION.	
										ELECTRICIAN.	
										I AM THE LEGAL OWNER OF THE PROPERTY DESCRIBED ABOVE	
										Mrs. Fred R. Fisher	
										OWNER	

CORRECTIONS

NEW SERVICE										21948 @ Requires #8 Bond	
METER LOOP										insert in service	
										400 Change 3 phase switch	
										T. Switch phase 3 pole	
										solid neutral 30 amps	
										general purpose switch	
										13) Bring around clamp	
										above grade	
										A) Max Fuse 10 amps. on	
										3/4 H motor	
										C) Sumner 6X	
										E) Rehire plus new	
										motor circuit - one	

ORIGINAL

TOTAL				APPROVALS			
NO. OF OUTLETS	\$			DATE		INSPECTOR'S NAME	
NO. OF FIXTURES	\$			2/10/48		D.A.	
NO. OF MOTORS H.P.	\$			7/10/48			
NO. OF SIGNS TRANS.	\$						
NO. OF RANGES OR HEATERS	\$						
MISCELLANEOUS	\$						
PERMIT FEE	\$	100		2/11/48		D.T.S.	
TOTAL FEE	\$	100		5/31/48		D.T.S.	

provide supplementary permit for

$3/4 + 1/2$  HP motors

073

---

8170-031-025

855

LOCATION OF JOB

Street 1319 Sandoz St Rd

Permit No. 2168 Date 12-19-34

**PLUMBING**

COUNTY OF LOS ANGELES

BUILDING BUREAU

THE REGIONAL PLANNING COMMISSION

E A Romo

Owner

Mayer J. Israeloff

Plumber

Plumber's Address.....

Plumber's Phone.....

Legal Description

Lot..... Block.....

Tract.....

Nearest Cross Street.....

- |                      |                       |
|----------------------|-----------------------|
| ..... Bath Tubs      | ..... Furnaces        |
| ..... Showers        | ..... Dish Washer     |
| ..... Lavatory       | ..... Refrigerator    |
| ..... Kitchen Sink   | ..... Water Softener  |
| ..... Floor Sinks    | ..... Sand Trap       |
| ..... Slop Sink      | ..... Floor Drain     |
| ..... Wash Trays     | ..... Urinals         |
| ..... Water Closets  | ..... Drink Fountain  |
| ..... Water Heaters  | ..... Dental Lavatory |
| ..... Gas-Fuel-Light | ..... Soda Fountain   |
| ..... Septic Tank    | .....                 |
| ..... Cesspool       | .....                 |

Total No. Fixtures.....

Cost \$.....

Fee 150

District No.....

OK RENT

FOR OFFICE RECORDS ONLY (Do not fill in)

Rough Plumbing.....  
Final.....  
Gas Piping.....  
Gas Vents.....  
Sewer.....  
Cesspool. 2-19-84 OK RCU

**CORRECTIONS**

Show location of septic tank or cesspool.

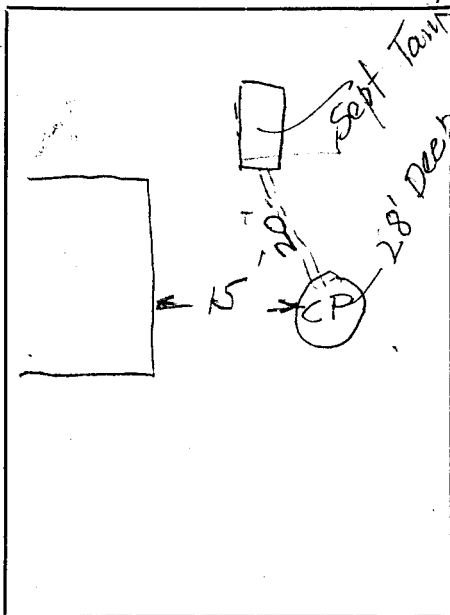

Number	PERMIT FEES			
	Gas System, 1st 4 Outlets	\$2.00		
	Each Outlet Additional	.50		
2	Water Heaters or Vents	\$2.00	4	00
2	Water Piping	\$2.00	4	00
	Water Treating Equipment or Softeners	\$2.00		
	Sink, Kitchen-Slop	\$2.00		
	Garbage Disp.	\$2.00		
	Bath Tub	\$2.00		
3	Lavatories	\$2.00	6	00
	Shower Pans	\$2.00		
3	Water Closets	\$2.00	6	00
	Laundry Trays	\$2.00		
	Wash. Mach. Stand Pipes	\$2.00		
	Dishwasher	\$2.00		
	Sink, Floor, Bar	\$2.00		
	Urinals	\$2.00		
	Drink Fountains	\$2.00		
	Floor Drains	\$2.00		
	Traps, Sand, Grease	\$2.00		
	Plumbing Piping Without Fixtures	Each \$2.00		
	Lawn Sprinklers	\$2.00		
	Back Flow Devices	\$2.00		
1	Sewer(s)	Each \$5.00	5	00
	Septic Tank & Cesspool	\$10.00		
	Swim Pool Plumbing	\$6.00		
	<b>FILING FEE</b>		<b>\$3</b>	<b>00</b>
	<b>TOTAL FEES</b>		<b>28</b>	<b>00</b>

8170-031-025

Street Address of Job **8221 S.F.S. Rd**

**PLUMBING**

DEPT. OF BLDG. WHITTIER, CALIFORNIA

Plumbing Contractor **GARCIA plb9**

Contractor's Address **4841 Durfee Pk**

Contractor's Phone **692 0462**

Property Owner's Name **A. J. Pyka**

Contractor's State Lic. No. **265413** Contractor's City Lic. No. **9020**

New Bldg. **NEW** Old Bldg.

**FLOORS TO BE LEFT OPEN UNTIL PIPING IS INSTALLED AND INSPECTED**

**SEWER CHARGE?**

REMARKS

**No Charge 8/10/77  
ASL**

**58' E/O M.H.  
6' deep 8" main**

EXCEPT WATER PIPE

BELOW FOR OFFICE USE ONLY

Groundwork **8-25-77** (Des) Rough **11-22-77** dm

Gas Final **1-24-78** dm

Sewer **11-9-77** JB

Utility Clearance

I hereby acknowledge that I have read this application and state that the above is correct and agree to comply with all ordinances and State Laws regulating plumbing. I hereby certify that I am properly registered and/or licensed as required by the City of Whittier and State of California or that I am the legal owner of the above described property, and I certify that in the performance of the work for which this permit is issued, I shall not employ any person in violation of the workmen's compensation laws of California.

Signature of Permittee

*Louie Garcia*

Permit Fee No.

**28<sup>00</sup>**

**88670 JB**

When Validated This Is Your Permit

**AUG-10-77 98484 > CA 88670**

**3 - 3**

**28.00**

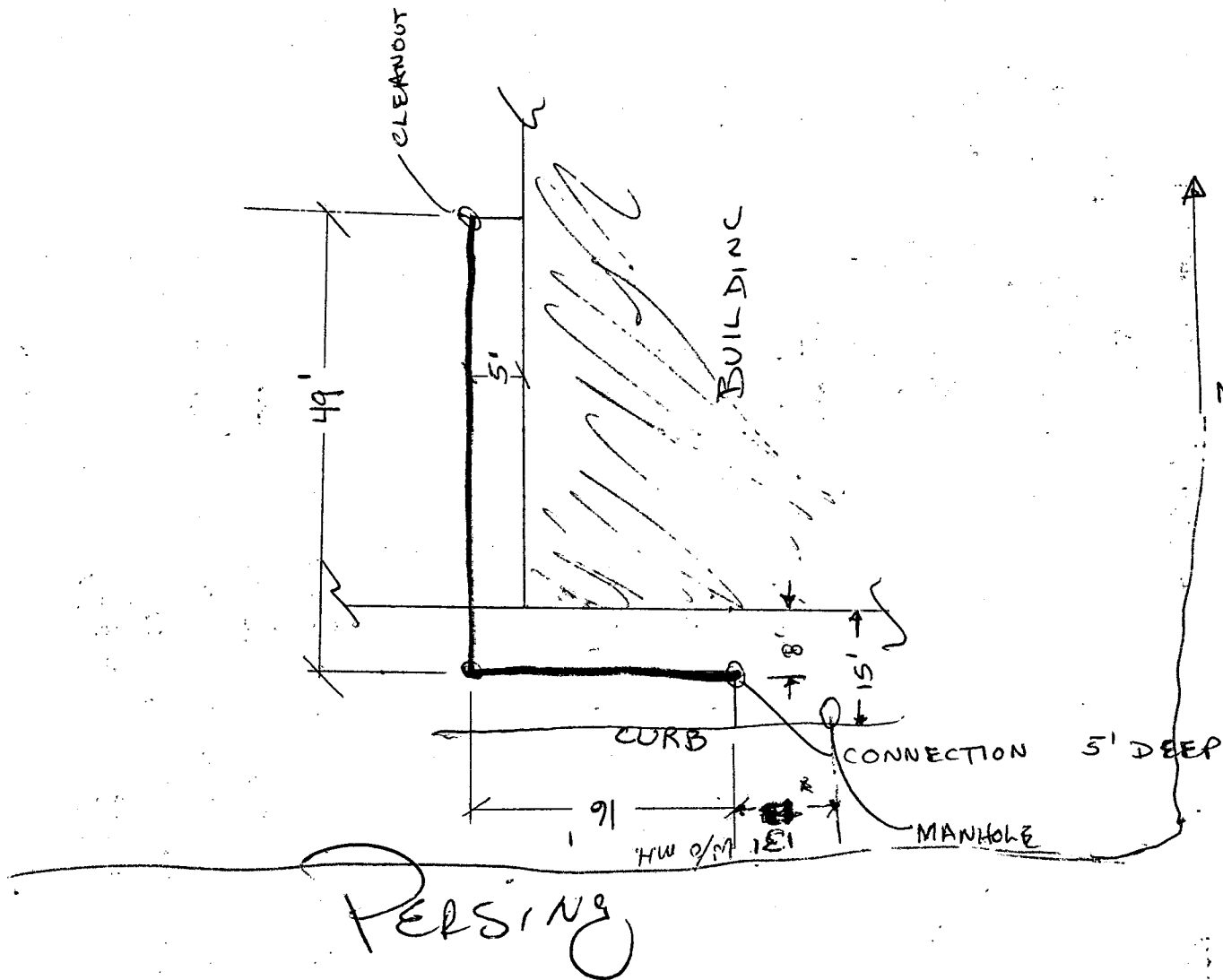

**DECLARATIONS**

The Declarations below are mandated by the State of California under Section 19825 of the Health and Safety Code.

— APPLICANT —

**CONTRACTOR: FILL IN DECLARATION 1, 3, 4 AND 5**

**OWNER: FILL IN DECLARATION 2, 4 AND 5**

**1. LICENSED CONTRACTOR'S DECLARATION**

I hereby affirm that I am licensed under provisions of Chapter 9 (commencing with Section 7000) of Division 3 of the Business and Professions Code, and my license is in full force and effect.

License Class \_\_\_\_\_ License No. \_\_\_\_\_

Date \_\_\_\_\_ Contractor \_\_\_\_\_

**2. OWNER-BUILDER DECLARATION**

I hereby affirm that I am exempt from the Contractor's License Law for the following reason (Sec. 7031.5, California Business and Professions Code: Any City which requires a permit to construct, alter, improve, demolish or repair any structure, prior to its issuance, also requires the applicant for such permit to file a signed statement that he is a licensed contractor pursuant to the provisions of the Contractor's License Law (Ch. 9 (Commencing with Sec. 7000) of Div. 3 of the B. & P. C.) or that he is exempt therefrom and the basis for the alleged exemption. Any violations of Sec. 7031.5 by any applicant for a permit subjects the applicant to a civil penalty of not more than five hundred dollars (\$500.00).):

I, as owner of the property, or my employees with wages as their sole compensation, will do the work, and the structure is not intended or offered for sale (Sec. 7044, B. & P. C.: The Contractor's License Law does not apply to an owner of property who builds or improves thereon, and who does such work himself or through his own employees, provided that such improvements are not intended or offered for sale. If, however, the building or improvement is sold within one year of completion, the owner-builder will have the burden of proving that he did not build or improve for the purpose of sale.)

I, as owner of the property, am exclusively contracting with licensed contractors to construct the project (Sec. 7044, B. & P. C.: The Contractor's License Law does not apply to an owner of contracts for such projects with a contractor(s) licensed pursuant to the Contractor's License Law.)

I am exempt under Sec. \_\_\_\_\_, B. & P. C. for this reason: \_\_\_\_\_

Date 2/2/83 Owner Edward L. Bonicore

**3. WORKER'S COMPENSATION DECLARATION**

I hereby affirm that I have a certificate of consent to self-insure or a certificate of worker's Compensation Insurance or a certified copy thereof. (Sec. 3800, Lab. C.)

Policy No. \_\_\_\_\_ Company \_\_\_\_\_

Certified copy is hereby furnished.

Certified copy is filed with the Department of Building & Safety.

Date \_\_\_\_\_ Applicant \_\_\_\_\_

**CERTIFICATE OF EXEMPTION FROM WORKER'S COMPENSATION INSURANCE**

I certify that in the performance of the work for which this permit is issued, I shall not employ any person in any manner so as to become subject to the Worker's Compensation Laws of California.

Date \_\_\_\_\_ Applicant \_\_\_\_\_

NOTICE TO APPLICANT: If, after making this Certificate of Exemption, you should become subject to the Work's Comp. provisions of the Labor Code, you must forthwith comply with such provisions or this permit shall be deemed revoked.

**4. CONSTRUCTION LENDING AGENCY**

I hereby affirm that there is a construction lending agency for the performance of the work for which this permit is issued (Sec. 3907, Civ. C.).

Lender's Name \_\_\_\_\_

Lender's Address \_\_\_\_\_

**5.**

I certify that I have read this application and state that the above information is correct. I agree to comply with all City, and State laws relating to the building construction, and hereby authorize representatives of this City to enter upon the above-mentioned property for inspection purposes.

Signature of Owner or Contractor ONLY Edward L. Bonicore Date \_\_\_\_\_

— IMPORTANT —

Application is hereby made to the Superintendent of Building and Safety for a permit subject to the conditions and restrictions set forth on the front and rear faces of this application.

1. Each person upon whose behalf this application is made and each person at whose request and for whose benefit work is performed under or pursuant to any permit issued as a result of this application agrees to and shall, indemnify and hold harmless the City of Whittier, its officers, agents and employees.

2. Any permit issued as a result of this application becomes null and void if work is not commenced within **ONE HUNDRED EIGHTY (180) DAYS** from date of issuance of such permit.

**BUILDING AND PLANNING USE ONLY**

Var. or C.U.P. V-82-09	Total Req'd Parking 15	Front 10'	Req'd Yards Rear 10' Sides 10'-0"
---------------------------	---------------------------	--------------	-----------------------------------------

Use Zone M	Type Const. V-N	Group B-2	Stories 1	Occ. Load	Ex. Use
---------------	--------------------	--------------	--------------	-----------	---------

Valuation of Job 60,000 <sup>00</sup>	Plan No. 9889
------------------------------------------	------------------

Bldg not to be heated or cooled.

Bldg "A" = 2080 sq. ft  
Bldg "B" = 750 sq. ft  
Mezzanine = 216 sq. ft

3-29-83 1st 4'-3" lift, gROUT, steel OK RE.  
4-4-83 2nd 4'-0" GROUT lift, steel OK RE.  
4-11-83 3rd gROUT level, steel OK RE.

Energy	No. (5100 Fund) 61249
Check Fee	
Plan 45	No. 06720
Check Fee 203	
Plan	No.
Check Fee	
Permit Fee 313 <sup>00</sup>	No. 07157
+ State Tax 4 <sup>20</sup>	
RIA	

Job Address: 8170-031-025  
8221 SANTA FE SPRINGS ROAD

DEPT. OF BUILDING BUILDING WHITTIER, CALIF.

Lot 32, 34 Block 35 Tract 6956

Description of Work: ADDITION TO AN INDUSTRIAL BUILDING.

Property Owner EDUARDO CENICEROS  
Owner's Address 8221 SANTA FE, WHITTIER  
Owner's Phone 696-5916  
Architect's Name JACK MATSON  
Address 6012 PICKERING, WHITTIER  
Phone 698-2109  
Engineer's Name JACK MATSON  
Contractor's Name Eduardo D. Bonicore  
Address 15258 Jupiter St  
Phone Home 696-4972 Bus 696-5916  
State Lic. No. City Lic. No. 01B

WHEN VALIDATED THIS IS YOUR PERMIT

7157-2/03/83 313.00  
1000204 2/03/83 4.20

Set Backs	Date	Foundation	Date
2-18-83	RE	2-18-83	RE
Rough OK	Date	Final OK	Date
3-15-83	RE	10-24-83	RE

- 4-14-83 Corrections - windows  
installed that are  
not on the plans. R.E.
- 4-25-83 Final lift bracket ~~SB~~
- 5-4-83 Roof nail inspection ~~OK~~  
Post anchors, Beams &  
roof joint system OK R.E.
- 5-5-83 Roof base sheet  
nailing. Corrections  
regarding straps over  
beam junctures. R.E.
- 5-27-83 Asphalt of base in  
parking lot area OK
- 6-16-83 Rough framing of plumb  
inside unit "B".
- 7-5-83 Drywall OK'd R.E.
- 9-23-83 Edison required changes  
in height of Parasol  
so elect. service still not  
finished - R.E.



CITY OF WHITTIER

Crest Map No. 100-272

8221 Santa Fe Sp. Rd official Address  
Lot 34 Block        Tract 6956  
35

City Easements

-Water-      -Sewer-      -Storm Drain-      -Other-  
As shown    As shown      As shown      NONE  
(None)      (None)      (None)  
Sewer main location and depth        ✓

Sewer charge: Amount due NONE  
Parkway width is 8 feet on SANTA FE SP RD

Information by JWN, date 12.16.82

Engineering Department Clearance

Req'd. Clear

Lot Split        ✓  
Right of Way        ✓  
Improvements        ✓ FP  
Grading Permit        ✓ FP  
Sewer Charge        ✓  
Driveway Approach        ✓ FP  
Field Investigation        ✓ FP

Date 12-20-82

Final Clearance by FP

City of WHITTIER

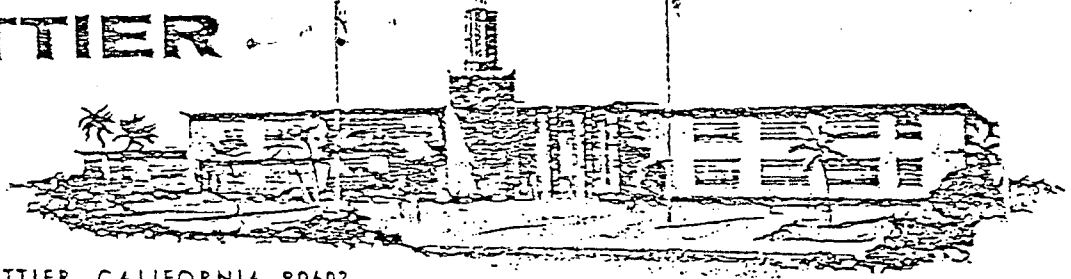

WHITTIER CIVIC CENTER

13230 EAST PENN STREET . WHITTIER, CALIFORNIA 90602

Date September 10, 1982

Mr. Eduardo Cenicerros  
8221-23 Santa Fe Springs Rd.  
Whittier, CA

Re: Zone Variance Request

Case No: V82-09

Action: Granted Conditionally

Dear Mr. Cenicerros:

The Whittier City Planning Commission, at their regular meeting of September 7, 1982 adopted enclosed Resolution No. P. C. 82-21 approving the request in the above-referenced case at 12561 Persing Drive & 8221-23 Santa Fe Springs Rd.

This approval shall become final and effective in 20 days from the date of adoption of the resolution unless appealed in writing by you, or any interested party, or the City Council determines to hold a public hearing on its own motion, within said 20-day period.

This approval was granted subject to the conditions listed in the enclosed resolution which must all be met before an occupancy permit can be issued or before the use granted can be started.

In addition, this approval is null and void if the use granted hereby is not commenced within one year from the date of adoption of the granting resolution (Section 9286 of Zoning Regulations).

If you have any question regarding the approval, or this letter, please do not hesitate to call the Planning Department.

Sincerely,

WHITTIER CITY PLANNING COMMISSION

Elvin H. Porter, Secretary

EHP:wh

Encl. Resolution No. P. C. 82-21

- cc: Engineering Dept.
- Building Dept.
- Police Dept.
- Public Services Dept.
- Community Development

RECEIVED  
SEP 10 1982  
BLDG.-SAFETY

RESOLUTION NO. P. C. 82-21

A RESOLUTION OF THE PLANNING COMMISSION  
OF THE CITY OF WHITTIER APPROVING A  
VARIANCE APPLICATION. (APPLICANT:  
EDUARDO CENICEROS; LOCATION: 12561 PERSING  
DRIVE AND 8221-23 SANTA FE SPRINGS ROAD;  
CASE NO: V82-09)

THE PLANNING COMMISSION OF THE CITY OF WHITTIER DOES RESOLVE  
AS FOLLOWS:

SECTION 1. The Planning Commission finds and determines:

(a) That an application for a variance was submitted by the owner of certain real property located at 12561 Persing Drive and 8221-23 Santa Fe Springs Rd. of Whittier, described more particularly as Lots 32, 34, and 35 of Tract No. 6956, Map Book 78, Page 55; and

(b) That the purpose of such application was to secure relief from Section 9132-2(a and b) and 9223-2(c) of the Whittier Municipal Code so as to allow the construction of a parking lot with parking spaces encroaching into required yard areas; and to allow the construction of an industrial building within the required 10 ft. rear yard area of an M zoned site; and

(c) That a duly noticed public hearing was held upon said application by the Planning Commission, and based upon the evidence presented, including applicable staff reports, and each member of the Commission being familiar with the property, it was determined that the facts required by the Whittier Municipal Code for the granting of such variance are:

(1) The lot fronting Persing Drive is of an irregular shape making conventional and efficient parking lot design difficult to achieve.

(2) The (P) overlay zone on the Persing Drive lot satisfies the purpose and intent of the required yard area, separation between residential and industrial uses.

(3) This request can promote the opportunity for future industrial growth without creating detrimental effects on surrounding properties.

SECTION 2. Based upon such determinations the Planning Commission hereby grants the variance subject to the following conditions:

(a) That development of the subject properties shall be in substantial compliance with Exhibit "A" except as may be otherwise modified by other following conditions.

(b) That the applicant shall dedicate 5 feet for street purposes from Lot 32 (Engineering); and

(c) That an agreement in a form as approved by the City Attorney shall be executed and recorded to run with the land between the applicant and the City of Whittier providing that applicant/owner or any future owner of subject property fronting onto Persing Drive pay their proportionate share of costs for the widening of said Persing Drive and that such payment be made at such time as the City Council so orders (Planning Commission); and

(d) That the applicant shall construct sidewalk to city standards where missing (Engineering); and

(e) That the applicant shall deposit \$126 with the Park Department for the purpose of planting three parkway trees (Park Dept.); and

(f) That the applicant shall submit to the Park Department detailed landscape and irrigation plans for their approval (Park Dept.); and

(g) That all other city regulations shall be complied with.

SECTION 3. That the Secretary of the Commission shall certify to the adoption of this resolution and shall forward a certified copy hereof to the City Clerk, to the applicant, and to any other person requesting the same.

PASSED AND APPROVED this 7th day of September, 1982, by the following vote:

AYES:	W. E. Thompson, Jr., C. R. Rollins, F. A. Bergerson, G. Trorey, E. K. Neslen
NOES:	None
ABSENT:	None

ATTEST

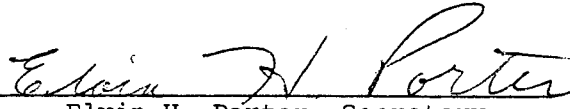
  
Elvin H. Porter, Secretary

100-272

82221+8223

8170-031-025

**BUILDING AND PLANNING USE ONLY**

Job Address: ~~2577~~ S. F. Springs Rd.

Use Zone	Fire Zone	Total Req'd Parking	Front	Req'd Rear	Yards S-N Sides
M	3	9	10	10	10-0

Type Const.	Group	Stories	Occ. Load	Ex. Use
II-N	F-2	1	38	

# Var. or P.P.	Valuation of Job	Plan No.
	\$53,800.00	8176

G.R.A. = 416 R#  
 FLOOR AREA = 3983 #

Remarks  
 Permit fee = \$195.00  
 P.C. " = 126.75  
 TOTAL FEES = 321.75  
 P.C. FEE PAID = 131.95  
 FEE DUE = 189.80

IT 7-6-77 done  
 GROUT Blocks up to Slab 8-24-77 done  
 9-19-77 1st lift w/m  
 GROUT To 5' 9-20-77 done  
 " " 8' 10-3-77 done  
 " " Top 10-24-77 done  
 11-18-77 roof frame except for 2 6"x6" supports w/m

Rough	Final
11-22-77 done	1-24-78 done
Plan # 131.95	No. 87592
Plan	No.
Check Fee	

Permit Fee 189.80

88225

DEPT. OF BUILDING BUILDING WHITTIER, CALIF.  
 Lot 3435 Blk. Tract 6956

Description of Work  
 Conc Block End Unit Bldg

BLOG # 1

Property Owner Andrew J. Pyka  
 Owner's Address 11619 E. Wash. Blvd  
 Whittier, Cal. Phone 6927748

Lender  
 Address  
 Architect J. B. Matson A.I.A.  
 State Lic. No. 5921 Phone 695-2109

Engineer " "  
 State Lic. No. " Phone "  
 Contractor Blume  
 Contractor's Address 11619 E. Wash. Blvd.  
 Phone

City Lic. No. State Lic. No.

I hereby acknowledge that I have read this application and state the above is correct and agree to comply with all ordinances and State laws. I hereby certify that I am properly registered and/or licensed as required by the City of Whittier and/or State of California, or that I am the legal owner of the above described property, and I certify that in the performance of the work for which this permit is issued I shall not employ any person in violation of the workmen's compensation laws of California.  
 Signature of Permittee Andrew J. Pyka

WHEN VALIDATED THIS IS YOUR PERMIT

+	3.77	State Tax			
MAY-23-77	963886	CK 87592	0	D-1	131.95
JUN-5-77	974670	CK 88225	0	D-2	189.80
JUL-5-77	974670	CK 1000 204		D-18-	3.77

Sh Rock 11-28-77 dm

F.P.O.F ENGINEERING SAYS  
OK TO FINAL - HOLDING  
BONDS FOR PKWAY FINAL

June 1-24-78

11-28-77

11-28-77

11-28-77

11-28-77  
11-28-77  
11-28-77

Rest Map No. 100-272

CITY OF WHITTIER

8223 - 8213

~~105#~~ SANTA FE SPRINGS official Address

Lot \_\_\_\_\_ Block \_\_\_\_\_ Tract 6950

33, 34, 35

8213  
18217  
18223

City Easements

Water- As shown None  
-Sewer- As shown None  
-Storm Drain- As shown None  
-Other- \_\_\_\_\_

Sewer main location and depth in Street

Sewer charge: Amount due None

Parkway width is 8' feet on Santa Fe Springs  
variable width pky on Penning.

Information by HS, date 5/23/77

Need Traffic Eng. Approval for  
Dwgs SIGNED PILOT 7-1-77 EG  
Engineering Department Clearance

Req'd. Clear

Lot Split	_____	<input checked="" type="checkbox"/>
Right of Way	_____	<input checked="" type="checkbox"/>
Improvements	_____	<input checked="" type="checkbox"/>
Grading Permit	_____	<input checked="" type="checkbox"/>
Sewer Charge	_____	<input checked="" type="checkbox"/>
Driveway Approach	<input checked="" type="checkbox"/>	<input checked="" type="checkbox"/> <u>AS NOTED</u>
Field Investigation	_____	<input checked="" type="checkbox"/>

Date 7-1-77

Final Clearance by M. J. Baker

Date: 5-23-77

7-1-77

# PLOT PLAN

STREET

ADDRESS

OF JOB

8213, 8221 & 8223 SANTA FE

8223 SPRINGS RD.

SPRINGS RD.

DEPT. OF BLDG.

WHITTIER, CALIF.

LOT

BLK.

TRACT

33, 34, 35

6956

PERSHING

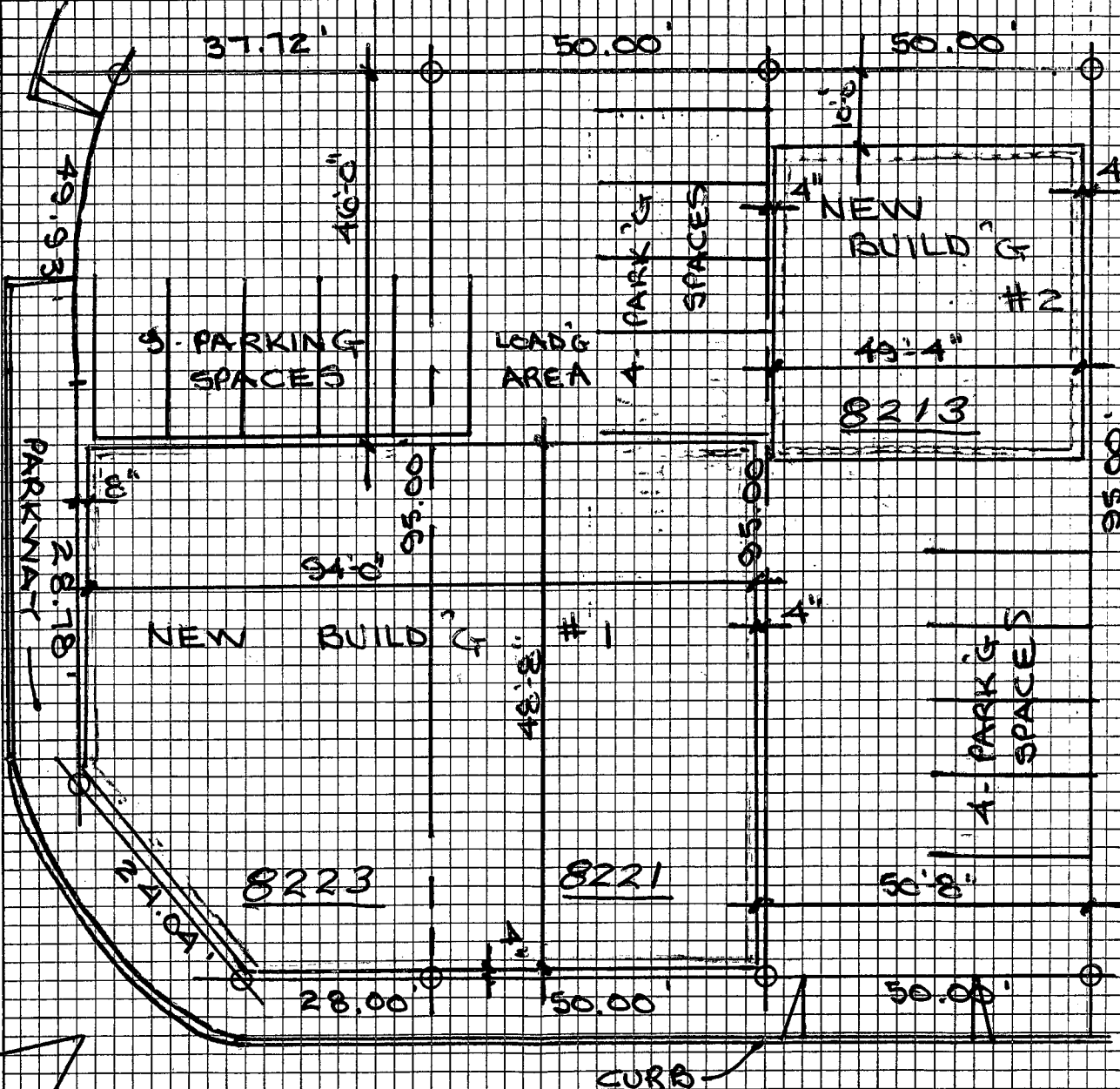
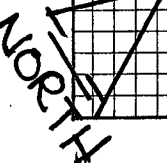

SANTA

FE

SPRINGS RD.



City of Whittier

Dept. of Building & Safety

APPROVED

THIS APPROVAL SHALL NOT BE CON-  
STRUED TO BE AUTHORITY TO VIOLATE  
OR CANCEL ANY PERTINENT CITY OR  
STATE ORDINANCES.

Permit No. 88226

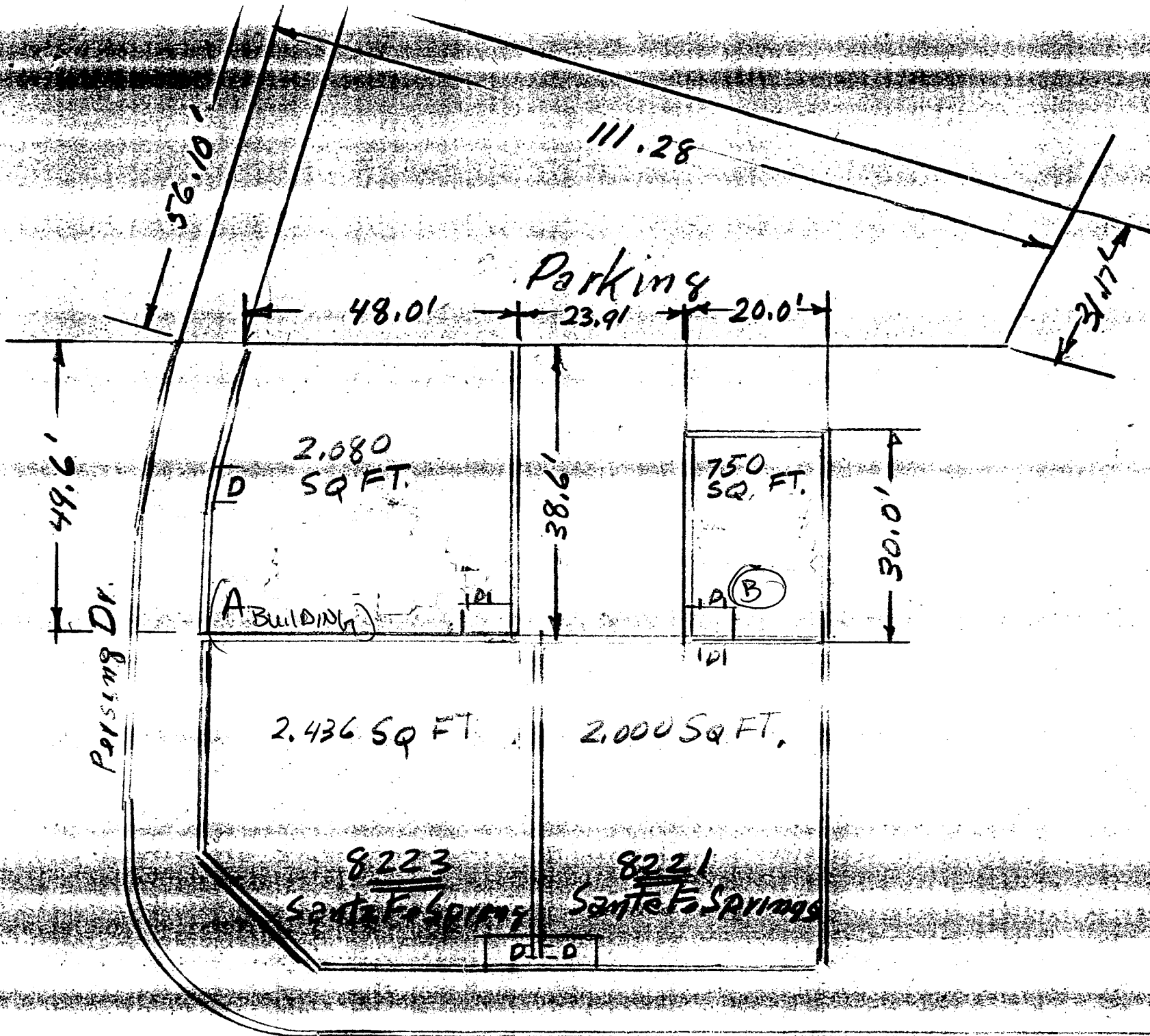

Santa Fe Springs Dr

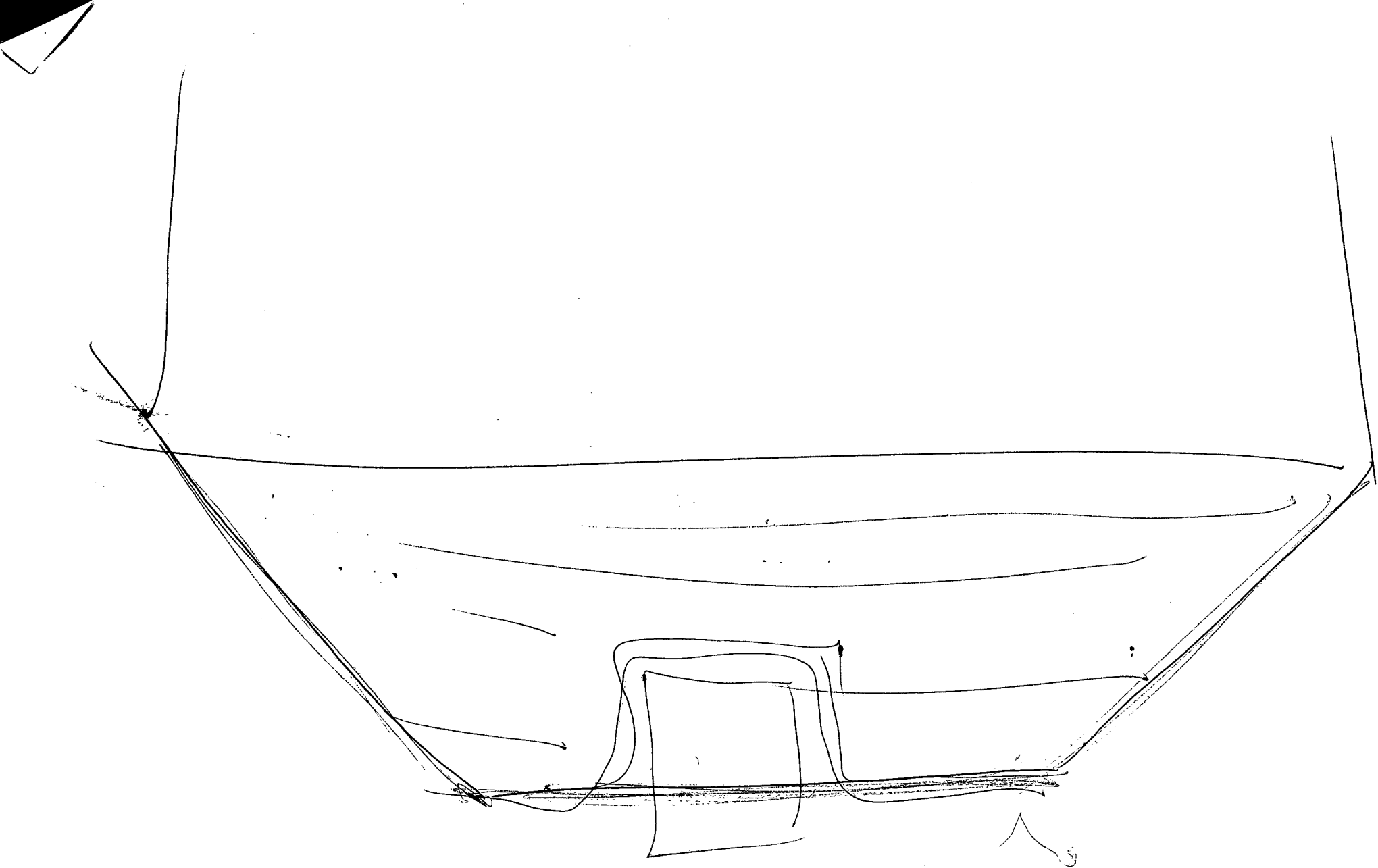

8223 Santa Fe Springs Road

8170-031-025

PERMIT FEES	No.	Each	Fee
Residence 750 sq. ft. max.		\$13.00	
Residence 1000 sq. ft. max.		\$17.50	
Residence 1400 sq. ft. max.		\$24.50	
Residence 1700 sq. ft. max.		\$30.00	
Residence 2000 sq. ft. max.		\$35.00	
Residence 2500 sq. ft. max.		\$44.00	
Residence 3000 sq. ft. max.		\$52.50	
Residence over 3000 sq. ft.		\$61.00	
RANGE or OVEN (ea.)		\$ 2.00	
CLOTHES DRYER		\$ 2.00	
SPACE/WATER HTR. (ea.)		\$ 2.00	
TIME CLOCK		\$ 2.00	
FIXTURES		\$ .25	
OUTLETS		\$ .25	
TEMPORARY POLE		\$ 6.00	
SERVICE (200 AMP. MAX.)		\$ 6.00	
(OVER 200 AMP.)		\$12.00	
SIGN (INC. TIME CLOCK)		\$ 8.00	
TEMP. LIGHTING		\$ 6.00	
<b>MOTORS:</b>			
1 H.P. MAX.	2	\$ 2.00	4.00
10 H.P. MAX.	5	\$ 5.00	25.00
50 H.P. MAX.		\$ 8.00	
100 H.P. MAX.		\$15.00	
500 H.P. MAX.		\$22.50	
OVER 500 H.P.		\$30.00	
FILING FEE			\$5.00
PLAN CHECK FEE (OVER 1200 A.)			
<b>TOTAL FEES</b>			<b>34.00</b>

STREET ADDRESS OF JOB

**ELECTRIC**

DEPT. OF BLDG.

WHITTIER, CALIF.

ELECTRICAL CONTRACTOR **K. D. Miller Electric, Inc.**

CONTRACTOR'S ADDRESS **12534 E. Washington Blvd.**

CONTRACTOR'S PHONE **698-3756**

CITY REG. NO. **10410**

STATE LICENSE NO. **155604**

PROPERTY OWNER **H & N Tool & Die Co.**

PURPOSE OF BLDG. **Machine Shop**

NEW BLDG.  EXISTING BLDG.  NO. OF METERS

REMARKS:

I hereby acknowledge that I have read this application and state the above is correct and agree to comply with all ordinances and State Laws. I hereby certify that I am properly registered and/or licensed as required by the City of Whittier and/or State of California, or that I am the legal owner of the above described property, and I certify that in the performance of the work for which this permit is issued I shall not employ any person, and that I shall purchase workers' compensation insurance before I employ any person on work for which this permit is issued.

**K. D. Miller Electric, Inc.**

Signature of Permittee

*K. D. Miller*

ROUGH

FINAL  
**2-22-78**  
*Jay*

LIGHTS CLEARED TO UTILITY CO.

POWER CLEARED TO UTILITY CO.

Permit NO.

**91067**

FEE

**\$34.00**

91067

2/22/78

34.00

EP



COUNTY OF LOS ANGELES  
 Department of County Engineer  
 DIVISION OF BUILDING & SAFETY  
 WILLIAM J. FOX, County Engineer

APPLICATION FOR PERMIT

**ELECTRIC 1**

**FOR APPLICANT TO FILL IN**

ELECTRICIAN \_\_\_\_\_

ADDRESS \_\_\_\_\_

CITY \_\_\_\_\_ TEL. NO. \_\_\_\_\_

COUNTY LICENSE NO. \_\_\_\_\_ EXPIRES \_\_\_\_\_

**PERMIT FEES**

	NUMBER	EACH	FEE
LIGHT OUTLETS			
RECEPTACLES			
WALL SWITCHES			
TOTAL OUTLETS		5c	\$
ELEC. RANGES		25	
ELEC. HEATERS		25	
FIXTURES		5	
MISC.			
NUMBER OF LIGHT CIRCUITS			
NUMBER OF RECEPTACLE CIRCUITS			

**MOTORS**

NUMBER	NEW	MVD.	HP	HORSEPOWER		FEE EACH
				OVER	INC.	
				1/2 & LESS		\$.25
				1/2	2	.50
				2	5	1.00
				5	15	1.50
				15	50	2.50
				50	200	5.00
				200	500	10.00
				500	1000	15.00
				OVER 1000		20.00

M.B. SET/FREQ. CHANGER-HP \_\_\_\_\_

WELDERS: AC-KVA \_\_\_\_\_

GENERATORS - KW \_\_\_\_\_

TRANSFORMERS - KVA \_\_\_\_\_

TEMP. MOTORS (75% OF ORIG.) \_\_\_\_\_

MOVED MOTORS (75% OF ORIG.) \_\_\_\_\_

MISC. *Handwritten signature* 100

**SIGNS**

NO. \_\_\_\_\_ NO. TRANS. \_\_\_\_\_

NO. \_\_\_\_\_ NO. LAMPS \_\_\_\_\_

**FOR EACH PERMIT:**

WIRING	\$1.00	100
FIXTURES	\$1.00	
SUPPLEMENTARY	.50	
<b>TOTAL FEE</b>		\$ 200

DISTRICT NO. 11	GROUP I	ZONE	PERMIT NO. 58745
RECEIVED BY <i>Mathews</i>	READY FOR FIRST INSPECTION	DATE ISSUED 12-10-52	

BUILDING ADDRESS *8223 Santa Fe Springs Rd*

LOCALITY *Perrine at*

NEAREST CROSS ST. *Perrine at*

OWNER *Fred R. Rappier*

MAIL ADDRESS *8223 Santa Fe Springs Rd*

CITY *Unhottin* TEL. NO. *631918*

I HEREBY ACKNOWLEDGE THAT I HAVE READ THIS APPLICATION AND STATE THAT THE ABOVE IS CORRECT AND AGREE TO COMPLY WITH ALL COUNTY ORDINANCES AND STATE LAWS REGULATING ELECTRICAL WIRING.

I CERTIFY THAT I POSSESS THE ABOVE VALID LOS ANGELES COUNTY LICENSE, OR I AM THE LEGAL OWNER OF THE RESIDENTIAL PROPERTY DESCRIBED ABOVE.

SIGNATURE OF PERMITTEE *Fred R. Rappier*

**INSPECTION RECORD**

*Request for 100 permits made on 12-15-52*

ORIGINAL

**APPROVALS**

	DATE	INSPECTOR'S NAME
CONDUIT		
WIRING		
FIXTURES		
POWER		
UTILITY CO. NOTIFIED		
FINAL	<i>12/10/52</i>	<i>Law</i>

DEPARTMENT OF BUILDING AND SAFETY  
COUNTY OF LOS ANGELES  
WILLIAM J. FOX, CHIEF ENGINEER

8170-031-025  
APPLICATION FOR PERMIT

**ELECTRIC 1**

FOR APPLICANT TO FILL IN				DISTRICT NO.	GROUP	ZONE	PERMIT NO.
ELECTRICIAN <i>Cause Emerald</i>				<i>11</i>	<i>F</i>	<i>M3</i>	<i>128816</i>
ADDRESS <i>657 Hereford dr</i>				RECEIVED BY	READY FOR FIRST INSPECTION		DATE ISSUED
CITY <i>Montebello PK J</i> TEL. NO. <i>UN 18553</i>				<i>WJS</i>			<i>7-10-50</i>
COUNTY LICENSE NO. <i>1304</i> EXPIRES <i>1950</i>				BUILDING ADDRESS <i>8223 Sta Fe Springs Rd</i>			
<b>PERMIT FEES</b>				LOCALITY <i>Whittier, Calif.</i>			
NUMBER	OUTLETS EACH		FEE	NEAREST CROSS ST. <i>Persing</i>			
	LIGHT	50	\$	OWNER <i>Fred Rippey</i>			
<i>2</i>	RECEPTACLES	5	<i>10</i>	MAIL ADDRESS <i>Same</i>			
	FIXTURES	5		CITY <i>Same</i> TEL. NO.			
	WALL SWITCHES	5		I HEREBY ACKNOWLEDGE THAT I HAVE READ THIS APPLICATION AND STATE THAT THE ABOVE IS CORRECT AND AGREE TO COMPLY WITH ALL COUNTY ORDINANCES AND STATE LAWS REGULATING ELECTRICAL WIRING.			
	ELEC. RANGES	25		I CERTIFY THAT I POSSESS THE ABOVE VALID LOS ANGELES COUNTY LICENSE, OR I AM THE LEGAL OWNER OF THE RESIDENTIAL PROPERTY DESCRIBED ABOVE.			
	ELEC. HEATERS	25		SIGNATURE OF PERMITTEE <i>Cause Emerald</i>			
	MISC.			<b>INSPECTION RECORD</b>			
NUMBER OF CIRCUITS INSTALLED:				7/11/50 Requires separate circuits for 17A & 3/4 HP motors on same circuit			
LIGHTS				3/4 HP motor in drop and requires conduit			
RECEPTACLES				Balance OK - OK			
MOTORS				ORIGINAL			
NUMBER		HORSEPOWER		FEE EACH			
NEW	MVD.	HP	OVER	INC.			
	<i>2 x</i>	<i>1/2</i>	<i>-10 1/2</i>	<i>1/2 &amp; LESS</i>	<i>\$ .25</i>	<i>7.5</i>	
<i>✓</i>	<i>2 x</i>	<i>1/4</i>	<i>+10 1/2</i>	<i>2</i>	<i>.50</i>	<i>2.00</i>	
	<i>1/2 x</i>	<i>1/2</i>	<i>2</i>	<i>5</i>	<i>1.00</i>	<i>2.00</i>	
			<i>5</i>	<i>15</i>	<i>1.50</i>		
			<i>15</i>	<i>50</i>	<i>2.50</i>		
			<i>50</i>	<i>200</i>	<i>5.00</i>		
			<i>200</i>	<i>500</i>	<i>10.00</i>		
			<i>500</i>	<i>1000</i>	<i>15.00</i>		
			<i>OVER 1000</i>		<i>20.00</i>		
M.G. SET/FREQ. CHANGER-HP							
WELDERS: AC-KVA							
GENERATORS - KW							
TRANSFORMERS - KVA							
TEMP. MOTORS (75% OF ORIG.)							
MOVED MOTORS (75% OF ORIG.)							
MISC. <i>1 Receptacle PKW</i>				<i>.50</i>			
SIGNS							
TYPE:				NO. TRANS.			
TYPE:				NO. LAMPS			
FOR EACH PERMIT:				<b>APPROVALS</b>			
WIRING				DATE	INSPECTOR'S NAME		
FIXTURES							
SUPPLEMENTARY							
TOTAL FEE				CONDUIT			
<i>\$ 5.35</i>				WIRING			
				FIXTURES			
				POWER			
				UTILITY CO. NOTIFIED			
				FINAL			

DEPARTMENT OF BUILDING AND SAFETY  
COUNTY OF LOS ANGELES  
WILLIAM J. FOX, CHIEF ENGINEER

8170-031-025  
APPLICATION FOR PERMIT**ELECTRIC 1**

FOR APPLICANT TO FILL IN				DISTRICT NO.	GROUP	ZONE	PERMIT NO.		
ELECTRICIAN <b>Conse A. Emerald</b>				11	F	M3	123233		
ADDRESS <b>6057 Hereford drive</b>				RECEIVED BY	READY FOR FIRST INSPECTION	DATE ISSUED			
CITY <b>Montebello PK</b> TEL. NO. <b>UN18553</b>				<i>[initials]</i>	<b>Now</b>	<b>5-22-50</b>			
COUNTY LICENSE NO. <b>1304</b> EXPIRES <b>1950</b>				BUILDING ADDRESS <b>8223 St. Fe Springs Rd</b>					
<b>PERMIT FEES</b>				LOCALITY <b>Whittier</b>					
NUMBER	OUTLETS EACH		FEE	NEAREST CROSS ST. <b>Persing Drive</b>					
<b>11</b>	LIGHT	5c	<b>\$ 55</b>	OWNER <b>Fred Ripby</b>					
<b>14</b>	RECEPTACLES	5	<b>70</b>	MAIL ADDRESS <b>same</b>					
<b>11</b>	FIXTURES	5	<b>55</b>	CITY <b>Whittier</b> TEL. NO. <b>OX 44516</b>					
<b>3</b>	WALL SWITCHES	5	<b>15</b>	I HEREBY ACKNOWLEDGE THAT I HAVE READ THIS APPLICATION AND STATE THAT THE ABOVE IS CORRECT AND AGREE TO COMPLY WITH ALL COUNTY ORDINANCES AND STATE LAWS REGULATING ELECTRICAL WIRING. I CERTIFY THAT I POSSESS THE ABOVE VALID LOS ANGELES COUNTY LICENSE, OR I AM THE LEGAL OWNER OF THE RESIDENTIAL PROPERTY DESCRIBED ABOVE.					
<b>1</b>	ELEC. RANGES (for <del>25</del> )		<b>25</b>						
<b>5</b>	ELEC. HEATERS	25							
MISC.				SIGNATURE OF PERMITTEE <b>Conse A. Emerald</b>					
NUMBER OF CIRCUITS INSTALLED: TOTAL				<b>INSPECTION RECORD</b>					
LIGHTS <b>3</b>	RECEPTACLES <b>4</b>								
<b>MOTORS</b>				<p><i>[Handwritten: Spoke to insurance permit for motors &amp; wire &amp; wattage of heater]</i></p>					
NUMBER	HORSEPOWER		FEE EACH						
NEW	MVD.	HP	OVER					INC.	
			1/2 & LESS					\$ .25	
			1/2					2	.50
			2					5	1.00
			5					15	1.50
			15					50	2.50
			50					200	5.00
			200					500	10.00
			500	1000	15.00				
			OVER 1000		20.00				
M.G. SET/FREQ. CHANGER-HP				<b>APPROVALS</b>					
WELDERS: AC-KVA									
GENERATORS - KW									
TRANSFORMERS - KVA									
TEMP. MOTORS (75% OF ORIG.)									
MOVED MOTORS (75% OF ORIG.)									
MISC.				DATE					
<b>SIGNS</b>				INSPECTOR'S NAME					
TYPE:		NO. TRANS.		CONDUIT					
TYPE:		NO. LAMPS		WIRING					
FOR EACH PERMIT:				FIXTURES					
WIRING		<b>2X \$1.00</b>		POWER					
FIXTURES		<b>2X \$1.00</b>		UTILITY CO. NOTIFIED					
SUPPLEMENTARY		<b>.50</b>		FINAL		<b>10/17/50</b>			
<b>TOTAL FEE</b>									

ORIGINAL

325



DEPARTMENT OF BUILDING AND SAFETY  
COUNTY OF LOS ANGELES  
WILLIAM J. FOX, CHIEF ENGINEER

8170-031-025  
APPLICATION FOR PERMIT

**ELECTRIC 1**

FOR APPLICANT TO FILL IN				DISTRICT NO.	GROUP	ZONE	PERMIT NO.																																																																									
ELECTRICIAN <i>Conse A Emerald</i>				<i>11</i>	<i>F</i>	<i>M3</i>	<i>123243</i>																																																																									
ADDRESS <i>6057 Hereford dr</i>				RECEIVED BY	READY FOR FIRST INSPECTION		DATE ISSUED																																																																									
CITY <i>L.A.</i> TEL. NO. <i>UN18553</i>				<i>[Signature]</i>			<i>5/23/50</i>																																																																									
COUNTY LICENSE NO. <i>1304</i> EXPIRES <i>1950</i>				BUILDING ADDRESS <i>8223 State Springs Rd</i>																																																																												
<b>PERMIT FEES</b>				LOCALITY <i>Whittier</i>																																																																												
NUMBER	OUTLETS EACH		FEE	NEAREST CROSS ST. <i>Persing</i>																																																																												
	LIGHT	5c	\$	OWNER <i>Fred Riphey</i>																																																																												
<i>14</i>	RECEPTACLES	5	<i>70</i>	MAIL ADDRESS <i>Same</i>																																																																												
	FIXTURES	5		CITY <i>Same</i> TEL. NO.																																																																												
	WALL SWITCHES	5		I HEREBY ACKNOWLEDGE THAT I HAVE READ THIS APPLICATION AND STATE THAT THE ABOVE IS CORRECT AND AGREE TO COMPLY WITH ALL COUNTY ORDINANCES AND STATE LAWS REGULATING ELECTRICAL WIRING.																																																																												
<i>1</i>	ELEC. RANGES <i>(furnace)</i>	25	<i>25</i>	I CERTIFY THAT I POSSESS THE ABOVE VALID LOS ANGELES COUNTY LICENSE, OR I AM THE LEGAL OWNER OF THE RESIDENTIAL PROPERTY DESCRIBED ABOVE.																																																																												
	ELEC. HEATERS	25		SIGNATURE OF PERMITTEE <i>Conse A. Emerald</i>																																																																												
	MISC.			<b>INSPECTION RECORD</b>																																																																												
NUMBER OF CIRCUITS INSTALLED:				<table border="1"> <thead> <tr> <th>NUMBER</th> <th colspan="2">HORSEPOWER</th> <th>FEE EACH</th> </tr> <tr> <th>NEW</th> <th>MVD.</th> <th>HP</th> <th>OVER</th> <th>INC.</th> <th></th> </tr> </thead> <tbody> <tr> <td></td> <td></td> <td></td> <td><math>\frac{1}{2}</math> &amp; LESS</td> <td>2</td> <td></td> <td>\$.25</td> </tr> <tr> <td></td> <td></td> <td></td> <td><math>\frac{1}{2}</math></td> <td>2</td> <td></td> <td>.50</td> </tr> <tr> <td></td> <td></td> <td></td> <td>2</td> <td>5</td> <td></td> <td>1.00</td> </tr> <tr> <td></td> <td></td> <td></td> <td>5</td> <td>15</td> <td></td> <td>1.50</td> </tr> <tr> <td></td> <td></td> <td></td> <td>15</td> <td>50</td> <td></td> <td>2.50</td> </tr> <tr> <td></td> <td></td> <td></td> <td>50</td> <td>200</td> <td></td> <td>5.00</td> </tr> <tr> <td></td> <td></td> <td></td> <td>200</td> <td>500</td> <td></td> <td>10.00</td> </tr> <tr> <td></td> <td></td> <td></td> <td>500</td> <td>1000</td> <td></td> <td>15.00</td> </tr> <tr> <td></td> <td></td> <td></td> <td>OVER 1000</td> <td></td> <td></td> <td>20.00</td> </tr> </tbody> </table>				NUMBER	HORSEPOWER		FEE EACH	NEW	MVD.	HP	OVER	INC.					$\frac{1}{2}$ & LESS	2		\$.25				$\frac{1}{2}$	2		.50				2	5		1.00				5	15		1.50				15	50		2.50				50	200		5.00				200	500		10.00				500	1000		15.00				OVER 1000			20.00
NUMBER	HORSEPOWER		FEE EACH																																																																													
NEW	MVD.	HP	OVER					INC.																																																																								
			$\frac{1}{2}$ & LESS					2		\$.25																																																																						
			$\frac{1}{2}$					2		.50																																																																						
			2					5		1.00																																																																						
			5					15		1.50																																																																						
			15					50		2.50																																																																						
			50					200		5.00																																																																						
			200					500		10.00																																																																						
			500	1000		15.00																																																																										
			OVER 1000			20.00																																																																										
LIGHTS				M.G. SET/FREQ. CHANGER-HP																																																																												
RECEPTACLES				WELDERS: AC-KVA																																																																												
MOTORS				GENERATORS - KW																																																																												
				TRANSFORMERS - KVA																																																																												
				TEMP. MOTORS (75% OF ORIG.)																																																																												
				MOVED MOTORS (75% OF ORIG.)																																																																												
MISC.				MISC.																																																																												
				SIGNS																																																																												
				TYPE: NO. TRANS.																																																																												
				TYPE: NO. LAMPS																																																																												
FOR EACH PERMIT:				<b>APPROVALS</b>																																																																												
WIRING \$1.00 <i>1 00</i>				DATE <i>5/20/50</i> INSPECTOR'S NAME <i>[Signature]</i>																																																																												
FIXTURES \$1.00				CONDUIT																																																																												
SUPPLEMENTARY .50				WIRING																																																																												
TOTAL FEE \$ <i>1 95</i>				FIXTURES																																																																												
				POWER																																																																												
				UTILITY CO. NOTIFIED <i>10/5/50</i>																																																																												
				FINAL <i>[Signature]</i>																																																																												

ORIGINAL

DEPT. USE ONLY

BUILDING & PLANNING

Job Address:

8170-031-025

8223 STA. FE SPRINGS

Use Zone	Total Req'd Parking	Req'd Yards		
R1		Front	Rear	Sides

BUILDING

DEPT. OF BUILDING

WHITTIER, CALIF.

Lot	35	Blk.		Tract	6956
-----	----	------	--	-------	------

Description of Work

DEMOLISH RESIDENCE

FILL CESSPOOL & TANK

Fire Zone	Type Const.	Group	No. of Stories	Occupant Load	Exist. Use
3					

# Variance or Precise Plan	Lot	Int. Cor.	Rev. Cor.	Valuation of Job
		<input type="checkbox"/>	<input checked="" type="checkbox"/>	\$400.00

Job Area	Plan No.
800 #	

Remarks

ORIGINAL COPY

Sewer cap in 5' deep and 3'0" inside new property line as per location in Engineers' office

Owner CITY OF WHITTIER

Owner's Address

Phone

Architect

State Lic. No.

Phone

Engineer

State Lic. No.

Phone

Contractor VIKING LAND CLEARING INC

Contractor's Address 14741 RAYMER ST

VAN NUYS Phone 786 121

City Lic. No. 235859

Rough	Final

Plan	No.

Check Fee	No.

Plan	No.

Check Fee	No.

Permit Fee	No.

I hereby acknowledge that I have read this application and state the above is correct and agree to comply with all ordinances and State laws. I hereby certify that I am properly registered and/or licensed as required by the City of Whittier and/or State of California, or that I am the legal owner of the above described property, and I certify that in the performance of the work for which this permit is issued I shall not employ any person in violation of the workmen's compensation laws of California.

Signature of Permittee [Signature]

WHEN VALIDATED THIS IS YOUR PERMIT

ED 1-68

NO FEE

10/8/68

APPLICATION FOR PERMIT

# PLUMBING

DEPARTMENT OF BUILDING AND SAFETY  
 COUNTY OF LOS ANGELES  
 WILLIAM J. FOX, CHIEF ENGINEER

FOR APPLICANT TO FILL IN

PLUMBER *H. V. Sartin*  
 ADDRESS *207 E. Whittier Blvd*  
 CITY *Whittier* TEL. NO. *417552*  
 COUNTY LICENSE NO. *2511M* EXPIRES

PERMIT FEES

NUMBER	TYPE OF FIXTURE OR ITEM	FEE
1	WATER CLOSET (TOILET) @ 0.50	\$
1	BATH TUB @ 0.50	
	SHOWER @ 0.50	
1	LAVATORY (WASH BASIN) @ 0.50	
	KITCHEN SINK @ 0.50	
	LAUNDRY TUB OR TRAY @ 0.50	
	GAS SYSTEM OUTLETS @ 0.50	
	WATER HEATER @ 0.50	
	SLOP SINK @ 0.50	
	FLOOR SINK @ 0.50	
	FLOOR DRAIN @ 0.50	
	DISHWASHER @ 0.50	
	DRINKING FOUNTAIN @ 0.50	
	URINAL @ 0.50	
	HOUSE SEWER @ 0.50	
	MISCELLANEOUS	
	CESSPOOL @ 1.00	
	SEPTIC TANK:	
	DRAIN ( ) PIT ( ) @ 1.00	
PERMIT		1.00

TOTAL FEE

\$ *250*

DISTRICT NO. *11* GROUP *F* ZONE *M3* PERMIT NO. *62087*  
 RECEIVED BY *IKS* READY FOR FIRST INSPECTION DATE ISSUED *1-30-50*  
 BUILDING ADDRESS *8223 Acutehale Logo Rd*  
 LOCALITY *Whittier*  
 NEAREST CROSS ST. *Forsberg*  
 OWNER *Fred Pipefay*  
 MAIL ADDRESS  
 CITY TEL. NO.

I HEREBY ACKNOWLEDGE THAT I HAVE READ THIS APPLICATION AND STATE THAT THE ABOVE IS CORRECT AND AGREE TO COMPLY WITH ALL COUNTY ORDINANCES AND STATE LAWS REGULATING PLUMBING.  
 I CERTIFY THAT I POSSESS THE ABOVE VALID LOS ANGELES COUNTY LICENSE, OR I AM THE LEGAL OWNER OF THE RESIDENTIAL PROPERTY DESCRIBED ABOVE.

SIGNATURE OF PERMITTEE *H. V. Sartin*

*1/30/50* INSPECTION RECORD  
*underneath rough Pipe c.b.*  
*J. Farrell*

ORIGINAL

APPROVALS

	DATE	INSPECTOR'S NAME
ROUGH PLUMBING	<i>4/14/50</i>	<i>ON</i>
GAS PIPING		
GAS VENT		
CESSPOOL		
SEPTIC TANK		
SEWER		
GAS TEST		
UTILITY CO. NOTIFIED		
FINAL	<i>10/12/50</i>	<i>871</i>

DECLARATIONS

DO NOT SEPARATE

The Declarations below are mandated by the State of California under Section 19825 of The Health and Safety Code.

- APPLICANT -

CONTRACTOR: FILL IN DECLARATION 1, 3, 4 AND 5

OWNER: FILL IN DECLARATION 2, 4 AND 5

1. LICENSED CONTRACTOR'S DECLARATION

I hereby affirm that I am licensed under provisions of Chapter 9 (commencing with Section 7000) of Division 3 of the Business and Professions Code, and my license is in full force and effect.

License Class B-1 License No. 480674

Date 7/16/96 Contractor CITY CONST

10/31/97

2. OWNER-BUILDER DECLARATION

I hereby affirm that I am exempt from the Contractor's License Law for the following reason (Sec. 7031.5, California Business and Professions Code: Any City which requires a permit to construct, alter, improve, demolish or repair any structure, prior to its issuance, also requires the applicant for such permit to file a signed statement that he is a licensed contractor pursuant to the provisions of the Contractor's License Law (Ch. 9 (Commencing with Sec. 7000) of Div. 3 of the B. & P. C.) or that he is exempt therefrom and the basis for the alleged exemption. Any violations of Sec. 7031.5 by any applicant for a permit subjects the applicant to a civil penalty of not more than five hundred dollars (\$500.00).):

I, as owner of the property, or my employees with wages as their sole compensation, will do the work, and the structure is not intended or offered for sale (Sec. 7044, B. & P. C.: The Contractor's License Law does not apply to an owner of property who builds or improves thereon, and who does such work himself or through his own employees, provided that such improvements are not intended or offered for sale. If, however, the building or improvement is sold within one year of completion, the owner-builder will have the burden of proving that he did not build or improve for the purpose of sale.)

I, as owner of the property, am exclusively contracting with licensed contractors to construct the project (Sec. 7044, B. & P. C.: The Contractor's License Law does not apply to an owner of contracts for such projects with a contractor(s) licensed pursuant to the Contractor's License Law.)

I am exempt under Sec. \_\_\_\_\_, B. & P. C. for this reason:

Date \_\_\_\_\_ Owner \_\_\_\_\_

3. WORKER'S COMPENSATION DECLARATION

I hereby affirm that I have a certificate of consent to self-insure or a certificate of worker's Compensation Insurance or a certified copy thereof. (Sec. 3800, Lab. C.)

Policy No. \_\_\_\_\_ Company \_\_\_\_\_

- Certified copy is hereby furnished.
- Certified copy is filed with the Department of Building & Safety.

Date \_\_\_\_\_ Applicant \_\_\_\_\_

CERTIFICATE OF EXEMPTION FROM WORKER'S COMPENSATION INSURANCE

I certify that in the performance of the work for which this permit is issued, I shall not employ any person in any manner so as to become subject to the Worker's Compensation Laws of California.

Date 7/16/96 Applicant SAFIE PAC

NOTICE TO APPLICANT: If, after making this Certificate of Exemption, you should become subject to the Work's Comp. provisions of the Labor Code, you must forthwith comply with such provisions or this permit shall be deemed revoked.

4. CONSTRUCTION LENDING AGENCY

I hereby affirm that there is a construction lending agency for the performance of the work for which this permit is issued (Sec. 3907, Civ. C.)

Lender's Name NOM

Lender's Address \_\_\_\_\_

5.

I certify that I have read this application and state that the above information is correct. I agree to comply with all City, and State laws relating to the building construction, and hereby authorize representatives of this City to enter upon the above-mentioned property for inspection purposes.

[Signature] 7/16  
Signature of Owner or Contractor ONLY Date

- IMPORTANT -

Application is hereby made to the Superintendent of Building and Safety for a permit subject to the conditions and restrictions set forth on the front and rear faces of this application.

1. Each person upon whose behalf this application is made and each person at whose request and for whose benefit work is performed under or pursuant to any permit issued as a result of this application agrees to and shall, indemnify and hold harmless the City of Whittier, its officers, agents and employees.

2. Any permit issued as a result of this application becomes null and void if work is not commenced within ONE HUNDRED EIGHTY (180) DAYS from date of issuance of such permit.

PERMIT FEES	No.	Each	Fee
Residence 750 sq. ft. max.			
Residence 1000 sq. ft. max.			
Residence 1400 sq. ft. max.			
Residence 1700 sq. ft. max.			
Residence 2000 sq. ft. max.			
Residence sq. ft.			
POOL OR SPA			
RANGE or OVEN (ea.)			
CLOTHES DRYER			
SPACE/WATER HTR. (ea.)			
TIME CLOCK			
FIXTURES			
OUTLETS/SWITCHES	5	70	3.50
TEMPORARY POLE			
SERVICE AMP.			
SUBPANEL			
SIGN (INC. TIME CLOCK)			
TEMP. LIGHTING			
MOTORS:			
5 H.P. MAX.	1		5.00
10 H.P. MAX.			
50 H.P. MAX.			
100 H.P. MAX.			
500 H.P. MAX.			
OVER 500 H.P.			
FILING FEE			15.00
PLAN CHECK FEE (OVER 1200 A.)			
TOTAL FEES			23.50
ROUGH			
FINAL			7-18-96
LIGHTS CLEARED TO UTILITY CO.			
POWER CLEARED TO UTILITY CO.			

JOB ADDRESS

8223 SANTA FE SPA

**ELECTRIC**

DEPT. OF BLDG. WHITTIER, CALIF.

ELECTRICAL CONTRACTOR  
CITY CONSTRUCT

CONTRACTOR'S ADDRESS  
1227E CALIFORNIA BL

CONTRACTOR'S PHONE 818-241-4844 CITY BUS. LIC. NO. 053291

PROPERTY OWNER  
ROYAL AMHC

OWNER'S ADDRESS  
8223 SANTA FE SP

Whittier CA

NEW BLDG.  EXISTING BLDG.  COM'L. RES'L.

7-21796-connections

07/16/96 10:04AM 000001#8333 19:01

1000-344 420.00

CALL EDISON CO. FOR METER LOCATION

PRIOR TO CONSTRUCTION

PERMIT NO.

**071931**

FEE

**23.50**

8170-031-025

PERMIT FEES	No.	Each	Fee
Residence 750 sq. ft. max.		\$ 5.00	
Residence 1000 sq. ft. max.		\$ 7.50	
Residence 1400 sq. ft. max.		\$10.00	
Residence 1700 sq. ft. max.		\$15.00	
Residence 2000 sq. ft. max.		\$20.00	
Residence over 2000 sq. ft.		\$25.00	
RANGE		\$ 1.00	
OVEN		\$ 1.00	
SPACE HTR.		\$ 1.00	
CLOTHES DRYER		\$ 1.00	
FIXTURES		\$ .10	
OUTLETS		\$ .10	
TEMPORARY POLE		\$ 1.00	
SERVICE	1	\$ 1.00	1.00
SIGN (1 Transf.)	1	\$ 2.00	
<i>Drying Fixture</i>	1		1.00
<b>MOTORS:</b>			
1/2 H.P. MAX.	2	\$ .25	50
2 H.P. MAX.		\$ .50	
5 H.P. MAX.		\$ 1.00	
15 H.P. MAX.		\$ 1.50	
50 H.P. MAX.		\$ 2.50	
200 H.P. MAX.		\$ 5.00	
500 H.P. MAX.		\$10.00	
1000 H.P. MAX.		\$15.00	
OVER 1000 H.P.		\$20.00	
FILING FEE			\$1.00
<b>TOTAL FEES</b>		<b>MIN. \$2.00</b>	<b>3.50</b>

STREET ADDRESS OF JOB *8223 Santa Fe Springs Rd.*

**ELECTRIC**

DEPT. OF BLDG. WHITTIER, CALIF.

ELECTRICAL CONTRACTOR *Del's Electric*

CONTRACTOR'S ADDRESS *731 N. Laurel St.*

CONTRACTOR'S PHONE *OW 11472*

CITY REG. NO. *2115* STATE LICENSE NO. *205264*

OWNER *Iuel Ripsey*

PURPOSE OF BLDG. *Industrial*

FLOOR AREA NO. OF METERS

NEW BLDG.  OLD BLDG

REMARKS:

ROUGH | FINAL *1-24-63*

LIGHTS CLEARED TO UTILITY CO.

POWER CLEARED TO UTILITY CO.

I hereby acknowledge that I have read this application and state that the above is correct and agree to comply with all ordinances and State laws regulating electrical wiring.

I hereby certify that I am properly registered and/or licensed as required by the City of Whittier and/or State of California, or that I am the legal owner of the above described property, and I certify that in the performance of the work for which this permit is issued I shall not employ any person in violation of the workmen's compensation laws of California.

Signature of Permittee *Del Stonebraker*

PERMIT NO. 018224

WHEN VALIDATED THIS IS YOUR PERMIT

JAN-23-63 17068 CK 18224 • D - 4

3.50

**DECLARATIONS**

JOB ADDRESS **A** 8170-031-025  
 8221 SANTA FE SPRINGS RD

The Declarations below are mandated by the State of California under Section 18825 of The Health and Safety Code.

- APPLICANT -  
**CONTRACTOR: FILL IN DECLARATION 1, 3, 4 AND 5**  
**OWNER: FILL IN DECLARATION 2, 4 AND 5**

PERMIT FEES	No.	Each	Fee
Residence 750 sq. ft. max.			\$15.00
Residence 1000 sq. ft. max.			\$20.00
Residence 1400 sq. ft. max.			\$28.00
Residence 1700 sq. ft. max.			\$34.00
Residence 2000 sq. ft. max.			\$40.00
Residence 2500 sq. ft. max.			\$50.00
Residence 3000 sq. ft. max.			\$60.00
Residence over 3000 sq. ft.			\$70.00
POOL OR SPA			\$20.00
RANGE or OVEN (ea.)			\$ 3.00
CLOTHES DRYER			\$ 3.00
SPACE/WATER HTR. (ea.)			\$ 3.00
TIME CLOCK			\$ 3.00
FIXTURES	12	\$ .40	4.80
OUTLETS	20	\$ .40	8.00
TEMPORARY POLE			\$10.00
SERVICE (200 AMP. MAX.)	1	\$10.00	10.00
(OVER 200 AMP.)		\$20.00	
SIGN (INC. TIME CLOCK)			\$10.00
TEMP. LIGHTING			\$ 8.00
MOTORS:			
5 H.P. MAX.	2	\$ 3.00	3.00
10 H.P. MAX.		\$ 6.00	
50 H.P. MAX.		\$10.00	
100 H.P. MAX.		\$18.00	
500 H.P. MAX.		\$25.00	
OVER 500 H.P.		\$35.00	
FILING FEE			\$10.00
PLAN CHECK FEE (OVER 1200 A.)			
<b>TOTAL FEES</b>			<b>35.80</b>
ROUGH	8-5-83 P.E.	FINAL	10-24-83
LIGHTS CLEARED TO UTILITY CO.			
POWER CLEARED TO UTILITY CO.			Cleared w/ "Am" 8-8-83

**ELECTRIC**

DEPT. OF BLDG. WHITTIER, CALIF.

ELECTRICAL CONTRACTOR **HOLMES EDDINGS**

CONTRACTOR'S ADDRESS **904 S. DELAWARE, MONROVIA CALIF.**

CONTRACTOR'S PHONE **213 359-8277** CITY BUS. LIC. NO. **20948**

PROPERTY OWNER

OWNER'S ADDRESS

NEW BLDG.  EXISTING BLDG.  COM'L.  RES'L.

**1. LICENSED CONTRACTOR'S DECLARATION**

I hereby affirm that I am licensed under provisions of Chapter 9 (commencing with Section 7000) of Division 3 of the Business and Professions Code, and my license is in full force and effect.

License Class **10** License No. **326037**

Date **6/15/83** Contractor **HOLMES EDDINGS**

**2. WORKER'S COMPENSATION DECLARATION**

I hereby affirm that I have a certificate of consent to self-insure or a certificate of worker's Compensation Insurance or a certified copy thereof. (Sec. 3800, Lab. C.).

Policy No. \_\_\_\_\_ Company \_\_\_\_\_

Certified copy is hereby furnished.  
 Certified copy is filed with the Department of Building & Safety.

Date \_\_\_\_\_ Applicant \_\_\_\_\_

**CERTIFICATE OF EXEMPTION FROM WORKER'S COMPENSATION INSURANCE**

I certify that in the performance of the work for which this permit is issued, I shall not employ any person in any manner so as to become subject to the Worker's Compensation Laws of California.

Date \_\_\_\_\_ Applicant \_\_\_\_\_

NOTICE TO APPLICANT: If, after making this Certificate of Exemption, you should become subject to the Work's Comp. provisions of the Labor Code, you must forthwith comply with such provisions or this permit shall be deemed revoked.

**4. CONSTRUCTION LENDING AGENCY**

I hereby affirm that there is a construction lending agency for the performance of the work for which this permit is issued (Sec. 3907, Civ. C.).

Lender's Name **NA**

Lender's Address **NA**

**5.**

I certify that I have read this application and state that the above information is correct. I agree to comply with all City, and State laws relating to the building construction, and hereby authorize representatives of this City to enter upon the above-mentioned property for inspection purposes.

**Frank R. Holmes Pres 6-7-83**

Signature of Owner or Contractor ONLY Date

**2. OWNER-BUILDER DECLARATION**

I hereby affirm that I am exempt from the Contractor's License Law for the following reason (Sec. 7031.5, California Business and Professions Code: Any City which requires a permit to construct, alter, improve, demolish or repair any structure, prior to its issuance, also requires the applicant for such permit to file a signed statement that he is a licensed contractor pursuant to the provisions of the Contractor's License Law (Ch. 9 (Commencing with Sec. 7000) of Div. 3 of the B. & P. C.) or that he is exempt therefrom and the basis for the alleged exemption. Any violations of Sec. 7031.5 by any applicant for a permit subjects the applicant to a civil penalty of not more than five hundred dollars (\$500.00).):

I, as owner of the property, or my employees with wages as their sole compensation, will do the work, and the structure is not intended or offered for sale (Sec. 7044, B. & P. C.: The Contractor's License Law does not apply to an owner of property who builds or improves thereon, and who does such work himself or through his own employees, provided that such improvements are not intended or offered for sale. If, however, the building or improvement is sold within one year of completion, the owner-builder will have the burden of proving that he did not build or improve for the purpose of sale.).

I, as owner of the property, am exclusively contracting with licensed contractors to construct the project (Sec. 7044, B. & P. C.: The Contractor's License Law does not apply to an owner of contracts for such projects with a contractor(s) licensed pursuant to the Contractor's License Law.).

I am exempt under Sec. \_\_\_\_\_, B. & P. C. for this reason: \_\_\_\_\_

Date \_\_\_\_\_ Owner \_\_\_\_\_

- IMPORTANT -

Application is hereby made to the Superintendent of Building and Safety for a permit subject to the conditions and restrictions set forth on the front and rear faces of this application.

- Each person upon whose behalf this application is made and each person at whose request and for whose benefit work is performed under or pursuant to any permit issued as a result of this application agrees to and shall, indemnify and hold harmless the City of Whittier, its officers, agents and employees.
- Any permit issued as a result of this application becomes null and void if work is not commenced within **ONE HUNDRED EIGHTY (180) DAYS** from date of issuance of such permit.

PERMIT NO. **08680**

FEE **35.80**

~~25.80~~

8680 6/15/83 35.80 EP

WHEN VALIDATED THIS IS YOUR PERMIT

**DECLARATIONS**

8170-031-025

The Declarations below are mandated by the State of California under Section 18825 of The Health and Safety Code.

- APPLICANT -  
**CONTRACTOR: FILL IN DECLARATION 1, 3, 4 AND 5**  
**OWNER: FILL IN DECLARATION 2, 4 AND 5**

**1. LICENSED CONTRACTOR'S DECLARATION**

I hereby affirm that I am licensed under provisions of Chapter 9 (commencing with Section 7000) of Division 3 of the Business and Professions Code, and my license is in full force and effect.

License Class C36 License No. 346611  
 Date 2/22/83 Contractor Eldo Klingenberg Jr

**2. OWNER-BUILDER DECLARATION**

I hereby affirm that I am exempt from the Contractor's License Law for the following reason (Sec. 7031.5, California Business and Professions Code: Any City which requires a permit to construct, alter, improve, demolish or repair any structure, prior to its issuance, also requires the applicant for such permit to file a signed statement that he is a licensed contractor pursuant to the provisions of the Contractor's License Law (Ch. 9 (Commencing with Sec. 7000) of Div. 3 of the B. & P. C.) or that he is exempt therefrom and the basis for the alleged exemption. Any violations of Sec. 7031.5 by any applicant for a permit subjects the applicant to a civil penalty of not more than five hundred dollars (\$500.00).):

I, as owner of the property, or my employees with wages as their sole compensation, will do the work, and the structure is not intended or offered for sale (Sec. 7044, B. & P. C.: The Contractor's License Law does not apply to an owner of property who builds or improves thereon, and who does such work himself or through his own employees, provided that such improvements are not intended or offered for sale. If, however, the building or improvement is sold within one year of completion, the owner-builder will have the burden of proving that he did not build or improve for the purpose of sale.)

I, as owner of the property, am exclusively contracting with licensed contractors to construct the project (Sec. 7044, B. & P. C.: The Contractor's License Law does not apply to an owner of contracts for such projects with a contractor(s) licensed pursuant to the Contractor's License Law.)

I am exempt under Sec. \_\_\_\_\_, B. & P. C. for this reason:

Date \_\_\_\_\_ Owner \_\_\_\_\_

**3. WORKER'S COMPENSATION DECLARATION**

I hereby affirm that I have a certificate of consent to self-insure or a certificate of worker's Compensation Insurance or a certified copy thereof. (Sec. 3800, Lab. C.)

Policy No. \_\_\_\_\_ Company \_\_\_\_\_  
 Certified copy is hereby furnished.  
 Certified copy is filed with the Department of Building & Safety.

Date \_\_\_\_\_ Applicant \_\_\_\_\_

**CERTIFICATE OF EXEMPTION FROM WORKER'S COMPENSATION INSURANCE**

I certify that in the performance of the work for which this permit is issued, I shall not employ any person in any manner so as to become subject to the Worker's Compensation Laws of California.

Date 2/22/83 Applicant [Signature]  
 NOTICE TO APPLICANT: If, after making this Certificate of Exemption, you should become subject to the Work's Comp. provisions of the Labor Code, you must forthwith comply with such provisions or this permit shall be deemed revoked.

**4. CONSTRUCTION LENDING AGENCY**

I hereby affirm that there is a construction lending agency for the performance of the work for which this permit is issued (Sec. 3907, Civ. C.).

Lender's Name U A

Lender's Address \_\_\_\_\_

**5.**  
 I certify that I have read this application and state that the above information is correct. I agree to comply with all City, and State laws relating to the building construction, and hereby authorize representatives of this City to enter upon the above-mentioned property for inspection purposes.

[Signature] 2-22-83  
 Signature of Owner or Contractor ONLY Date

- IMPORTANT -

Application is hereby made to the Superintendent of Building and Safety for a permit subject to the conditions and restrictions set forth on the front and rear faces of this application.

- Each person upon whose behalf this application is made and each person at whose request and for whose benefit work is performed under or pursuant to any permit issued as a result of this application agrees to and shall, indemnify and hold harmless the City of Whittier, its officers, agents and employees.
- Any permit issued as a result of this application becomes null and void if work is not commenced within **ONE HUNDRED EIGHTY (180) DAYS** from date of issuance of such permit.

Number	PERMIT FEES		
<u>4</u>	Gas System, 1st 4 Outlets	\$2.00	<u>8 00</u>
	Each Outlet Additional	.50	
<u>2</u>	Water Heaters or Vents	\$2.00	<u>4 00</u>
<u>1</u>	Water Piping	\$2.00	<u>2 00</u>
	Water Treating Equipment or Softeners	\$2.00	
	Sink, Kitchen-Slop	\$2.00	
	Garbage Disp.	\$2.00	
<u>4</u>	Bath Tub	\$2.00	
	Lavatories	\$2.00	<u>8 00</u>
<u>4</u>	Shower Pans	\$2.00	
	Water Closets	\$2.00	<u>8 00</u>
	Laundry Trays	\$2.00	
	Wash. Mach. Stand Pipes	\$2.00	
	Dishwasher	\$.200	
	Sink, Floor, Bar	\$2.00	
	Urinals	\$2.00	
	Drink Fountains	\$2.00	
	Floor Drains	\$2.00	
	Traps, Sand, Grease	\$2.00	
<u>1</u>	Plumbing Piping Without Fixtures	Each \$2.00	
	Lawn Sprinklers	\$2.00	
	Back Flow Devices	\$2.00	
<u>1</u>	Sewer(s)	Each \$5.00	<u>5 00</u>
	Septic Tank & Cesspool	\$10.00	
	Swim Pool Plumbing	\$6.00	
	<b>FILING FEE</b>	<b>\$3 00</b>	
	<b>TOTAL FEES</b>	<b>38 00</b>	
	Groundwork	<u>3-17-83 RE.</u>	
	Gas System	<u>2-23-83 RE. Rough</u>	<u>8-5-83</u>
	Gas	<u>Final</u>	<u>8-8-83</u>
	Sewer		
	Utility Clearance	<u>Cleared w/ Francis</u>	
		<u>5-16-83</u>	<u>2:15</u>

Job Address 8221 Santa Fe Springs

**PLUMBING**

DEPT. OF BLDG. WHITTIER, CALIFORNIA

Plumbing Contractor's Name Eldo Klingenberg Jr

Contractor's Address 708 Del Valle La Habra

Contractor's Phone 337682 Contractor's City Lic. No. \_\_\_\_\_

Property Owner's Name Eduardo Ceniceros

Property Owner's Address \_\_\_\_\_

New Bldg.  Old Bldg.  Com'l Bldg.  Res'l Bldg.

**FLOORS TO BE LEFT OPEN UNTIL PIPING IS INSTALLED AND INSPECTED**

**SEWER CHARGE -**

Permit Fee 38.00 No. 07321

When Validated This Is Your Permit

7321 2/22/83 38.00 PP

CR

# City of WHITTIER

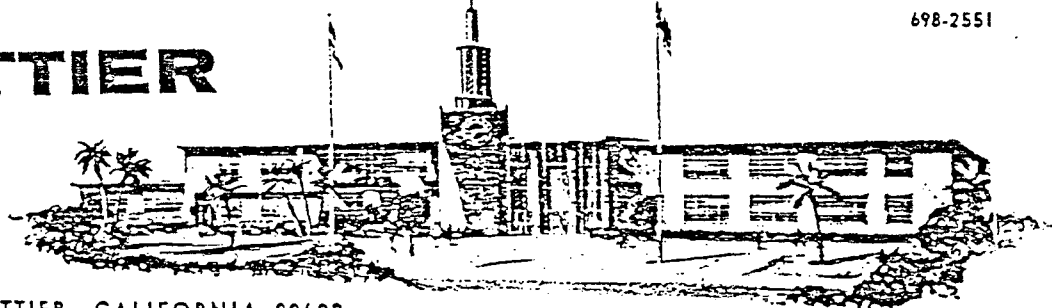

WHITTIER CIVIC CENTER  
13230 EAST PENN STREET • WHITTIER, CALIFORNIA 90602

File No. z82-03  
Date Sept. 10, 1982

The Honorable City Council  
City of Whittier  
City Hall  
Whittier, California

Gentlemen:

At the regular meeting of the Whittier City Planning Commission held Sept. 7, 1982  
Resolution No. P. C. 82-20 was adopted.

	<u>Case Number</u>
<u>      </u> Recommending approval of	Zone Change <span style="float: right;"><u>Z 82-03</u></span>
<u>  X  </u> Recommending conditional approval of	Zone Variance <span style="float: right;"><u>V</u></span>
	Zone Variance Modification <span style="float: right;"><u>V</u></span>
<u>      </u> Denying	Conditional Use Permit <span style="float: right;"><u>C</u></span>
	CUP Modification <span style="float: right;"><u>C</u></span>
<u>      </u> Granting - Conditionally	Planned Development Precise Plan <span style="float: right;"><u>PD</u></span>
	Amendment of Zoning Regulations <span style="float: right;"><u>      </u></span>

(Section No.)

  X   It will be necessary for the City Council to conduct a public hearing before the final approval or disapproval of this matter. Subject matter will be considered at the regular meeting of the City Council Oct. 5, 1982 at 7:30 p.m.

As per Section 9276 of the Whittier Zoning Regulations, the above action shall become final and effective in 20 days, or as otherwise specified therein, from the date of decision unless an appeal is filed in writing, or the City Council determines to hold a public hearing on its own motion.

Respectfully submitted,

WHITTIER CITY PLANNING COMMISSION

*Elvin H. Porter*  
Elvin H. Porter, Secretary

EHP:wh  
Encl. P.C. 82-20

Applicant: Eduardo Cenicerros  
cc: Engineering Dept.  
   Park Dept.  
   Police Dept.  
   Public Services Dept.  
   Building Dept.  
   Community Development Dept.

**RECEIVED**  
**SEP 10 1982**  
**BLDG.-SAFETY**



RESOLUTION NO. P. C. 82-20

A RESOLUTION OF THE PLANNING COMMISSION  
OF THE CITY OF WHITTIER RECOMMENDING TO  
THE CITY COUNCIL A CHANGE OF ZONE FROM  
R-1 TO R-(P). (APPLICANT: EDUARDO CENICEROS;  
CASE NO. Z82-03; LOCATION: 12561 PERSING DR.)

THE PLANNING COMMISSION OF THE CITY OF WHITTIER DOES RESOLVE  
AS FOLLOWS:

SECTION 1. The Planning Commission does hereby find, determine,  
and declare as follows:

(a) That an application for a change of zone from  
R-1 to R-1(P) was submitted by the owner of the subject property,  
located at 12561 Persing Drive and described more particularly  
as Lot 32, Tract No. 6956, Book 78, Page 55; and

(b) A duly noticed public hearing was held upon said appli-  
cation by the Planning Commission on September 7, 1982, and based  
upon the evidence presented, it was determined that the public  
necessity, convenience, and general welfare required the approval  
hereof.

SECTION 2. Based upon such findings and determinations, the  
Planning Commission hereby recommends to the City Council that  
zoning of the subject property be changed from R-1 to R-1(P), subject  
to the condition that the applicant shall dedicate 5 ft. of frontage  
to the city for street purposes.

SECTION 3. That the Secretary shall certify to the adoption of  
this resolution and shall cause copies of the same to be forwarded to  
the City Council and to the applicant.

PASSED AND APPROVED this 7th day of September, 1982, by the  
following vote:

AYES:	W. E. Thompson, Jr., C. R. Rollins, F. A. Bergerson, G. Trorey, E. K. Neslen
NOES:	None
ABSENT:	None

ATTEST:

*Elvin H. Porter*

Elvin H. Porter, Secretary

**DECLARATIONS**

8170-031-035

The Declarations below are mandated by the State of California under Section 18825 of The Health and Safety Code.

**- APPLICANT -**

**CONTRACTOR: FILL IN DECLARATION 1, 3, 4 AND 5**

**OWNER: FILL IN DECLARATION 2, 4 AND 5**

**1. LICENSED CONTRACTOR'S DECLARATION**

I hereby affirm that I am licensed under provisions of Chapter 9 (commencing with Section 7000) of Division 3 of the Business and Professions Code, and my license is in full force and effect.

License Class C-36 License No. 346641

Date 3/15/83 Contractor [Signature]

**2. OWNER-BUILDER DECLARATION**

I hereby affirm that I am exempt from the Contractor's License Law for the following reason (Sec. 7031.5, California Business and Professions Code: Any City which requires a permit to construct, alter, improve, demolish or repair any structure, prior to its issuance, also requires the applicant for such permit to file a signed statement that he is a licensed contractor pursuant to the provisions of the Contractor's License Law (Ch. 9 (Commencing with Sec. 7000) of Div. 3 of the B. & P. C.) or that he is exempt therefrom and the basis for the alleged exemption. Any violations of Sec. 7031.5 by any applicant for a permit subjects the applicant to a civil penalty of not more than five hundred dollars (\$500.00.):

I, as owner of the property, or my employees with wages as their sole compensation, will do the work, and the structure is not intended or offered for sale (Sec. 7044, B. & P. C. : The Contractor's License Law does not apply to an owner of property who builds or improves thereon, and who does such work himself or through his own employees, provided that such improvements are not intended or offered for sale. If, however, the building or improvement is sold within one year of completion, the owner-builder will have the burden of proving that he did not build or improve for the purpose of sale.)

I, as owner of the property, am exclusively contracting with licensed contractors to construct the project (Sec. 7044, B. & P. C. : The Contractor's License Law does not apply to an owner of contracts for such projects with a contractor(s) licensed pursuant to the Contractor's License Law.)

I am exempt under Sec. \_\_\_\_\_, B. & P. C. for this reason:

Date \_\_\_\_\_ Owner \_\_\_\_\_

**3. WORKER'S COMPENSATION DECLARATION**

I hereby affirm that I have a certificate of consent to self-insure or a certificate of worker's Compensation Insurance or a certified copy thereof. (Sec. 3800, Lab. C.)

Policy No. \_\_\_\_\_ Company \_\_\_\_\_

Certified copy is hereby furnished.  
 Certified copy is filed with the Department of Building & Safety.

Date \_\_\_\_\_ Applicant \_\_\_\_\_

**CERTIFICATE OF EXEMPTION FROM WORKER'S COMPENSATION INSURANCE**

I certify that in the performance of the work for which this permit is issued, I shall not employ any person in any manner so as to become subject to the Worker's Compensation Laws of California.

Date 3/15/83 Applicant [Signature]

NOTICE TO APPLICANT: If, after making this Certificate of Exemption, you should become subject to the Work's Comp. provisions of the Labor Code, you must forthwith comply with such provisions or this permit shall be deemed revoked.

**4. CONSTRUCTION LENDING AGENCY**

I hereby affirm that there is a construction lending agency for the performance of the work for which this permit is issued (Sec. 3907, Civ. C.).

Lender's Name NA

Lender's Address \_\_\_\_\_

**5.**

I certify that I have read this application and state that the above information is correct. I agree to comply with all City, and State laws relating to the building construction, and hereby authorize representatives of this City to enter upon the above-mentioned property for inspection purposes.

[Signature] 3/15/83  
Signature of Owner or Contractor ONLY Date

**- IMPORTANT -**

Application is hereby made to the Superintendent of Building and Safety for a permit subject to the conditions and restrictions set forth on the front and rear faces of this application.

1. Each person upon whose behalf this application is made and each person at whose request and for whose benefit work is performed under or pursuant to any permit issued as a result of this application agrees to and shall, indemnify and hold harmless the City of Whittier, its officers, agents and employees.

2. Any permit issued as a result of this application becomes null and void if work is not commenced within **ONE HUNDRED EIGHTY (180) DAYS** from date of issuance of such permit.

PERMIT FEES			
Gas System, 1st 4 Outlets	\$2.00		
Each Outlet Additional	.50		
Water Heaters or Vents	\$2.00		
Water Piping	\$2.00		
Water Treating Equipment or Softeners	\$2.00		
Sink, Kitchen-Slop	\$2.00		
Garbage Disp.	\$2.00		
Bath Tub	\$2.00		
Lavatories	\$2.00	1	00
Shower Pans	\$2.00	2	00
Water Closets	\$2.00		
Laundry Trays	\$2.00		
Wash. Mach. Stand Pipes	\$2.00		
Dishwasher	\$.200		
Sink, Floor, Bar	\$2.00		
Urinals	\$2.00		
Drink Fountains	\$2.00		
Floor Drains	\$2.00		
Traps, Sand, Grease	\$2.00		
Plumbing Piping Without Fixtures	Each \$2.00		
Lawn Sprinklers	\$2.00		
Back Flow Devices	\$2.00		
Sewer(s)	Each \$5.00		
Septic Tank & Cesspool	\$10.00		
Swim Pool Plumbing	\$6.00		
<b>FILING FEE</b>		<b>\$3 00</b>	
<b>TOTAL FEES</b>		<b>7 00</b>	

Groundwork	Rough	<u>8-5-83</u>
Gas	Final	<u>8-8-83</u>
Sewer		
Utility Clearance		

Job Address 8221 Santa Fe Springs

**PLUMBING**

DEPT. OF BLDG. WHITTIER, CALIFORNIA

Plumbing Contractor's Name Eldon Klingenberg

Contractor's Address 708 Del Valle Ln

Contractor's Phone 331 7682 Contractor's City Lic. No. 19543

Property Owner's Name \_\_\_\_\_

Property Owner's Address \_\_\_\_\_

New Bldg.  Old Bldg.  Com'l Bldg.  Res'l Bldg.

**FLOORS TO BE LEFT OPEN UNTIL PIPING IS INSTALLED AND INSPECTED**

**SEWER CHARGE -**

Permit Fee 7.00 No. 07496

When Validated This Is Your Permit 7496 3/15/83 7:00 PM

CR

**DECLARATIONS**

8170-031-025

The Declarations below are mandated by the State of California under Section 18825 of The Health and Safety Code.

- APPLICANT -  
**CONTRACTOR: FILL IN DECLARATION 1, 3, 4 AND 5**  
**OWNER: FILL IN DECLARATION 2, 4 AND 5**

**1. LICENSED CONTRACTOR'S DECLARATION**

I hereby affirm that I am licensed under provisions of Chapter 9 (commencing with Section 7000) of Division 3 of the Business and Professions Code, and my license is in full force and effect.

License Class CP License No. 326037  
 Date 6/15/83 Contractor HELMES EDWIGE

**2. WORKER'S COMPENSATION DECLARATION**

I hereby affirm that I have a certificate of consent to self-insure or a certificate of worker's Compensation Insurance or a certified copy thereof. (Sec. 3800, Lab. C.)

Policy No. \_\_\_\_\_ Company \_\_\_\_\_  
 Certified copy is hereby furnished.  
 Certified copy is filed with the Department of Building & Safety.

Date \_\_\_\_\_ Applicant \_\_\_\_\_

**2. OWNER-BUILDER DECLARATION**

I hereby affirm that I am exempt from the Contractor's License Law for the following reason (Sec. 7031.5, California Business and Professions Code: Any City which requires a permit to construct, alter, improve, demolish or repair any structure, prior to its issuance, also requires the applicant for such permit to file a signed statement that he is a licensed contractor pursuant to the provisions of the Contractor's License Law (Ch. 9 (Commencing with Sec. 7000) of Div. 3 of the B. & P. C.) or that he is exempt therefrom and the basis for the alleged exemption. Any violations of Sec. 7031.5 by any applicant for a permit subjects the applicant to a civil penalty of not more than five hundred dollars (\$500.00).):

I, as owner of the property, or my employees with wages as their sole compensation, will do the work, and the structure is not intended or offered for sale (Sec. 7044, B. & P. C.): The Contractor's License Law does not apply to an owner of property who builds or improves thereon, and who does such work himself or through his own employees, provided that such improvements are not intended or offered for sale. If, however, the building or improvement is sold within one year of completion, the owner-builder will have the burden of proving that he did not build or improve for the purpose of sale.)

I, as owner of the property, am exclusively contracting with licensed contractors to construct the project (Sec. 7044, B. & P. C.): The Contractor's License Law does not apply to an owner of contracts for such projects with a contractor(s) licensed pursuant to the Contractor's License Law.)

I am exempt under Sec. \_\_\_\_\_, B. & P. C. for this reason: \_\_\_\_\_

Date \_\_\_\_\_ Owner \_\_\_\_\_

**CERTIFICATE OF EXEMPTION FROM WORKER'S COMPENSATION INSURANCE**

I certify that in the performance of the work for which this permit is issued, I shall not employ any person in any manner so as to become subject to the Worker's Compensation Laws of California.

Date \_\_\_\_\_ Applicant \_\_\_\_\_

**NOTICE TO APPLICANT:** If, after making this Certificate of Exemption, you should become subject to the Work's Comp. provisions of the Labor Code, you must forthwith comply with such provisions or this permit shall be deemed revoked.

**4. CONSTRUCTION LENDING AGENCY**

I hereby affirm that there is a construction lending agency for the performance of the work for which this permit is issued (Sec. 3907, Civ. C.)

Lender's Name \_\_\_\_\_  
 Lender's Address NA

**5.**

I certify that I have read this application and state that the above information is correct. I agree to comply with all City, and State laws relating to the building construction, and hereby authorize representatives of this City to enter upon the above-mentioned property for inspection purposes.

Frank R. [Signature] 6-7-83  
 Signature of Owner or Contractor ONLY Date

PERMIT FEES	No.	Each	Fee
Residence 750 sq. ft. max.			\$15.00
Residence 1000 sq. ft. max.			\$20.00
Residence 1400 sq. ft. max.			\$28.00
Residence 1700 sq. ft. max.			\$34.00
Residence 2000 sq. ft. max.			\$40.00
Residence 2500 sq. ft. max.			\$50.00
Residence 3000 sq. ft. max.			\$60.00
Residence over 3000 sq. ft.			\$70.00
POOL OR SPA			\$20.00
RANGE or OVEN (ea.)			\$ 3.00
CLOTHES DRYER			\$ 3.00
SPACE/WATER HTR. (ea.)			\$ 3.00
TIME CLOCK			\$ 3.00
FIXTURES	12	\$ .40	4.80
OUTLETS	20	\$ .40	8.00
TEMPORARY POLE			\$10.00
SERVICE (200 AMP. MAX.)			\$10.00
(OVER 200 AMP.)	1	\$20.00	20.00
SIGN (INC. TIME CLOCK)			\$10.00
TEMP. LIGHTING			\$ 8.00
<b>MOTORS:</b>			
5 H.P. MAX.	1	\$ 3.00	3.00
10 H.P. MAX.		\$ 6.00	
50 H.P. MAX.		\$10.00	
100 H.P. MAX.		\$18.00	
500 H.P. MAX.		\$25.00	
OVER 500 H.P.		\$35.00	
FILING FEE			\$10.00
PLAN CHECK FEE (OVER 1200 A.)			
<b>TOTAL FEES</b>			<b>35.80</b>
ROUGH			FINAL 45.80
10-24-83			10-24-83
LIGHTS CLEARED TO UTILITY CO.			
POWER CLEARED TO UTILITY CO.			Cleared w/ Ams 8-8-83

**JOB ADDRESS** 8221 Santa Fe Springs Rd

**ELECTRIC**

DEPT. OF BLDG. WHITTIER, CALIF.

ELECTRICAL CONTRACTOR HELMES EDWIGE

CONTRACTOR'S ADDRESS 9045 Altadena Ave  
91016 Monrovia Cal

CONTRACTOR'S PHONE 713 359-8277 CITY BUS. LIC. NO. 20948

PROPERTY OWNER \_\_\_\_\_

OWNER'S ADDRESS \_\_\_\_\_

NEW BLDG.  EXISTING BLDG.  COM'L   
 RES'L.

PERMIT NO.  
**08681**

~~35.80~~ 45.80 CR

8681 6/15/83 45.80 EP

WHEN VALIDATED THIS IS YOUR PERMIT

- IMPORTANT -

Application is hereby made to the Superintendent of Building and Safety for a permit subject to the conditions and restrictions set forth on the front and rear faces of this application.

- Each person upon whose behalf this application is made and each person at whose request and for whose benefit work is performed under or pursuant to any permit issued as a result of this application agrees to and shall, indemnify and hold harmless the City of Whittier, its officers, agents and employees.
- Any permit issued as a result of this application becomes null and void if work is not commenced within ONE HUNDRED EIGHTY (180) DAYS from date of issuance of such permit.