

Glacier Creek Office Park

Class A Office Space

6711 Towpath Road
East Syracuse, NY 13057

Final 4,693 Square Foot Availability



Offering Overview

Glacier Creek Office Park offers Class A office space within a one of a kind natural setting. Overlooking a forever wild wetland, tenants can enjoy picturesque decks and walkways. Inside guests enter through a stunning atrium with abundant natural light and high-end finishes. Tenants include both medical office and professional service providers.

Offering Details

- + 4,693 Square Feet
- + Class A Office Space In Unmatched Setting
- + Pricing: Contact Broker

Glacier Creek Office Park

6711 Towpath Road | East Syracuse, NY 13057

For Lease

Property Overview

- + 4,693 Square Feet Available
- + High Level Class A Finishes Throughout
- + Recently Remodeled Main Lobby With Modern Luxury Finishes, Lighting & Furniture
- + Common Conference Room
- + Ample Free Parking On Site
- + Covered, Drive-Up Drop Off At Building
- + Outstanding Exposure To I-481
- + Unmatched Natural Setting with Outdoor Decking Overlooking Serene Pond and Forever Wild Wetlands
- + High Quality Cotenants Include Medical Office and Professional Services Firms
- + Excellent Location, Convenient To:
 - Interstates
 - Retail
 - Dining
 - Lodging
 - Entertainment

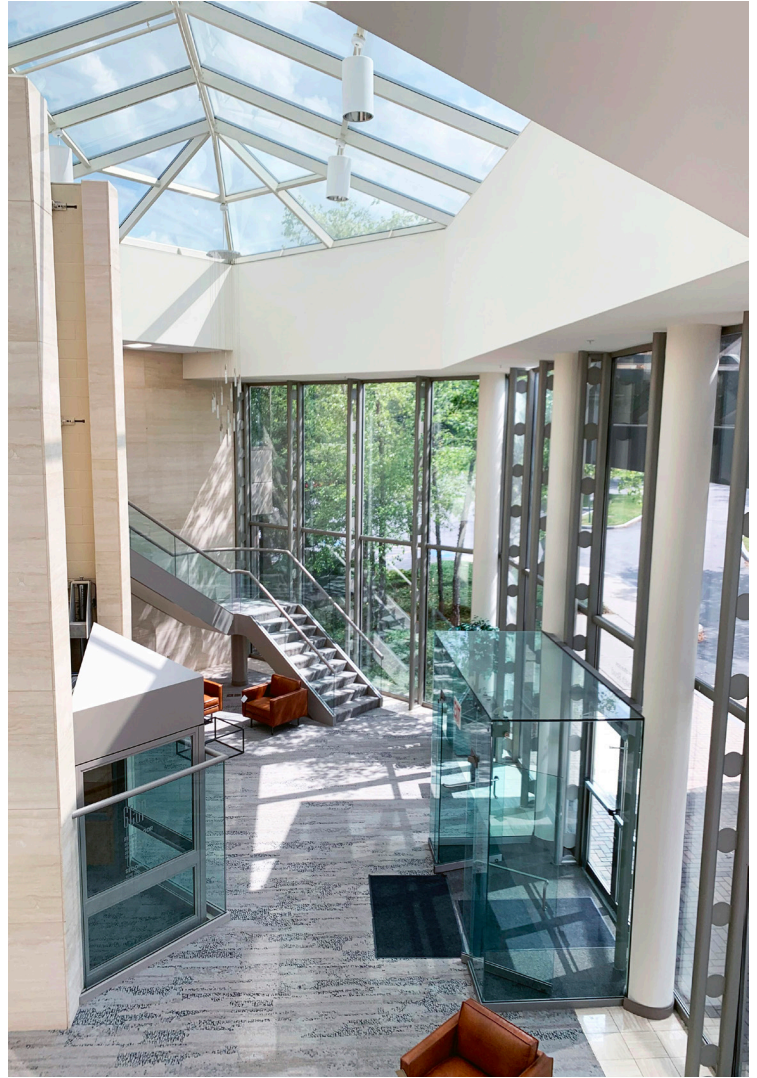

Contact Us

Bill Anninos

+1 315 422 4200 x315

bill.anninos@cbre-syr.com

Licensed Associate Real Estate Broker

Peter Finn

+1 315 422 4200 x302

peter.finn@cbre-syr.com

Licensed Associate Real Estate Broker

© 2023 CBRE Upstate NY, part of the CBRE Affiliate Network. All rights reserved. This information has been obtained from sources believed reliable, but has not been verified for accuracy or completeness. You should conduct a careful, independent investigation of the property and verify all information. Any reliance on this information is solely at your own risk. CBRE Upstate NY and the CBRE Upstate NY logo are service marks of CBRE Upstate NY. All other marks displayed on this document are the property of their respective owners, and the use of such logos does not imply any affiliation with or endorsement of CBRE Upstate NY. Photos herein are the property of their respective owners. Use of these images without the express written consent of the owner is prohibited.

CBRE Upstate NY

313 E. Willow St

Syracuse, NY 13203

+1 315 422 4200

www.cbre.com/UpstateNY

CBRE Upstate NY

PART OF THE AFFILIATE NETWORK

Glacier Creek Office Park

6711 Towpath Road | East Syracuse, NY 13057

For Lease



Contact Us

Bill Anninos

+1 315 422 4200 x315

bill.anninos@cbre-syr.com

Licensed Associate Real Estate Broker

Peter Finn

+1 315 422 4200 x302

peter.finn@cbre-syr.com

Licensed Associate Real Estate Broker

CBRE Upstate NY

313 E. Willow St

Syracuse, NY 13203

+1 315 422 4200

www.cbre.com/UpstateNY

CBRE Upstate NY

PART OF THE AFFILIATE NETWORK

Glacier Creek Office Park

6711 Towpath Road | East Syracuse, NY 13057

For Lease

First Floor

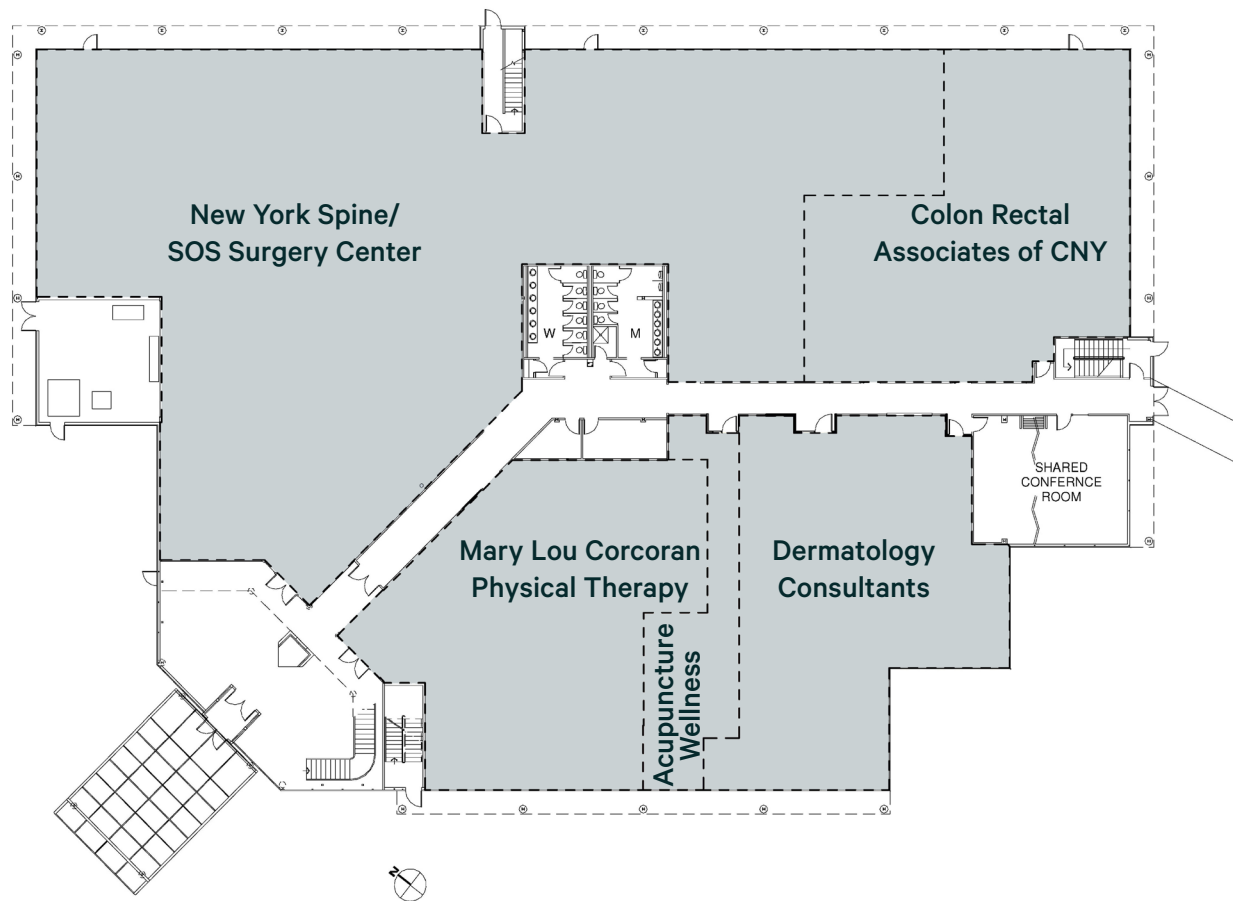

Second Floor

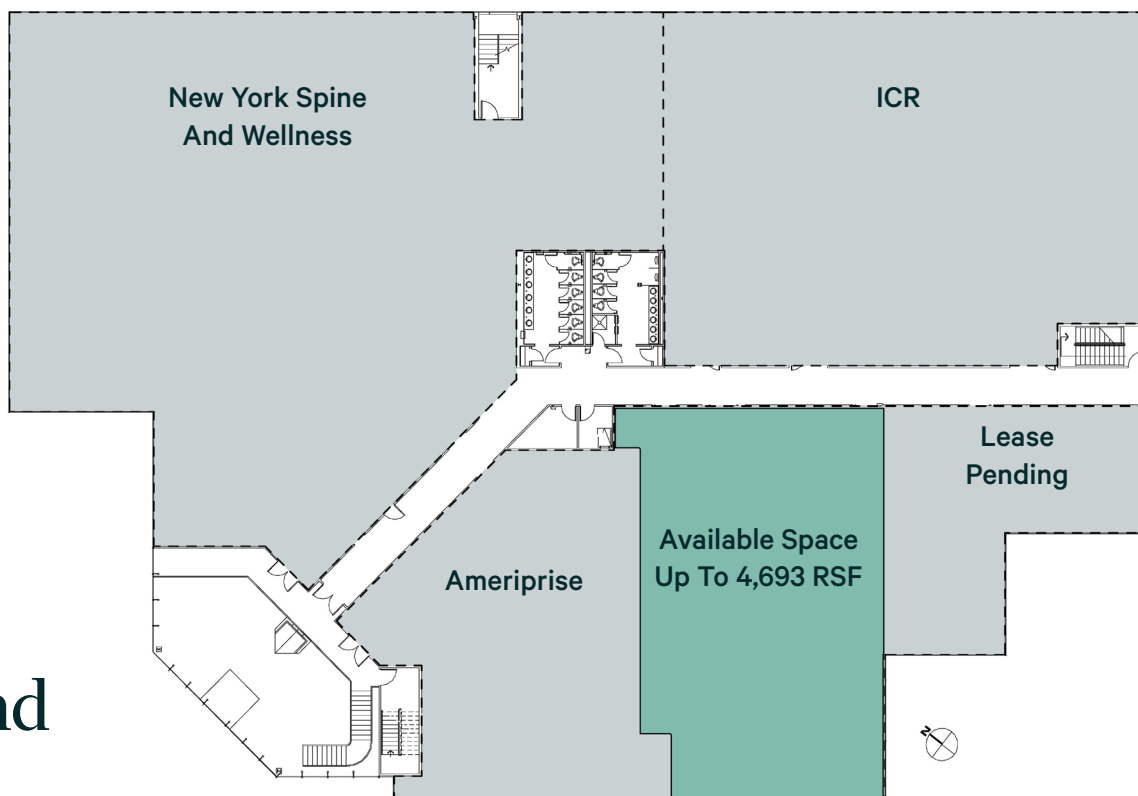

Glacier Creek Office Park

6711 Towpath Road | East Syracuse, NY 13057

For Lease



Contact Us

Bill Anninos

+1 315 422 4200 x315

bill.anninos@cbre-syr.com

Licensed Associate Real Estate Broker

Peter Finn

+1 315 422 4200 x302

peter.finn@cbre-syr.com

Licensed Associate Real Estate Broker

CBRE Upstate NY

313 E. Willow St

Syracuse, NY 13203

+1 315 422 4200

www.cbre.com/UpstateNY

CBRE Upstate NY

PART OF THE AFFILIATE NETWORK

Glacier Creek Office Park

6711 Towpath Road | East Syracuse, NY 13057

For Lease

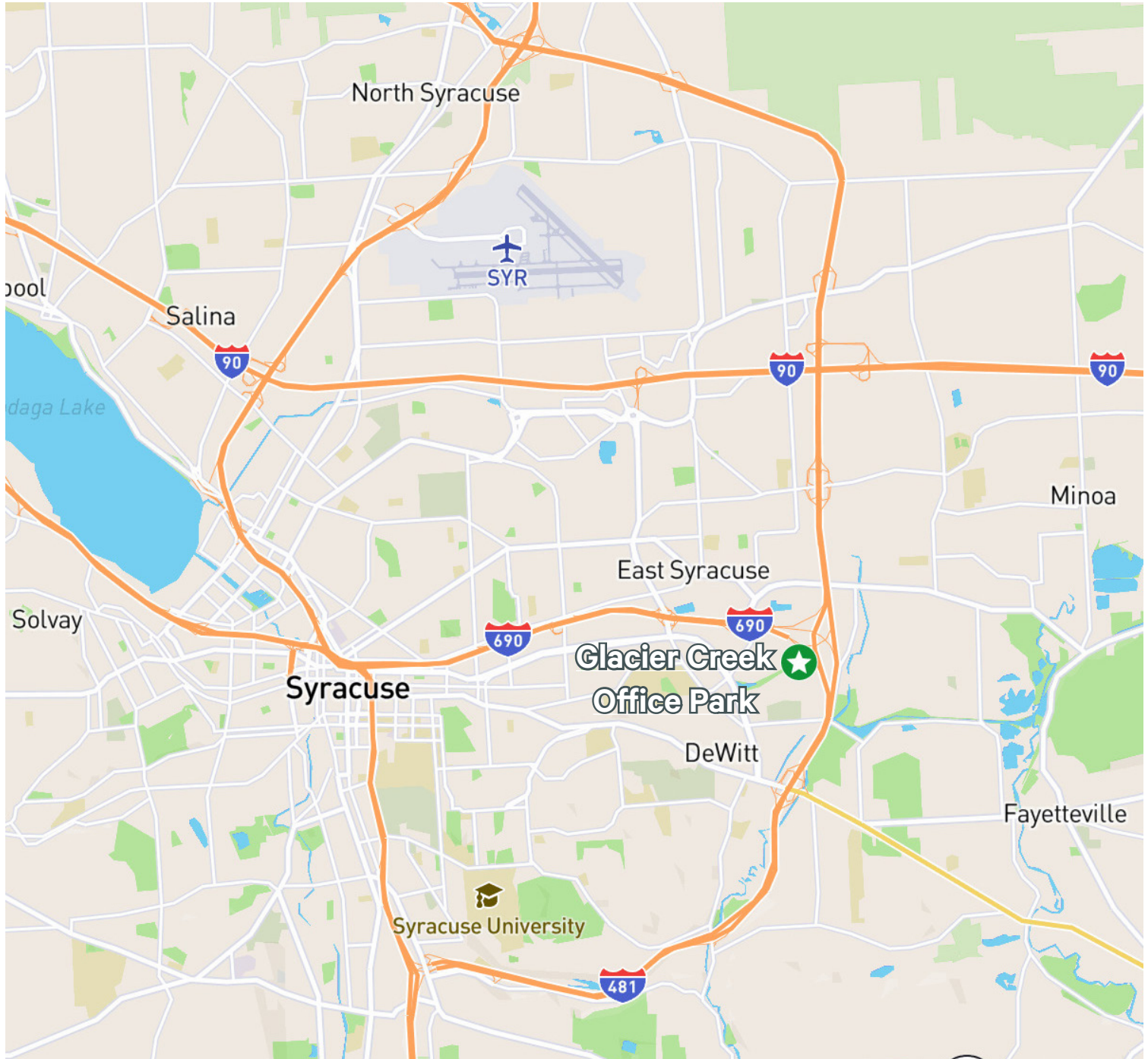

Contact Us

Bill Anninos

+1 315 422 4200 x315

bill.anninos@cbre-syr.com

Licensed Associate Real Estate Broker

Peter Finn

+1 315 422 4200 x302

peter.finn@cbre-syr.com

Licensed Associate Real Estate Broker

CBRE Upstate NY

313 E. Willow St

Syracuse, NY 13203

+1 315 422 4200

www.cbre.com/UpstateNY

CBRE Upstate NY

PART OF THE AFFILIATE NETWORK