



**BOUNDARY**

PEACHTREE AT 17TH

**PROGRESSING**

**POSSIBILITY AT**

**PEACHTREE AT 17<sup>TH</sup>**

# INTRODUCING BOUNDARY

Boundary is a visionary three-building campus centered between Uptown and The Arts District, located at the prominent intersection of Peachtree and 17th in Midtown ATL. Recently acquired by Parkside Partners with dramatic redevelopment and architectural unification efforts realized — discover dynamic space for companies seeking a Peachtree Street address and unmatched visibility.

Availabilities range from 2,000 SF to 12,000 SF, with new custom buildout and exterior building signage opportunities.

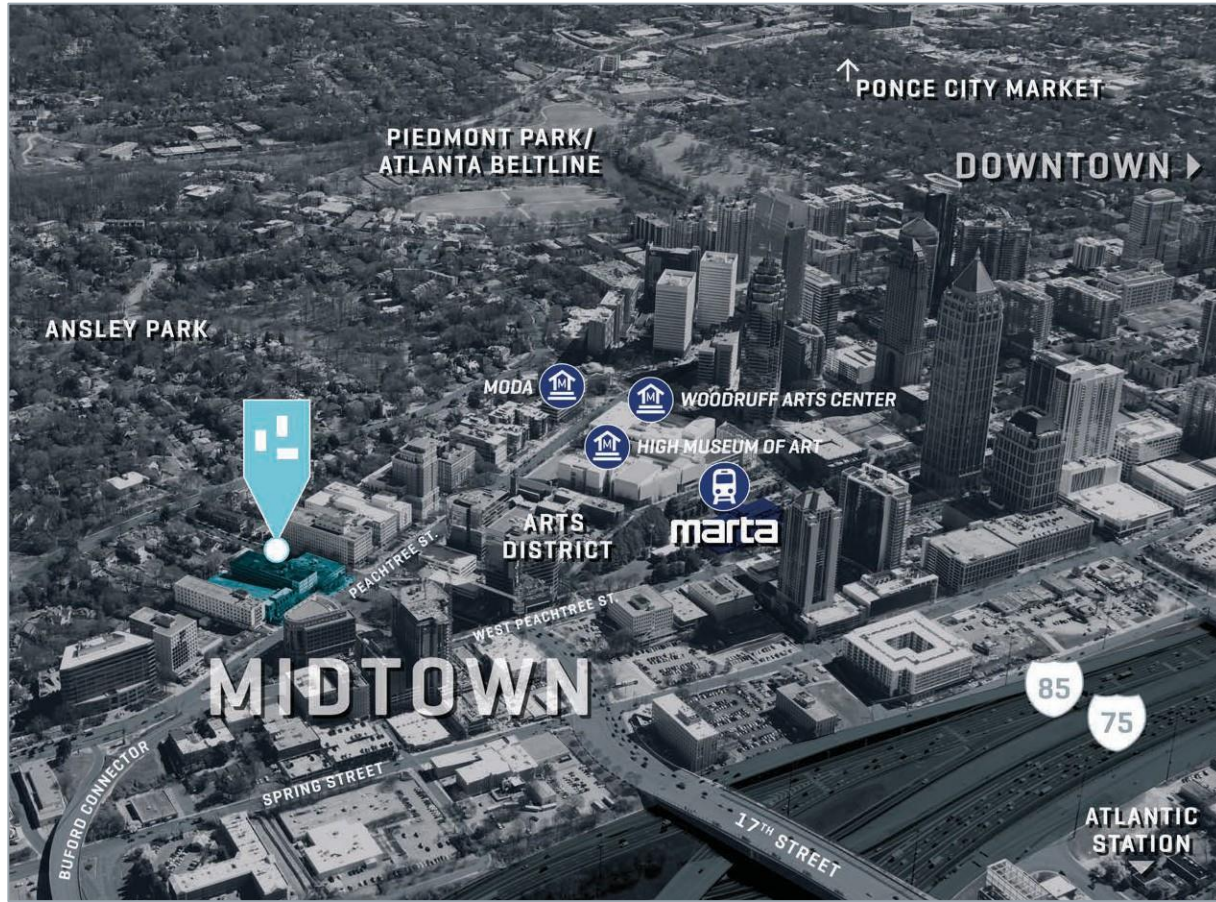

Short bike ride to Piedmont Park and the Atlanta BeltLine



Preferred access to I-75/85 and the Buford Connector (< .4 miles)



Abundant surface street alt. route access via 17th Street

# PROXIMITY ON PACE

## SELECT WALKABLE AMENITIES

**HIGH**

**HUGE × BRASH**



**5 MIN.** to MODA, High Museum of Art, and The Woodruff Arts Center

**6 MIN.** to MARTA Arts Center Station

**8 MIN.** to Colony Square amenities

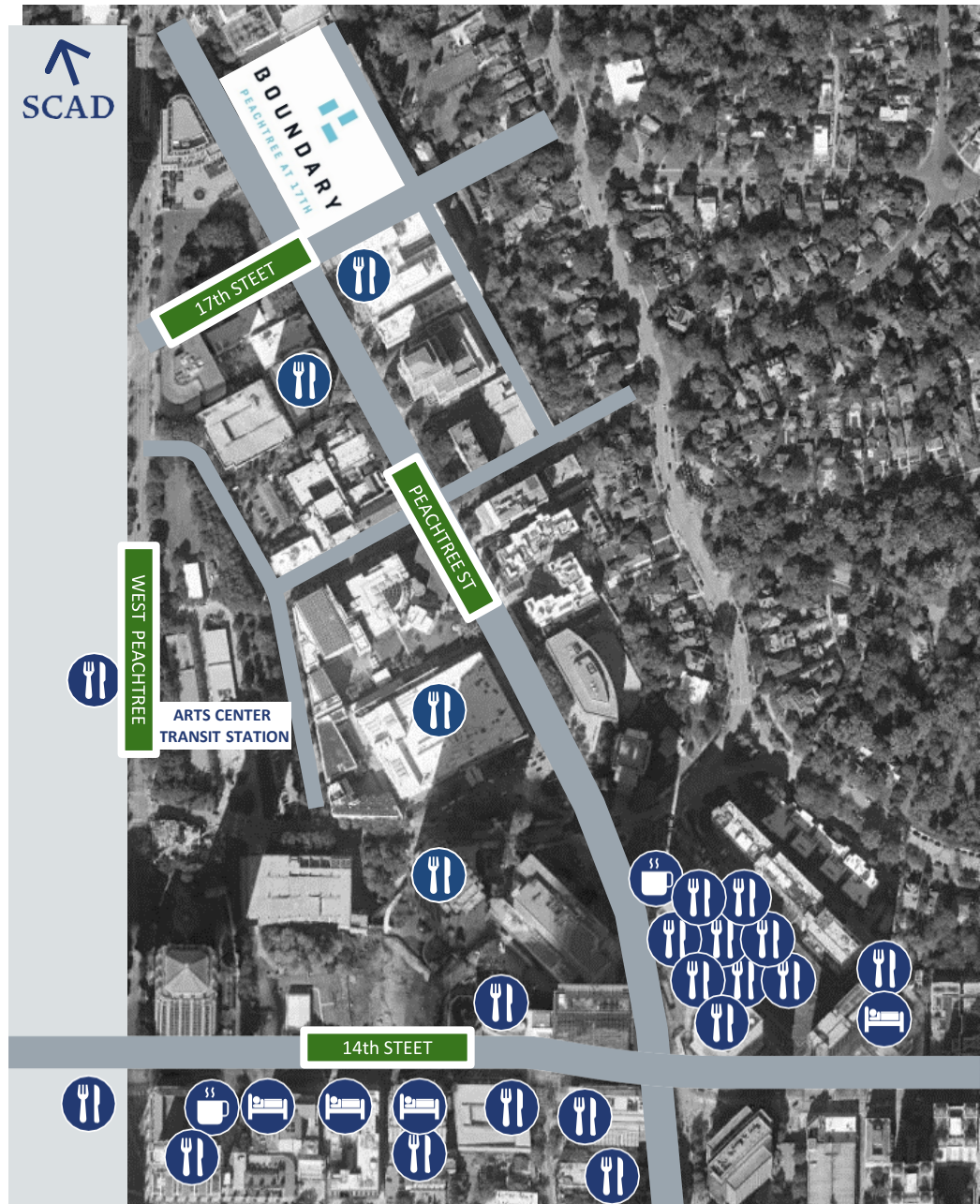

# AVAILABILITIES OVERVIEW

## 1401 PEACHTREE

- 97,339 SF on 5 Levels
- Creative Office & Arcade-Level Retail/Showroom
- Contiguous Availabilities from 1,000 SF to 12,000 SF

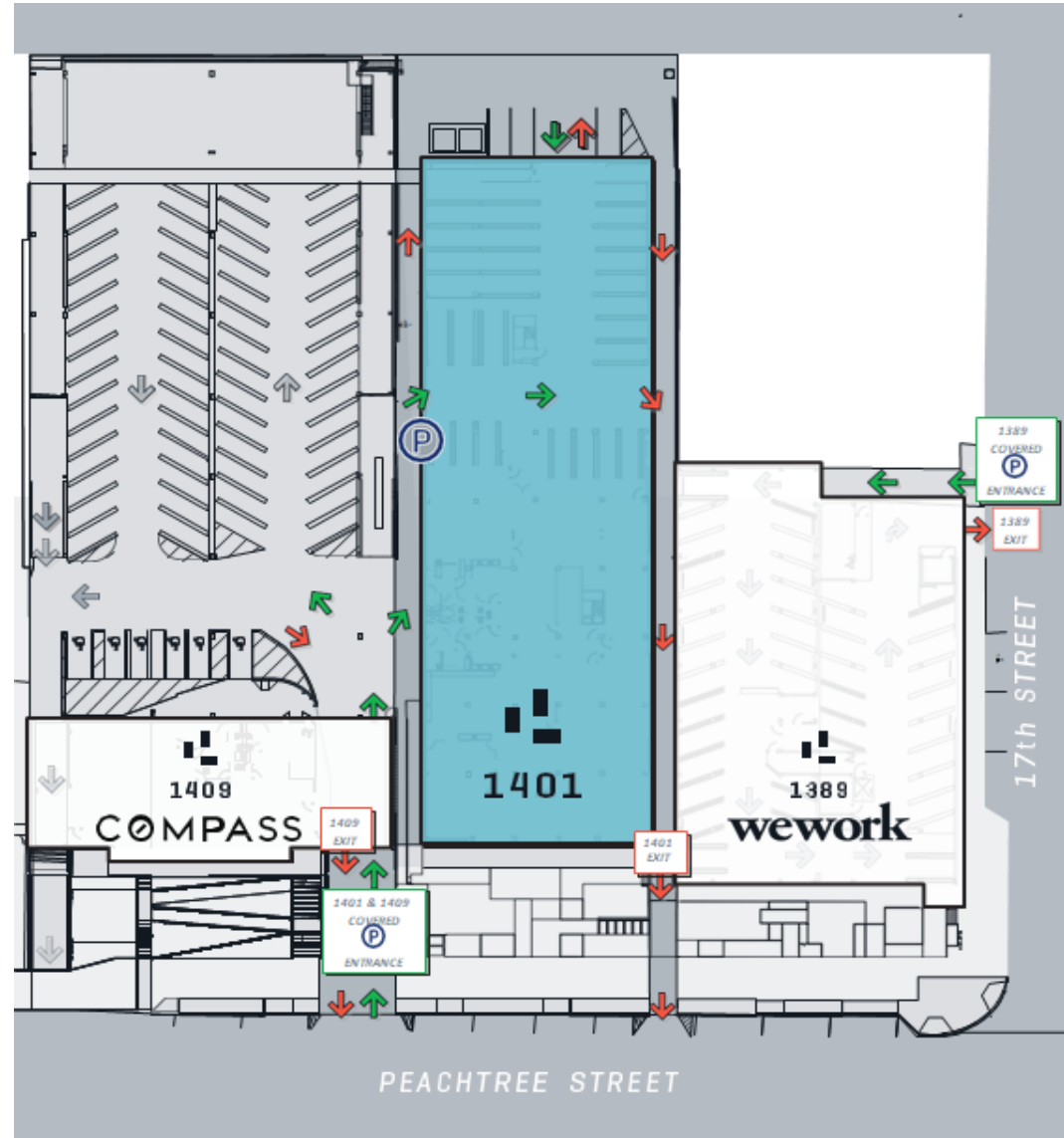

# 1401 PEACHTREE – STACKING PLAN



# 1401 PEACHTREE – SOCIAL HUB & PROJECT AMENITIES

## SOCIAL HUB

- Shared Conference Room
- Social Breakout Areas, Games & Event Space
- State-of-the-Art Fitness Center
- Common Restrooms with Showers

## OUTDOOR AMENITIES

- Turfed Linear Park with Peachtree Street Frontage
- Secluded Pocket Park



# BOUNDARY – PROJECT PHOTOGRAPHY

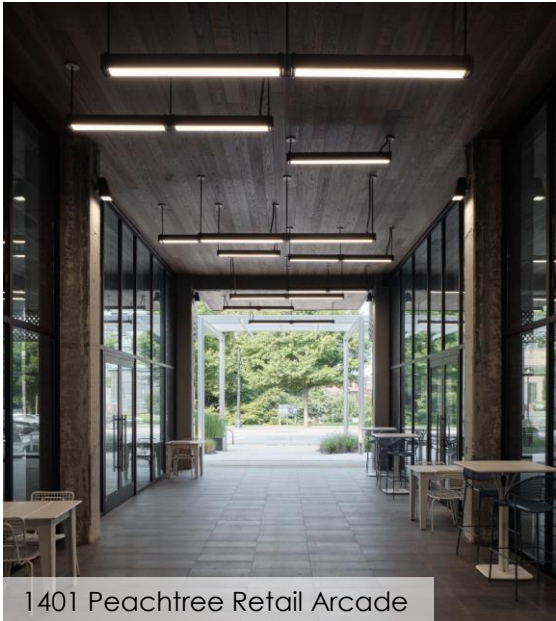

Leased & Developed by:



PARKSIDE PARTNERS

# BOUNDARY – PROJECT PHOTOGRAPHY



1401 Peachtree Social Hub



1401 Peachtree Social Hub



Pocket Park



Pocket Park



1401 Peachtree Lobby



LEASING CONTACTS

**KYLE JENKS**  
404.660.9494

**SAM HIGGINS**  
404.713.5951

Leased & Developed by:

