

Retail/Flex For Lease

315 N Aspen Ave

Broken Arrow, OK 74102

WIGGIN
PROPERTIES, LLC



Retail/Flex for Lease

315 N Aspen Ave

Lease Rate: \$12 psf +Utilities

Available SF: 3,700 SF

Highlights:

- Excellent visibility from N Aspen Ave / 145th St
- Excellent traffic counts
- 1,998 SF Storefront
- 1,702 SF Warehouse
- 2 overhead doors (10'x10' & 10'x12')

Demographics

2024	1 Mile	3 Miles	5 Miles
Population	9,293	68,305	186,859
Average HH Income	\$82,997	\$92,320	\$88,233
Households	3,495	26,251	72,724

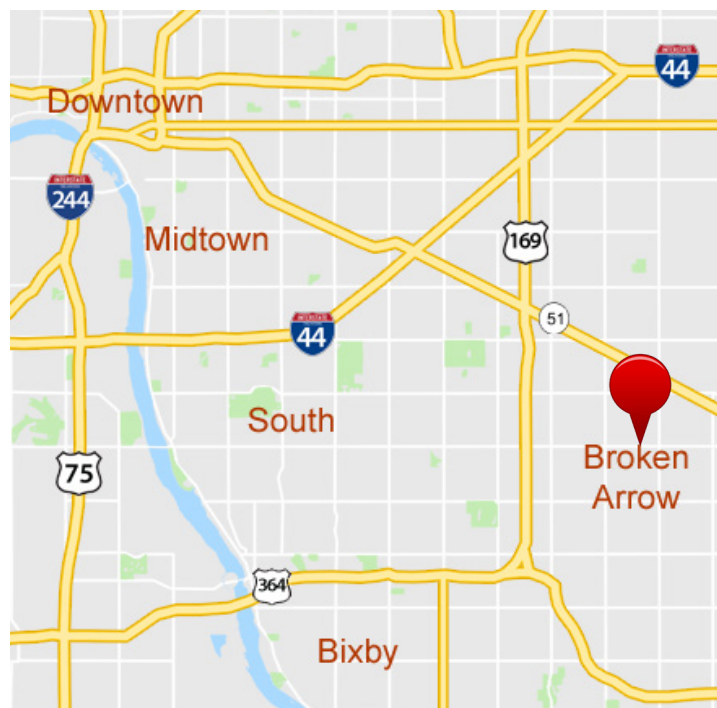

Traffic Counts

Street	VPD
N Aspen Ave	27,709
E 71st St	27,554

Vicki Patterson, CCIM 918.519.6731 | Erica Cunningham 918.829.5754

vpatterson@wigginprop.com | ecunningham@wigginprop.com | wigginprop.com

This material is provided for information purposes only. It is from sources believed to be reliable. However, Wiggin Properties makes no warranties or representations, expressed or implied, as to the accuracy or sufficiency of the information. It is presented subject to errors, omissions, changes or withdrawal without notice. Square footage is provided by the local County Assessor or the Owner. Photos and graphics with copyrights by Costar, Google, Wiggin Properties and independent contractors are used with permission.

Retail/Flex For Lease

315 N Aspen Ave

Broken Arrow, OK 74102

WIGGIN
PROPERTIES, LLC

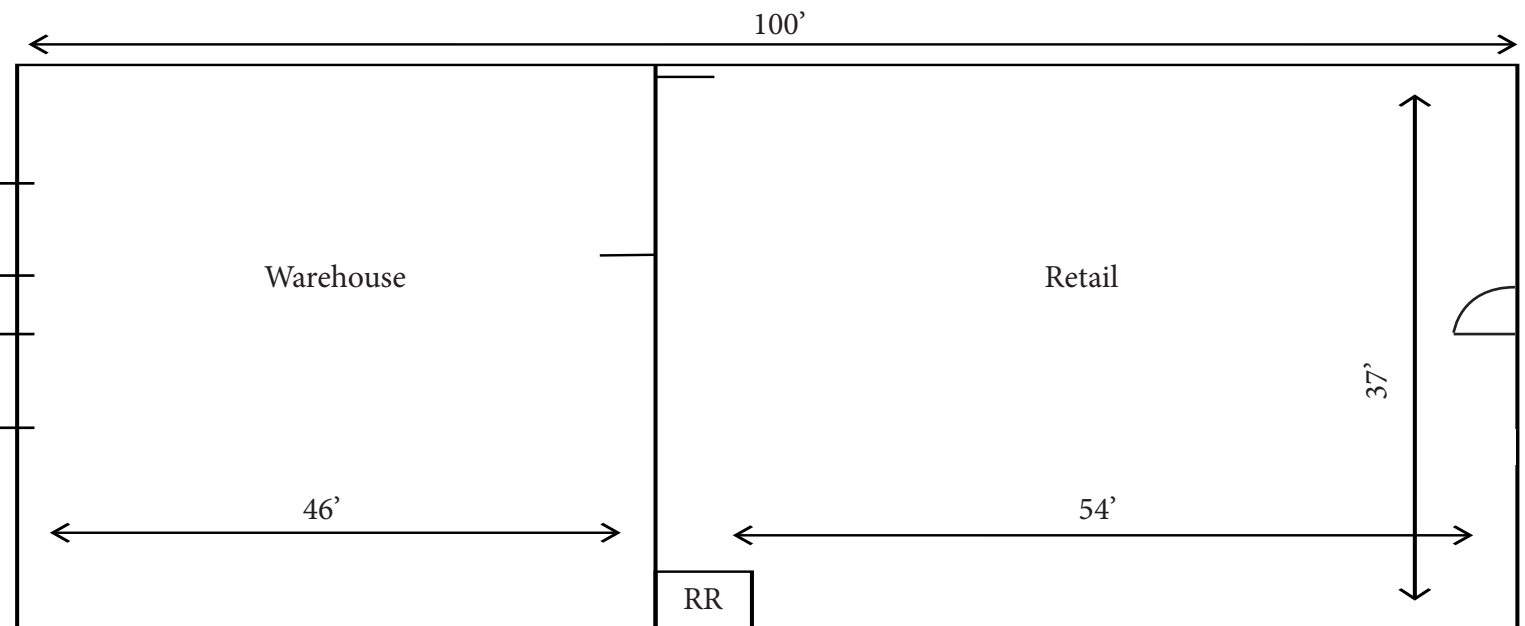

Vicki Patterson, CCIM **918.519.6731** | Erica Cunningham **918.829.5754**

vpatterson@wigginprop.com | ecunningham@wigginprop.com | wigginprop.com

This material is provided for information purposes only. It is from sources believed to be reliable. However, Wiggin Properties makes no warranties or representations, expressed or implied, as to the accuracy or sufficiency of the information. It is presented subject to errors, omissions, changes or withdrawal without notice. Square footage is provided by the local County Assessor or the Owner. Photos and graphics with copyrights by Costar, Google, Wiggin Properties and independent contractors are used with permission.