

WAREHOUSE SPACE FOR LEASE

44873 FALCON PLACE - SUITE 128 | STERLING, VA 20166



PROPERTY FEATURES

- 5,457 RSF
- 18' clear height
- (2) loading docks, of which (1) has a ramp
- 3.3/1000 parking ratio
- Relet office build-out with 2 sets of restrooms

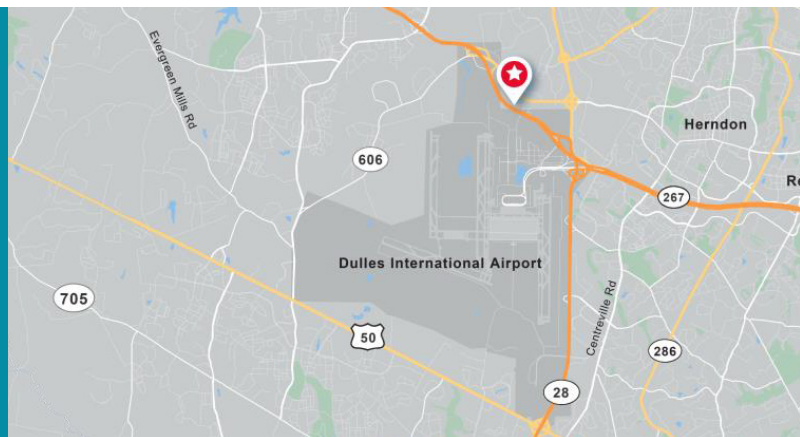

FOR MORE INFORMATION, PLEASE CONTACT:

Jon Lawrence
Executive Director
703 847 2787
jon.lawrence@cushwake.com

Ed Zaptin
Senior Director
703 847 2730
ed.zaptin@cushwake.com

Shane Keeton
Brokerage Specialist
703 847 2784
shane.keeton@cushwake.com

CUSHMAN & WAKEFIELD OF VIRGINIA
1800 Tysons Boulevard | Suite 200
Tysons Corner | VA 22102
www.cushmanwakefield.com

©2024 Cushman & Wakefield. All rights reserved. The information contained in this communication is strictly confidential. This information has been obtained from sources believed to be reliable but has not been verified. NO WARRANTY OR REPRESENTATION, EXPRESS OR IMPLIED, IS MADE AS TO THE CONDITION OF THE PROPERTY (OR PROPERTIES) REFERENCED HEREIN OR AS TO THE ACCURACY OR COMPLETENESS OF THE INFORMATION CONTAINED HEREIN, AND SAME IS SUBMITTED SUBJECT TO ERRORS, OMISSIONS, CHANGE OF PRICE, RENTAL OR OTHER CONDITIONS, WITHDRAWAL WITHOUT NOTICE, AND TO ANY SPECIAL LISTING CONDITIONS IMPOSED BY THE PROPERTY OWNER(S). ANY PROJECTIONS, OPINIONS OR ESTIMATES ARE SUBJECT TO UNCERTAINTY AND DO NOT SIGNIFY CURRENT OR FUTURE PROPERTY PERFORMANCE.



**CUSHMAN &
WAKEFIELD**

WAREHOUSE SPACE FOR LEASE

44873 FALCON PLACE - SUITE 128 | STERLING, VA 20166

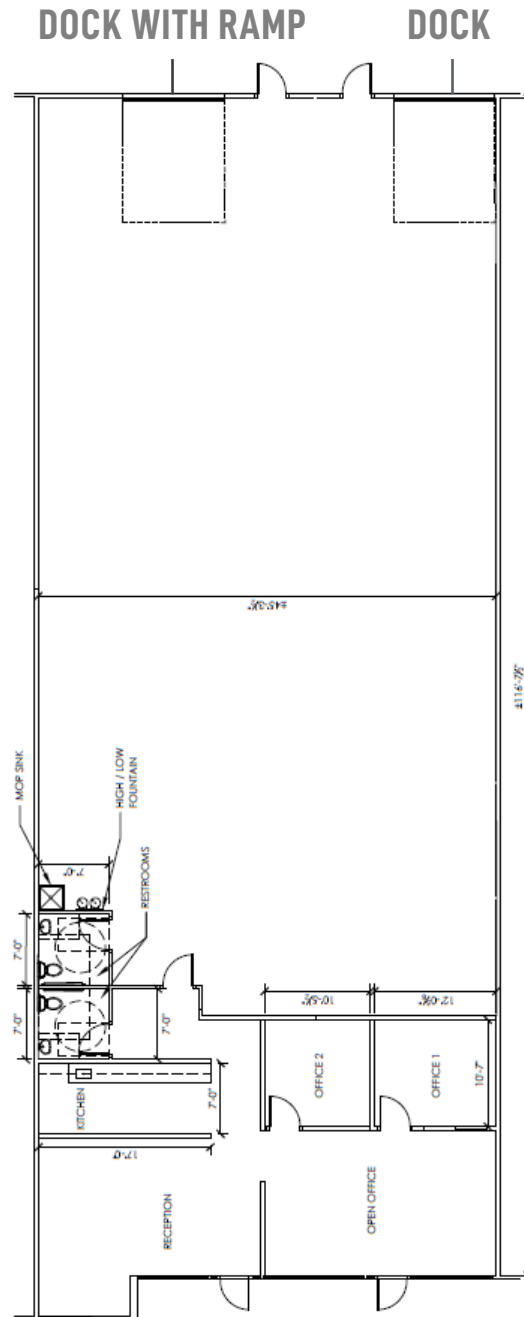

FOR MORE INFORMATION, PLEASE CONTACT:

Jon Lawrence
Executive Director
703 847 2787
jon.lawrence@cushwake.com

Ed Zaptin
Senior Director
703 847 2730
ed.zaptin@cushwake.com

Shane Keeton
Brokerage Specialist
703 847 2784
shane.keeton@cushwake.com

CUSHMAN & WAKEFIELD OF VIRGINIA
1800 Tysons Boulevard | Suite 200
Tysons Corner | VA 22102
www.cushmanwakefield.com

©2024 Cushman & Wakefield. All rights reserved. The information contained in this communication is strictly confidential. This information has been obtained from sources believed to be reliable but has not been verified. NO WARRANTY OR REPRESENTATION, EXPRESS OR IMPLIED, IS MADE AS TO THE CONDITION OF THE PROPERTY (OR PROPERTIES) REFERENCED HEREIN OR AS TO THE ACCURACY OR COMPLETENESS OF THE INFORMATION CONTAINED HEREIN, AND SAME IS SUBMITTED SUBJECT TO ERRORS, OMISSIONS, CHANGE OF PRICE, RENTAL OR OTHER CONDITIONS, WITHDRAWAL WITHOUT NOTICE, AND TO ANY SPECIAL LISTING CONDITIONS IMPOSED BY THE PROPERTY OWNER(S). ANY PROJECTIONS, OPINIONS OR ESTIMATES ARE SUBJECT TO UNCERTAINTY AND DO NOT SIGNIFY CURRENT OR FUTURE PROPERTY PERFORMANCE.



CUSHMAN & WAKEFIELD