

AVAILABLE FOR SALE

MT. SHASTA MALL – 1291 Hilltop Dr, Redding, CA 96003 – 110k SF / 2.4 Acres

Disclaimer: Representative Photo

FOR MORE INFORMATION:

Patrick Brady: mobile. 602.245.9365 // email. pbrady@raiderhill.com



Redding, CA – 1291 Hilltop Dr, Redding, CA 96003

The anchor store is an owned location within Mt. Shasta Mall positioned at the intersection of Cascade Wonderland Hwy (I-5) and Rte-44

Metrics	Store
City, ST	Redding, CA
Mall Operator	Brookfield
Ownership Interest	Owned
Store GLA / Acres	110k SF / 2.4 Acres
# Floors – Store / Mall	2 (Stacked) / 1

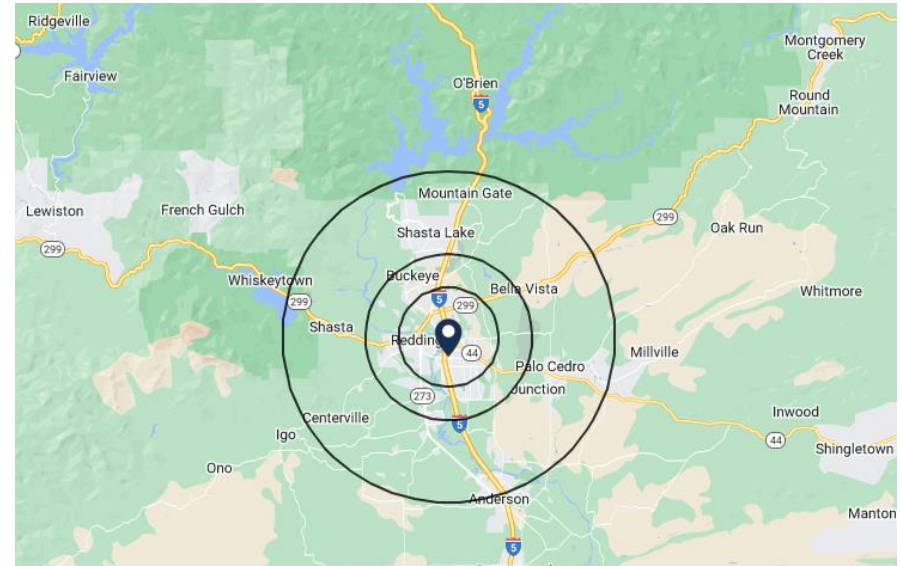

Population	3 Mile	5 Mile	10 Mile
Total Population	63,255	99,378	144,491
Median Age	37.4	39.0	40.6
Median Age (Male)	35.5	37.4	39.1
Median Age (Female)	39.5	40.8	42.2

Households & Income	3 Mile	5 Mile	10 Mile
Total Households	25,073	38,472	56,369
# of Persons Per Household	2.4	2.5	2.5
Average Household Income	\$98,957	\$107,142	\$106,670

* Demographic data derived from US Census

FOR MORE INFORMATION:

Patrick Brady: mobile. 602.245.9365 // email. pbrady@raiderhill.com

Redding, CA – Retail Submarket



FOR MORE INFORMATION:

Patrick Brady: mobile. 602.245.9365 // email. pbrady@raiderhill.com

Redding, CA – Mt. Shasta Mall

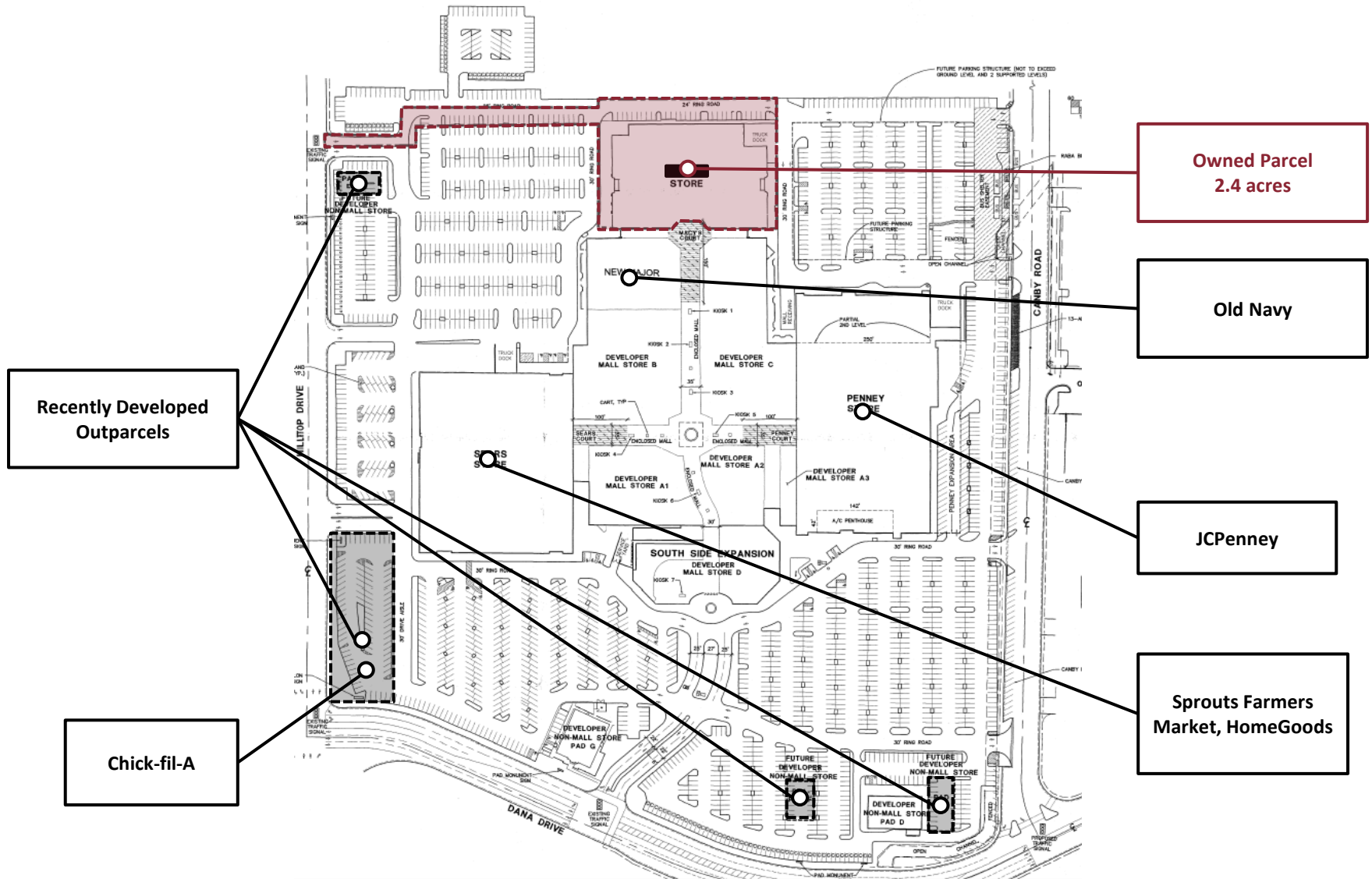

FOR MORE INFORMATION:

Patrick Brady: mobile. 602.245.9365 // email. pbrady@raiderhill.com

Second Floor

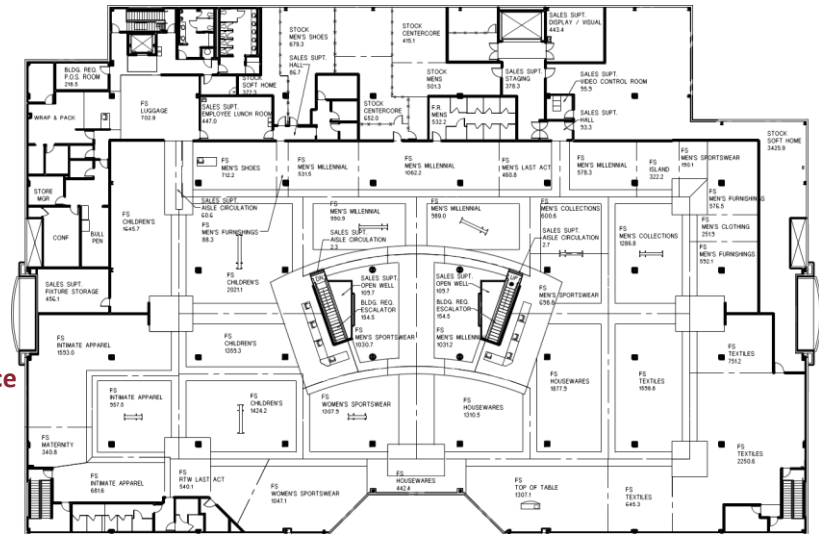

4