

# 20,070 SF

Industrial Space For Lease



## Prologis Park 13

5227 NE 152nd Place  
Portland, Oregon 97230



### LOCATION

- 2.5 miles east of I-205
- 4.8 miles east of Portland International Airport
- Signalized access to NE Airport Way

### FACILITY

- 20,070 SF available
- 2,135 SF office
- 26' clear height
- 5 dock high doors
- 3 grade level doors
- 3-phase, 277/480 volt, up to 225 amps
- ESFR sprinkler system
- End cap unit
- Available April 1, 2026

### ADVANTAGES AND AMENITIES

- Located with close proximity to PDX Airport, supporting services, and regional distribution transportation routes
- Efficient cross-dock loading with ideal building depth for a multitude of layout potentials
- Surplus land area that can be utilized for trailer parking or laydown yard area
- Hard to find size and functionality for the Airport Way submarket

# 20,070 SF

## Industrial Space For Lease

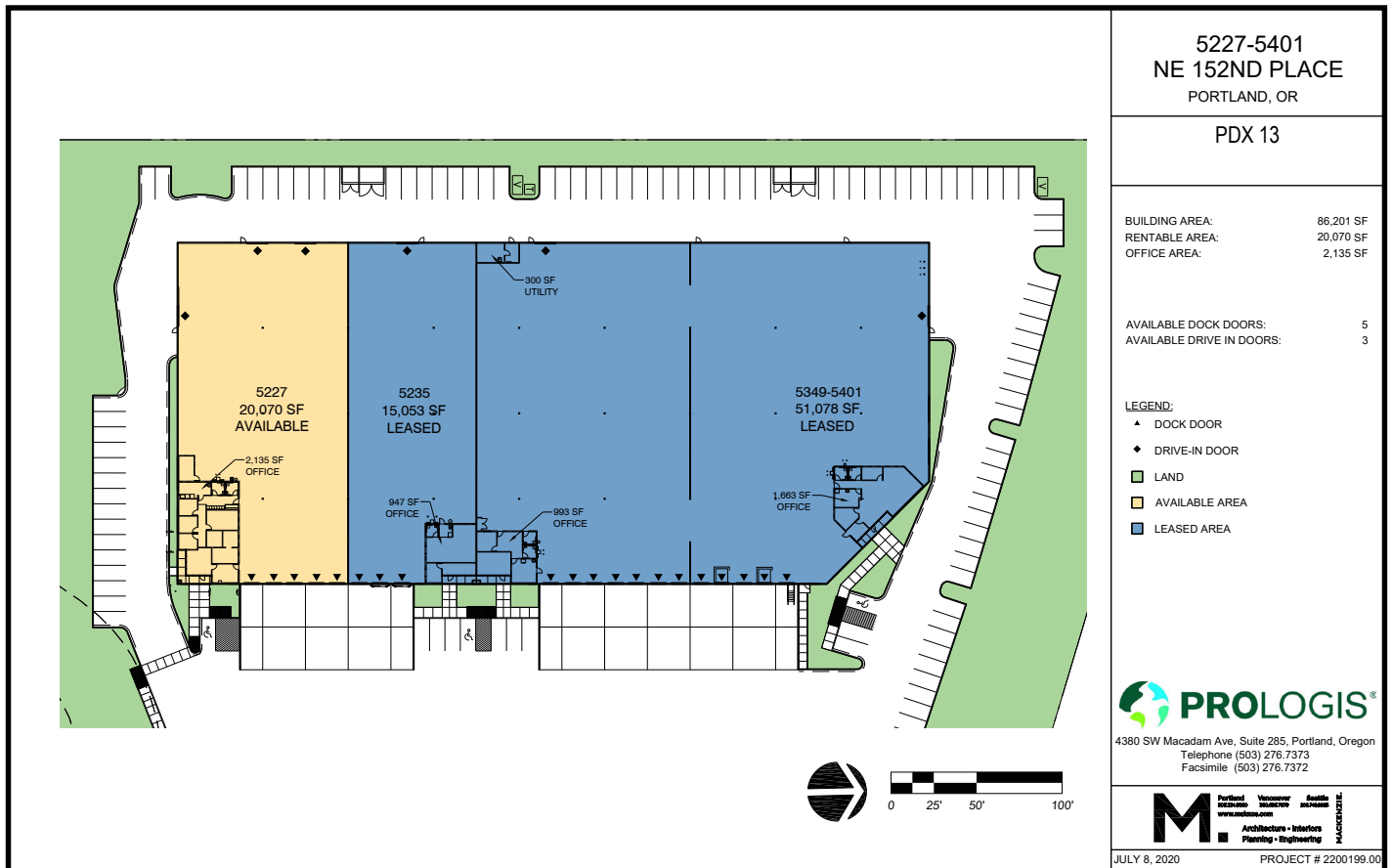

### KIDDER MATHEWS

Tom Talbot, SIOR  
 tom.talbot@kidder.com  
 ph +1 503 221 2270  
 101 SW Main Street  
 Suite 1200  
 Portland, OR 97204

### KIDDER MATHEWS

Tony Reser, SIOR  
 tony.reser@kidder.com  
 ph +1 503 221 2271  
 101 SW Main Street  
 Suite 1200  
 Portland, OR 97204

### KIDDER MATHEWS

Scott Murphy, SIOR  
 scott.murphy@kidder.com  
 ph +1 503 221 2287  
 101 SW Main Street  
 Suite 1200  
 Portland, OR 97204

### PROLOGIS

Sean Colletta  
 scolletta@prologis.com  
 ph +1 503 276 7375  
 4380 SW Macadam Ave  
 Suite 285  
 Portland, OR 97239