

# FORMER RITE AID LOCATION W/ OVER 3 ACRE LOT, EXCESS LAND

## 2938

W. ROSAMOND BLVD

ROSAMOND • CA 93560



## FOR SALE/LEASE



### 2938 W. ROSAMOND BLVD, ROSAMOND CA 93560

**Showings by appointment only**



**David Issaians, CCIM**  
818.307.0193  
david@kw.com  
DRE# 01792207

**Alliance Partners**  
COMMERCIAL REAL ESTATE ADVISORS  
AlliancePartnersco.com

**Emil Akopian, CCIM**  
818.339.8115  
Emila@kw.com  
DRE# 01449462



**Ryan Sypek**  
323.422.2422  
sypekgroup.com  
ryan.sypek@compass.com  
Broker Associate  
DRE#: 01949108  
5715 N Figueroa St #200  
Los Angeles CA 90042



KELLER WILLIAMS REAL ESTATE SERVICES | 889 Americana Way, #408 Glendale, CA 91210 | Each Office is Independently Owned and Operated. If your property is currently listed with another broker, this is not intended as a solicitation. Keller Williams Realty does not guarantee the accuracy of square footage, lot size, or other information concerning the condition or features of the property provided by the seller or obtained from public records or other sources and the buyer is advised to independently verify the accuracy of that information through personal inspection with appropriate licensed professionals.

# STATEMENT OF CONFIDENTIALITY & DISCLAIMER

The information contained in the following Offering Memorandum is proprietary and strictly confidential. It is intended to be reviewed only by the party receiving it from KW Commercial and it should not be made available to any other person or entity without the written consent of KW Commercial. By taking possession of and reviewing the information contained herein the recipient agrees to hold and treat all such information in the strictest confidence. The recipient further agrees that recipient will not photocopy or duplicate any part of the Offering Memorandum. If you have no interest in the subject property at this time, please return this Offering Memorandum to KW Commercial.

This Offering Memorandum has been prepared to provide summary, unverified financial and physical information to prospective purchasers, and to establish only a preliminary level of interest in the subject property. The information contained herein is not a substitute for a thorough due diligence investigation. KW Commercial has not made any investigation, and makes no warranty or representation with respect to the income or expenses for the subject property, the future projected financial performance of the property, the size and square footage of the property and improvements, the presence or absence of contaminating substances, PCBs or asbestos, the compliance with local, state and federal regulations, the physical condition of the improvements thereon, or the financial condition or business prospects of any tenant, or any tenant's plans or intentions to continue its occupancy of the subject property. The information contained in this Offering Memorandum has been obtained from sources we believe to be reliable; however, KW Commercial has not verified, and will not verify, any of the information contained herein, nor has KW Commercial conducted any investigation regarding these matters and makes no warranty or representation whatsoever regarding the accuracy or completeness of the information provided. All potential buyers must take appropriate measures to verify all of the information set forth herein. Prospective buyers shall be responsible for their costs and expenses of investigating the subject property.

All potential buyers are strongly advised to take advantage of their opportunities and obligations to conduct thorough due diligence and seek expert opinions as they may deem necessary. KW Commercial has not been retained to perform, and cannot conduct, due diligence on behalf of any prospective purchaser. KW Commercial's principal expertise is in marketing investment properties and acting as intermediaries between buyers and sellers. KW Commercial and its investment professionals cannot and will not act as lawyers, accountants, contractors, or engineers. All potential buyers are admonished and advised to engage other professionals on legal issues, tax, regulatory, financial, and accounting matters, and for questions involving the property's physical condition or financial outlook. Projections and pro forma financial statements are not guarantees and all potential buyers should be comfortable with and rely solely on their own projections, analyses, and decision-making.)



**Emil Akopian, CCIM**  
**818.339.8115**  
Emila@kw.com  
DRE# 01449462



**David Issaiahs, CCIM**  
**818.307.0193**  
david@kw.com  
DRE# 01792207

**KELLER WILLIAMS REAL ESTATE SERVICES**  
**889 AMERICANA WAY, #408 GLENDALE, CA 91210**

Each Office is Independently Owned and Operated. If your property is currently listed with another broker, this is not intended as a solicitation. Keller Williams Realty does not guarantee the accuracy of square footage, lot size, or other information concerning the condition or features of the property provided by the seller or obtained from public records or other sources and the buyer is advised to independently verify the accuracy of that information through personal inspection with appropriate licensed professionals.

**Ryan Sypek**  
**323.422.2422**  
sypekgroup.com  
ryan.sypek@compass.com  
Broker Associate  
DRE#: 01949108

5715 N Figueroa St #200  
Los Angeles CA 90042

**COMPASS**

## SITE CHARACTERISTICS:

- Building Square footage : +/- 17,253
- Land Size: +/- 3.27 acres (142,441 square feet)
- APN: 251-181-01-00-3
- Approx. parcel dimensions: 300x475
- Year Built: 2016
- Zoning: C2 (per title)
- Tenancy Status: Vacant
- Former Use: Built-to-Suit for Rite Aid

## SITE HIGHLIGHTS:

- Newer Construction (2016)
- Abundance of on-site parking
- Double Lane Drive through
- Signalized Corner location
- Great Visibility on main thoroughfare
- Close Proximity to freeways

**ABOUT ROSAMOND:** Located in Southern California's Antelope Valley, Rosamond is an unincorporated town of around 18,000 at the hub of what has been called "Aerospace Valley". Rosamond is the gateway to Edwards Air Force Base, and is just south of the emerging civilian spaceport at Mojave.



# 2938 W. ROSAMOND BLVD, ROSAMOND CA 93560

Showings by appointment only



**David Issaiahs, CCIM**  
**818.307.0193**  
 david@kw.com  
 DRE# 01792207

**Alliance Partners**  
 COMMERCIAL REAL ESTATE ADVISORS  
 AlliancePartnersco.com

**Emil Akopian, CCIM**  
**818.339.8115**  
 Emila@kw.com  
 DRE# 01449462



**Ryan Sypek**  
**323.422.2422**  
 sypekgroup.com  
 ryan.sypek@compass.com  
 Broker Associate  
 DRE#: 01949108  
 5715 N Figueroa St #200  
 Los Angeles CA 90042



KELLER WILLIAMS REAL ESTATE SERVICES | 889 Americana Way, #408 Glendale, CA 91210 | Each Office is Independently Owned and Operated. If your property is currently listed with another broker, this is not intended as a solicitation. Keller Williams Realty does not guarantee the accuracy of square footage, lot size, or other information concerning the condition or features of the property provided by the seller or obtained from public records or other sources and the buyer is advised to independently verify the accuracy of that information through personal inspection with appropriate licensed professionals.



Photos

2938 W. ROSAMOND BLVD, ROSAMOND CA 93560

Showings by appointment only



David Issaiahs, CCIM  
818.307.0193  
david@kw.com  
DRE# 01792207

**Alliance Partners**  
COMMERCIAL REAL ESTATE ADVISORS  
AlliancePartnersco.com

Emil Akopian, CCIM  
818.339.8115  
Emila@kw.com  
DRE# 01449462



Ryan Sypek  
323.422.2422  
sypekgroup.com  
ryan.sypek@compass.com  
Broker Associate  
DRE#: 01949108  
5715 N Figueroa St #200  
Los Angeles CA 90042



KELLER WILLIAMS REAL ESTATE SERVICES | 889 Americana Way, #408 Glendale, CA 91210 | Each Office is Independently Owned and Operated. If your property is currently listed with another broker, this is not intended as a solicitation. Keller Williams Realty does not guarantee the accuracy of square footage, lot size, or other information concerning the condition or features of the property provided by the seller or obtained from public records or other sources and the buyer is advised to independently verify the accuracy of that information through personal inspection with appropriate licensed professionals.



## 2938 W. ROSAMOND BLVD, ROSAMOND CA 93560

Showings by appointment only



**David Issaians, CCIM**  
818.307.0193  
david@kw.com  
DRE# 01792207

**Alliance Partners**  
COMMERCIAL REAL ESTATE ADVISORS  
AlliancePartnersco.com

**Emil Akopian, CCIM**  
818.339.8115  
Emila@kw.com  
DRE# 01449462



**Ryan Sypek**  
323.422.2422  
sypekgroup.com  
ryan.sypek@compass.com  
Broker Associate  
DRE#: 01949108  
5715 N Figueroa St #200  
Los Angeles CA 90042



KELLER WILLIAMS REAL ESTATE SERVICES | 889 Americana Way, #408 Glendale, CA 91210 | Each Office is Independently Owned and Operated. If your property is currently listed with another broker, this is not intended as a solicitation. Keller Williams Realty does not guarantee the accuracy of square footage, lot size, or other information concerning the condition or features of the property provided by the seller or obtained from public records or other sources and the buyer is advised to independently verify the accuracy of that information through personal inspection with appropriate licensed professionals.

Rite Aid									
2938 W Rosamond Blvd, Rosamond, CA 93560									
Building Type: <b>General Retail</b>			Total Available: <b>17,277 SF</b>						
Secondary: <b>Drug Store</b>			% Leased: <b>0%</b>						
GLA: <b>17,277 SF</b>			Rent/SF/Yr: <b>-</b>						
Year Built: <b>2016</b>									
Radius			2 Mile		5 Mile		10 Mile		
Population									
2029 Projection			18,575		21,456		27,750		
2024 Estimate			18,420		21,301		27,458		
2020 Census			17,607		20,485		25,465		
Growth 2024 - 2029			0.84%		0.73%		1.06%		
Growth 2020 - 2024			4.62%		3.98%		7.83%		
<b>2024 Population by Hispanic Origin</b>			8,553		9,887		12,226		
<b>2024 Population</b>			18,420		21,301		27,458		
White			9,055 49.16%		10,686 50.17%		14,359 52.29%		
Black			2,099 11.40%		2,226 10.45%		2,434 8.86%		
Am. Indian & Alaskan			266 1.44%		318 1.49%		423 1.54%		
Asian			718 3.90%		767 3.60%		900 3.28%		
Hawaiian & Pacific Island			67 0.36%		92 0.43%		114 0.42%		
Other			6,215 33.74%		7,212 33.86%		9,228 33.61%		
U.S. Armed Forces			388		409		409		
<b>Households</b>									
2029 Projection			6,255		7,251		9,436		
2024 Estimate			6,211		7,208		9,351		
2020 Census			5,962		6,961		8,720		
Growth 2024 - 2029			0.71%		0.60%		0.91%		
Growth 2020 - 2024			4.18%		3.55%		7.24%		
Owner Occupied			4,091 65.87%		4,842 67.18%		6,609 70.68%		
Renter Occupied			2,120 34.13%		2,367 32.84%		2,741 29.31%		
<b>2024 Households by HH Income</b>			6,210		7,208		9,351		
Income: <\$25,000			1,304 21.00%		1,459 20.24%		2,011 21.51%		
Income: \$25,000 - \$50,000			1,103 17.76%		1,247 17.30%		1,585 16.95%		
Income: \$50,000 - \$75,000			879 14.15%		1,114 15.46%		1,346 14.39%		
Income: \$75,000 - \$100,000			777 12.51%		930 12.90%		1,124 12.02%		
Income: \$100,000 - \$125,000			608 9.79%		756 10.49%		1,047 11.20%		
Income: \$125,000 - \$150,000			666 10.72%		728 10.10%		895 9.57%		
Income: \$150,000 - \$200,000			573 9.23%		605 8.39%		718 7.68%		
Income: \$200,000+			300 4.83%		369 5.12%		625 6.68%		
<b>2024 Avg Household Income</b>			\$86,546		\$86,729		\$88,836		
<b>2024 Med Household Income</b>			\$70,923		\$70,819		\$70,508		

Rite Aid				
2938 W Rosamond Blvd, Rosamond, CA 93560				
Building Type: <b>General Retail</b>				
Secondary: <b>Drug Store</b>				
GLA: <b>17,277 SF</b>				
Year Built: <b>2016</b>				
Total Available: <b>17,277 SF</b>				
% Leased: <b>0%</b>				
Rent/SF/Yr: -				
2024 Annual Spending (\$000s)		2 Mile	5 Mile	10 Mile
Total Specified Consumer Spending		\$207,877	\$241,686	\$319,725
Total Apparel		\$11,451	\$13,139	\$16,923
Women's Apparel		4,164	4,777	6,217
Men's Apparel		2,256	2,611	3,402
Girl's Apparel		955	1,082	1,350
Boy's Apparel		712	814	1,023
Infant Apparel		622	709	880
Footwear		2,743	3,147	4,052
Total Entertainment & Hobbies		\$30,309	\$35,438	\$47,550
Entertainment		6,661	7,864	10,721
Audio & Visual Equipment/Service		6,338	7,355	9,617
Reading Materials		418	491	672
Pets, Toys, & Hobbies		5,126	5,969	7,939
Personal Items		11,768	13,760	18,601
Total Food and Alcohol		\$56,422	\$65,471	\$85,399
Food At Home		30,396	35,306	46,212
Food Away From Home		22,561	26,139	33,904
Alcoholic Beverages		3,465	4,025	5,283
Total Household		\$32,550	\$37,721	\$50,334
House Maintenance & Repair		7,447	8,757	11,942
Household Equip & Furnishings		12,760	14,778	19,637
Household Operations		9,271	10,656	14,014
Housing Costs		3,073	3,530	4,741

2938 W. ROSAMOND BLVD, ROSAMOND CA 93560

Showings by appointment only



David Issaiaans, CCIM  
818.307.0193  
david@kw.com  
DRE# 01792207

**Alliance Partners**  
COMMERCIAL REAL ESTATE ADVISORS  
AlliancePartnersco.com

Emil Akopian, CCIM  
818.339.8115  
Emila@kw.com  
DRE# 01449462



Ryan Sypek  
323.422.2422  
sypekgroup.com  
ryan.sypek@compass.com  
Broker Associate  
DRE#: 01949108

5715 N Figueroa St #200  
Los Angeles CA 90042



Demographics

KELLER WILLIAMS REAL ESTATE SERVICES | 889 Americana Way, #408 Glendale, CA 91210 | Each Office is Independently Owned and Operated. If your property is currently listed with another broker, this is not intended as a solicitation. Keller Williams Realty does not guarantee the accuracy of square footage, lot size, or other information concerning the condition or features of the property provided by the seller or obtained from public records or other sources and the buyer is advised to independently verify the accuracy of that information through personal inspection with appropriate licensed professionals.

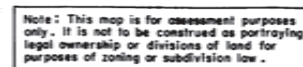

## Plat Map

ASSESSORS MAP NO. 251-18  
COUNTY OF KERN

## Showings by appointment only





2938 W. ROSAMOND BLVD, ROSAMOND CA 93560

Showings by appointment only



David Issaians, CCIM  
818.307.0193  
david@kw.com  
DRE# 01792207

**Alliance Partners**  
COMMERCIAL REAL ESTATE ADVISORS  
AlliancePartnersco.com

Emil Akopian, CCIM  
818.339.8115  
Emila@kw.com  
DRE# 01449462



Ryan Sypek  
323.422.2422  
sypekgroup.com  
ryan.sypek@compass.com  
Broker Associate  
DRE#: 01949108  
5715 N Figueroa St #200  
Los Angeles CA 90042



KELLER WILLIAMS REAL ESTATE SERVICES | 889 Americana Way, #408 Glendale, CA 91210 | Each Office is Independently Owned and Operated. If your property is currently listed with another broker, this is not intended as a solicitation. Keller Williams Realty does not guarantee the accuracy of square footage, lot size, or other information concerning the condition or features of the property provided by the seller or obtained from public records or other sources and the buyer is advised to independently verify the accuracy of that information through personal inspection with appropriate licensed professionals.