

Manufacturing Space

5,000 -25,000 SF For Lease

168 West Main Street
Honeoye Falls, NY 14472

4 Grade Level Doors & Heavy Power



Offering Overview

168 West Main Street is a 26,000± square foot manufacturing building in the Village of Honeoye Falls, with up to 25,000 square feet available for lease. The property features heavy power, 14' clear height and four grade level doors.

Offering Details

- + 5,000 - 25,000 SF For Lease
- + Heavy Power
- + 4 Grade Level Doors
- + Lease Rate: Negotiable

Manufacturing Space

168 West Main St | Honeoye Falls, NY 14472

For Lease



Property Overview

- + 26,000 Square Feet Total
 - 23,500 SF Manufacturing Space
 - 2,500 SF Office Existing
- + 5,000 - 25,000 SF Available For Lease
- + 4 Grade Level Doors
- + Underground Radiant Heat at Overhead Doors
- + 14' Clear Height
- + Power: 800amp, 3-Phase 240volt
- + Manufacturing Space is Heat Only
- + Racking Available
- + 10 Minutes from I-390

Contact Us

Patrick Wahl

+1 585 784 3633

patrick.wahl@cbre-rochester.com

Licensed Real Estate Salesperson

Harry Gleason, SIOR

+1 585 784 3639

harry.gleason@cbre-rochester.com

Licensed Associate Real Estate Broker

© 2025 CBRE Upstate NY, part of the CBRE Affiliate Network. All rights reserved. This information has been obtained from sources believed reliable, but has not been verified for accuracy or completeness. You should conduct a careful, independent investigation of the property and verify all information. Any reliance on this information is solely at your own risk. CBRE Upstate NY and the CBRE Upstate NY logo are service marks of CBRE Upstate NY. All other marks displayed on this document are the property of their respective owners, and the use of such logos does not imply any affiliation with or endorsement of CBRE Upstate NY. Photos herein are the property of their respective owners. Use of these images without the express written consent of the owner is prohibited.

CBRE Upstate NY

1350 University Ave, Ste 100

Rochester, NY 14607

+1 585 240 8080

www.cbre.com/rochester

CBRE Upstate NY

PART OF THE AFFILIATE NETWORK

168 West Main St | Honeoye Falls, NY 14472

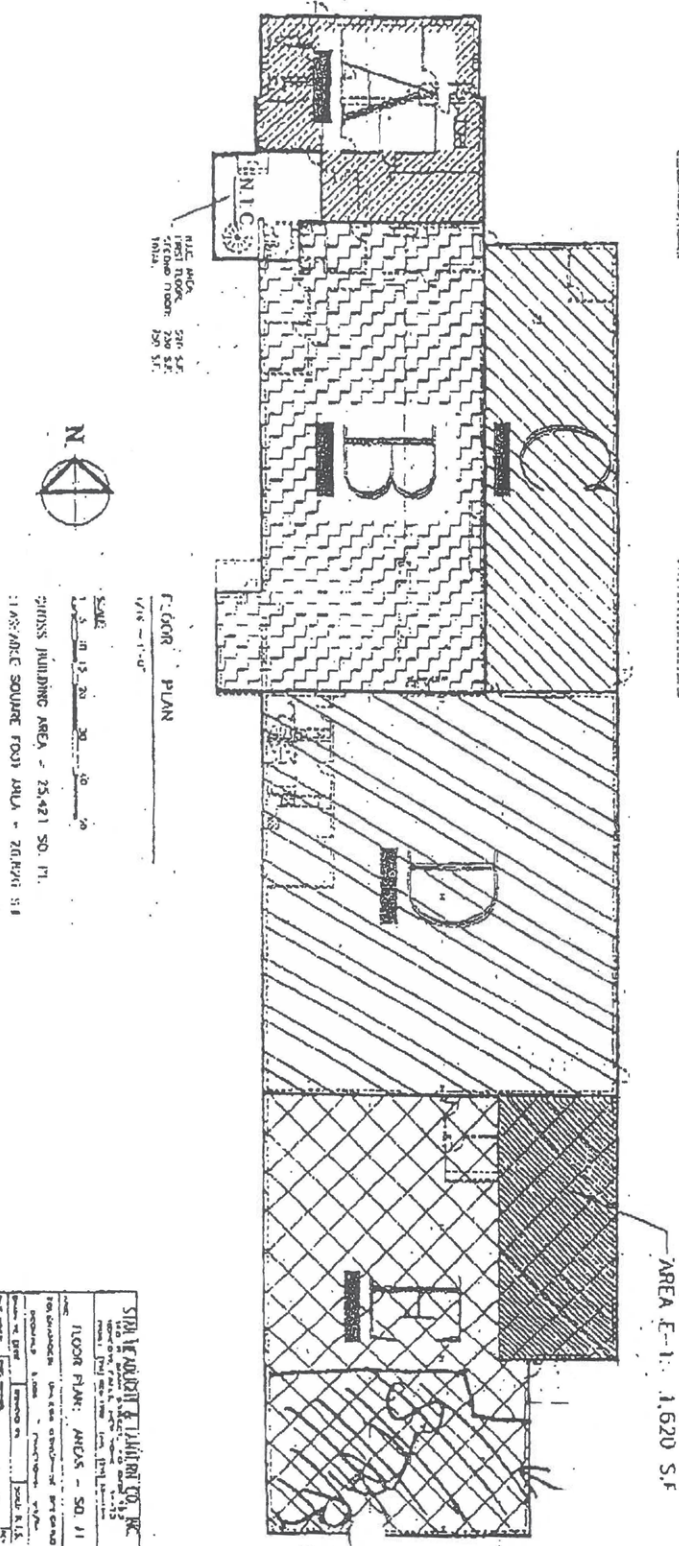

AREA - SQUARE FOOT:	
A.	2,400 S.F.
B.	5,020 S.F.
D-WCZP	1,020 S.F.
C	3,000 S.F.
D	7,200 S.F.
E	7,200 S.F.
(INCLUDES AREA E-1)	
TOTAL LEASEABLE SQUARE FOOT	26,820 S.F.

REV	DATE	CHANGE
A	—	<p>AREA 1: 2400 SF TO 2100 SF AREA 11: 5000 SF TO 5400 SF ADD 6-ACD. AREA 1700 SF; SPORT AREA 11-11, 1400 SF; (INCLUDED IN AREA 11) TOTAL 125500.1 AREA 7-9-82 SF TO 12400 SF; ADD NITE AREA: 500 SF 14, 250 SF 200 = 750 SF TOTAL</p>

Licensed Associate Real Estate Broker

Licensed Real Estate Salesperson

PART OF THE AFFILIATE NETWORK