



Rendering

545

METROPOLITAN AVENUE

WILLIAMSBURG VENTED RETAIL/RESTAURANT SPACE | 985 SF + BSMT IN THE HEART OF WILLIAMSBURG | NEW CONSTRUCTION

545 Metropolitan Avenue, Williamsburg

Between Lorimer Street & Union Avenue

Available Space

Ground Floor:	985 sf	Frontage:	14'-7" along Metropolitan Ave	Possession:	February 2025
Basement:	237 sf			Rent:	Upon Request

Comments

- Vented space - all uses considered
- New construction under way - at base of 6-unit residential development
- Steps from the **G** train at the Metropolitan Ave station and Lorimer Street **L** -train station
- Area retail and eateries include H&H Reserve, Brooklyn Roasting Company, Quimby's Bookstore, Dunkin', Mozaik Café, Kini Wine Bar, Kellogg's Diner, Pomp & Circumstance, Beer Karma, Montesacro, Zona Rosa, Kellogg's Diner, Bagelsmith, Union Pool, Settepani Bakery, Mo's General, Alligator Lounge, Northern Bell, Pinkerton Wine Bar, Blue Brown Café, Starbucks, Think Coffee, Barcade, Ainslie

By the Numbers

Retail Businesses

1,241

1 Mile Radius

Households

71,581

2024 est. - 1 Mile Radius

Avg. Household Income

\$121,187

2024 - 1 Mile Radius

Subway Ridership

3,903,034

2023 - L/G station

Floor Plans

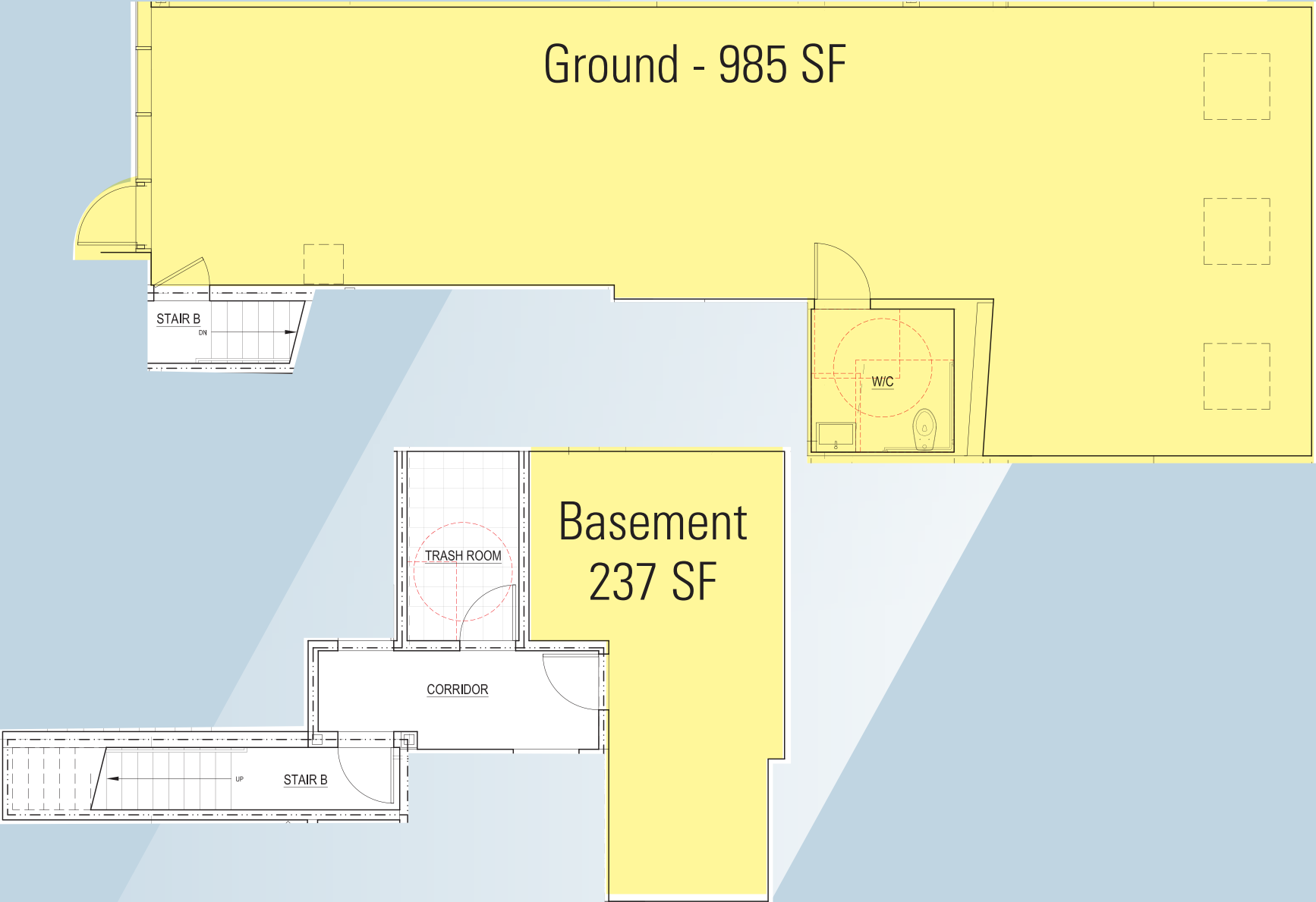



1,582 Residential Units, New School
 500,000 SF Commercial Space
 6-Acre Waterfront Explanade

Hotel Indigo - 188-keys
 500 Metropolitan Avenue

SELECT HIGHLIGHTED AREA TENANTS

- | | | | | | | |
|---------------------------------|------------------------------|------------------------------|------------------------------|----------------------------|-----------------------------|-------------------------|
| 1. Brooklyn Art Haus | 37. Form50 Fitness | 88. CAVA | 96. Citizens | 110. Blue Bottle Coffee | 126. DeStefano's Steakhouse | 138. Pinkerton Wine Bar |
| 3. Medrite | 48. Vanessa's Dumpling House | 89. Levain Bakery | 97. Black Seed Bagels | 113. Serendipity bk | 127. BagelSmith | 139. OutBox Gym |
| 5. Momofuku Milk Bar | 55. Williamsburg Cinemas | 90. Apple | 98. The Levee | 115. J.Crew | 128. Union Pool | 140. Blue Brown Café |
| 9. Fette Sau | 65. Roberta's | 91. Sweetgreen | 99. Elite Williamsburg | 117. Trader Joe's | 129. Kings Co Imperial | 141. Starbucks |
| 13. Gertie | 67. Sunday in Brooklyn | 93. Equinox | 100. Velma Vintage | 118. Brooklyn Roasting Co. | 130. Settepani Bakery | 142. Think Coffee |
| 14. St. Mazie Bar & Supper Club | 68. FREEHOLD | 94. Whole Foods Market | 101. Daily Feed | 119. H&H Reserve | 131. 787 Coffee | 143. Suzume |
| 16. Emmy Squared Pizza | 70. Devoción | 95. Duane Reade | 102. Williamsburg Veterinary | 120. Pomp & Circumstance | 132. Sunac Natural Food | 144. Hidden Grounds |
| 22. The Yard | 72. Nitehawk Cinema | 96. Citizens | 103. Jack's Wife Frieda | 121. Beer Karma | 133. Vine Wine | 145. Barcade |
| 23. Weylin | 77. The Four Horsemen | 102. Williamsburg Veterinary | 104. KCDC Skateshop | 122. Montesacro Brooklyn | 134. Mo's General | 146. The West Brooklyn |
| 25. Pies 'n' Thighs | 79. St. Anselm | 103. Jack's Wife Frieda | 105. RAINS | 123. Metropolitan | 135. Alligator Lounge | 147. Ainslie |
| 32. The Woods | 86. Bond Vet | 105. RAINS | 106. Book Thug Nation | 124. Zona Rosa | 136. Northern Bell | |
| | 87. Just Salad | 107. Casper | 107. Casper | 125. Kellogg's Diner | 137. Birria-Landia | |



For further information and/or inspection contact:

Ben Waller

Partner

Licensed Assoc. Real Estate Broker
212.400.9515 | bwaller@absre.com

Anthony Diorio

Director

Licensed Real Estate Salesperson
518.894.1605 | adiorio@absre.com

Mark Tergesen

Partner

Licensed Assoc. Real Estate Broker
212.400.9528 | mt@absre.com

ABS Partners Real Estate • 200 Park Avenue South, 10th Floor, New York, NY 10003 • 212.400.6060 • www.absre.com