



# FOR LEASE • BUILDING 242 • 2nd FLOOR

54,608 SF • 5411 Luce Avenue, McClellan



-  Ken Giannotti • John Knauer
-  Office: 916 965-7100
-  Email: [Leasing@McClellanPark.com](mailto:Leasing@McClellanPark.com)

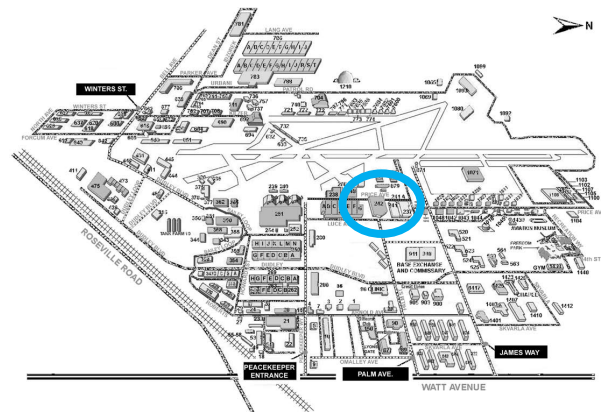

# FOR LEASE • BUILDING 242 • 2<sup>nd</sup> FLOOR

54,608 SF • 5411 Luce Avenue, McClellan

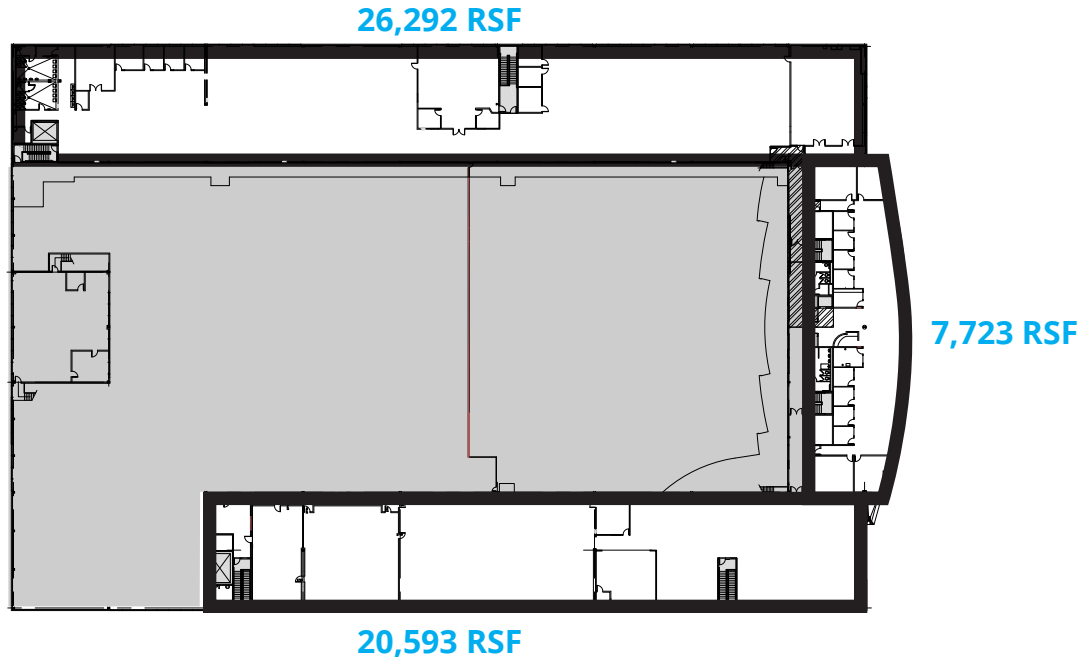

## Building Features

### Suites from 2,000 SF

- ✓ Prominent location inside the McClellan Conference Center
- ✓ Tenant improvements to suit
- ✓ Monument signage opportunity
- ✓ Fiber ready
- ✓ Building signage opportunity
- ✓ Ample parking: 4:1,000 SF
- ✓ Beach Hut Deli on premises

## Services & Amenities

- ✓ Onsite full service hotel & conference center
- ✓ Onsite full service airport and FBO
- ✓ Onsite McClellan facility services (available for contract)
- ✓ Onsite restaurants
- ✓ Regional transit shuttle to lightrail
- ✓ Close proximity to Watt & I-80 Freeways
- ✓ 24/7/365 onsite security patrol
- ✓ California Family Fitness onsite
- ✓ Residential apartments & homes for rent
- ✓ Full broker cooperation