

# New Development Opportunity

Positioned at a signalized hard corner across from Publix Supermarket

SWC of St. John Heritage Pkwy & Malabar Rd  
Palm Bay, FL 32907  
[www.cbre.com/orlando](http://www.cbre.com/orlando)

Located in a high residential growth area





# Property Highlights

- + New Retail Development Opportunity
- + Two available retail parcels:
  - Parcel 1: ±1.20 Acres
  - Parcel 2: ±1.14 Acres
- + Strategically positioned at a signalized hard corner offering strong visibility and ease of access
- + Located directly across from a new Publix-anchored shopping center, enhancing daily traffic and retail synergy
- + Co-tenancy opportunities with nationally recognized retailers including Wawa and Mavis Tires & Brakes
- + Situated within a high-growth residential trade area experiencing a 3.19% annual population increase within a five-minute drive
- + Affluent demographic profile, with an average household income of \$109,638 within a five-minute drive
- + St. Johns Heritage Parkway Extension: Future roadway extension currently in the planning and environmental review phase; schedule subject to project approvals



5 Minute Drive Time

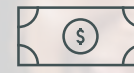

**\$109,638**

Average Household Income



**40.5**

Median Age



**3.19%**

Population Growth Rate

# Site Plan | Conceptual

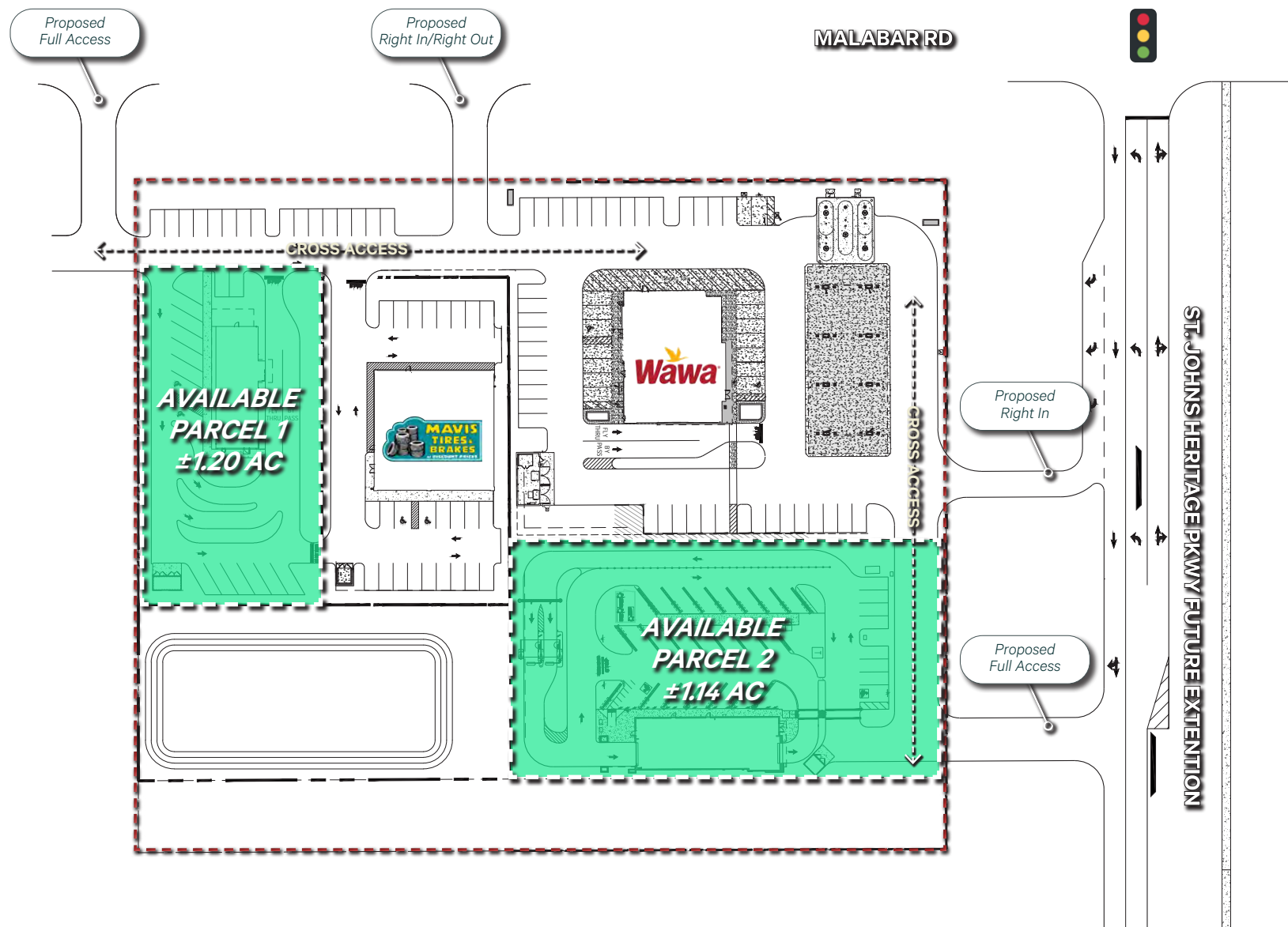



# Aerial | Trade Area





5 Minute Drive Time

# Housing Growth

NEW SUBDIVISION	PLANNED HOMES	HOMES BUILT
Edgewood at Everlands	162	162
Riverwood at Everlands	840	69
Timbers at Everlands	840	235
Malabar Springs	885	0
Palm Island	77	0
Sanibel Cove	50	48
St Johns Preserve	740	432
Tillman Lakes	726	203
<b>TOTAL HOMES</b>	<b>4,320</b>	<b>1,149</b>







2025

# Demographics

5 Minutes

**1,786**

Total Population

**3.19%**

Population Growth

**1,157**

Daytime Population

**\$109,638**

Average Household  
Income

10 Minutes

**14,149**

Total Population

**1.48%**

Population Growth

**8,818**

Daytime Population

**\$94,793**

Average Household  
Income

15 Minutes

**43,061**

Total Population

**1.07%**

Population Growth

**29,756**

Daytime Population

**\$97,478**

Average Household  
Income

20 Minutes

**96,283**

Total Population

**1.35%**

Population Growth

**78,016**

Daytime Population

**\$98,899**

Average Household  
Income





# For leasing information please contact:

## Cabot L. Jaffee III

Senior Vice President  
Advisory & Transaction Services  
+1 407 404 5051  
[cabot.jaffee@cbre.com](mailto:cabot.jaffee@cbre.com)

## Katy Taylor

Senior Associate  
Advisory & Transaction Services  
+1 407 404 5071  
[katy.taylor1@cbre.com](mailto:katy.taylor1@cbre.com)

© 2025 CBRE, Inc. All rights reserved. This information has been obtained from sources believed reliable but has not been verified for accuracy or completeness. CBRE, Inc. makes no guarantee, representation or warranty and accepts no responsibility or liability as to the accuracy, completeness, or reliability of the information contained herein. You should conduct a careful, independent investigation of the property and verify all information. Any reliance on this information is solely at your own risk. CBRE and the CBRE logo are service marks of CBRE, Inc. All other marks displayed on this document are the property of their respective owners, and the use of such marks does not imply any affiliation with or endorsement of CBRE.

**CBRE**