

**PRICE REDUCTION!**



**105 TOPSHAM FAIR MALL RD.  
TOPSHAM, ME, 04086**

## PROPERTY HIGHLIGHTS

- 7,633± SF of prime medical/office space
- Easy access to and visible from I-295
- Traffic Count: 14,090 vehicles/day (AADT 2019)
- Newly renovated medical center anchored by Central Maine Healthcare and New England Cancer Center
- Nearby retailers include Target, Dick's Sporting Goods, Five Below, Panera, Smitty's Cinema, Gamestop, The Home Depot, Hannaford, Reny's and more.
- **Sublease Rate: \$20.00/SF NNN**

**FOR SUBLEASE**  
**MEDICAL/OFFICE SPACE**

## PROPERTY HIGHLIGHTS

<b>OWNER</b>	105 Topsham Fair Mall, LLC	<b>YEAR BUILT/ RENOVATED</b>	2007/2016
<b>SUBLESSOR</b>	Shields Imaging with Central Maine Health, LLC	<b>HVAC</b>	Central, natural gas fired
<b>ASSESSOR'S REFERENCE</b>	Map R05, Lot 08A	<b>UTILITIES</b>	Municipal
<b>BUILDING SIZE</b>	46,303± SF	<b>PARKING</b>	Ample on-site
<b>AVAILABLE SPACE</b>	Suite 5: 5,765± SF Suite 7: 1,868± SF	<b>SIGNAGE</b>	On building and pylon on main thoroughfare
<b>ZONING</b>	MUC - Mixed-Use Commercial	<b>AVAILABILITY</b>	Immediate
<b>LOT SIZE</b>	4.44± Acres	<b>SUBLEASE RATE</b>	\$20.00/SF NNN

## FLOOR PLAN

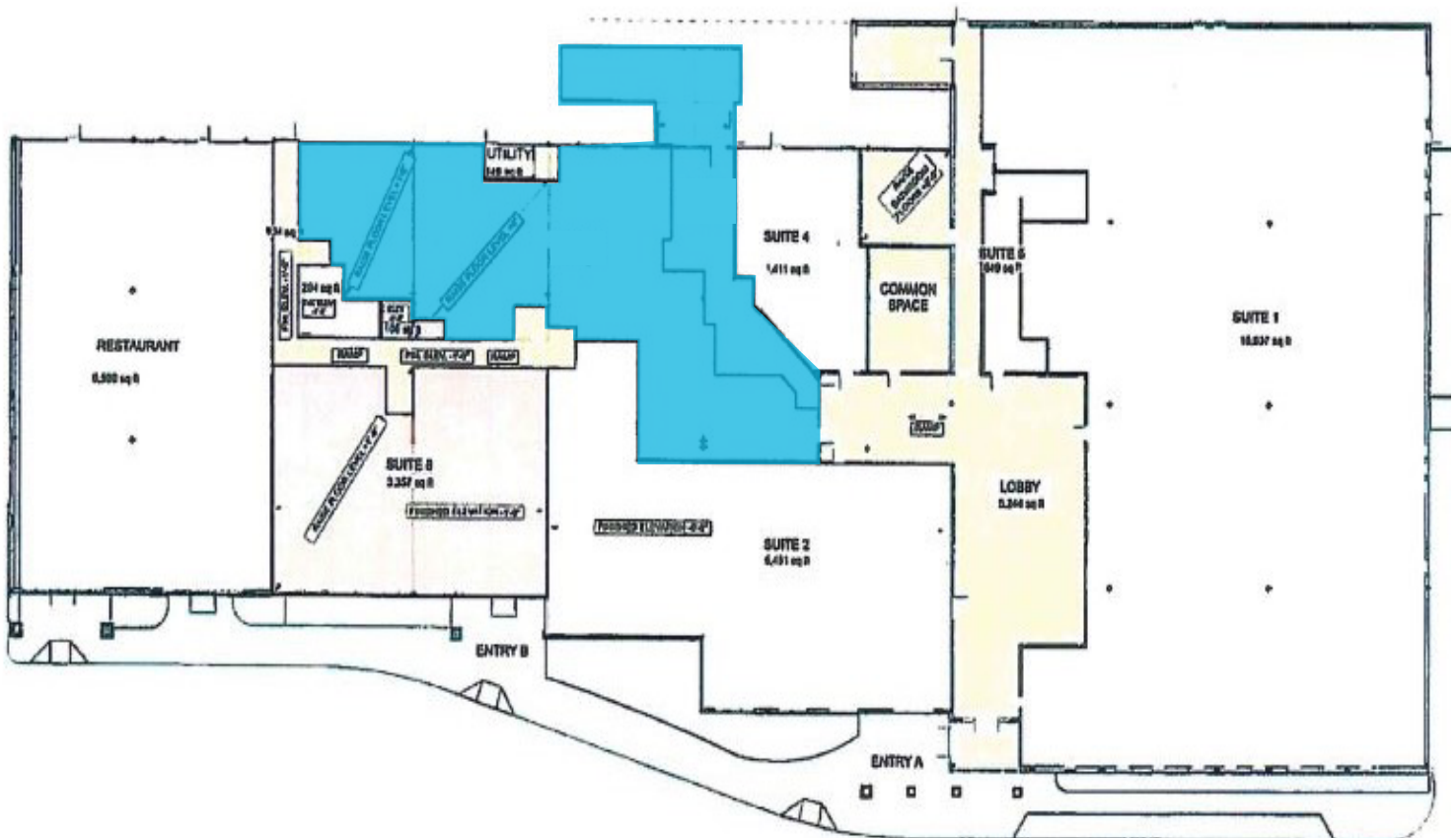



**FOR SUBLEASE** | 105 TOPSHAM FAIR MALL ROAD  
TOPSHAM, ME 04086





**FOR SUBLEASE** | 105 TOPSHAM FAIR MALL ROAD  
TOPSHAM, ME 04086



## CONTACT US



**DEREK MILLER**  
Partner, Broker  
+1 207.553.1721 D  
+1 207.240.0032 C  
[dmiller@boulos.com](mailto:dmiller@boulos.com)



**EMMETT FRUEH**  
Associate  
+1 207.553.1739 D  
+1 207.749.3127 C  
[efrueh@boulos.com](mailto:efrueh@boulos.com)

©2025 The Boulos Company, Inc. All rights reserved. This information has been obtained from sources believed reliable but has not been verified for accuracy or completeness. You should conduct a careful, independent investigation of the property and verify all information. Any reliance on this information is solely at your own risk. The Boulos Company and The Boulos Company logo are service marks of The Boulos Company, Inc. All other marks displayed on this document are the property of their respective owners. Photos herein are the property of their respective owners. Use of these images without the express written consent of the owner is prohibited.