

1023-

1119

E. Wendover

Greensboro, NC

Office Space Ideally Located  
on E. Wendover Ave.



217 - 4,000  
Square Feet

## BUILDING FEATURES

- Conveniently located in close proximity to US Highway 29 at E. Wendover Ave.
- Located in the historic ORD district, just minutes from I-85 and I-40.
- High visibility buildings directly on E. Wendover Ave.
- Offering full service leases and flexible terms on a variety of small to medium size options.
- Ideal for small businesses and seasoned professionals seeking efficient and effective use of their office space.



Chris O'Leary  
336.382.1208  
coleary@kourycorp.com

Travis Carter, CCIM  
336.255.4693  
tcarter@kourycorp.com

336.299.9200  
KouryCorp.com

**KOURY**  
CORPORATION  
BUILDER & DEVELOPER

**1023-1119**  
E. Wendover  
Greensboro, NC

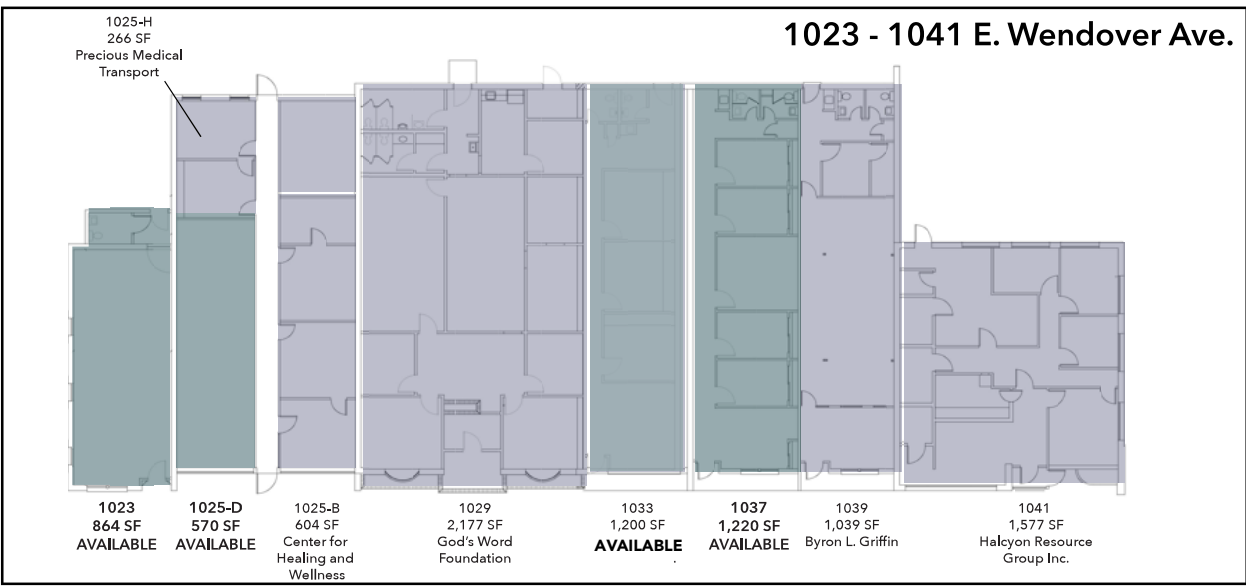
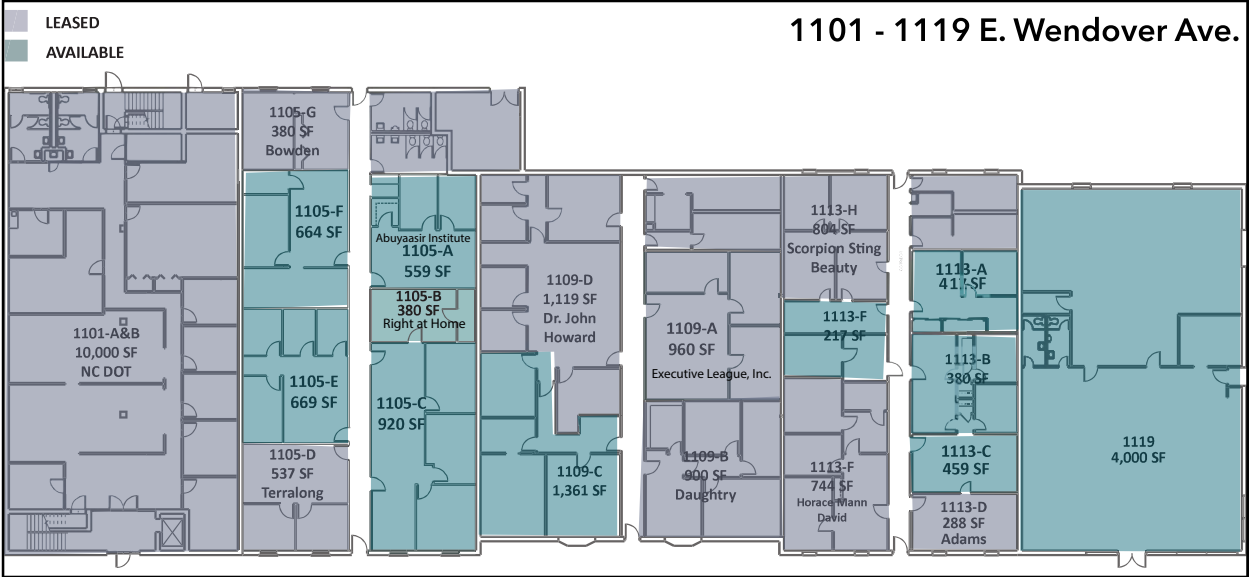

336.299.9200  
KouryCorp.com



Chris O'Leary • 336.382.1208 • [coleary@kourycorp.com](mailto:coleary@kourycorp.com)  
Travis Carter, CCIM • 336.255.4693 • [tcarter@kourycorp.com](mailto:tcarter@kourycorp.com)