



FOR LEASE

±1,326 SF

CG Zoning

8085 Blue Diamond Rd
Las Vegas, NV 89178

Property Summary

LEASE RATE	\$3.00/SF/Mo/NNN
CAMS	\$0.70
MONTHLY RENT	Suite 103 \$4,906.20/Mo
TOTAL AVAILABLE	Suite 103 ±1,326 SF
YEAR BUILT	2018
ZONING	CG

- Suite 103 is a grey shell delivery with T.I. allowance available. Building is located in an Albertson's Grocery anchored center.
- Join many national food and retail tenants.
- Located on high traffic Blue Diamond Rd.
- Shared grease trap available.
- Great generating factors.
- High density residential.
- High density commercial.
- Strong demographics.



OR TEXT 22332 TO 39200

Message frequency will vary. Message and data rates may apply. Reply HELP for help or STOP to cancel.

[ARTL Terms of Service](#) | [ARTL Privacy Statement](#)

Floor Plan - 103



[CLICK HERE](#)
FOR A 3D TOUR

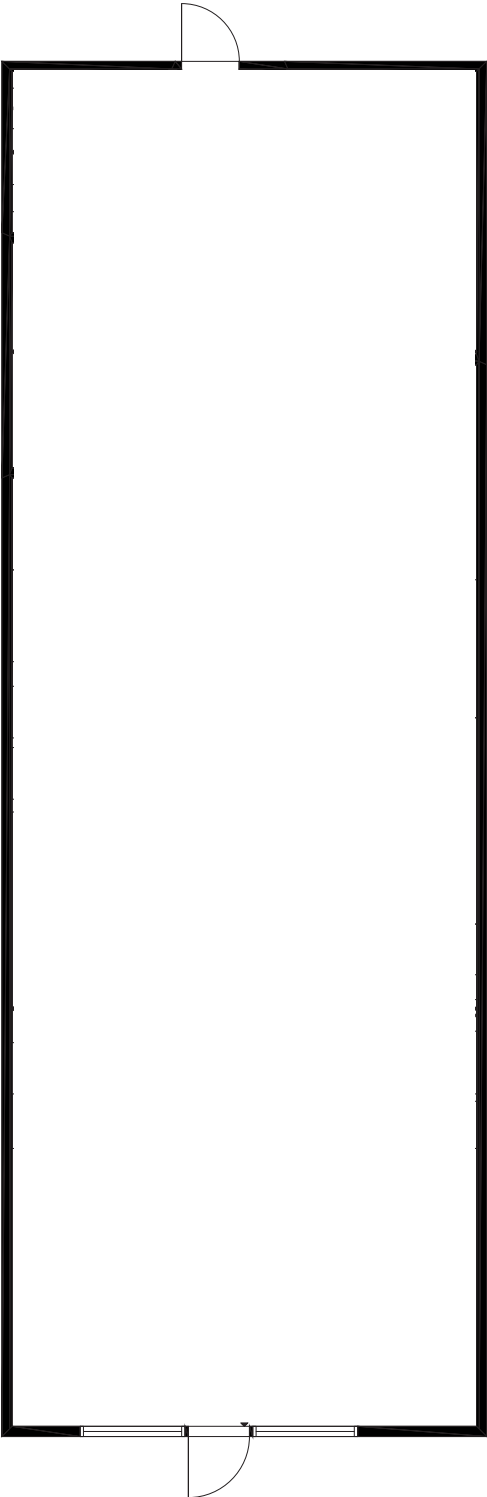

SUITE 103

Total SQFT	±1,326
Lease Rates	\$3.00/SF/Mo
CAMS	\$0.70
Monthly Rent	\$4,906.20



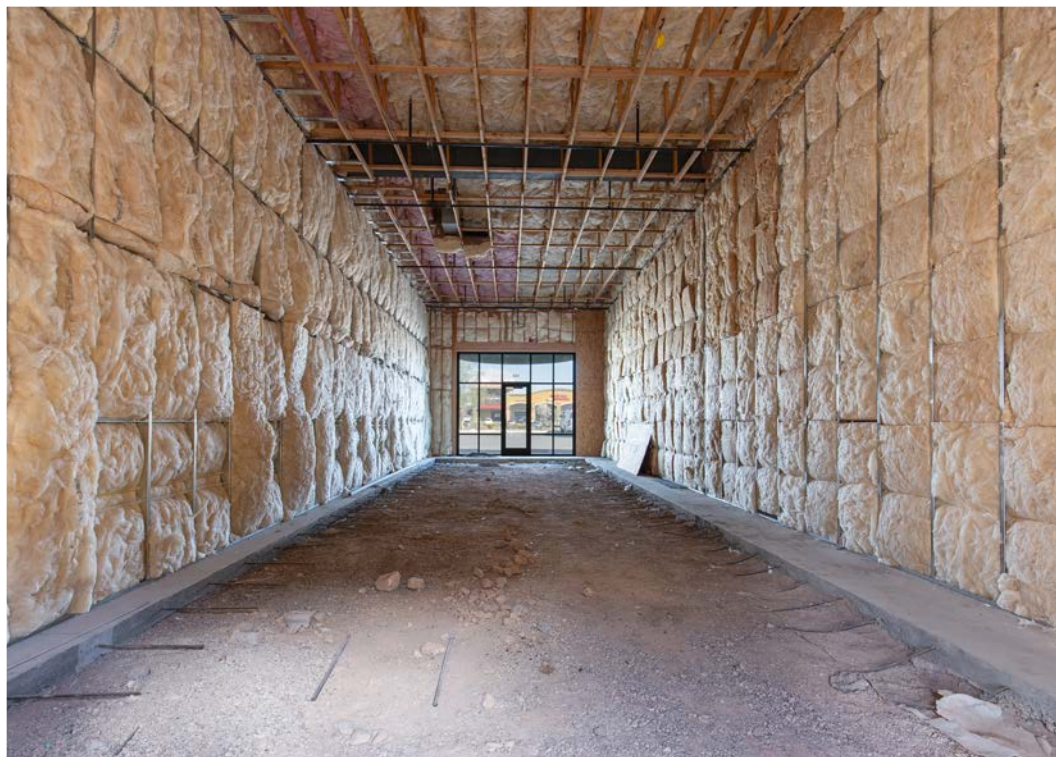

Area Map

- Shops/Tenants
- Schools
- Public Parks
- Govt. Buildings
- Airport

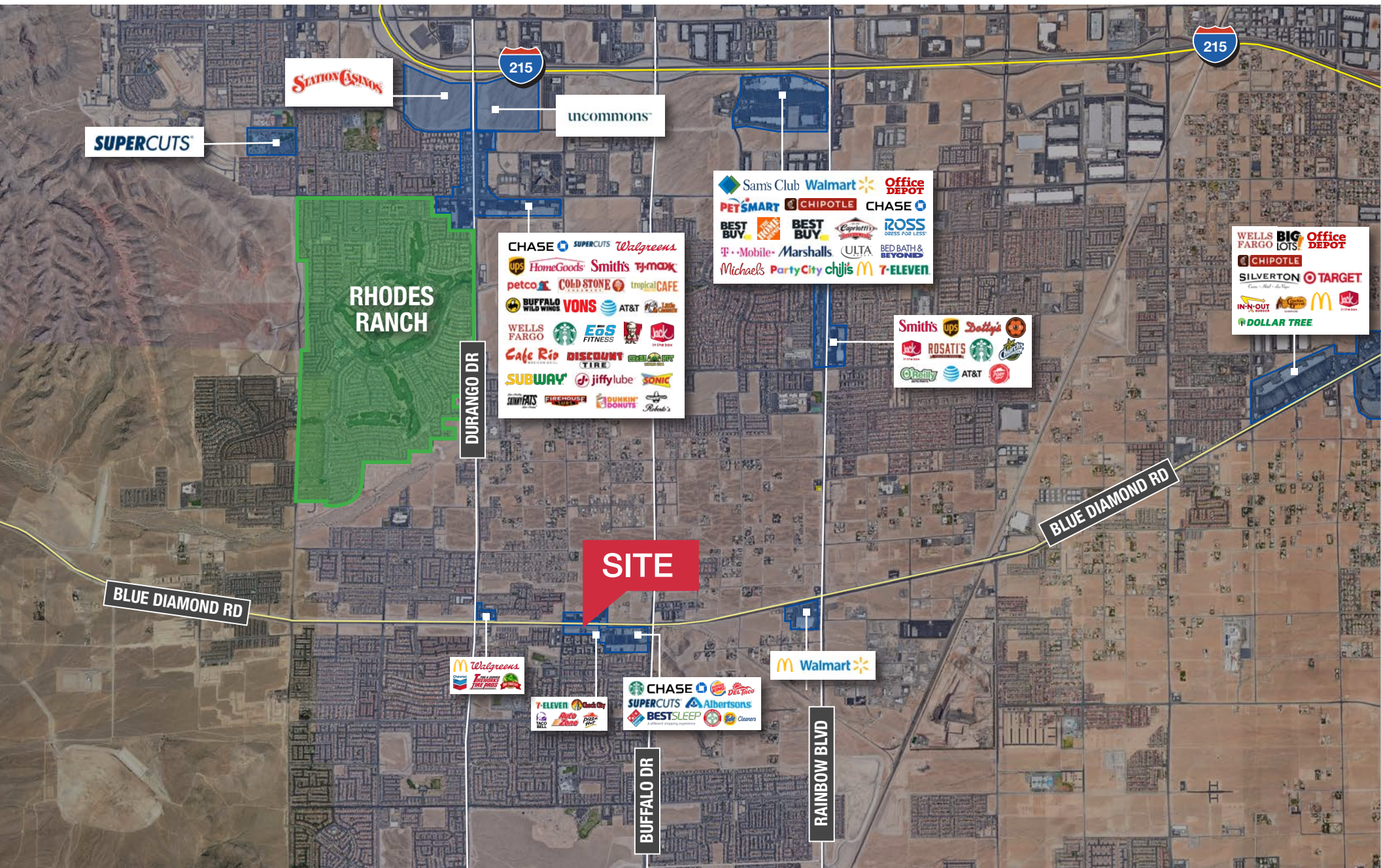

Demographics

POPULATION	1-mile	3-mile	5-mile
2023 Population	19,798	141,573	296,427
HOUSEHOLDS	1-mile	3-mile	5-mile
2023 Households	6,597	49,357	110,374
INCOME	1-mile	3-mile	5-mile
2023 Average HH Income	\$128,119	\$119,646	\$113,483

Traffic Counts

STREET	CPD
S Rainbow Blvd / W Shelbourne Ave	30,500
Blue Diamond Rd / Montessori St	47,000

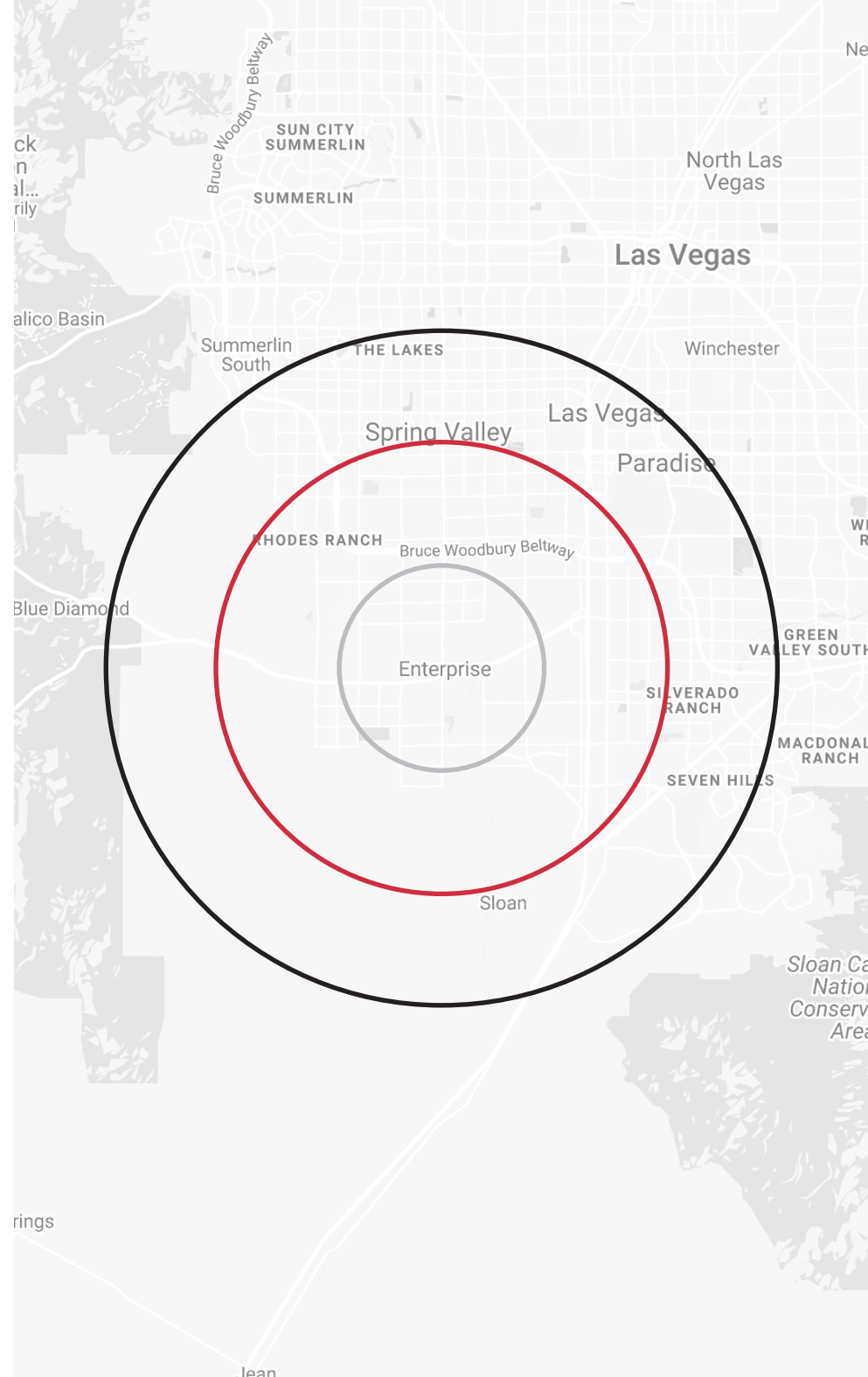



Distance to Major Cities

Salt Lake City, Utah	302 miles
Las Vegas, Nevada	120 miles
Los Angeles, California	387 miles
San Diego, California	449 miles
Denver, Colorado	630 miles
Phoenix, Arizona	419 miles

Market Research

Our offices publish commercial and residential market research across Utah and Nevada. NAI Excel is known for their deep and rich data. Lending institutions, appraisers, and business consultants look to our market reports as the authority on commercial real estate market trends. We have built and maintained a comprehensive database comprised of data collected from some of the largest appraisal firms in the region, NAI transaction, and other data. NAI publishes statistics for the office, retail, industrial, and multifamily markets. Additionally, single family housing reports are published for every major market from Las Vegas to Salt Lake City, through our affiliate.

[ARTI Terms of Service](#) | [ARTI Privacy Statement](#)
<https://brokerstechnology.com/terms-of-use/>
<https://brokerstechnology.com/privacy-policy/>

CLICK HERE



**VIEW MARKET STATISTICS
FOR OFFICE, RETAIL,
INDUSTRIAL & MULTIFAMILY**

<https://excelcres.com/market-research>

NAI Excel

COMMERCIAL REAL ESTATE SERVICES, WORLDWIDE

6064 South Durango Drive,
Las Vegas, NV 89113

702.383.3383 | naiexcel.com

Maria Herman

LIC#BS.0027640

702.334.7280

mherman@naiexcel.com

This offering, including any related digital marketing, contains selected information pertaining to the Property and does not purport to be a representation of the state of the Property, to be all-inclusive, or to contain all or part of the information which interested parties may require to evaluate a purchase or lease of real property.

Neither the seller or NAI Excel, nor any of their respective directors, officers, Affiliates or representatives make any representation or warranty, expressed or implied, as to the accuracy or completeness of this Offering Memorandum or any of its contents, as to the financial performance of the property, or as to the condition of the Property, malfunctions or mechanical defects on the Property or to any improvements thereon, including but not limited to the material, workmanship or mechanical components of the structures, foundations, roof, heating, plumbing, electrical or sewage system, drainage or moisture conditions, air conditioning, or damage by the presence of pests, mold or other organisms, environmental condition, soils conditions, the zoning of the Property, the suitability of the Property for interested parties intended use or purpose, or for any other use or purpose.