

226

EAST FORDHAM RD
FORDHAM | THE BRONX



MOST EXCLUSIVE CORNER OF FORDHAM ROAD



226

EAST FORDHAM ROAD

CORNER OF E FORDHAM RD & VALENTINE AVE
FORDHAM | THE BRONX

SIZE: 9,000 SF Ground Floor
3,200 SF Lower Level

FRONTAGE: 43'

CEILING HEIGHT: 12'

POSSESSION: January 1, 2025

ASKING RENT: Upon Request

TRANSPORTATION: 

HIGHLIGHTS:

- Centrally located in the heart of the East Fordham Road Shopping District
- 3,200 SF storage on the lower level
- Prominent corner location at Valentine Avenue
- High foot traffic area with excellent visibility
- Neighboring tenants include: *Applebee's, Target, Marshalls, JD Sport, Five Below, GAP, Chick-fil-A, Burlington, The Children's Place, Wingstop, Bank of America, Planet Fitness, Snipes, & Many More!*



All information supplied in this marketing presentation and/or flyer is from sources deemed reliable and is furnished subject to errors, omissions, modifications, removal of listings from sale/lease and to any listing condition. Any square footage, dimensions, floor plans and/or technical data set forth are approximations and are subject to further elaboration/confirmation.



226

EAST FORDHAM ROAD

FLOOR PLANS:
GROUND FLOOR - 9,000 SF

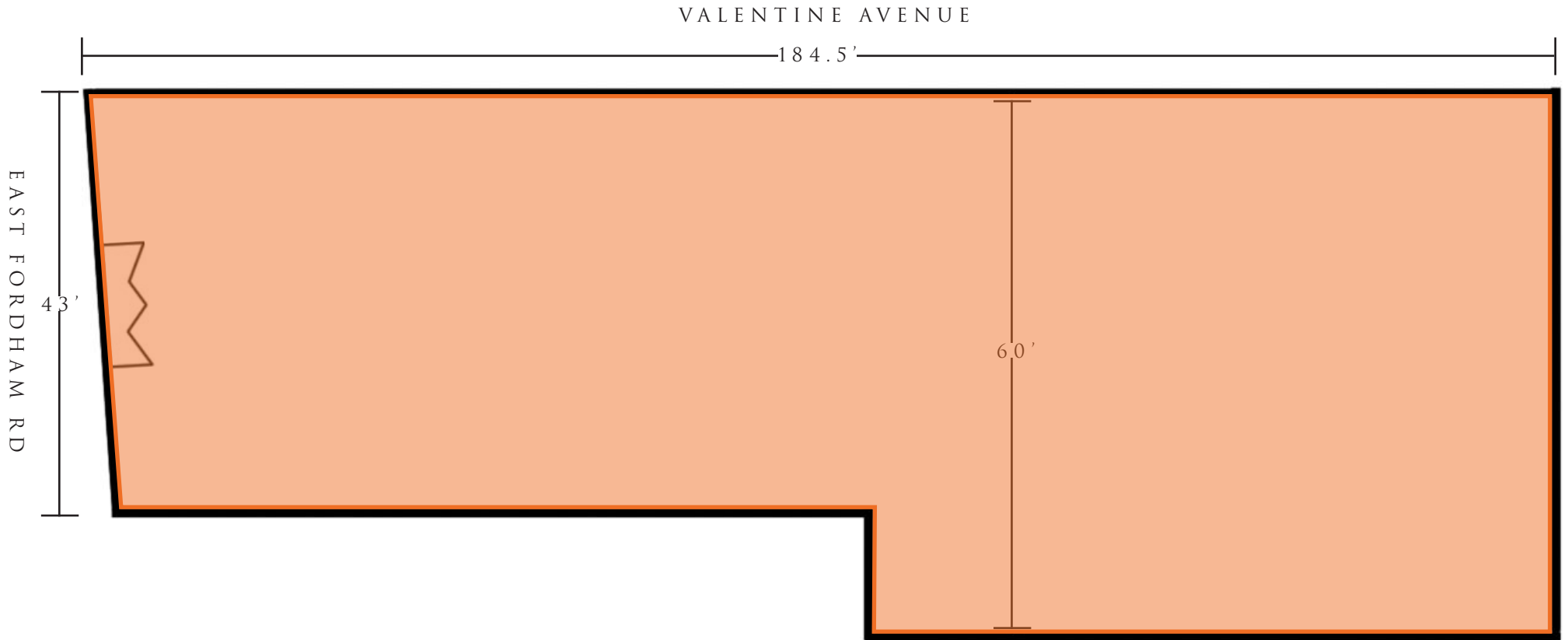

226

EAST FORDHAM ROAD

FLOOR PLANS: DIVISION OPTION 1

SPACE A - 4,350 SF (INLINE)

SPACE B - 4,650 SF (CORNER)

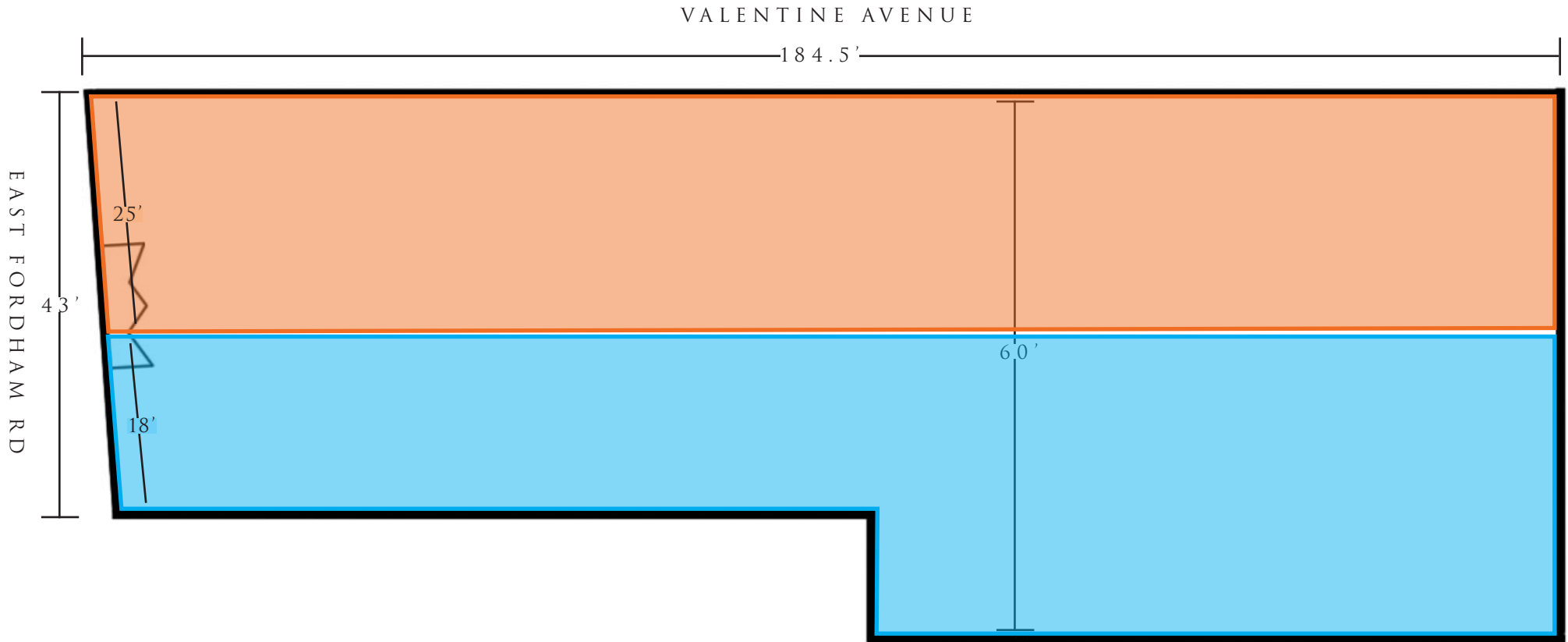

226

EAST FORDHAM ROAD

FLOOR PLANS: DIVISION OPTION 2

SPACE A - 5,400 SF

SPACE B - 3,600 SF

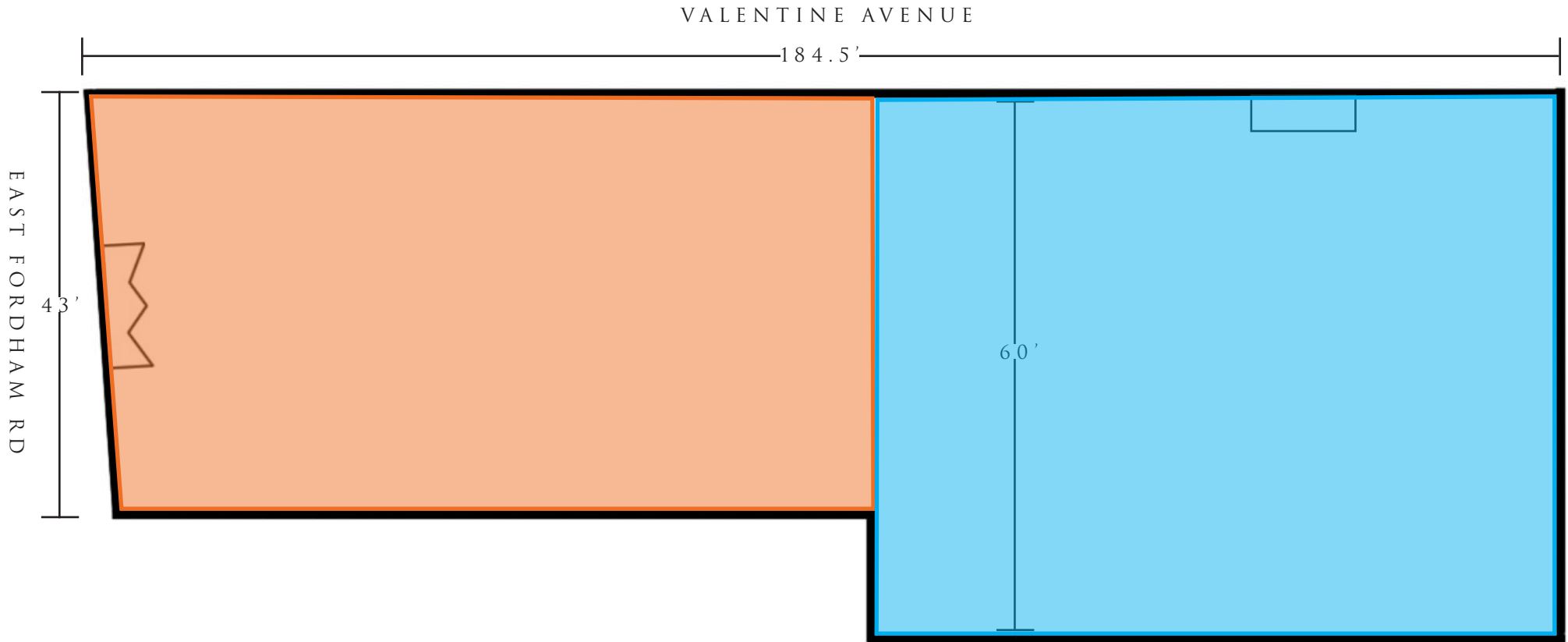

226

EAST FORDHAM ROAD

CORNER OF E FORDHAM RD & VALENTINE AVE
FORDHAM | THE BRONX

FOR MORE INFORMATION,
PLEASE CONTACT:

EZRA FALACK

917.518.3568 | EFalack@ksrny.com

SOLOMON SHARABY

718.986.7149 | SSharaby@ksrny.com

ALBERT MANOPLA

212.380.8369 | AManopla@ksrny.com

