



SWC Harbor Blvd & 19th St • Costa Mesa, CA

172,612 SF Lifestyle Center

- | | |
|----------------------------|-----------------------|
| BevMo! | Rubio's Coastal Grill |
| Grocery Outlet | Buffalo Wild Wings |
| CVS | FedEx Office |
| Code Ninjas | Phenix Salon Suites |
| The Coffee Bean & Tea Leaf | Road Runner Sports |
| Western Dental | Club Studio |
| Vans | |



POPULATION	AVG HH INCOME	DAYTIME POPULATION
1-mile 39,727	1-mile \$152,372	1-mile 23,804
3-mile 160,578	3-mile \$194,823	3-mile 120,553
5-mile 348,080	5-mile \$183,014	5-mile 422,061

Source: SITES USA, 2023

AVAILABLE SPACE

1,439 SF QSR Space (Jamba Juice) • 200 amps • 5-ton HVAC • No hood

TRAFFIC COUNTS

- Harbor Blvd** 37,180 cars per day
- 19th Street** 34,631 cars per day
- Newport Blvd** 93,442 cars per day

Source: SITES USA, 2022



For More Information,
Please Contact:

Wally Limburg CalBRE Lic: 00468578
949.500.1396 | wally.limburg@SRA-re.com





SECOND FLOOR

PARK AVENUE



NOT A PART

W 19th STREET

SECOND FLOOR

HARBOR BOULEVARD



Total Site Area
21 Acres
Building Area
170,000 Square Feet



Costa Mesa, California

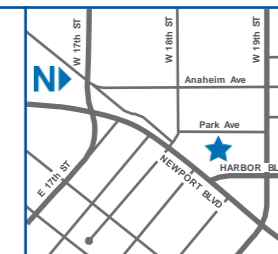

★ 1835 Newport Blvd.



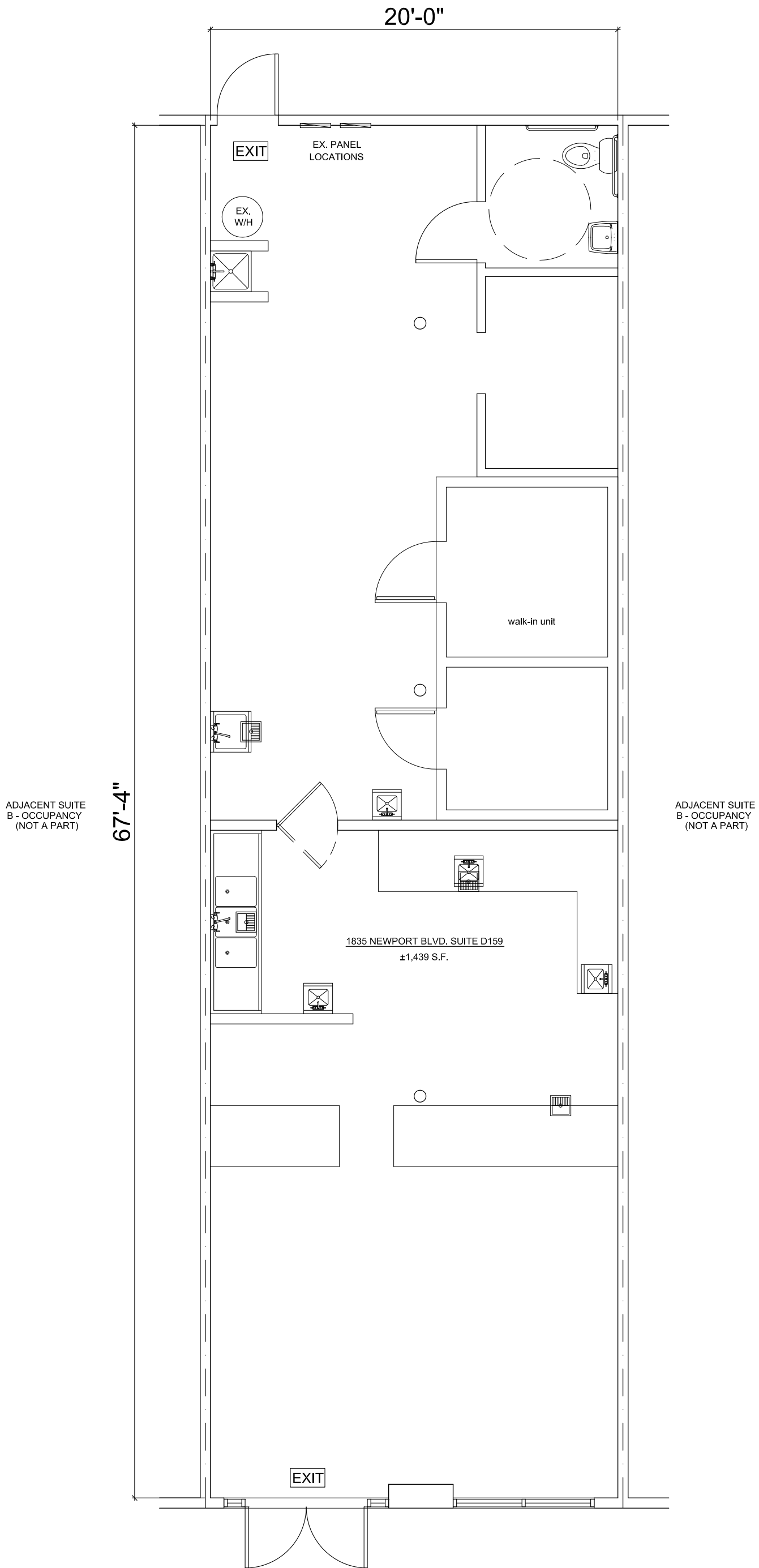

1 EXISTING AS-BUILT FLOOR PLAN
 COSTA MESA COURTYARDS
 1835 NEWPORT BLVD., SUITE D159
 COSTA MESA, CA 92627

SCALE: 3/16"=1'-0"



KEVIN R. BARNES
 ARCHITECT

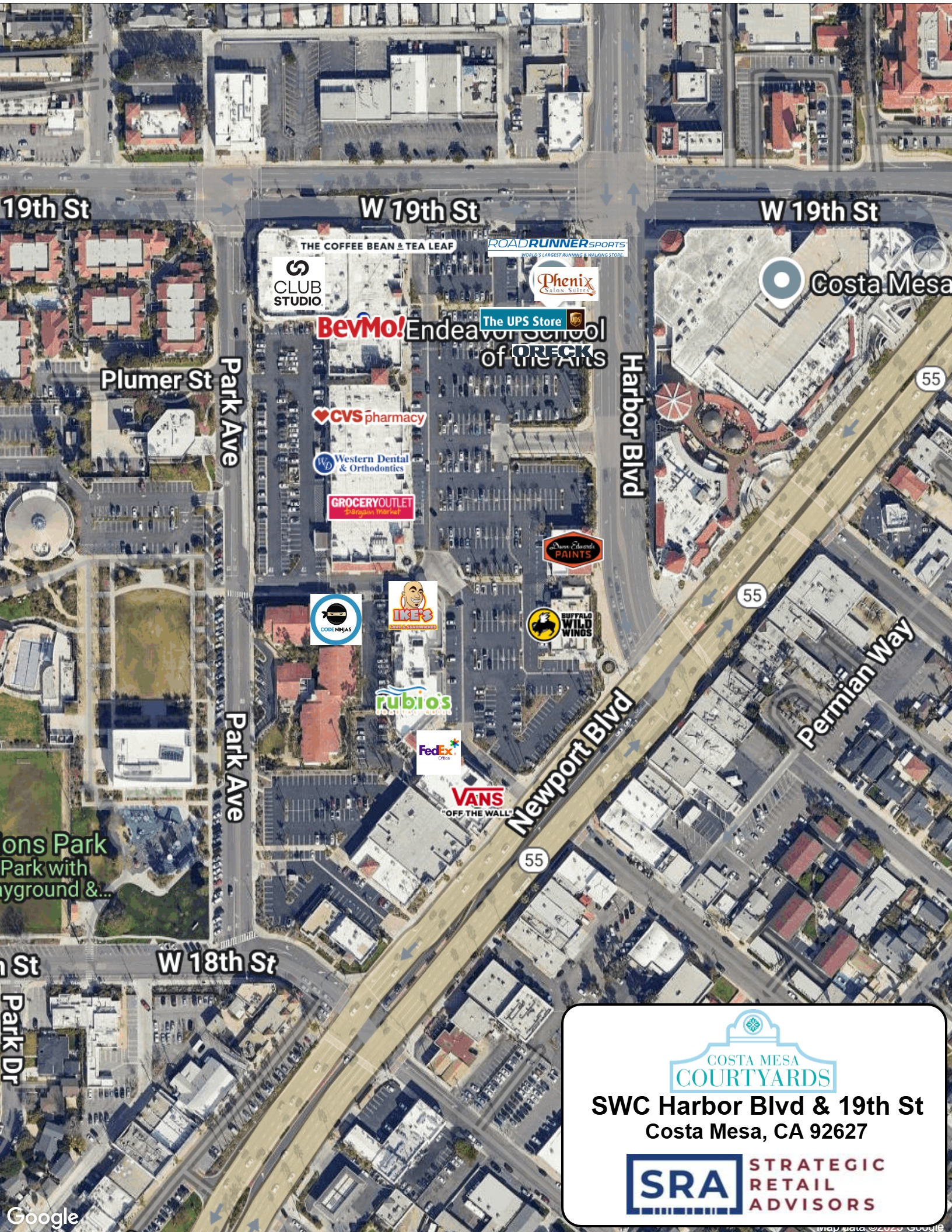

19th St

W 19th St

W 19th St

Costa Mesa

Plumer St

Park Ave

Harbor Blvd

55

55

Newport Blvd

Permian Way

ons Park
Park with
yground &...

W 18th St

n St

Park Dr



SWC Harbor Blvd & 19th St
Costa Mesa, CA 92627



STRATEGIC
RETAIL
ADVISORS



**COSTA MESA COURTYARDS
PRIMARY TRADE AREA**

Total Population - 160,754

Costa Mesa Population - 94,569
(represents 84% of total city population)

Newport Beach Population - 63,348
(represents 73% of total city population)



This map was produced using data from private and government sources deemed to be reliable. The information herein is provided without representation or warranty.