

315 W Alabama St #200, Houston, TX 77006-5177, Harris County



N/A	6,700	12,576	N/A
Beds	Bldg Sq Ft	Lot Sq Ft	Sale Price
N/A	1950	MISC BLDG	N/A
Baths	Yr Built	Type	Sale Date

Owner Information

Owner Name:	Harris Dwayne	Tax Billing Address:	315 W Alabama St #200
Owner Name 2:	Harris Paula D	Tax Billing City & State:	Houston, TX
Owner Occupied:	Yes	Tax Billing Zip:	77006
Carrier Route:	C019	Tax Billing Zip+4:	5177

Location Information

Subdivision:	Bute	Key Map:	493t
School District Name:	Houston ISD	Topography:	Flat/Level
Neighborhood Code:	Montrose-5904.02	Census Tract:	4107.02
Township:	Houston	Map Facet:	493-T
MLS Area:	16	Traffic:	Paved
Market Area:	MONTROSE		

Tax Information

Parcel ID:	008-260-000-0013	% Improved:	12%
Parcel ID:	0082600000013	Tax Area:	040
Lot #:	2	Water Tax Dist:	041
Block #:	10		
Legal Description:	TRS 1A 3A 3B 4B 6 & LT 2 BLK 10 BUTE		

Assessment & Tax

Assessment Year	2017	2016	2015
Assessed Value - Total	\$1,212,955	\$1,115,844	\$1,085,440
Assessed Value - Land	\$1,068,960	\$1,068,960	\$817,440
Assessed Value - Improved	\$143,995	\$46,884	\$268,000
YOY Assessed Change (\$)	\$97,111	\$30,404	
YOY Assessed Change (%)	8.7%	2.8%	
Market Value - Total	\$1,212,955	\$1,115,844	\$1,085,440
Market Value - Land	\$1,068,960	\$1,068,960	\$817,440
Market Value - Improved	\$143,995	\$46,884	\$268,000

Tax Year	Total Tax	Change (\$)	Change (%)
2015	\$28,874		
2016	\$29,610	\$735	2.55%
2017	\$30,643	\$1,034	3.49%

Jurisdiction	Tax Rate	Tax Amount
Houston ISD	1.2067	\$14,636.73
Harris County	.41801	\$5,070.27
Hc Flood Control Dist	.02831	\$343.39
Port Of Houston Authority	.01256	\$152.35
Hc Hospital Dist	.1711	\$2,075.37
Hc Department Of Education	.0052	\$63.01
Houston Community College	.10026	\$1,216.15
Houston City Of	.58421	\$7,086.20

Courtesy of Antonio Cogliandro, RE/MAX Cinco Ranch, Houston Association of REALTORS

The data within this report is compiled by CoreLogic from public and private sources. If desired, the accuracy of the data contained herein can be independently verified by the recipient of this report with the applicable county or municipality.

Property Detail

Generated on 03/04/2018

Page 1 of 3

Total Estimated Tax Rate 2.5264

Characteristics

Land Use - CoreLogic:	Misc Building	Condition:	Average
Land Use - County:	8001	Quality:	Average
Land Use - State:	Commercial	Total Units:	10
Lot Acres:	0.2887	Elec Svs Type:	Y
Lot Sq Ft:	12,576	Cooling Type:	Central
# of Buildings:	1	Heat Type:	Hot Air
Building Type:	Building	Parking Type:	Off Street
Bldg Class:	C	Garage Type:	Parking Avail
Building Sq Ft:	6,700	Construction:	Wood
Gross Sq Ft:	6,700	Exterior:	Brick
Ground Floor Sq Ft:	3,534	Year Built:	1950
2nd Floor Sq Ft:	3,166	Building Remodel Year:	2009
Stories:	1	Effective Year Built:	1984

Features

Feature Type	Unit	Size/Qty	Year Built
Base Area Pri	S	184	
Base Area Pri	S	1,327	
Base Area Pri	S	1,655	
Base Area Pri	S	368	
Base Area Upr	S	184	
Base Area Upr	S	1,655	
Base Area Upr	S	1,327	
Paving - Asphalt	S	2,500	1950

Building Description	Building Size
Interior Finish Percent	100
Wall Height	24

Last Market Sale & Sales History

Recording Date	10/11/2005	
Buyer Name	Harris Dwayne & Paula D	Ashley Jimmy D
Buyer Name 2	Harris Paula D	
Seller Name	Ashley Jimmy D	
Document Number	Y820591	
Document Type	Warranty Deed	Deed (Reg)

Mortgage History

Mortgage Date	09/02/2015	10/11/2005	07/21/2003
Mortgage Amount	\$400,000	\$470,400	\$236,000
Mortgage Lender	Wells Fargo Bk Na	Lehman Brothers Bk Fsb	Southwest Bk/Tx
Mortgage Code	Conventional	Conventional	Conventional
Borrower Name	Harris Dwayne	Harris Dwayne	Daily Properties Ltd
Borrower Name 2	Harris Paula D	Harris Paula D	

Property Map

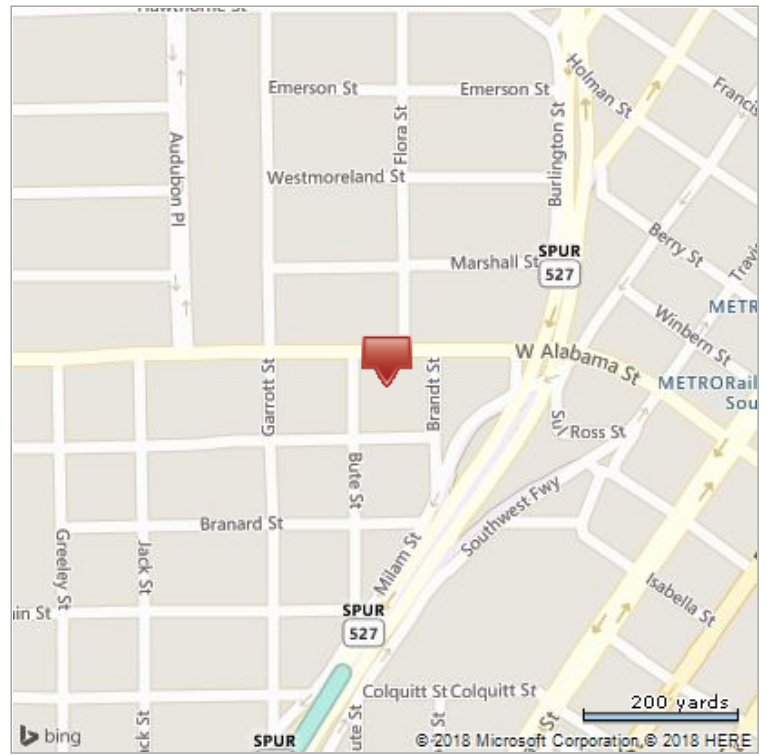
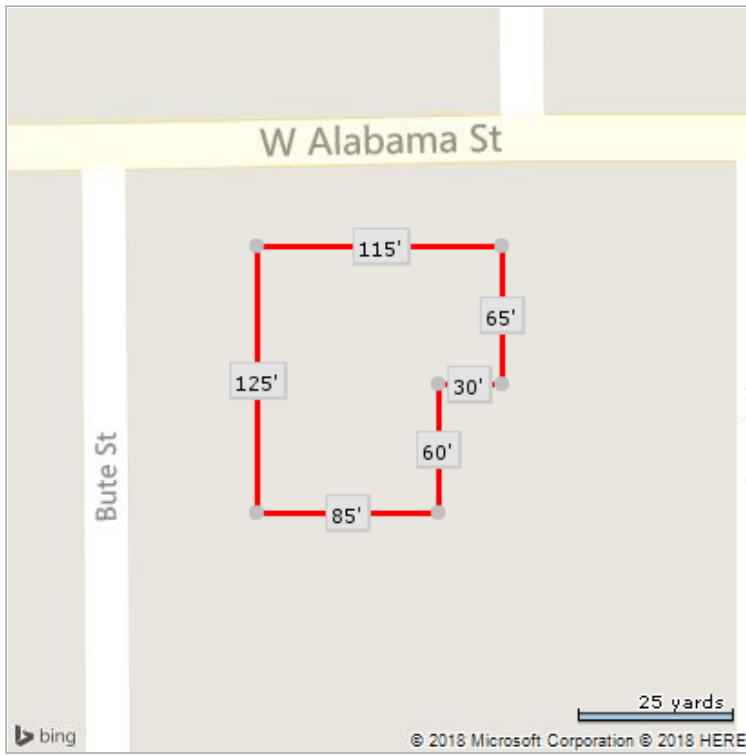

*Lot Dimensions are Estimated