



16404

CORPORATE PARKWAY NORTH

16404 N BLACK CANYON HWY | PHOENIX, AZ

CBRE

SECOND CITY 
REAL ESTATE



PROPERTY FEATURES



New outdoor break area with a ping pong table, corn-hole, and collaboration spaces



Brand new fully equipped fitness center



10-person conference room available to tenants



Two-story atrium lobby provides multiple collaboration spaces



Corporate neighbors include Paychex Regional Facility and Teletech/Revana



Redone Parking Lot: 6.5/1,000



Freight elevator + loading dock



On-site Cafe North open from 7am – 4pm



Wi-Fi connected throughout building

CORPORATE PARKWAY NORTH

SITE PLAN

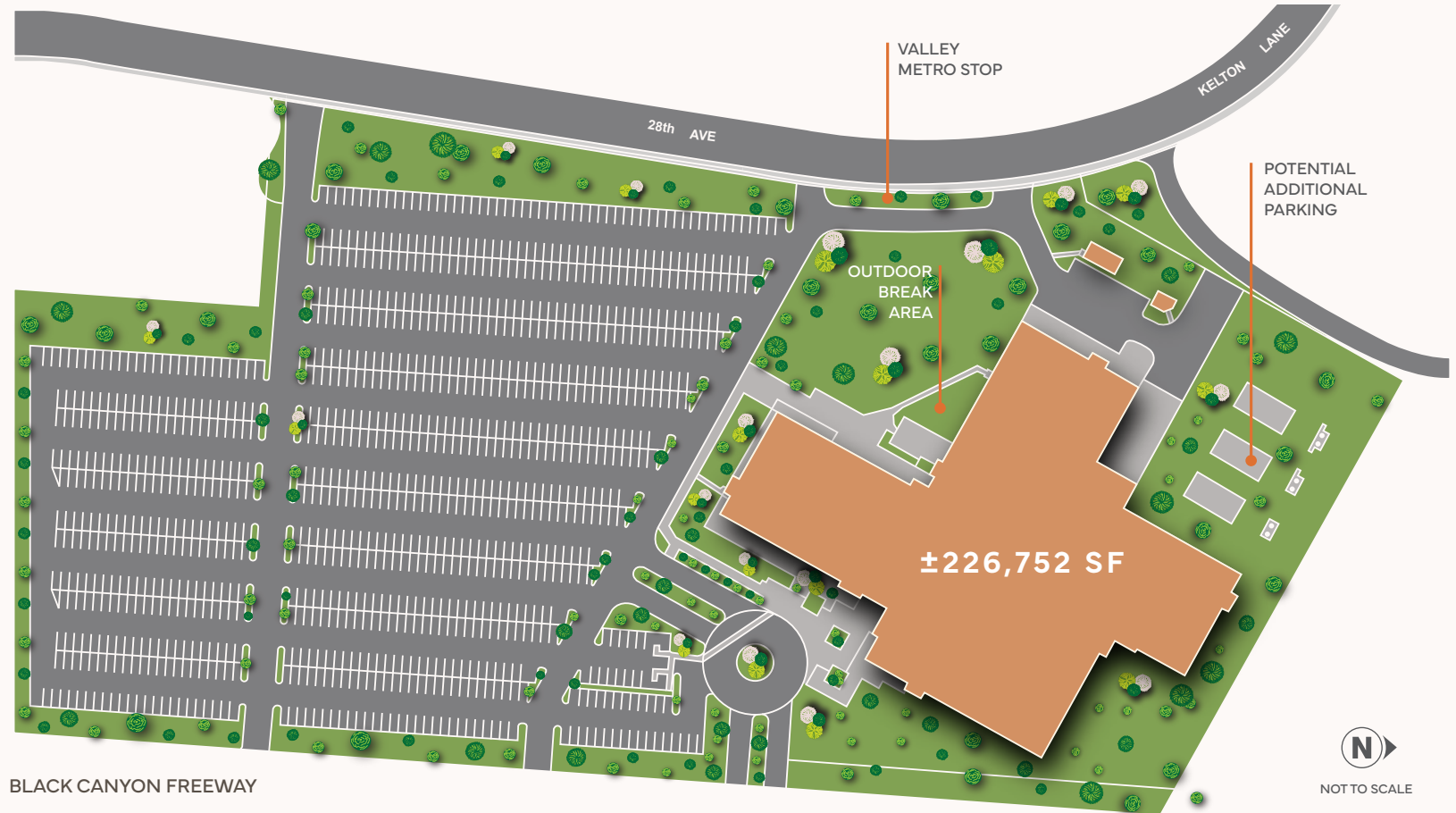

FIRST FLOOR

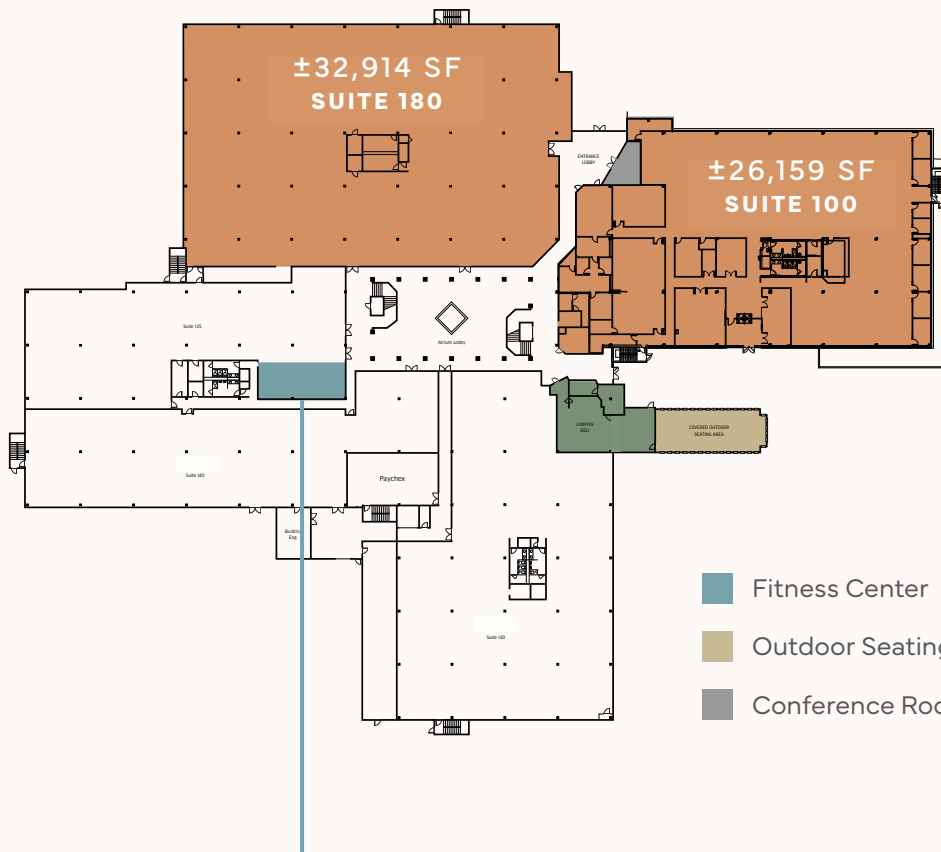

SECOND FLOOR

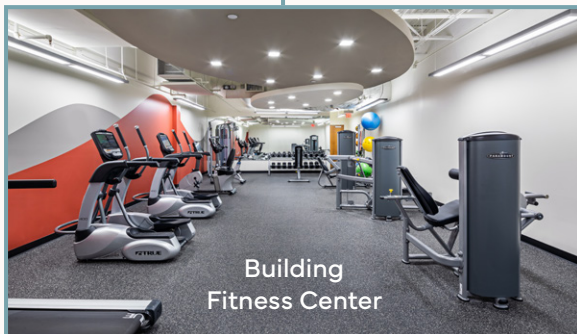
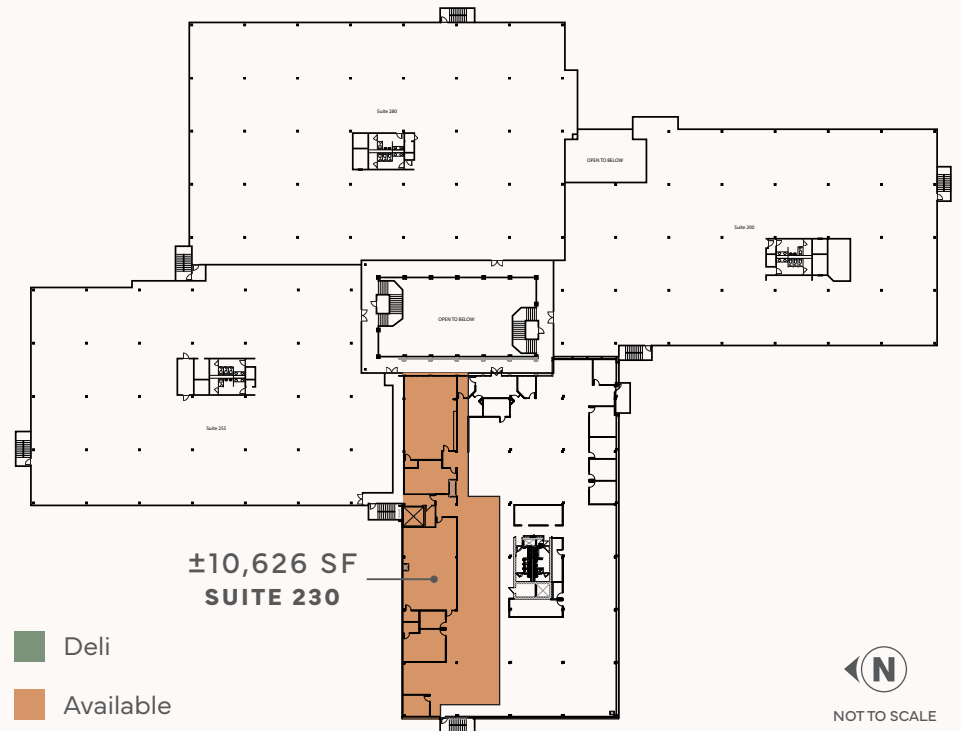

SUITE	SIZE	AVAILABILITY
100	±26,159 SF	Immediate Availability
180	±32,914 SF	Immediate Availability
230	±10,626 SF	Immediate Availability



CONTACT

JAMES BAYLESS

Senior Vice President

+1 602 735 1794

james.bayless@cbre.com

ASHLEY BROOKS

Senior Vice President

+1 602 735 1758

ashley.brooks@cbre.com

© 2023 CBRE, Inc. All rights reserved. This information has been obtained from reliable sources but has not been verified for accuracy or completeness. CBRE, Inc. makes no guarantee, representation, or warranty and accepts no responsibility or liability for the accuracy, completeness, or reliability of the information contained herein. You should conduct a careful, independent investigation of the property and verify all information. Any reliance on this information is solely at your own risk. CBRE and the CBRE logo are service marks of CBRE, Inc. All other marks displayed on this document are the property of their respective owners, and the use of such marks does not imply any affiliation with or endorsement of CBRE. Photos herein are the property of their respective owners. Use of these images without the express written consent of the owner is prohibited.

CBRE

SECOND CITY
REAL ESTATE