

FOR LEASE

**459 PARK AVENUE
SAN FERNANDO, CA 91340**



CHAD GAHR
O: 818 742 1626
cgahr@naicapital.com
Cal DRE Lic #01230414

DAVID YOUNG
O: 818 742 1651
dyoung@naicapital.com
Cal DRE Lic #00914504

NAI CAPITAL
15821 Ventura Blvd., Suite 320
Encino, CA 91436
naicapital.com | 818 905 2400

NAI Capital
COMMERCIAL REAL ESTATE SERVICES, WORLDWIDE

FOR LEASE

459 PARK AVENUE
SAN FERNANDO, CA 91340

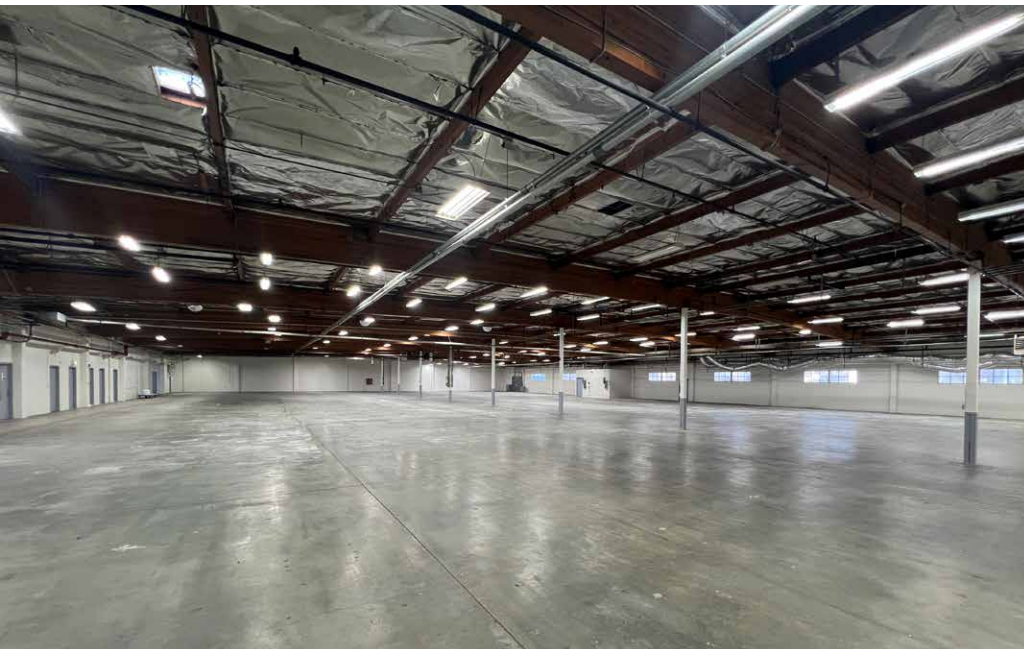

PROPERTY HIGHLIGHTS

- **\$0.99 / SF Gross Lease Rate**
- Fully Renovated Building
- New Roof and New Office Space
- 2 Dock High Loading Positions
- Prime East Valley Location with Immediate Access to 5, 210, 118 & 405 Freeways
- Business Friendly City of San Fernando Location

PROPERTY FEATURES

Available Space	37,502 SF
Lease Rate	\$0.99 / SF Gross for Months 1 thru 6 (\$1.30 / SF Gross Thereafter)
Office Area	6,090 SF
Loading	2 Dock High and 1 Ground Level
Clear Height	12' – 15'
Power	TBD
Parking	57 Striped Stalls / Fenced Parking Lot
Zoning	M1
Fire Sprinklers	Yes
Year Built	1968

FOR LEASE

459 PARK AVENUE
SAN FERNANDO, CA 91340



FOR LEASE

459 PARK AVENUE
SAN FERNANDO, CA 91340

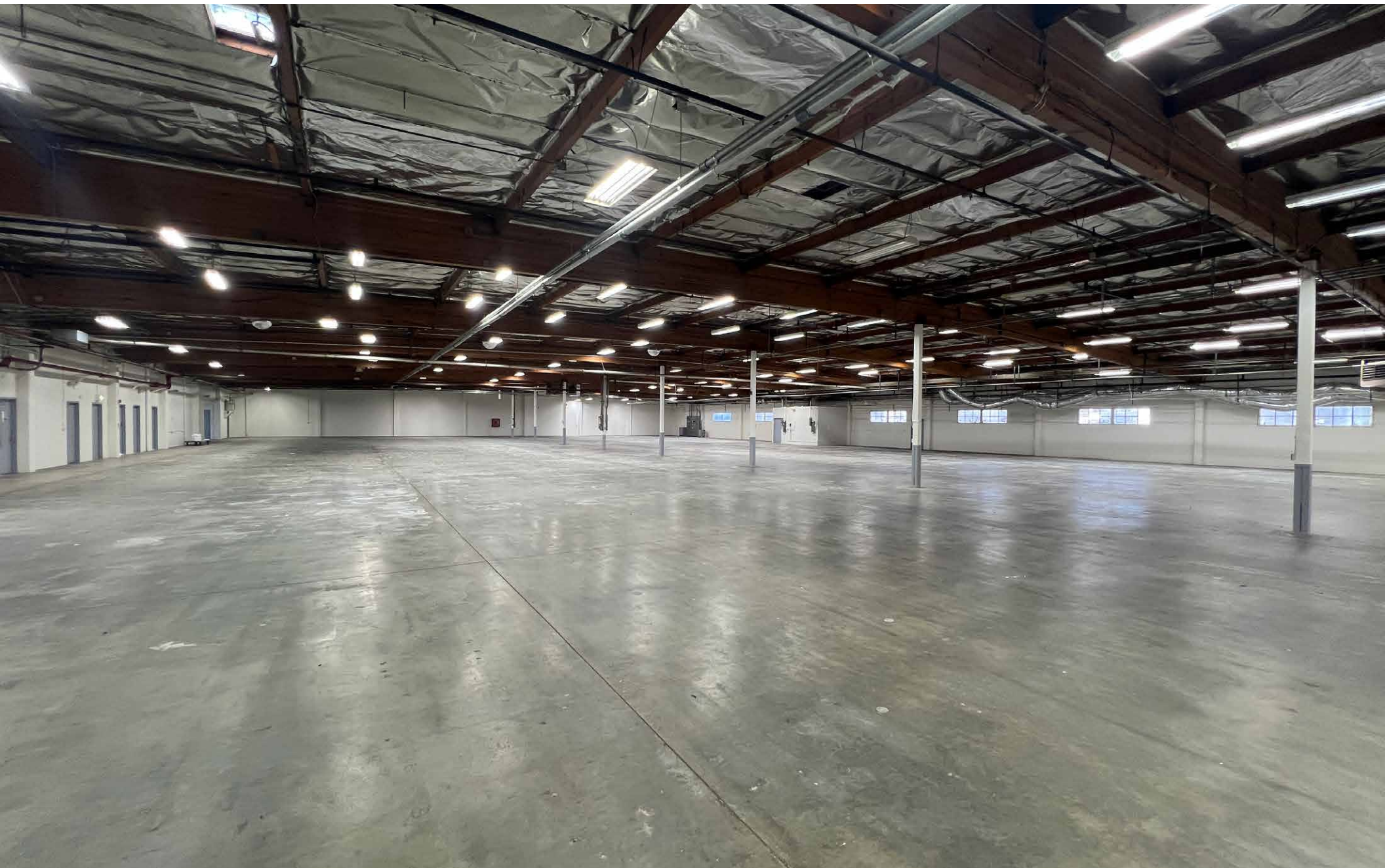

FOR LEASE

459 PARK AVENUE
SAN FERNANDO, CA 91340

SITE PLAN

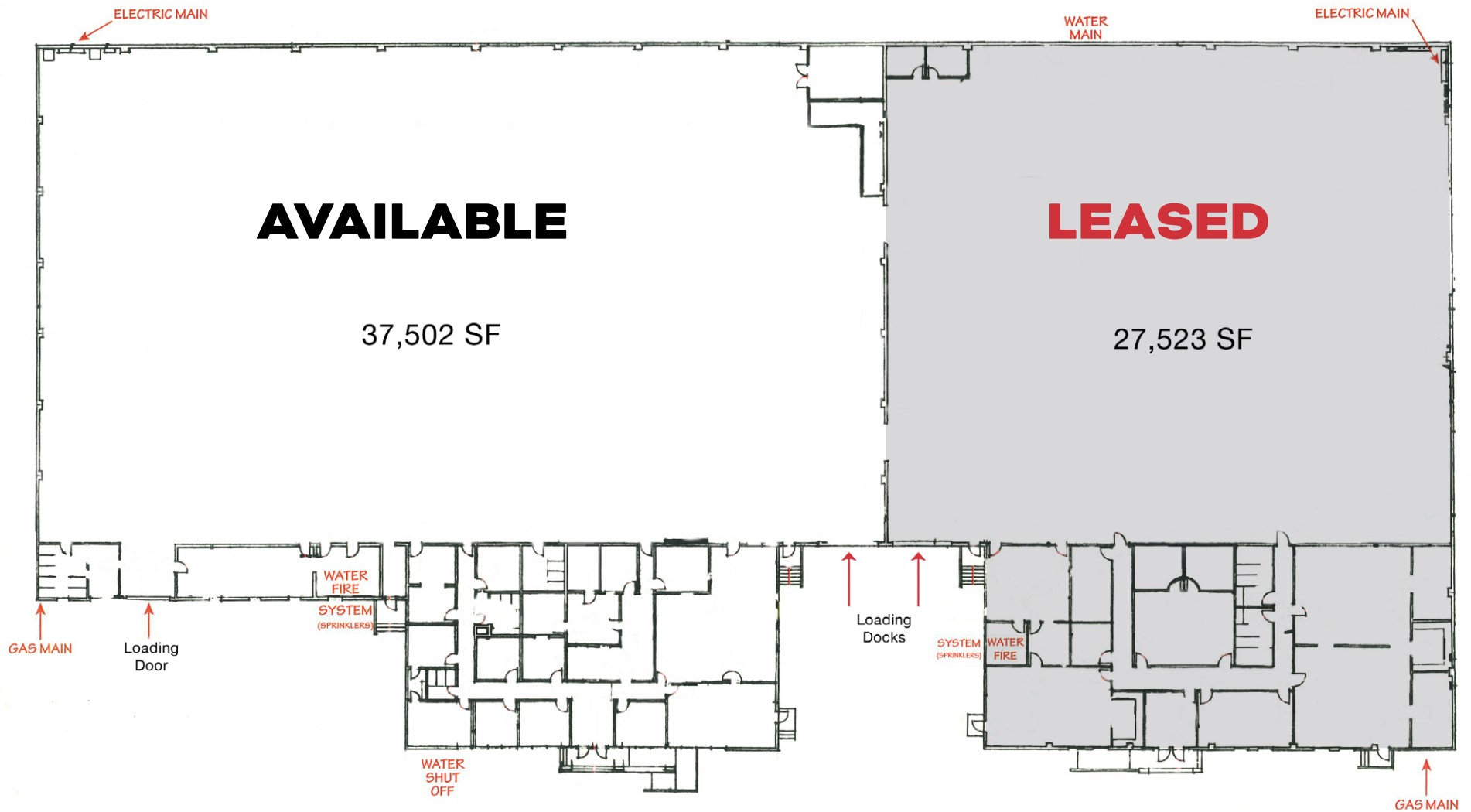

FOR LEASE

459 PARK AVENUE
SAN FERNANDO, CA 91340



Google Earth
Image Landsat / Copernicus

FOR LEASE

459 PARK AVENUE
SAN FERNANDO, CA 91340

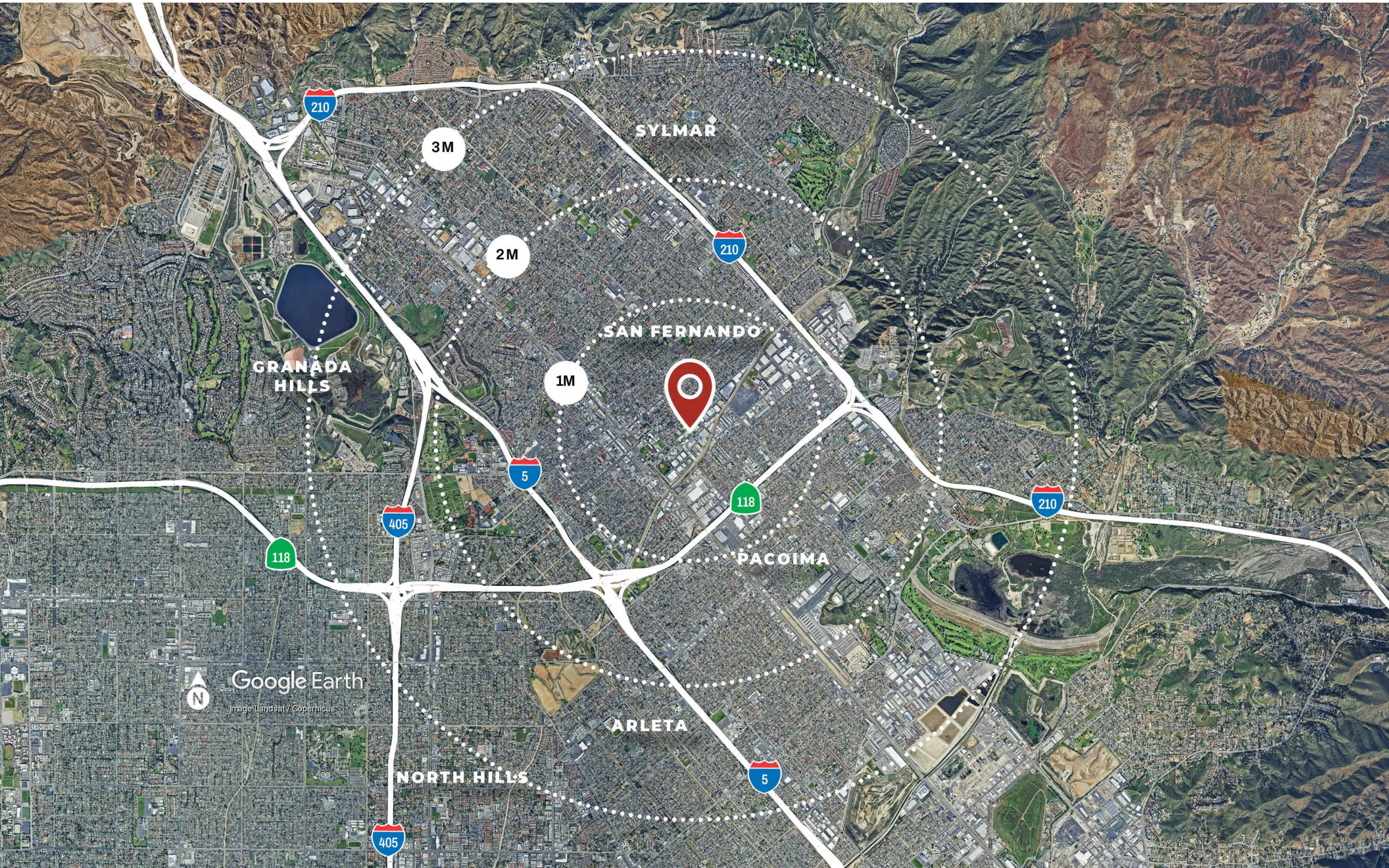

FOR LEASE

**459 PARK AVENUE
SAN FERNANDO, CA 91340**



CHAD GAHR
O: 818 742 1626
cgahr@naicapital.com
Cal DRE Lic #01230414

DAVID YOUNG
O: 818 742 1651
dyoung@naicapital.com
Cal DRE Lic #00914504

NAI CAPITAL
15821 Ventura Blvd., Suite 320
Encino, CA 91436
naicapital.com | 818 905 2400

No warranty, express or implied, is made as to the accuracy of the information contained herein. This information is submitted subject to errors, omissions, change of price, rental or other conditions, withdrawal without notice, and is subject to any special listing conditions imposed by our principals. Cooperating brokers, buyers, tenants and other parties who receive this document should not rely on it, but should use it as a starting point of analysis, and should independently confirm the accuracy of the information contained herein through a due diligence review of the books, records, files and documents that constitute reliable sources of the information described herein. NAI Capital Cal DRE Lic #02130474

NAI Capital
COMMERCIAL REAL ESTATE SERVICES, WORLDWIDE