



**14.5 ACRES**

**LAND FOR SALE**

**NWQ STATE HIGHWAY 360 & SUBLETT RD  
ARLINGTON, TX 76018**





# PROPERTY DETAILS

NWQ STATE HIGHWAY 360 & SUBLETT RD  
ARLINGTON, TX 76018



**SALES PRICE**  
CONTACT BROKER



**UTILITIES**  
AVAILABLE TO SITE



**ZONING**  
PD 07-32 (PLANNED DEVELOPMENT)  
CC (COMMUNITY COMMERCIAL)



**APPROVED USES**  
MOST COMMUNITY & REGIONAL, OFFICE,  
RETAIL, RESTAURANT & COMMERCIAL USES.



**ACCESS**  
CENTRALLY LOCATED IN DFW METROPLEX  
WITH EASY ACCESS TO HWY 360



**AIRPORT**  
10 MIN TO DFW AIRPORT





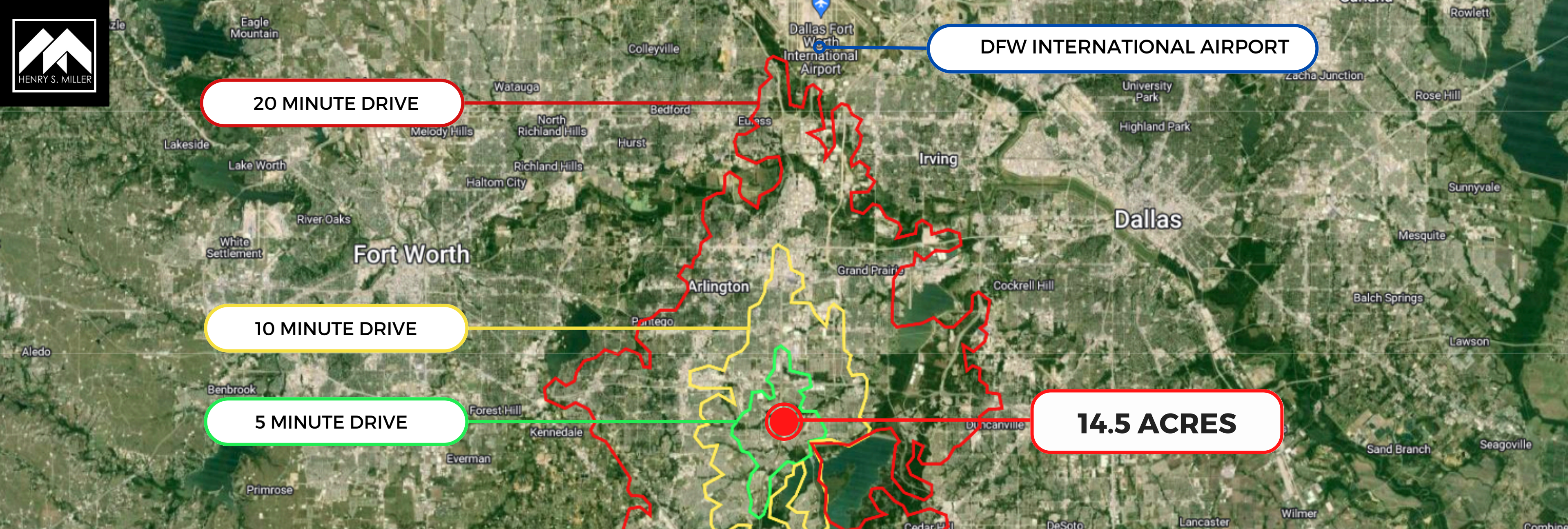

# PROPERTY DESCRIPTION

NWQ STATE HIGHWAY 360 & SUBLETT RD  
ARLINGTON, TX 76018

This approximately 14.5-acre property sits in an ideal spot in Arlington, Texas, at the northwest corner of SH 360 and Sublett. It offers convenient access to Highway 360 and includes pad sites for future development. The site is near numerous restaurants and retail stores, providing easy access to essential neighborhood amenities.

Located approximately 20-minutes from DFW Airport makes this property a prime opportunity for new commercial development.



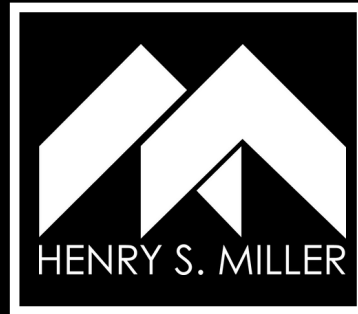
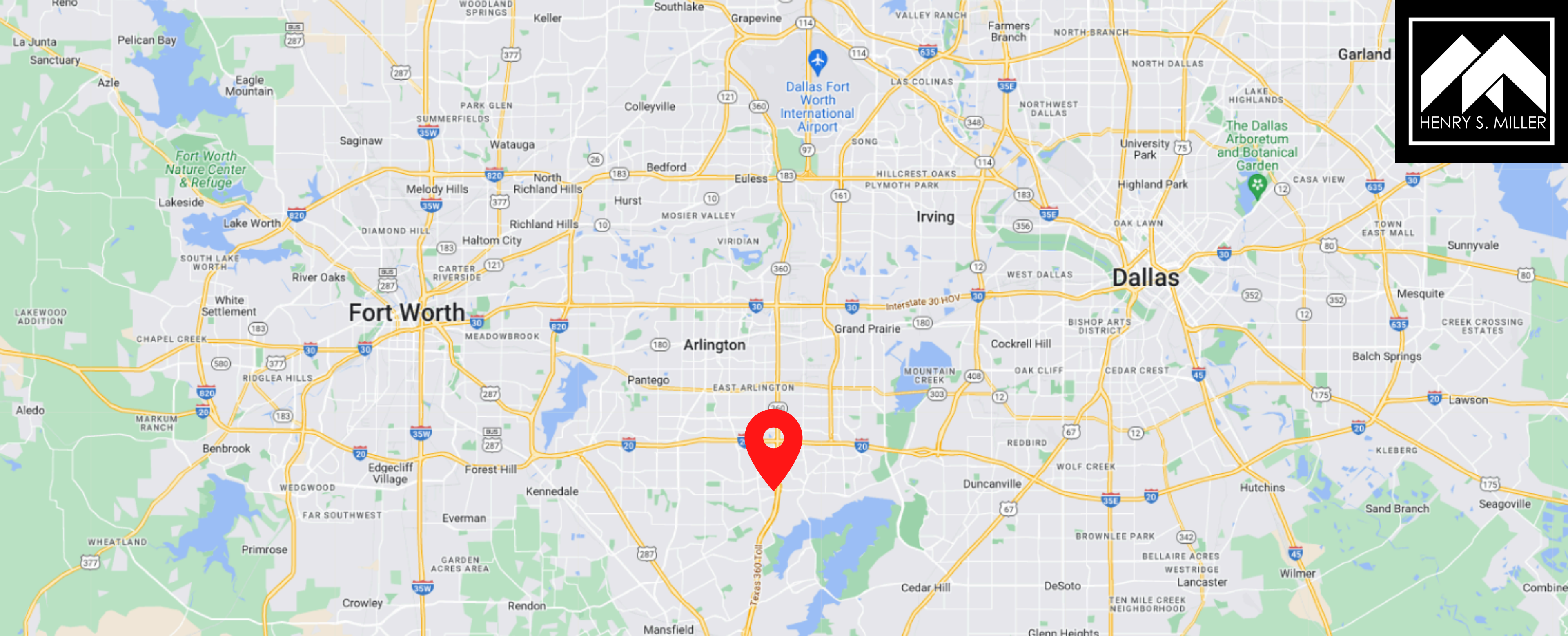

# CONTACT OUR TEAM

**LANE KOMMER**  
SENIOR VICE PRESIDENT  
(972) 419-4093 Direct  
(469) 258-0088 Mobile  
[lkommer@henrysmiller.com](mailto:lkommer@henrysmiller.com)

**HENRY S. MILLER BROKERAGE, LLC**  
5151 Belt Line Road, Suite 900  
Dallas, Texas 75254  
[www.henrysmiller.com](http://www.henrysmiller.com)

NOTICE & DISCLAIMER: The enclosed information is from sources believed to be reliable, but Henry S. Miller Brokerage, LLC has not verified the accuracy of the information. Henry S. Miller Brokerage, LLC makes no guarantee, warranty or representation as to the information, and assumes no responsibility for any error, omission or inaccuracy. The information is subject to the possibility of errors, omissions, changes of condition, including price or rental, or withdrawal without notice. Any projections, assumptions or estimates are for illustrative purposes only. Recipients should conduct their own investigation.