

1035
W LAKE

1039

← Inkwell
NOW OPEN!

FULTON MARKET – CHICAGO, IL
RESTAURANT OPPORTUNITY

ASANA PARTNERS

MID-AMERICA URBAN

NORTH CARPENTER STREET

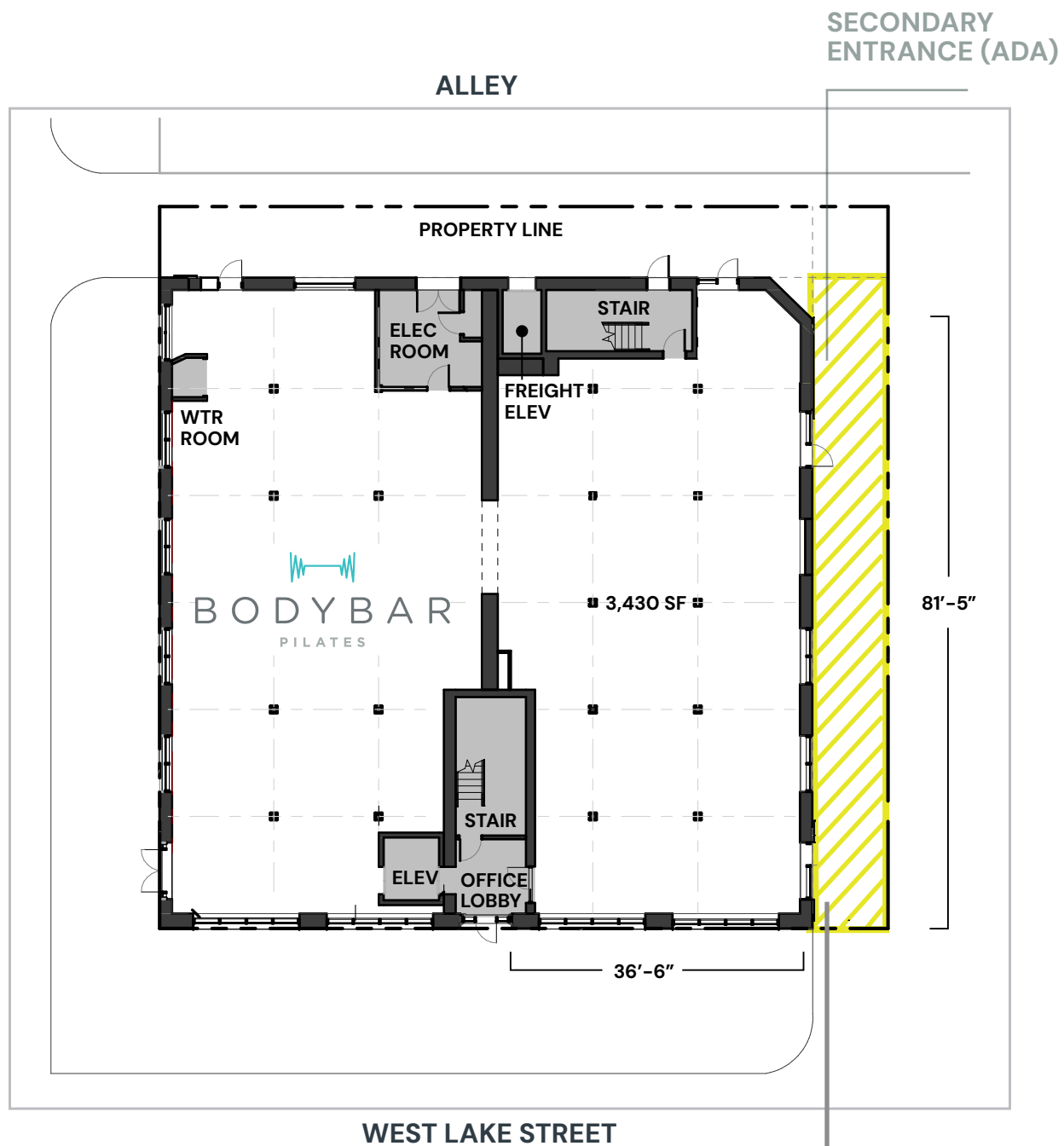

+/- 1,500 SF EXCLUSIVE
OUTDOOR PATIO

LEASING PLAN

- THREE-STORY, BRICK AND TIMBER BOUTIQUE OFFICE BUILDING SITUATED AT THE SOUTHWEST CORNER OF WEST LAKE STREET AND NORTH CARPENTER STREET IN CHICAGO'S FULTON MARKET NEIGHBORHOOD

- INTERIOR AND EXTERIOR OF BUILDING WAS FULLY RENOVATED IN 2023

- 3,430 SF INLINE RETAIL OR RESTAURANT SPACE AVAILABLE

- OPPORTUNITY TO JOIN NEWLY OPENED, OMAHA-BASED INKWELL COCKTAIL BAR

- ±1,500 SF ADJACENT OUTDOOR AREA OPPORTUNITY

- BLACK IRON IN PLACE

- EASE OF LOADING OFF CARPENTER STREET

- AVAILABLE IMMEDIATELY



Inkwell



EXTERIOR PHOTOS AFTER DARK



STOREFRONT

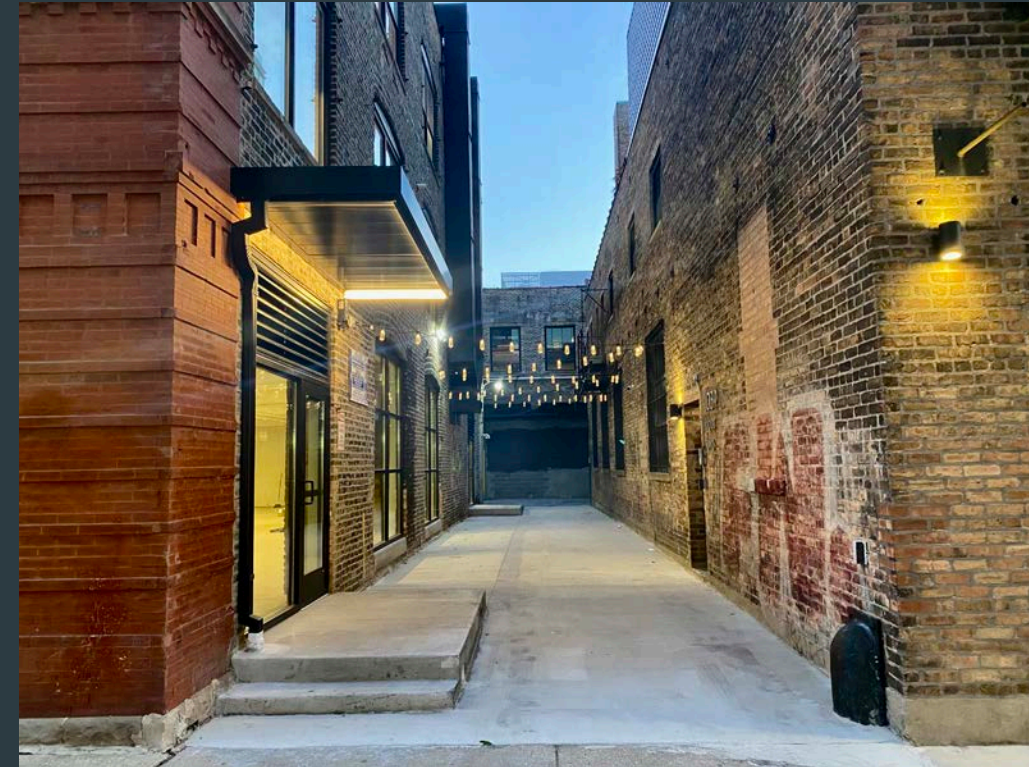

1,500 SF ALLEYWAY PATIO LOOKING SOUTH



MAIN ENTRANCE FRONTS ALLEYWAY PATIO



SECONDARY ENTRANCE ALSO FRONTS ALLEYWAY PATIO

ADDITIONAL EXTERIOR PHOTOS AFTER DARK



SOUTHEAST VIEWPOINT



WINDOWS ALONG ALLEYWAY PATIO

WITHIN ONE BLOCK



Inkwell

NOW OPEN AT 1039 W. LAKE STREET



Osaka
COCINA NIKKEI

COMING SOON TO 1101 W. LAKE STREET



Riccardo
OSTERIA



nights &
weekends



Forno Rosso



GIOIA
RISTORANTE PASTIFICIO

JOIN FULTON MARKET

OFFICE

AspenDental

BCG BOSTON CONSULTING GROUP

Coca-Cola

dyson

EY

Google

glassdoor™

HARRISON STREET
Making an Impact.

HermanMiller



JOHN DEERE

Knoll



SRAM

Uber

VITAL PROTEINS™

WPP

FOOD & BEVERAGE

aba

Au Cheval

avec

Aviary

BAR ★ SIENA

BEATRIX™

cabra
cevicheria

CIRA

duck duck goat

EVER
after



FIORETTA
ITALIAN STEAKHOUSE

GIOIA
RISTORANTE PASTIFICIO

GIRL & THE GOAT

Levain
BAKERY

εστιατόριο
LÝRA



next

Osaka
COCINA NIKKEI

rose mary

REGISTER



SWIFT & SONS
CHICAGO, IL

TACOMBI

TimeOut
MARKET
CHICAGO

TRIVOLI
TAVERN
CHICAGO

HOSPITALITY

THE
DALCY
EVENT HALL

the
emily
hotel

the hoxton

H
HYATT
house®

LOFT LUCIA

NOBU HOTEL

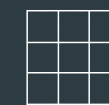

SOHO HOUSE

RETAIL

allbirds

ANTHROPOLOGIE

bluemercury®

BRILLIANT EARTH

brooklinen



FRAMEBRIDGE

free people

ever/
body

lululemon
athletica

Madewell

MEJURI

patagonia®

SPECIALIZED

WARBY PARKER



CONCEPTUAL RENDERING

1035
WLAKE

KELLY NICKELE

MID-AMERICA REAL ESTATE CORP.
KNICKELE@MIDAMERICAGRP.COM
630.954.9513

LARA KEENE

MID-AMERICA REAL ESTATE CORP.
LKEENE@MIDAMERICAGRP.COM
630.481.4038

GREG BAYER

MID-AMERICA REAL ESTATE CORP.
GBAYER@MIDAMERICAGRP.COM
630.954.7441

PAUL BRYANT

MID-AMERICA REAL ESTATE CORP.
PBRYANT@MIDAMERICAGRP.COM
630.954.7354