

217 28<sup>TH</sup> STREET SE  
GRAND RAPIDS, MICHIGAN

RETAIL FOR SALE  
5,000 Square Feet Available



**SIGNATURE  
ASSOCIATES**  
KNOW SIGNATURE | KNOW RESULTS

**NEW BEGINNINGS RESTAURANT**

**PRICE REDUCED**



## PROPERTY FEATURES

- 5,000 total square feet available
- Located on 1.72 acres
- Zoned TN-TBA
- 12' Ceilings
- Security system in place
- Built in 1971; Renovated in 1999 & 2023
- Sale Price: ~~\$1,600,000~~ \$995,000 (\$199.00/sq. ft.)

**Comments:** First time on the market, the iconic New Beginnings restaurant is available for purchase on busy 28th Street and less than 1.5 miles from US-131. This purchase is 100% turn-key and fully equipped, ready to open day one! Over 40 parking spots on the side and back. Do not miss this opportunity to own along 28th Street.

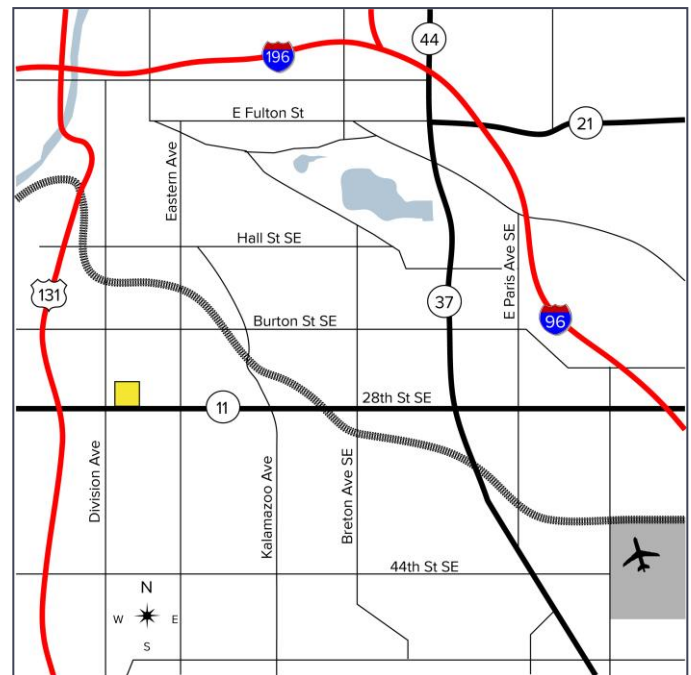

For more information, please contact:

**JOE RIZQALLAH**  
(616) 822 6310

[jrizqallah@signatureassociates.com](mailto:jrizqallah@signatureassociates.com)

**PETER CACHEY**  
(616) 259 6386

[pcachey@signatureassociates.com](mailto:pcachey@signatureassociates.com)

**SIGNATURE ASSOCIATES**  
1188 East Paris Ave SE, Suite 220  
Grand Rapids, MI 49546  
[www.signatureassociates.com](http://www.signatureassociates.com)



217 28<sup>th</sup> Street SE – Grand Rapids, Michigan

Retail for Sale

5,000  
Square Feet  
AVAILABLE

Aerial



DEMOGRAPHICS		
	POPULATION	MED. HH INCOME
1 MILE	11,429	\$74,330
3 MILE	129,431	\$65,799
5 MILE	293,445	\$69,369

TRAFFIC COUNTS (TWO-WAY)	
39,422	28 <sup>th</sup> St east of Division Ave
43,600	28 <sup>th</sup> St west of Division Ave
15,922	Division Ave north of 28 <sup>th</sup> St
15,180	Division Ave south of 28 <sup>th</sup> St

For more information, please contact:

**JOE RIZQALLAH**

(616) 822 6310

jrizzqallah@signatureassociates.com

**PETER CACHEY**

(616) 259 6386

pcachey@signatureassociates.com

**SIGNATURE ASSOCIATES**

1188 East Paris Ave SE, Suite 220

Grand Rapids, MI 49546

www.signatureassociates.com

Information is subject to verification and no liability for errors or omissions is assumed. Price is subject to change and listing withdrawal.