

3475 CASS AVENUE
DETROIT, MICHIGAN

RETAIL FOR SALE
1,134 Square Feet Available



**SIGNATURE
ASSOCIATES**
KNOW SIGNATURE | KNOW RESULTS

HEART OF MIDTOWN LOCATION



PROPERTY FEATURES

- 1,134 square feet available
- Excellent location in the heart of Midtown
- Surrounded by a variety of restaurants and sports & entertainment venues
- Good hard corner
- 14' clear height
- (2) overhead doors
- Sale Price: \$595,000 (\$524.69/sq. ft.)



For more information, please contact:

JOE STACK
(248) 359 0615
jstack@signatureassociates.com

CHARLEY HENNEGHAN
(248) 359 3838
chennehan@signatureassociates.com

SIGNATURE ASSOCIATES
One Towne Square, Suite 1200
Southfield, MI 48076
www.signatureassociates.com

3475 Cass Avenue – Detroit, Michigan

Retail For Sale

1,134
Square Feet
AVAILABLE

Site Plan

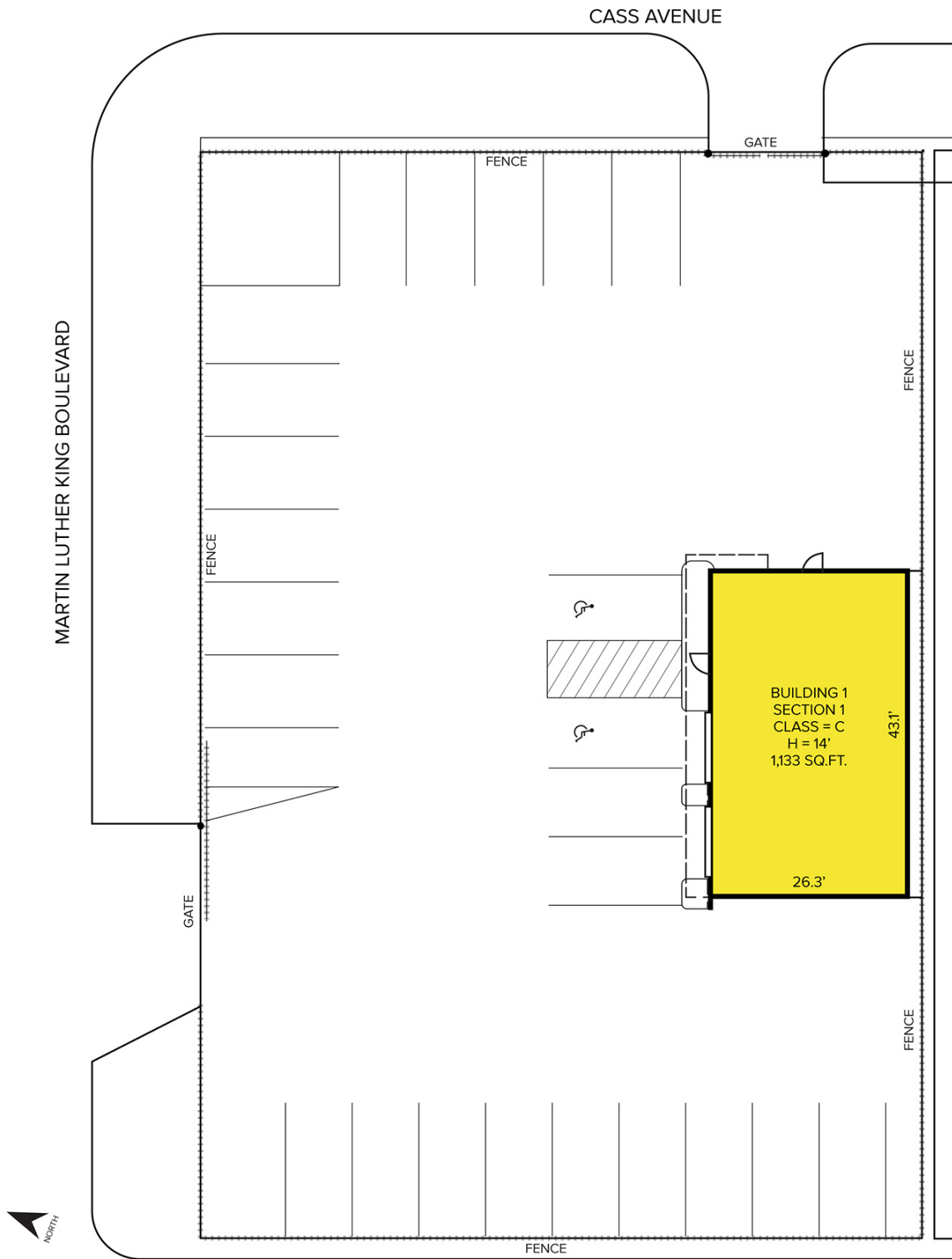

For more information, please contact:

JOE STACK
(248) 359 0615
jstack@signatureassociates.com

CHARLEY HENNEGHAN
(248) 359 3838
chenneghan@signatureassociates.com

SIGNATURE ASSOCIATES
One Towne Square, Suite 1200
Southfield, MI 48076
www.signatureassociates.com

3475 Cass Avenue – Detroit, Michigan

Retail For Sale

1,134
Square Feet
AVAILABLE



DEMOGRAPHICS

	POPULATION	MED. HH INCOME
1 MILE	23,875	\$43,178
3 MILE	99,591	\$47,792
5 MILE	263,012	\$44,377

TRAFFIC COUNTS (TWO-WAY)

5,562	Cass Ave. SE of MLK Jr Blvd.
5,166	Cass Ave. NW of MLK Jr Blvd.
12,488	MLK Jr Blvd. SW of Cass Ave.
14,027	MLK Jr Blvd. NE of Cass Ave.



For more information, please contact:

JOE STACK
(248) 359 0615
jstack@signatureassociates.com

CHARLEY HENNEGHAN
(248) 359 3838
chennehan@signatureassociates.com

SIGNATURE ASSOCIATES
One Towne Square, Suite 1200
Southfield, MI 48076
www.signatureassociates.com