

Columbia Plaza

250 East 5th Street, 15th Floor, Cincinnati, OH 45202



PRIVATE OFFICES

Highly professional private offices for individuals and teams that are flexible and scaled for growth.

MEETING ROOMS

Spacious, well-appointed meeting rooms with on-site administrative support. Available for an hour, day or longer.

VIRTUAL OFFICES

Establish a business presence with mail handling, phone answering or meeting room time.

ABOUT THIS LOCATION

The Columbia Plaza (formerly Chiquita Center) in Cincinnati, Ohio provides an excellent view from our office spaces and meeting rooms on the 15th floor, of downtown Cincinnati. The area is full of rich history, as well as being home to the headquarters of companies like Proctor & Gamble Co., The Kroger Co., and Macy's. The Cincinnati Art Museum is a short drive away, and the Carew Tower is just a little further down 5th street. If your business is looking for a beautiful office location in Cincinnati, Premier Workspaces has the solution.

CONTACT US

Let's touch base! Contact the on-site General Manager at 513-562-1500 or CINmanager@premierworkspaces.com to schedule a tour.



Columbia Plaza

250 East 5th Street, 15th Floor, Cincinnati, OH 45202



PREMIER AMENITIES

Our private suites can be easily customized to fit your desired aesthetic and brand.

- Private Offices
- Team Rooms
- High Speed Internet
- Telephone Answering
- Mail Collection
- Equipped Kitchen
- Day Offices
- Meeting Rooms
- Daily Janitorial
- Furnished or Unfurnished

PREMIER DIFFERENCE

We've been perfecting the professional workspace for over 21 years.

- Highly-Professional Atmosphere
- On-Site Manager & Support Staff
- Scalable Solutions for Individuals and Teams
- On-Site Billing
- 90+ Locations Nationwide

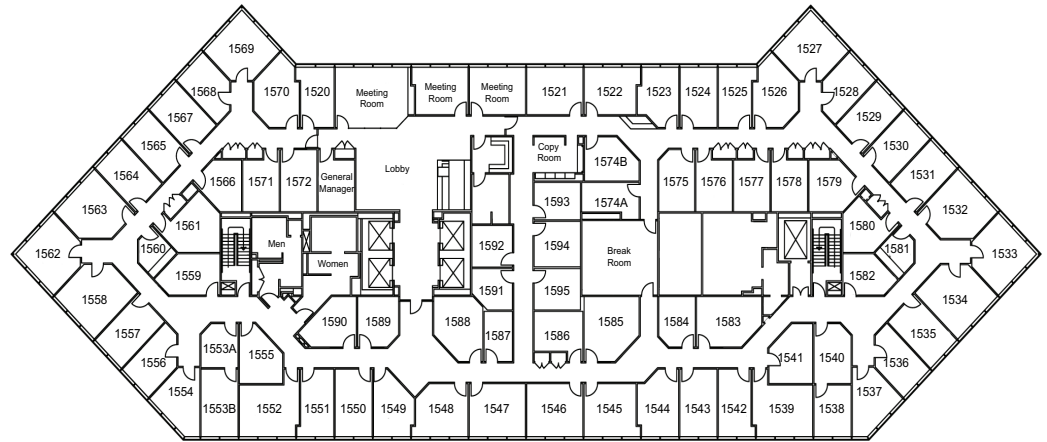

NEARBY AMENITIES

Columbia Plaza is located nearby the I-75, I-71, and 475. The CVG Airport, KY Airport, and the Lunken Airport are all about 15 to 20 minutes away, making any of them easily accessible from the building.

Nearby Amenities:

- The Alms Park
- Federal Courthouse (Federal Building)
- Eden Park
- Fountain Square
- Great American Ballpark
- P&G Gardens

Property Amenities: Nearby Transit:

- 2 ATMs (PNC and US Bank)
- Bagel Shop
- Café 201
- Subway
- Starbucks
- Parking – Underground Garage
- Freeways – I-75, I-71, and 475
- Streetcar – 1 Block at Columbia Plaza

CONTACT US

Let's touch base! Contact the on-site General Manager at 513-562-1500 or CINmanager@premierworkspaces.com to schedule a tour.