



Exceptional Industrial Distribution Buildings Featuring Dock High & Ground Level Loading  
A Master Planned Industrial Park Undergoing Complete Refurbishment  
Another Quality Institutionally Owned & Managed Asset by Rexford Industrial

3002-3072

INLAND EMPIRE BLVD.  
Ontario, CA



## REXFORD EMPIRE COMMERCE CENTER

Eleven High Image Industrial Units from 11,000 to 33,000 SF  
Prime Ontario Location with Identity on the I-10 Freeway

**NAICapital**  
COMMERCIAL REAL ESTATE SERVICES, WORLDWIDE



**Richard Lee, SIOR**  
Senior Vice President  
310.600.8888  
rlee@naicapital.com  
Cal DRE Lic #01757870

**Nicholas Chang, CCIM, SIOR**  
Senior Vice President  
909.243.7614  
nchang@naicapital.com  
Cal DRE Lic #01344844

**Justin Kuehn**  
Vice President  
909.243.7627  
jkuehn@naicapital.com  
Cal DRE Lic #01966182

# SITE PLAN & PROPERTY HIGHLIGHTS

3002-3072 INLAND EMPIRE BLVD



## PROPERTY HIGHLIGHTS

- Highly functional industrial units feature both Dock High and Grade Level Loading
- Minimum warehouse ceiling heights up to 24 feet
- Select units feature 1-10 Freeway adjacent identity; additional street frontage identity along Inland Empire Blvd.
- 210' reciprocal truck courts available. Select units feature 110' deep private truck courts allowing for rare, excess trailer parking for small industrial units of this size
- Newly renovated office spaces up to 2,500 SF or more
- Key Distances include:



ONT Airport: 1.6 Miles



Victoria Gardens: 6 miles



BNSF Intermodal Railyard: 21 Miles



FedEx Hub: 4 miles



UPS Hub: 2.8 Miles



Nearest on/off Ramp: 1/4 miles

Address	Total Square Footage	Loading	Warehouse Height	Available
3002A	15,137 SF	1 DH   1 GL	24' Min	Leased
3002B	12,043 SF	1 DH   1 GL	24' Min	Leased
3008	27,520	2 DH   1 GL	24' Min	Leased
3022	32,609	5 DH   1 GL	24' Min	Leased
3030A	14,222	2 DH   0 GL	24' Min	Leased
3030B	18,324	2 DH   1 GL	24' Min	Leased
3042A	28,800	4 DH   1 GL	24' Min	Now
3042B	17,600	1 DH   1 GL	24' Min	Leased
3050	14,400	1 DH   1 GL	24' Min	Leased
3062	11,502	1 DH   1 GL	24' Min	Leased
3072	26,250	2 DH   1 GL	24' Min	Leased

3042A WAREHOUSE & OFFICE FLOORPLAN

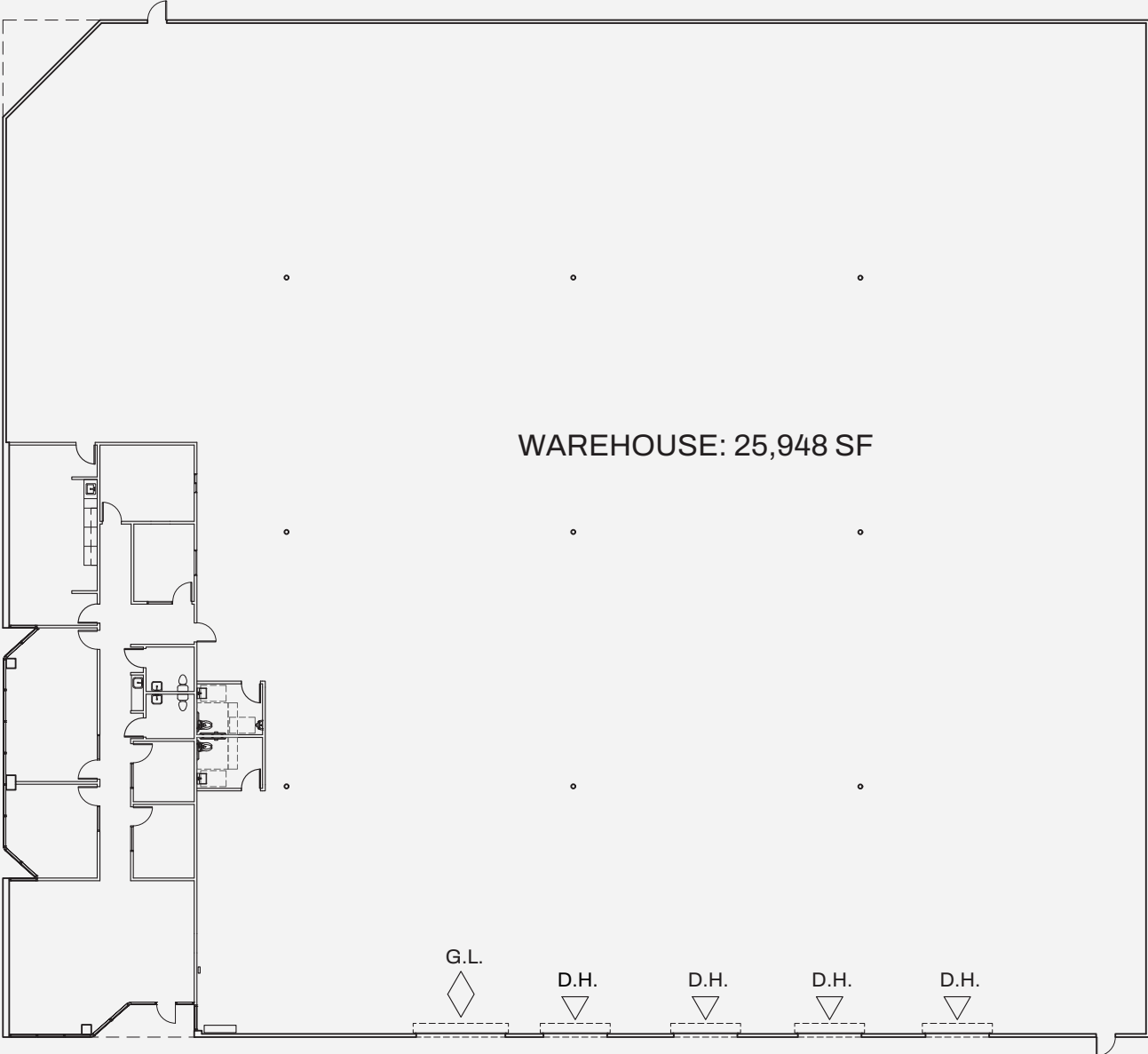

OFFICE AREA: 2,852 SF

WAREHOUSE: 25,948 SF

OFFICE PHOTOS



EXTERIOR PHOTOS



# REXFORD EMPIRE COMMERCE CENTER

Eleven High Image Industrial Units from 11,000-33,000 SF

Prime Ontario Location with Identity on the I-10 Freeway

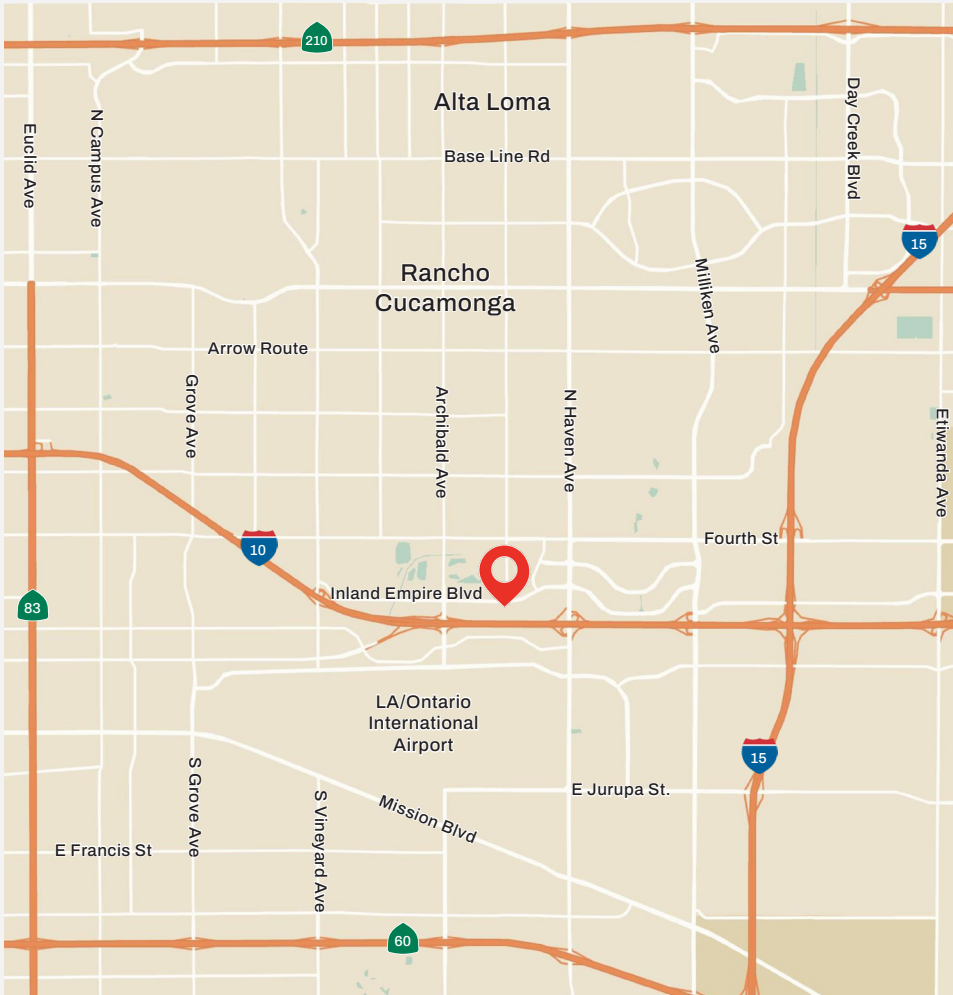

**NAI Capital**  
COMMERCIAL REAL ESTATE SERVICES, WORLDWIDE

  
**Rexford  
Industrial**

**Richard Lee, SIOR**  
Senior Vice President  
310.600.8888  
rlee@naicapital.com  
Cal DRE Lic #01757870

**Nicholas Chang, CCIM, SIOR**  
Senior Vice President  
909.243.7614  
nchang@naicapital.com  
Cal DRE Lic #01344844

**Justin Kuehn**  
Vice President  
909.243.7627  
jkuehn@naicapital.com  
Cal DRE Lic #01966182