

For sublease

5501 W Ogden Avenue, Cicero, IL 60804
32,000 - 95,466 SF



JLL

Patrick Callahan
Senior Associate
patrick.callahan@jll.com
+1 331 202 7699

Kris Bjorson, SIOR
Vice Chairman
kris.bjorson@jll.com
+1 312 282 0511

For sublease

32,000 - 95,466 SF Available

Available space	32,000 - 95,466 SF	Auto parking	77 total
Office	7,500 SF	Sprinklers	Wet
Clear height	12'6" - 18'	Power	3,200 amps
Column spacing	30' x 30' typ	Cranes	(1) 5-ton overhead
Loading docks	3 ext, 4 int	Zoning	M-2
Drive-in doors	2	Rail	BNSF adjacent

**Interior and
exterior loading**

Air compressor

Will-call area

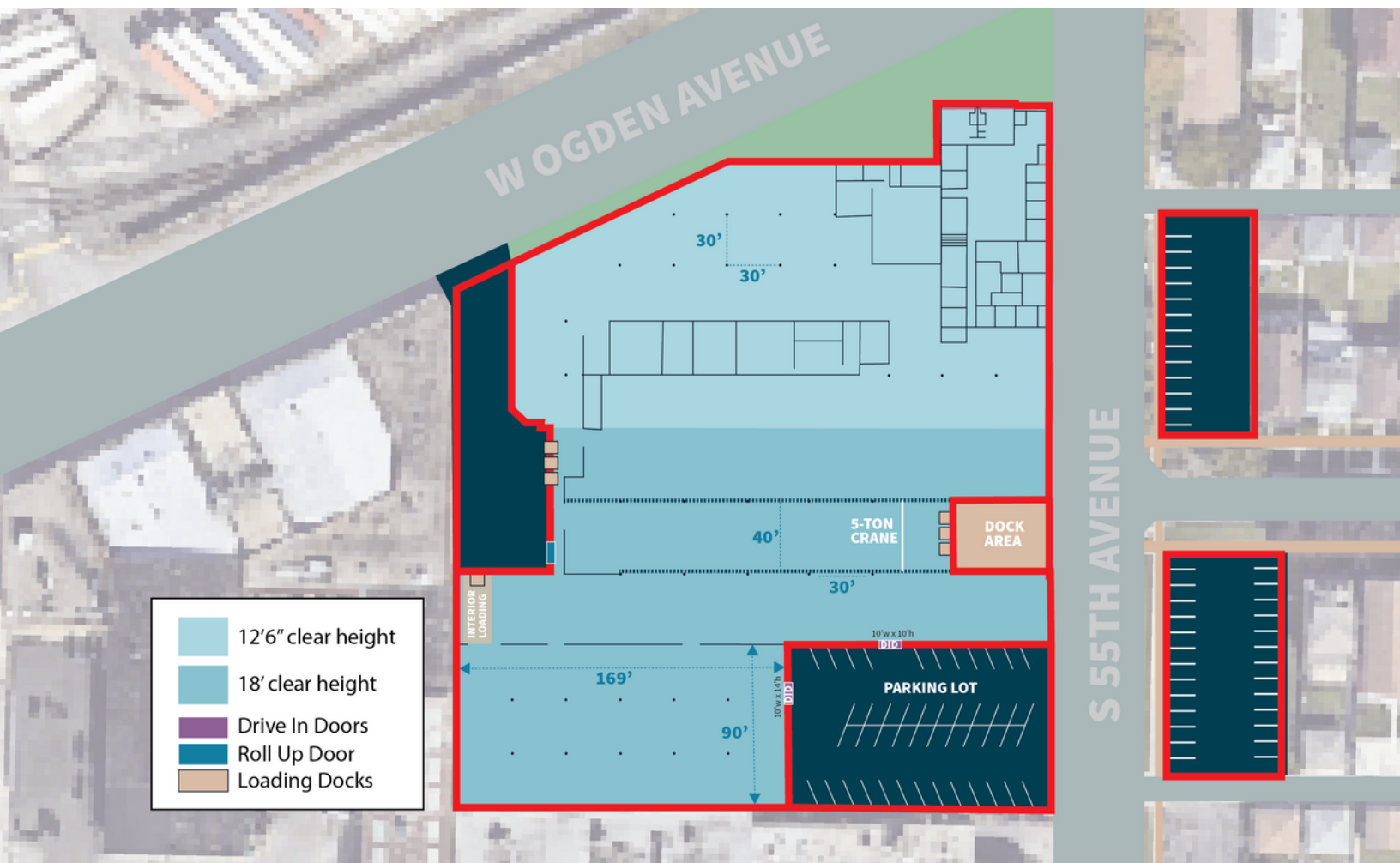

5501 W Ogden Avenue,
Cicero, IL 60804

3.0 miles to full I-290 interchange
2.5 miles to full I-55 interchange

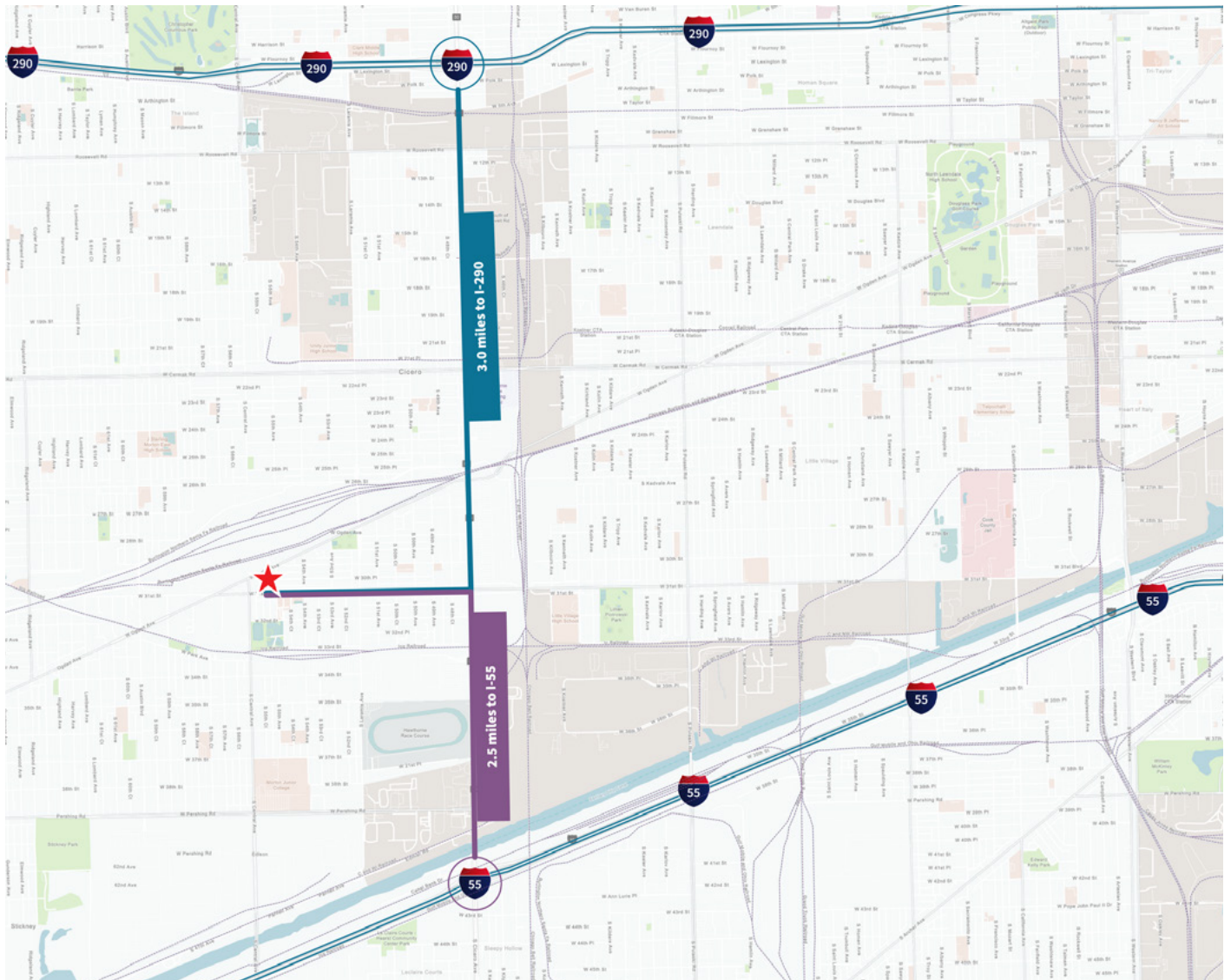

Patrick Callahan
Senior Associate
patrick.callahan@jll.com
+1 331 202 7699

Kris Bjorson, SIOR
Vice Chairman
kris.bjorson@jll.com
+1 312 282 0511

Although information has been obtained from sources deemed reliable, neither Owner nor JLL makes any guarantees, warranties or representations, express or implied, as to the completeness or accuracy as to the information contained herein. Any projections, opinions, assumptions or estimates used are for example only. There may be differences between projected and actual results, and those differences may be material. The Property may be withdrawn without notice. Neither Owner nor JLL accepts any liability for any loss or damage suffered by any party resulting from reliance on this information. If the recipient of this information has signed a confidentiality agreement regarding this matter, this information is subject to the terms of that agreement. ©2025 Jones Lang LaSalle IP, Inc. All rights reserved