

**GENERAL NOTES**

**COMMENTS:**  
 1. FURNITURE VENDOR: WHEN EXISTING FILE STORAGE IS NOT ADEQUATE, PROVIDE 2 DRAWER LATERAL FILE FOR EACH NEW DESK WITHOUT A CREDENZA OR (1) 4 DRAWER LATERAL FILE FOR A SET OF 2 DESKS KEYED SEPARATELY.

**FINISH COMMENTS:**  
 1. DO NOT PAINT NATURAL MATERIALS (BRICK, STONE, WOOD AND/ OR METAL)

**TECHNOLOGY COMMENTS:**

**MARKETING COMMENTS:**  
 1. CUSTOM QUOTE WALL REQUIRED. MARKETING TEAM TO DETERMINE EXACT LOCATION.

**SURVEY FOR SPECIAL REQUIREMENTS**

	NEW OR EXPANDED TELLER LINE
	TELLER LINE ADA STATION PRESENT
	VERIFY ALL DIMENSIONS NOTED ON PLAN

CASH STORAGE REQUIREMENTS		LOCATION
	CASH STORAGE OK	
X	SURVEY FOR CASH STORAGE SOLUTION	TYPE AND LOCATION, AS NEEDED
	SURVEY FOR DAY SAFE	
	SURVEY FOR TL-30	
	SURVEY FOR TL-15	

	PROGRAM		
	EXISTING	PROPOSED	NET
TELLERS	5	-	-
TELLERS - DRIVE	2	-	-
PLATFORM	4	-	-
SERVICE MGR	0	1	+1
ONLINE BANKING	0	1	+1
FOCUS / CONF	0	-	-
ATM - WALK UP	1	-	-
ATM - DRIVE UP	0	-	-
NIGHT DEPOSIT	1	-	-

PROPERTY NAME AND ADDRESS

**ANNANDALE - JOHN MARR**  
 2,273 SQFT - GREATER DISTRICT OF COLUMBIA WEST  
 4260 JOHN MARR DRIVE  
 ANNANDALE, VIRGINIA 22003

SHEET TITLE

**GENERAL SPECIFICATIONS**

WELLS FARGO BUILDING ENTITY      WACHOVIA PROPERTY ID

141701      410394

ISSUE / UPDATED DATE      STATE

23 DECEMBER 2010      **VA**



WELLS FARGO  
 ARCHITECTURE & DESIGN  
 301 SOUTH TRYON STREET  
 19TH FLOOR  
 CHARLOTTE, NC 28288  
 NC0350 / MAC D1130-190

BASKERVILL

LEGEND

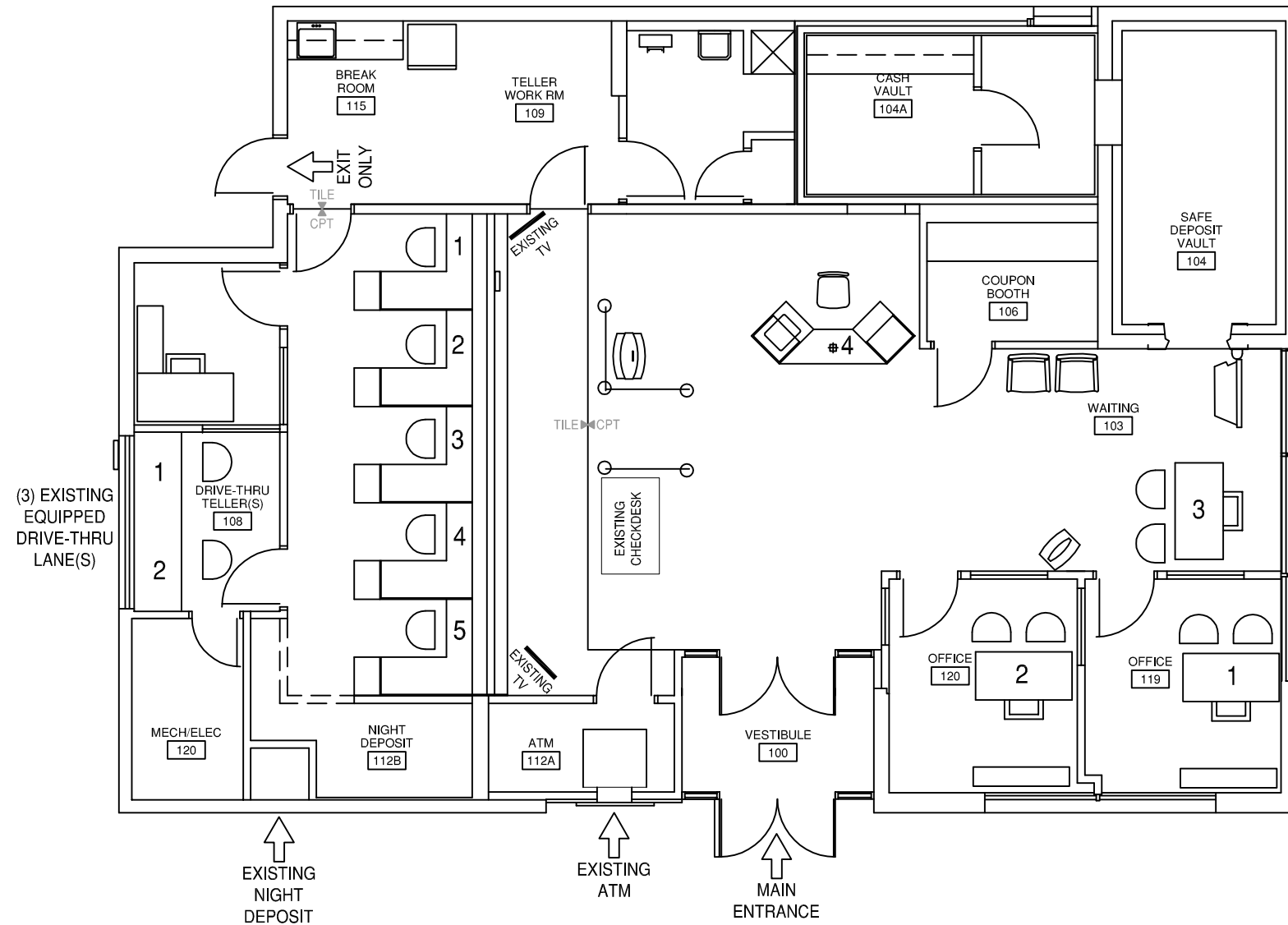

REVISIONS

1	-	-
2	-	-
3	-	-
4	-	-
5	-	-

PROPERTY NAME AND ADDRESS

**ANNANDALE - JOHN MARR**  
 2,273 SQFT - GREATER DISTRICT OF COLUMBIA WEST  
 4260 JOHN MARR DRIVE  
 ANNANDALE, VIRGINIA 22003

SHEET TITLE

**EXISTING  
 FLOOR PLAN**

WELLS FARGO BUILDING ENTITY WACHOVIA PROPERTY ID

141701 410394

ISSUE / UPDATED DATE STATE

23 DECEMBER 2010 **VA**

LEGEND

**COLOR LEGEND**

GREEN	RELO / RECONFIG
BLUE	NEW MILLWORK
MAGENTA	NEW ELEMENTS
BLACK	EXISTING
RED	REVISION
ORANGE	NEW WALLS/DOORS

**FINISH LEGEND**

P-1	PAINT - BENJAMIN MOORE PUTNAM IVORY HC-39
P-2	PAINT - BENJAMIN MOORE ROASTED SESAME SEED 2160-40
P-3	PAINT - BENJAMIN MOORE KANSAS GRAIN 2160-60
C-1	NEW WALK-OFF MAT - TANDUS ABRASIVE ACTION MKI - 19102
C-2	NEW CARPET - TANDUS WAGONWHEEL #05310 24" x 24"
T-1	TILE - DAL TILE VERANDA SAND P505 / 13" x 13"
	SEMI OPAQUE FILM - 3M 7725SE-315 / DUSTED CRYSTAL

**REVISIONS**

1	-	-
2	-	-
3	-	-
4	-	-
5	-	-

PROPERTY NAME AND ADDRESS  
**ANNANDALE - JOHN MARR**  
 2,273 SQFT - GREATER DISTRICT OF COLUMBIA WEST  
 4260 JOHN MARR DRIVE  
 ANNANDALE, VIRGINIA 22003

SHEET TITLE  
**PROPOSED FLOOR PLAN**

WELLS FARGO BUILDING ENTITY	WACHOVIA PROPERTY ID
141701	410394
ISSUE / UPDATED DATE	STATE
23 DECEMBER 2010	VA

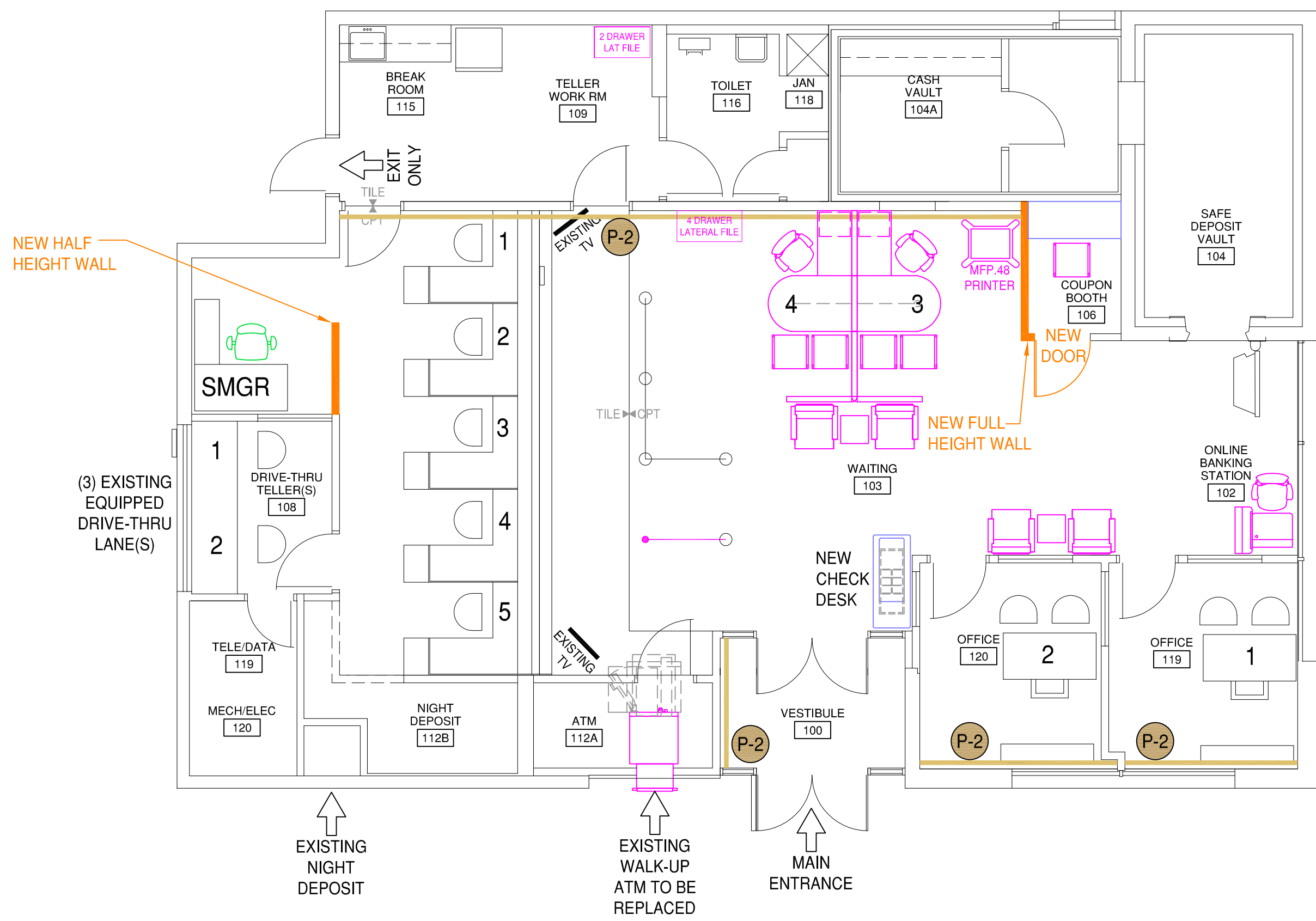

NEW HALF HEIGHT WALL

NEW FULL HEIGHT WALL

(3) EXISTING EQUIPPED DRIVE-THRU LANE(S)

EXISTING NIGHT DEPOSIT

EXISTING WALK-UP ATM TO BE REPLACED

MAIN ENTRANCE

LEGEND

**TECHNOLOGY LEGEND**

	TELLER WORKSTATION
	DRIVE-UP WORKSTATION
	PLATFORM WORKSTATION
	PRINTERS
	DATA ONLY
	BUSINESS BANKING WRKS
	MISCELLANEOUS EQUIPMENT
	ONLINE BANKING STATION
	PARTNER SPACE
	LEGACY EQUIPMENT

**REVISIONS**

1	-	-
2	-	-
3	-	-
4	-	-
5	-	-

PROPERTY NAME AND ADDRESS  
**ANNANDALE - JOHN MARR**  
 2,273 SQFT - GREATER DISTRICT OF COLUMBIA WEST  
 4260 JOHN MARR DRIVE  
 ANNANDALE, VIRGINIA 22003

SHEET TITLE  
**TECHNOLOGY FLOOR PLAN**

WELLS FARGO BUILDING ENTITY WACHOVIA PROPERTY ID  
 141701 410394

ISSUE / UPDATED DATE STATE  
 23 DECEMBER 2010 VA

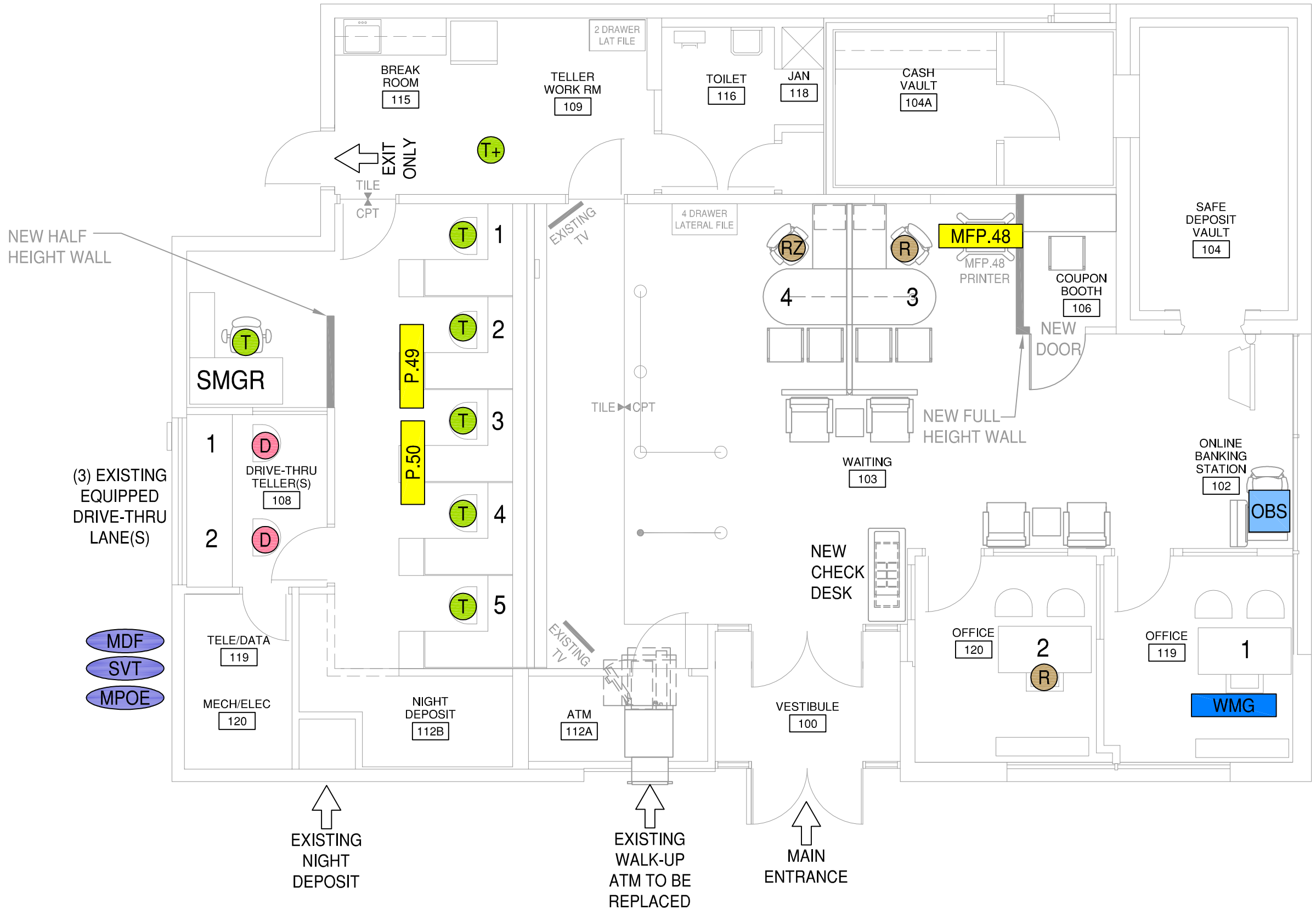

MARKETING LEGEND	
<span style="border: 1px solid red; padding: 2px;">QUOTE</span>	HENRY WELLS QUOTE
<span style="border: 1px solid yellow; padding: 2px;">TV</span>	42" FLAT SCREEN TV
<span style="border: 1px solid yellow; padding: 2px;">32</span>	32" FLAT SCREEN TV
<span style="border: 1px solid blue; border-radius: 50%; padding: 2px;">WW</span>	WELCOME WALL F = FIXED A = OPTION 'A' B = OPTION 'B' C = OPTION 'C'  P = PORTABLE FS = FREESTANDING V = VERTICAL FV = 'FLAGSHIP' VERTICAL CUST = CUSTOM * = CABLE MOUNTED
<span style="border: 1px solid green; padding: 2px;">MURAL</span>	MURAL
<span style="border: 1px solid green; padding: 2px;">KEY</span>	MURAL KEY

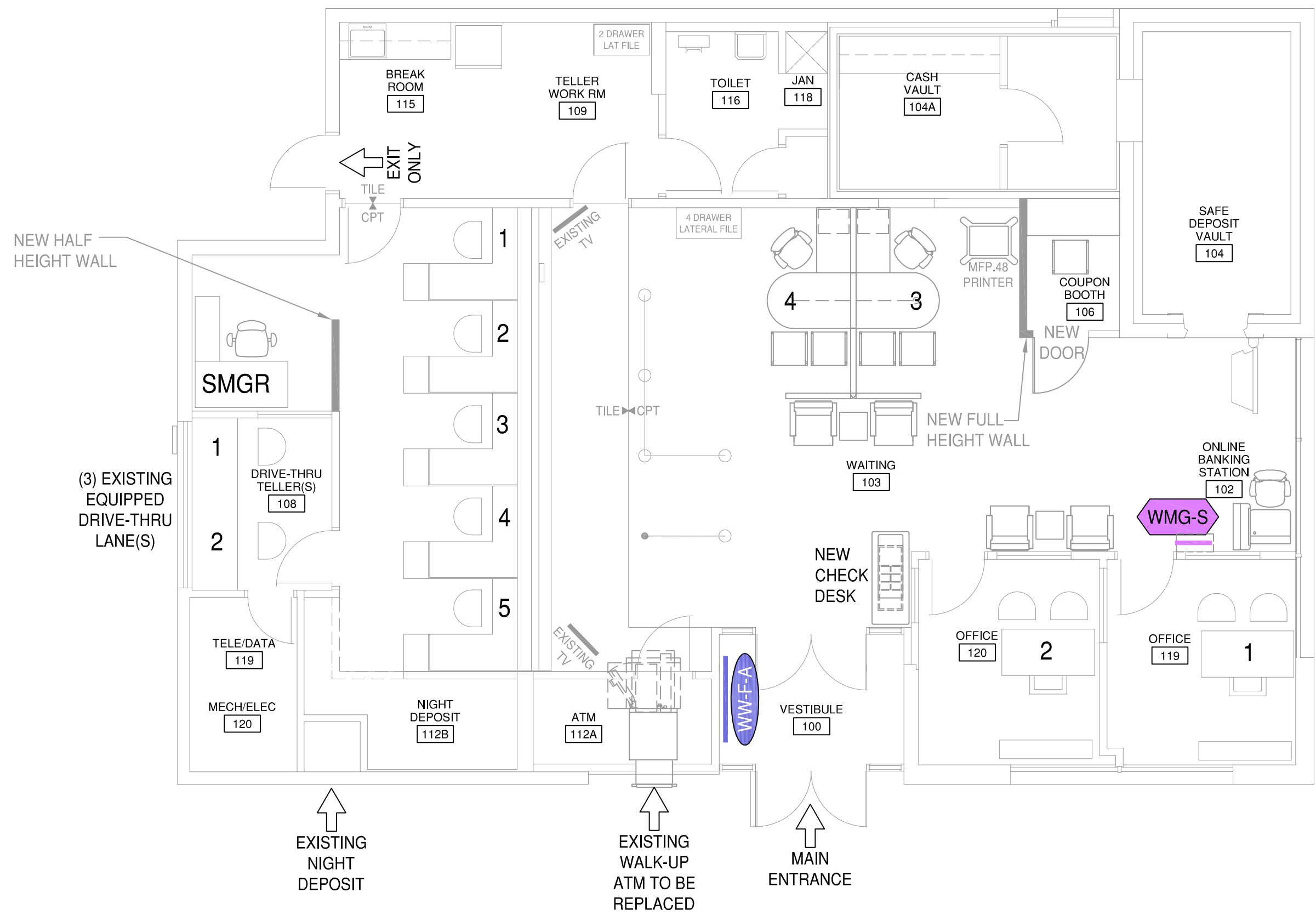

PROPERTY NAME AND ADDRESS

**ANNANDALE - JOHN MARR**  
 2,273 SQFT - GREATER DISTRICT OF COLUMBIA WEST  
 4260 JOHN MARR DRIVE  
 ANNANDALE, VIRGINIA 22003

SHEET TITLE

**MARKETING FLOOR PLAN**

WELLS FARGO BUILDING ENTITY WACHOVIA PROPERTY ID

141701 410394

ISSUE / UPDATED DATE STATE

23 DECEMBER 2010 VA