

# Walmart Plaza

U.S. 89 and Haul Rd.  
Page, AZ 86040  
Coconino County



## key features

- retail outlots anchored by existing Walmart Supercenter
- outlots available from  $\pm 0.8$  to  $\pm 10$  acres
- retail growth area serving Lake Powell tourism

## demographics

	3 miles	5 miles	10 miles
population	7,000	8,124	8,764
households	2,459	2,804	3,115
avg. household income	\$127,943	\$126,715	\$124,879
daytime population	3,928	4,233	4,392

2024 Estimates. Source: Applied Geographic Solutions 5/2024, TIGER Geography

outlots for sale/lease/build-to-suit

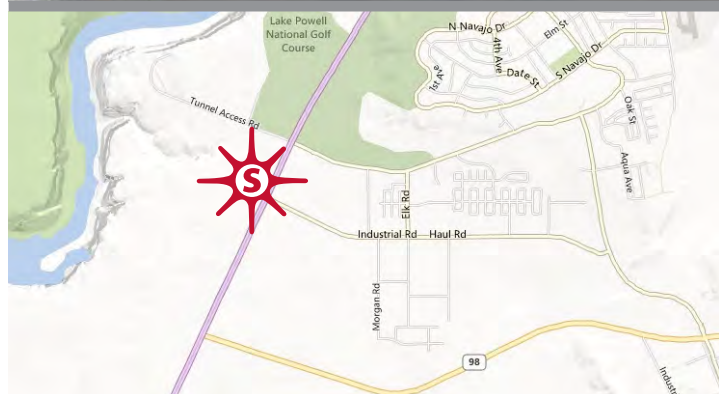

Jay D. Stein 480.949.9011 [jdstein@sandordev.com](mailto:jdstein@sandordev.com)

5725 N. Scottsdale Rd., Suite C-195, Scottsdale, AZ 85250

[www.sandordev.com](http://www.sandordev.com)  
**sandor**

## outlots available

OUTLOT	STATUS	SIZE
1D	AVAILABLE	±4.24 AC
1H	AVAILABLE	±0.8 AC
2	AVAILABLE	±1.0 AC
3	AVAILABLE	±1.0 AC
4	AVAILABLE	±1.0 AC
5	AVAILABLE	±1.0 AC
6	AVAILABLE	±1.72 AC
9	AVAILABLE	±4.58 AC

