

BAKER EXCHANGE

CENTRAL DENVER INDUSTRIAL + YARD



±24,074 SF AVAILABLE

1780 W. 6TH AVENUE, SUITE 520 | DENVER | COLORADO | 80209

FOR MORE INFORMATION:

AARON VALDEZ, SIOR
303.819.7333
aaron.valdez@cushwake.com

ALEC RHODES, SIOR
303.312.4282
alec.rhodes@cushwake.com

TYLER SMITH, SIOR, CCIM
303.312.4296
t.smith@cushwake.com

CUSHMAN & WAKEFIELD
1401 Lawrence Street, Suite 1100
Denver, Colorado 80202
www.cushmanwakefield.com



SUITE 520 SPECS

Suite SF:	±24,074
Warehouse SF:	±21,165 SF
Office SF:	±2,909 SF
Occupancy:	February 2025
Showroom:	Possible to convert a portion of office space
Dock High:	3
Grade Level:	1 (oversized drive-in ramp)
Clear Height:	16'
Power:	300-amps 120/208V (to be verified)
Fenced Yard:	±0.5 Acre
Parking:	Off-Street Parking



The information contained herein is believed to be accurate but is not warranted as to its accuracy and may change or be updated without notice. Seller or landlord makes no representation as to the environmental condition of the property and recommends purchaser's or tenant's independent investigation.

1780 W. 6TH AVENUE, SUITE 520

FLOOR PLAN

UNDER NEW OWNERSHIP

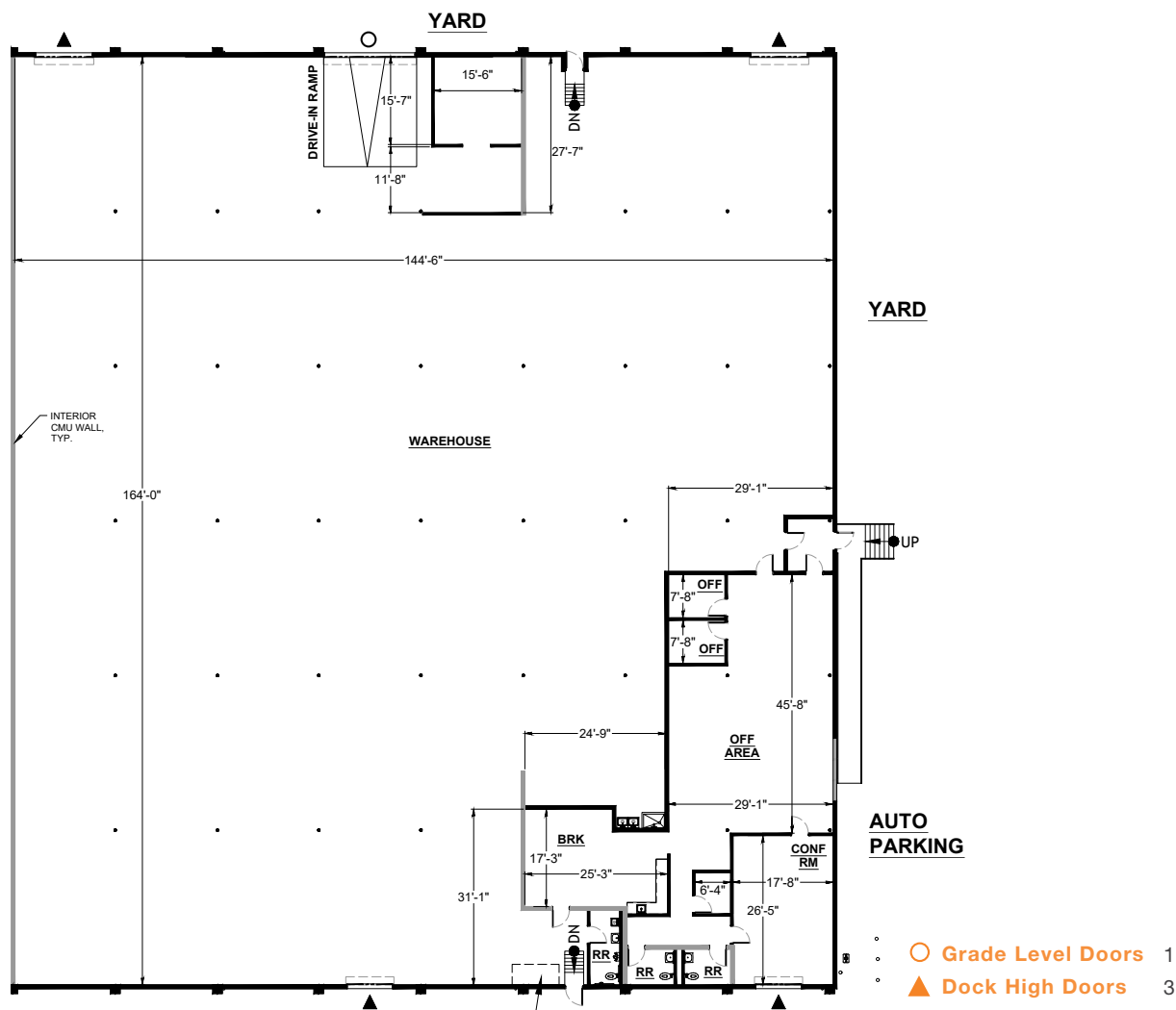

Planned Renovations



FOR MORE INFORMATION

AARON VALDEZ, SIOR

Executive Director

303.819.7333

aaron.valdez@cushwake.com

ALEC RHODES, SIOR

Executive Director

303.312.4282

alec.rhodes@cushwake.com

TYLER SMITH, SIOR, CCIM

Executive Director

303.312.4296

t.smith@cushwake.com

CUSHMAN & WAKEFIELD

1401 Lawrence Street, Suite 1100

Denver, Colorado 80202

www.cushmanwakefield.com

1780 W. 6TH AVENUE

DENVER, COLORADO 80209

