



Each office independently owned and operated

RE/MAX ADVANTAGE PLUS

1251 Town Centre Drive
Eagan, MN 55123
REMAXCOMMERCIAL.COM

FOR LEASE | OFFICE BUILDING

1440 ARCADE ST NORTH - UNIT A

SAINT PAUL, MN 55106

FOR MORE
INFORMATION
CONTACT:

TIM LITTLE

Chief Commercial Broker
952.432.4900
tctimlittle@gmail.com

JIM STARR

Sr. Associate
612.247.5898
jjstarr41@gmail.com

JEREMY FELDMANN

Associate
406.314.3333
jeremy.feldmann@remax.net



1440 ARCADE ST NORTH - UNIT A

SAINT PAUL, MN 55106

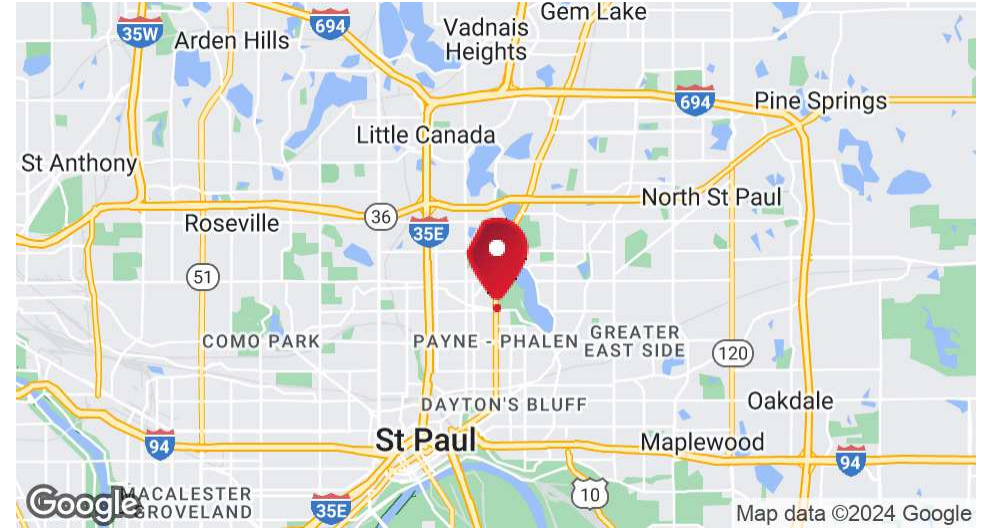

OFFERING SUMMARY

Lease Rate:	\$1,600.00 per month (Gross)
Available SF:	960 SF
Lot Size:	0.51 Acres
Building Size:	15,960 SF

PROPERTY DESCRIPTION

Lease Rate: \$1,600/mo (includes utilities)
 Space Size: 960 SF
 Lease Term (in months): 36 - 60
 Building Size: 15,960 sf
 Lot Size: 0.51 A
 Renovated: 2008
 Zoning: Retail / Business / Office



ADVANTAGE PLUS
Each office independently owned and operated

TIM LITTLE
 Chief Commercial Broker
 952.432.4900
 tctimlittle@gmail.com

JIM STARR JEREMY FELDMANN
 Sr. Associate Associate
 612.247.5898 406.314.3333
 jjstarr41@gmail.com jeremy.feldmann@remax.net

1251 Town Centre Drive
Eagan, MN 55123

REMAXCOMMERCIAL.COM

FOR LEASE

OFFICE BUILDING

LOCATION MAP

1440 ARCADE ST NORTH - UNIT A

SAINT PAUL, MN 55106

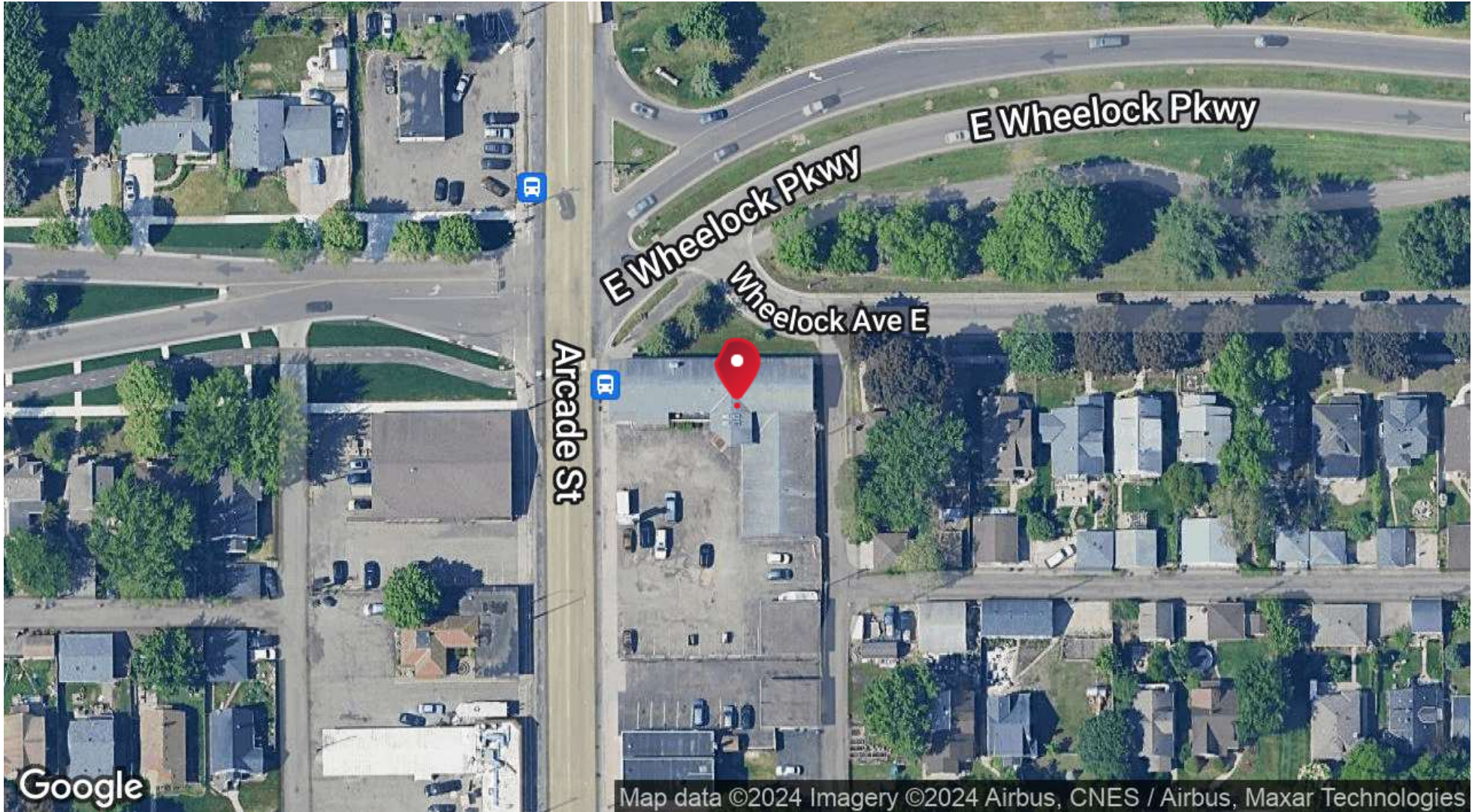

ADVANTAGE PLUS

Each office independently owned and operated

TIM LITTLE
Chief Commercial Broker
952.432.4900
tctimlittle@gmail.com

JIM STARR JEREMY FELDMANN
Sr. Associate Associate
612.247.5898 406.314.3333
jjstarr41@gmail.com jeremy.feldmann@remax.net

1251 Town Centre Drive
Eagan, MN 55123

REMAXCOMMERCIAL.COM

All information contained herein is deemed reliable but not guaranteed. Each office independently owned and operated

1440 ARCADE ST NORTH - UNIT A

SAINT PAUL, MN 55106

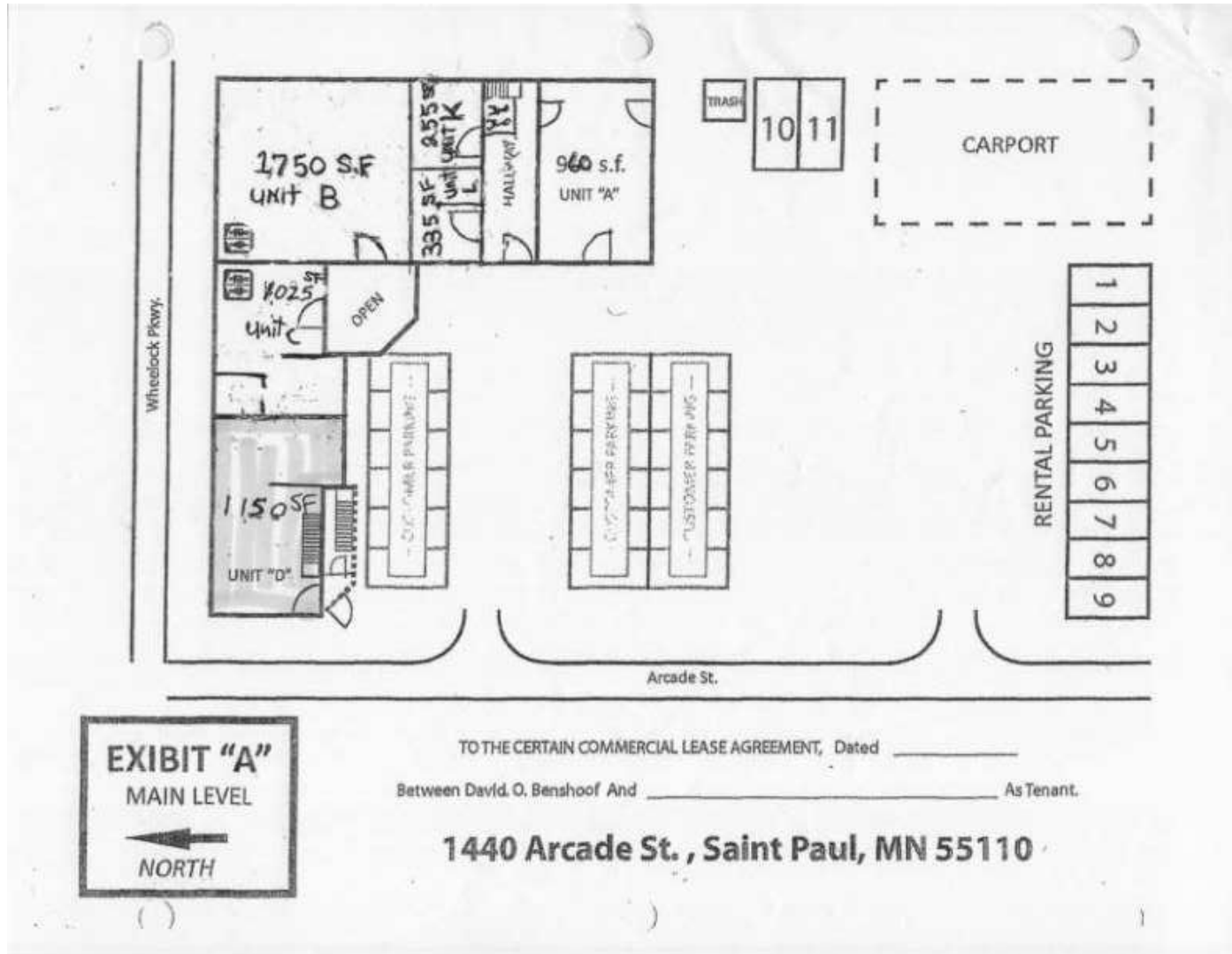

ADVANTAGE PLUS
Each office independently owned and operated

TIM LITTLE
Chief Commercial Broker
952.432.4900
tctimittle@gmail.com

JIM STARR JEREMY FELDMANN
Sr. Associate Associate
612.247.5898 406.314.3333
jjstarr41@gmail.com jeremy.feldmann@remax.net

1251 Town Centre Drive
Eagan, MN 55123

REMAXCOMMERCIAL.COM

1440 ARCADE ST NORTH - UNIT A

SAINT PAUL, MN 55106



POPULATION

	0.3 MILES	0.5 MILES	1 MILE
Total Population	1,317	4,682	21,135
Average Age	35	35	34
Average Age (Male)	35	35	33
Average Age (Female)	36	36	34

HOUSEHOLDS & INCOME

	0.3 MILES	0.5 MILES	1 MILE
Total Households	439	1,549	6,611
# of Persons per HH	3	3	3.2
Average HH Income	\$95,202	\$91,251	\$83,532
Average House Value	\$295,171	\$298,713	\$273,745

Demographics data derived from AlphaMap



ADVANTAGE PLUS
Each office independently owned and operated

TIM LITTLE
Chief Commercial Broker
952.432.4900
tctimlittle@gmail.com

JIM STARR JEREMY FELDMANN
Sr. Associate Associate
612.247.5898 406.314.3333
jjstarr41@gmail.com jeremy.feldmann@remax.net

1251 Town Centre Drive
Eagan, MN 55123

REMAXCOMMERCIAL.COM

1440 ARCADE ST NORTH - UNIT A

SAINT PAUL, MN 55106



TIM LITTLE

Chief Commercial Broker

Direct: 952.432.4900 **Cell:** 952.432.4900
tctimlittle@gmail.com



JIM STARR

Sr. Associate

Direct: 612.247.5898 **Cell:** 612.247.5898
jjstarr41@gmail.com



JEREMY FELDMANN

Associate

Direct: 406.314.3333 **Cell:** 406.314.3333
jeremy.feldmann@remax.net



ADVANTAGE PLUS

Each office independently owned and operated

TIM LITTLE
Chief Commercial Broker
952.432.4900
tctimlittle@gmail.com

JIM STARR JEREMY FELDMANN
Sr. Associate Associate
612.247.5898 406.314.3333
jjstarr41@gmail.com jeremy.feldmann@remax.net

1251 Town Centre Drive
Eagan, MN 55123

REMAXCOMMERCIAL.COM