



Colliers



For Sale
±4,900 SF

Asking Price:
\$2,100,000

Contact

Shadd Walker, SIOR

Senior Executive Vice President
Lic. 01253297
+1 213 532 3242
shadd.walker@colliers.com

Alex Blecksmith, CCIM

Associate Vice President
Lic. 01518130
+1 323 278 3132
alex.blecksmith@colliers.com

Colliers

865 S. Figueroa Street
Suite 3500
Los Angeles, CA 900147
colliers.com

528 East Fig Avenue
Monrovia, CA

Property Features

Loading Doors	2-DH / 1-GL (via ramp)
Sprinklers	No
Zoning / Property Type	MOM*
Available SF	4,900 SF
Lot Size:	9,503 SF / 0.22 AC
Office SF	±1,620 SF
Clear Height	12'
Parking	4 Spaces
Power	600 Amps, 120-240V, 3 Phase, 4 Wire Power
Location	Convenient Access to 210 and 605 freeways
Construction Type	Concrete Tilt-Up

Accelerating success.

528 East Fig Avenue, Monrovia

Site Plan

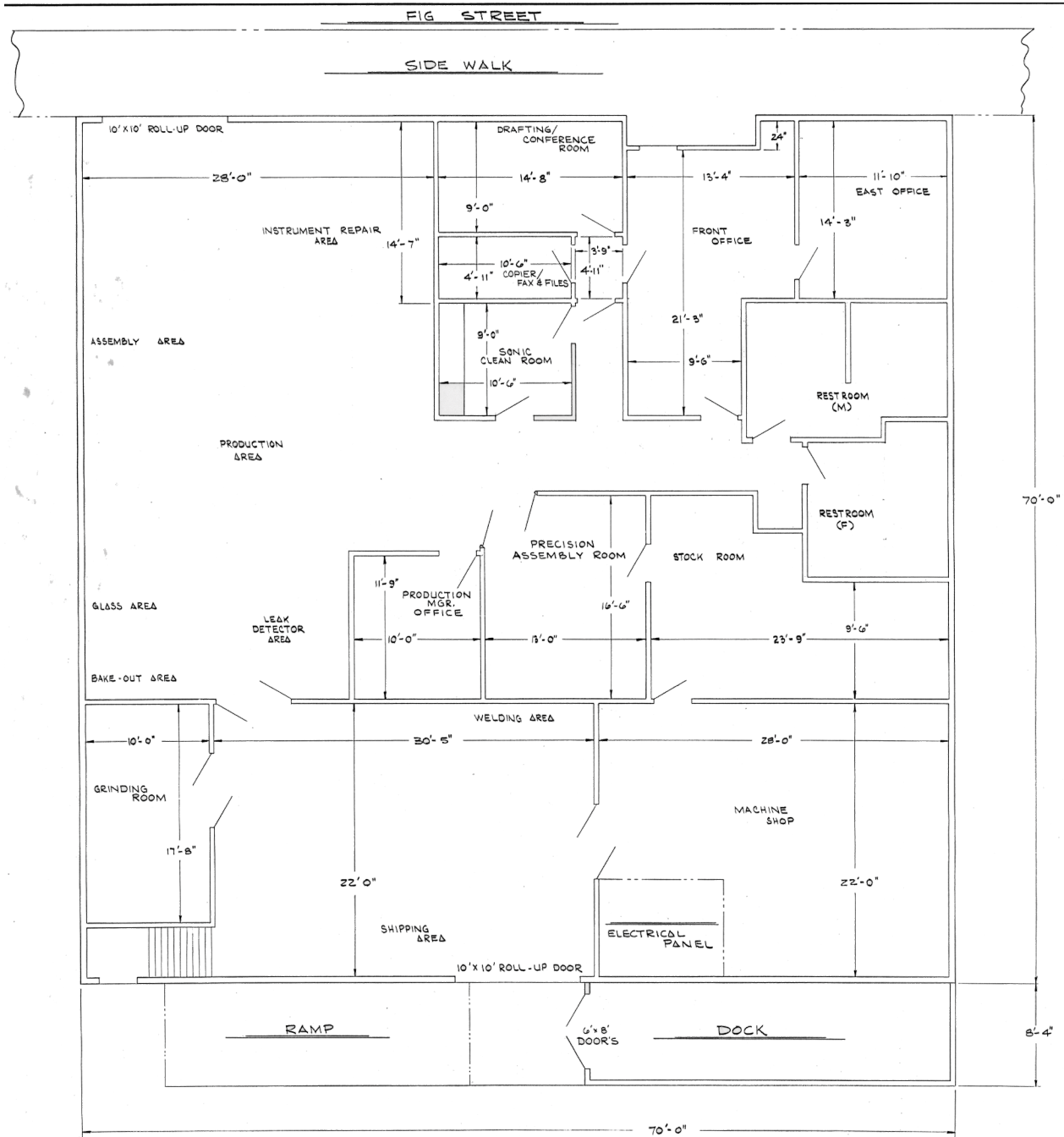

This document has been prepared by Colliers International for advertising and general information only. Colliers International makes no guarantees, representations or warranties of any kind, expressed or implied, regarding the information including, but not limited to, warranties of content, accuracy and reliability. Any interested party should undertake their own inquiries as to the accuracy of the information. Colliers International excludes unequivocally all inferred or implied terms, conditions and warranties arising out of this document and excludes all liability for loss and damages arising there from. This publication is the copyrighted property of Colliers International and/or its licensor(s). ©2023. All rights reserved.



528 East Fig Avenue, Monrovia

Photos



528 East Fig Avenue, Monrovia



Location Map

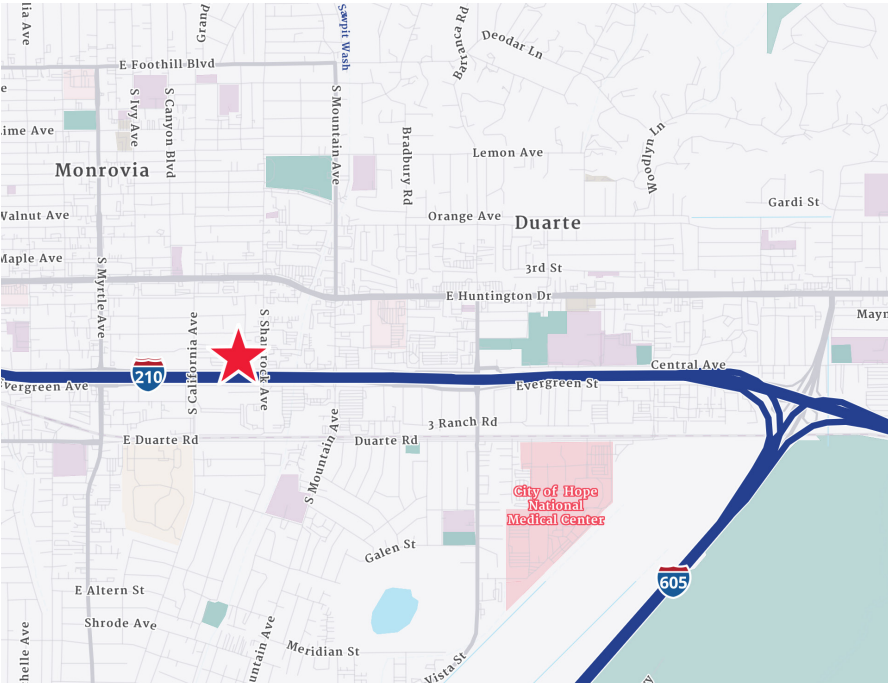

Key Distances



Downtown Los Angeles
23 Miles



Old Town Monrovia
1.5 Miles



605 Interchange
1.5 Miles



Monrovia Station (Gold Line)
1.0 Miles

Shadd Walker, SIOR
Senior Executive Vice President
Lic. 01253297
+1 213 532 3242
shadd.walker@colliers.com

Alex Blecksmith, CCIM
Associate Vice President
Lic. 01518130
+1 323 278 3132
alex.blecksmith@colliers.com