



**BOUNDARY SURVEY OF
TMS 178-00-01-013, OWNED BY
SC DISTRICT OF WESLEYAN CHURCH TRUSTEE
LOCATED IN THE TOWN OF SUMMITTLE
BERKELEY COUNTY, SOUTH CAROLINA**

SCALE: 1" = 100'
DECEMBER 1, 2023
PLAT C, LARSON, M.S.C. NO. 17171

WETLAND ADJACENT TO
WETLAND A 0.57 AC
WETLAND B 0.59 AC
WETLAND C 0.58 AC
TOTAL WETLAND 1.74 AC
TOTAL UNPAVED 23.09 AC
TOTAL ACRES 24.83 AC

WM

02/09/2024, 09:01:29 AM EST

LEGEND
PROPERTY LINE W/IRON PIN
PROPERTY LINE W/WOOD SET
OVER HEAD POWER LINE
FENCE LINE
CONCRETE MATCH
POWER POLE

J. M. PARTNERSHIP
178-00-01-014

**SOUTH CAROLINA DISTRICT OF THE
WESLEYAN CHURCH TRUSTEE**
178-00-01-013
1.158,878 SP
TOTAL ACRES

APPROX 3.51 AC

REFERENCES:
1) PLAT BY ANDREW C. GILLETTE, REVISED DECEMBER 22, 1985
2) PLAT BY ANDREW C. GILLETTE, AT PAGE 107
3) PLAT BY ANDREW C. GILLETTE, REVISED AUGUST 12, 1999
4) PLAT BY ANDREW C. GILLETTE, AT PAGE 102
5) PLAT BY ANDREW C. GILLETTE, REVISED MARCH 6, 2008
6) PLAT BY ANDREW C. GILLETTE, AT PAGE 111
7) PLAT BY ANDREW C. GILLETTE, REVISED NOVEMBER 29, 2006
8) PLAT BY ANDREW C. GILLETTE, AT PAGE 211

LEGEND
IRON ROD SET
WOOD ROD FOUND

LINE	LENGTH	BEARING
L1	154.17	N 27.03°01' E
L2	67.71	S 84.20°01' E
L3	28.90	S 28°00'01" E
L4	33.58	S 17°31'53" E
L5	15.15	S 77°40'32" E
L6	21.68	S 72°21'50" E
L7	29.47	N 78°25'34" E
L8	35.65	N 69°12'51" E
L9	18.31	S 28°17'00" E
L10	14.00	N 87.50°01' E
L11	18.31	S 28°17'00" E
L12	35.65	N 69°12'51" E
L13	29.47	N 78°25'34" E
L14	21.68	S 72°21'50" E
L15	15.15	S 77°40'32" E
L16	28.90	S 28°00'01" E
L17	67.71	S 84.20°01' E
L18	154.17	N 27.03°01' E

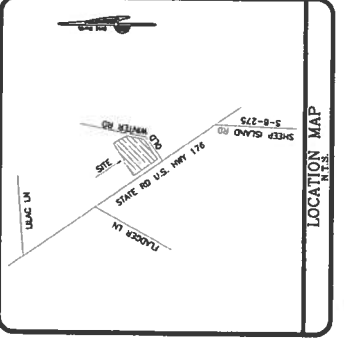

- NOTES:**
- 1) AREA WAS DETERMINED BY THE COORDINATE METHOD.
 - 2) ALL DIMENSIONS SHOWN OUTSIDE THE DEFINED BOUNDARY IS FOR EXCLUSIVE USE OF THE CLIENT.
 - 3) THE PUBLIC RECORDS REFERENCED ON THIS PLAT ARE ONLY USED AS A GUIDE AND/OR NECESSARY TO THE ESTABLISHMENT OF THE BOUNDARY. THEY ARE NOT TO BE CONSIDERED AS A TITLE SEARCH. THEY ARE NOT AND DO NOT CONSTITUTE A TITLE SEARCH.
 - 4) THIS PLAT HAS BEEN PREPARED FOR THE EXCLUSIVE USE AND PURPOSE OF THE CLIENT ASSIGNED AND CONTRACTED WITH TO PERFORM A BOUNDARY SURVEY. IT IS NOT TO BE USED FOR ANY OTHER PURPOSES WITHOUT THE WRITTEN CONSENT OF THE SURVEYOR. ANY UNAUTHORIZED USE OF THIS PLAT IS AT THE USER'S SOLE RISK AND WITHOUT LIABILITY TO THE SURVEYOR.
 - 5) DISTANCE SHOWN HEREON ARE HORIZONTAL GROUND DIMENSIONS.
 - 6) ALL SURVEYS WERE PERFORMED IN ACCORDANCE WITH THE SURVEYING ACT AND THE RULES AND REGULATIONS OF THE BOARD OF SURVEYING AND MAPPING. THE SURVEYOR'S NAME AND LICENSE NUMBER ARE SHOWN ON THIS PLAT. THEREFORE, THIS PLAT DOES NOT REFLECT THE SURVEYOR'S OPINION OR CONCLUSIONS WHICH MAY AFFECT THIS PROPERTY.
 - 7) THIS PROPERTY IS LOCATED IN FLOOD ZONE X. SET BACK REQUIREMENTS ARE SHOWN ON THIS PLAT. SEE THE LOCAL ZONING ORDINANCE FOR MORE INFORMATION.
 - 8) THIS PROPERTY IS ZONED R1D1.

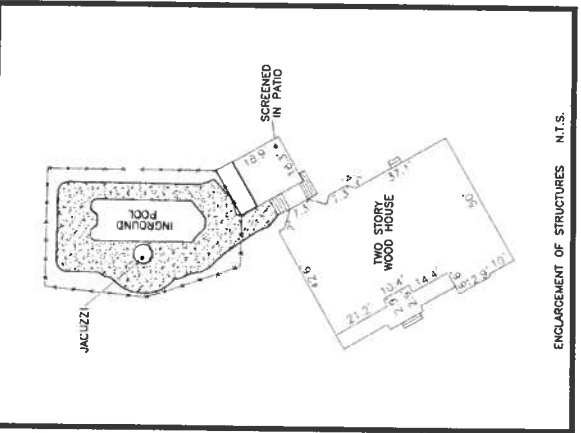

ENCLOSURE OF STRUCTURES N.T.S.